

NEW MEXICO OIL CONSERVATION COMMISSION  
Santa Fe, New Mexico

Form O-101  
Revised (12/1/55)

NOTICE OF INTENTION TO DRILL

Notice must be given to the District Office of the Oil Conservation Commission and approval obtained before drilling or recompletion begins. If changes in the proposed plan are considered advisable, a copy of this notice showing such changes will be returned to the sender. Submit this notice in QUINTUPLICATE. One copy will be returned following approval. See additional instructions in Rules and Regulations of the Commission. If State Land submit 6 Copies Attach Form O- 128 in triplicate to first 3 copies of form O-101

Breckenridge, Texas  
(Place)

October 5, 1959  
(Date)

OIL CONSERVATION COMMISSION  
SANTA FE, NEW MEXICO

Gentlemen:

You are hereby notified that it is our intention to commence the Drilling of a well to be known as  
Graridge Corporation

(Company or Operator)

Resler Yates State  
(Lease)

Well No. 383

G

The well is

(Unit)

located 2310 feet from the North line and 1850 feet from the

East

line of Section 28

T. 18S

R.

28E, NMPM.

(GIVE LOCATION FROM SECTION LINE)

Artesia

Pool,

Eddy

County

If State Land the Oil and Gas Lease is No. 647

If patented land the owner is

Address

We propose to drill well with drilling equipment as follows: 2100' with rotary equipment

The status of plugging bond is \$10,000 Fidelity & Casualty Company of New York #103517 covering drilling & plugging for State of New Mexico.

Drilling Contractor

(Will advise later)

We intend to complete this well in the 1st Grayburg formation at an approximate depth of 2050 - 2100 feet.

CASING PROGRAM

We propose to use the following strings of Casing and to cement them as indicated:

Size of Hole	Size of Casing	Weight per Foot	New or Second Hand	Depth	Sacks Cement
10-3/4"	8-5/8"	28#	New	300	200
7-7/8"	4 1/2"	9.5#	New	2100	100

If changes in the above plans become advisable we will notify you immediately.

ADDITIONAL INFORMATION (If recompletion give full details of proposed plan of work.) This well is to be drilled as a replacement for well #26 which has been plugged and abandoned.

COPY

Approved \_\_\_\_\_, 19\_\_\_\_  
Except as follows:

OIL CONSERVATION COMMISSION

By

M. L. Armstrong

Sincerely yours,

GRARIDGE CORPORATION

(Company or Operator)

By

Charles W. Smith

Charles W. Smith

Position

Production Clerk

Send Communications regarding well to

Name

Graridge Corporation

Box 752 Breckenridge, Texas

U.S. DEPARTMENT OF COMMERCE	
BUREAU OF COMMERCE	
No. _____	
City	
State	
Country	
U.S. Office	
Transfer	
File	
Bureau	

Revised 5/1/57

NEW MEXICO OIL CONSERVATION COMMISSION  
Well Location and Acreage Dedication Plat

Section A.

Date October 2, 1959

Operator The Graridge Corporation Lease Resler-Yates-State  
 Well No. 383 Unit Letter S Section 28 Township 18 South Range 28 East NMPM  
 Located 2310 Feet From North Line, 1850 Feet From East Line  
 County Eddy G. L. Elevation 3536 Dedicated Acreage \_\_\_\_\_ Acres  
 Name of Producing Formation 1st Grayburg Pool Artesia

1. Is the Operator the only owner\* in the dedicated acreage outlined on the plat below?  
 Yes X No \_\_\_\_\_.
2. If the answer to question one is "no," have the interests of all the owners been consolidated by communitization agreement or otherwise? Yes \_\_\_\_\_ No \_\_\_\_\_. If answer is "yes," Type of Consolidation \_\_\_\_\_
3. If the answer to question two is "no," list all the owners and their respective interests below:

OwnerLand Description

<u>Owner</u>	<u>Land Description</u>

## Section B

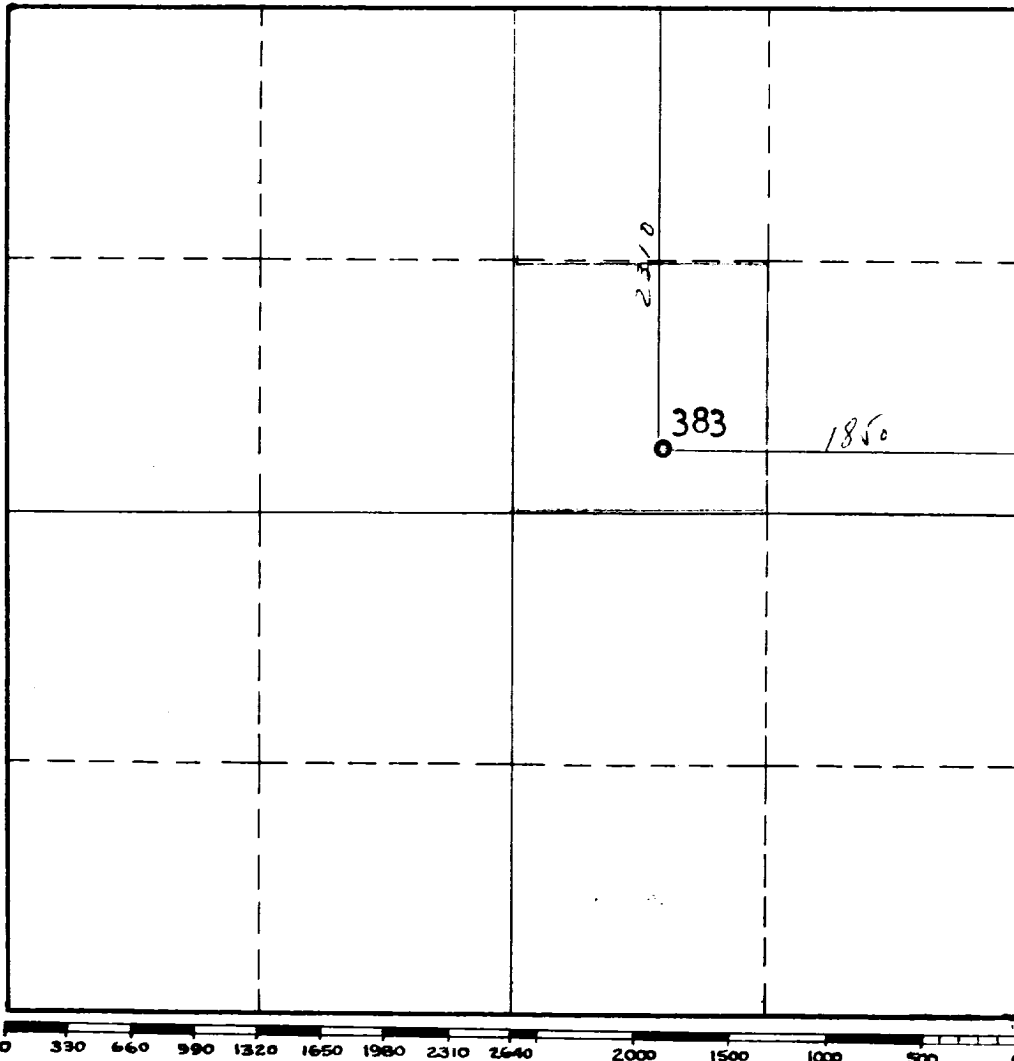

This is to certify that the information in Section A above is true and complete to the best of my knowledge and belief.

Graridge Corporation

(Operator)

(Representative)

Breckenridge, Texas

Address

This is to certify that the well location shown on the plat in Section B was plotted from field notes of actual surveys made by me or under my supervision and that the same is true and correct to the best of my knowledge and belief.

Date Surveyed 10/2/59

Registered Professional  
 Engineer and/or Land Surveyor.

Certificate No. 1502

(See instructions for completing this form on the reverse side)

INSTRUCTIONS FOR COMPLETION

1. Operator shall furnish and certify to the information called for in Section A.
2. Operator shall outline the dedicated acreage for both oil and gas wells on the plat in Section B.
3. A registered professional engineer or land surveyor registered in the State of New Mexico or approved by the Commission shall show on the plat the location of the well and certify this information in the space provided.
4. All distances shown on the plat must be from the outer boundaries of Section.
5. If additional space is needed for listing owners and their respective interests as required in question 3, Section A, please use space below

\* "Owner" means the person who has the right to drill into and to produce from any pool and to appropriate the production either for himself or for himself and another. (65-3-29 (e) NMSA 1953 Comp.)