

NEW MEXICO OIL CONSERVATION COMMISSION
Santa Fe, New Mexico

Form C-101
Revised (12/1/55)

NOTICE OF INTENTION TO DRILL

Notice must be given to the District Office of the Oil Conservation Commission and approval obtained before drilling or recompletion begins. If changes in the proposed plan are considered advisable, a copy of this notice showing such changes will be returned to the sender. Submit this notice in QUINTUPPLICATE. One copy will be returned following approval. See additional instructions in Rules and Regulations of the Commission. If State Land submit 6 Copies Attach Form G- 128 in triplicate to first 3 copies of form C-101

Breckenridge, Texas
(Place)

May 25, 1959
(Date)

OIL CONSERVATION COMMISSION
SANTA FE, NEW MEXICO

Gentlemen:

You are hereby notified that it is our intention to commence the Drilling of a well to be known as

Graridge Corporation

(Company, or Operator)

Ventures State

(Lease)

Well No. 306

in A

(Unit)

The well is

located 820 feet from the North line and 1180 feet from the

East

line of Section 28, T. 18S, R. 28E, NMPM.

(GIVE LOCATION FROM SECTION LINE)

Artesia

Pool,

Eddy

County

647

If State Land the Oil and Gas Lease is No.

If patented land the owner is

Address

We propose to drill well with drilling equipment as follows: 2100' with rotary equipment.

The status of plugging bond is \$10,000 Fidelity & Casualty Company of New York #1053517 covering drilling & plugging in State of New Mexico.

Drilling Contractor

(Will advise later)

We intend to complete this well in the 1st Grayburg

formation at an approximate depth of 2050' to 2100' feet.

CASING PROGRAM

We propose to use the following strings of Casing and to cement them as indicated:

Size of Hole	Size of Casing	Weight per Foot	New or Second Hand	Depth	Sacks Cement
10-3/4"	8-5/8"	28#	New	300	200
8-3/4"	5-1/2"	14#	New	2100	150

If changes in the above plans become advisable we will notify you immediately

ADDITIONAL INFORMATION (If recompletion give full details of proposed plan of work.)

JUL 9 1959

Approved _____, 19_____
Except as follows:

OIL CONSERVATION COMMISSION

By

Sincerely yours,

Graridge Corporation

(Company or Operator)

By

Charles W. Smith

Position Production Clerk

Send Communications regarding well to

Name Graridge Corporation

Address Box 752, Breckenridge, Texas

NEW MEXICO OIL CONSERVATION COMMISSION

Well Location and Acreage Dedication Plat

Section A.

Date May 19, 1959

Operator Granidge Corporation Lease Ventures State
Well No. 305 Unit Letter A Section 28 Township 18S Range 2SE NMPM
Located 822 Feet From North Line, 1180 Feet From East Line
County Eddy G. L. Elevation 3548 Dedicated Acreage _____ Acres
Name of Producing Formation 1st Granbury Pool Artesia

1. Is the Operator the only owner* in the dedicated acreage outlined on the plat below?
Yes ☒ No ☐.
2. If the answer to question one is "no," have the interests of all the owners been consolidated by communitization agreement or otherwise? Yes ☐ No ☐. If answer is "yes," Type of Consolidation _____
3. If the answer to question two is "no," list all the owners and their respective interests below:

Owner

Land Description

Section B

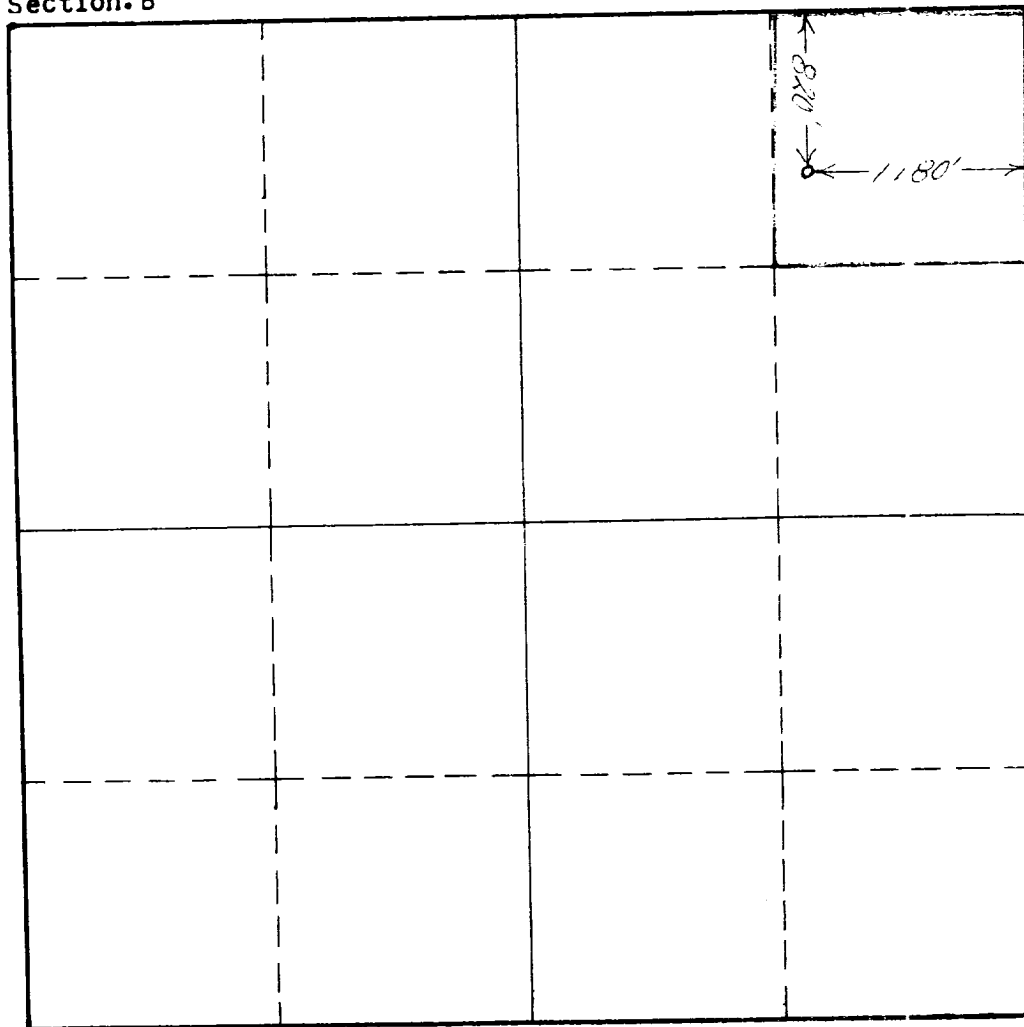

This is to certify that the information in Section A above is true and complete to the best of my knowledge and belief.

Granidge Corporation

(Operator)

Charles W. Mitt
(Representative)

Breckenridge, Texas

Address

This is to certify that the well location shown on the plat in Section B was plotted from field notes of actual surveys made by me or under my supervision and that the same is true and correct to the best of my knowledge and belief.

Date Surveyed 5-23-59

W. P. Sheldon
Registered Professional
Engineer and/or Land Surveyor.

Certificate No. 963

INSTRUCTIONS FOR COMPLETION:

1. Operator shall furnish and certify to the information called for in Section A.
2. Operator shall outline the dedicated acreage for both oil and gas wells on the plat in Section B.
3. A registered professional engineer or land surveyor registered in the State of New Mexico or approved by the Commission shall show on the plat the location of the well and certify this information in the space provided.
4. All distances shown on the plat must be from the outer boundaries of Section.
5. If additional space is needed for listing owners and their respective interests as required in question 3, Section A, please use space below

OIL CONSERVATION COMMISSION	
ARTERIA DISTRICT OFFICE	
NAME	
ADDRESS	
CITY	
STATE	
ZIP	
PHONE	
TELETYPE	
MAILING ADDRESS	
DATE	
BY	
BU	

* "Owner" means the person who has the right to drill into and to produce from any pool and to appropriate the production either for himself or for himself and another. (65-3-29 (e) NMSA 1953 Comp.)