



IN REPLY REFER TO:

UNITED STATES
DEPARTMENT OF THE INTERIOR
BIOLOGICAL SURVEY
Roswell, New Mexico

cy to 2.7.

November 3, 1963

Texaco Inc.
P. O. Box 3109
Midland, Texas

Gentlemen:

Your Notice of Intention to Drill well No. 10 Leo R. Manning Federal "B" NCT-1 (copy attached) in the SE1/4 sec. 28, T. 18 S., R. 30 E., N.M.P.M., Eddy County, New Mexico, lease New Mexico 033775, to a depth of 3,300 feet to test the Grayburg formation, has been forwarded to this office for approval.

Pursuant to authority delegated to the Regional Oil and Gas Supervisor on May 10, 1962, 27 F.R. 4814, I hereby approve the Notice of Intention to Drill described in the foregoing.

Please notify the District Engineer, Geological Survey, Drawer U, Artesia, New Mexico, in sufficient time for a representative to witness all cementing operations.

Very truly yours,

(O.I.G. SGD.) JOHN A. ANDERSON

JOHN A. ANDERSON
Regional Oil and Gas Supervisor

Attachment

Copy to: Washington
Mining Branch (2)
NMDC-~~Artesia~~ (2) (w/2 cys Notice) ✓
Artesia
Roswell (2)

JAKnauf:hb 10/31/63

RECEIVED

NOV 6 1963

O. C. C.
ARTESIA, OFFICE

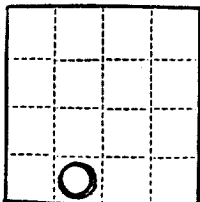

(SUBMIT IN TRIPLICATE)

UNITED STATES
DEPARTMENT OF THE INTERIOR
GEOLOGICAL SURVEY

Land Office

Lease No. NM-033775

Unit

SUNDRY NOTICES AND REPORTS ON WELLS

NOTICE OF INTENTION TO DRILL	<input checked="" type="checkbox"/>	SUBSEQUENT REPORT OF WATER SHUT-OFF
NOTICE OF INTENTION TO CHANGE PLANS	<input type="checkbox"/>	SUBSEQUENT REPORT OF SHOOTING OR ACIDIZING
NOTICE OF INTENTION TO TEST WATER SHUT-OFF	<input type="checkbox"/>	SUBSEQUENT REPORT OF ALTERING CASING
NOTICE OF INTENTION TO RE-DRILL OR REPAIR WELL	<input type="checkbox"/>	SUBSEQUENT REPORT OF RE-DRILLING OR REPAIR
NOTICE OF INTENTION TO SHOOT OR ACIDIZE	<input type="checkbox"/>	SUBSEQUENT REPORT OF ABANDONMENT
NOTICE OF INTENTION TO PULL OR ALTER CASING	<input type="checkbox"/>	SUPPLEMENTARY WELL HISTORY
NOTICE OF INTENTION TO ABANDON WELL	<input type="checkbox"/>	

(INDICATE ABOVE BY CHECK MARK NATURE OF REPORT, NOTICE, OR OTHER DATA)

Lease No. 163971
Léo R. Manning Federal "B" NCT-1 October 29, 1963

Well No. 10 is located 660 ft. from [N] line and 2310 ft. from [E] line of sec. 28

SE/4 of the SW/4 Sec 28, T-18-S, R-30-E NMPM
(1/4 Sec. and Sec. No.) (Twp.) (Range) (Meridian)

North Benson (Queen) Eddy **RECEIVED**
(Field) (County or Subdivision) (State or Territory)

The elevation of the derrick floor above sea level is 3468 ft. NOV 4 1963

DETAILS OF WORK U. S. GEOLOGICAL SURVEY
ROSWELL, NEW MEXICO

(State names of and expected depths to objective sands; show sizes, weights, and lengths of proposed casings; indicate mudding jobs, cementing points, and all other important proposed work)

SEE ATTACHED SHEET

RECEIVED
NOV 6 1963
O. C. C.
ARTESIA, OFFICE

RECEIVED
OCT 31 1963
U. S. GEOLOGICAL SURVEY
ARTESIA, NEW MEXICO

I understand that this plan of work must receive approval in writing by the Geological Survey before operations may be commenced.

Company TEXACO Inc. TEXACO Inc.

Address P. O. Box 3109

Midland, Texas

By [Signature]
Title Division Civil Engineer

CASING PROGRAM

We propose to use the following strings of Casing and to cement them as indicated:

Size of Hole	Size of Casing	Weight per Foot	New or Second Hand	Depth	Sacks Cement
9- 5/8"	7"	14#	New	480'	450*
6 1/4"	4 1/2"	9.5#	New	3300'	350**

* 350 sks. Class "C" with 4% gel followed by 100 sks. "C" Neat.

** Class "C" Neat with 10% salt by weight of mixing water.

RECEIVED

NOV 4 1963

U. S. GEOLOGICAL SURVEY
ROSWELL, NEW MEXICO

FORMATION TOPS EXPECTED

Anhydrite	350'
Top of Salt	555'
Yates	1570'
Queen	2740'
Total Depth	3300'

RECEIVED
OCT 31 1963

U. S. GEOLOGICAL SURVEY
ARTESIA, NEW MEXICO

RECEIVED
NOV 16 1963

D. C. C.
ARTESIA, OFFICE

NEW MEXICO OIL CONSERVATION COMMISSION
WELL LOCATION AND ACREAGE DEDICATION PLAT

FORM C-128
Revised 5/1/57

SEE INSTRUCTIONS FOR COMPLETING THIS FORM ON THE REVERSE SIDE

SECTION A

Operator TEXACO Inc.		Lease Leo R. Manning-Federal "B" NCT-1		Well No. 10
Unit Letter N	Section 28	Township 18 South	Range 30 East	County Eddy
Actual Footage Location of Well: 660 feet from the South line and 2310 feet from the West line Sec. 28				
Ground Level Elev. 3457	Producing Formation Queen	Pool North Benson Queen-Grayburg	Dedicated Acreage: 40 Acres	

1. Is the Operator the only owner in the dedicated acreage outlined on the plat below? YES X NO ____ . ("Owner" means the person who has the right to drill into and to produce from any pool and to appropriate the production either for himself or for himself and another. (65-3-29 (e) NMSA 1935 Comp.)
2. If the answer to question one is "no," have the interests of all the owners been consolidated by communitization agreement or otherwise? YES ____ NO ____ . If answer is "yes," Type of Consolidation ____
3. If the answer to question two is "no," list all the owners and their respective interests below:

Owner	Land Description

RECEIVED
NOV 6 1963
O. C. C.
ARTESIA OFFICE

SECTION B

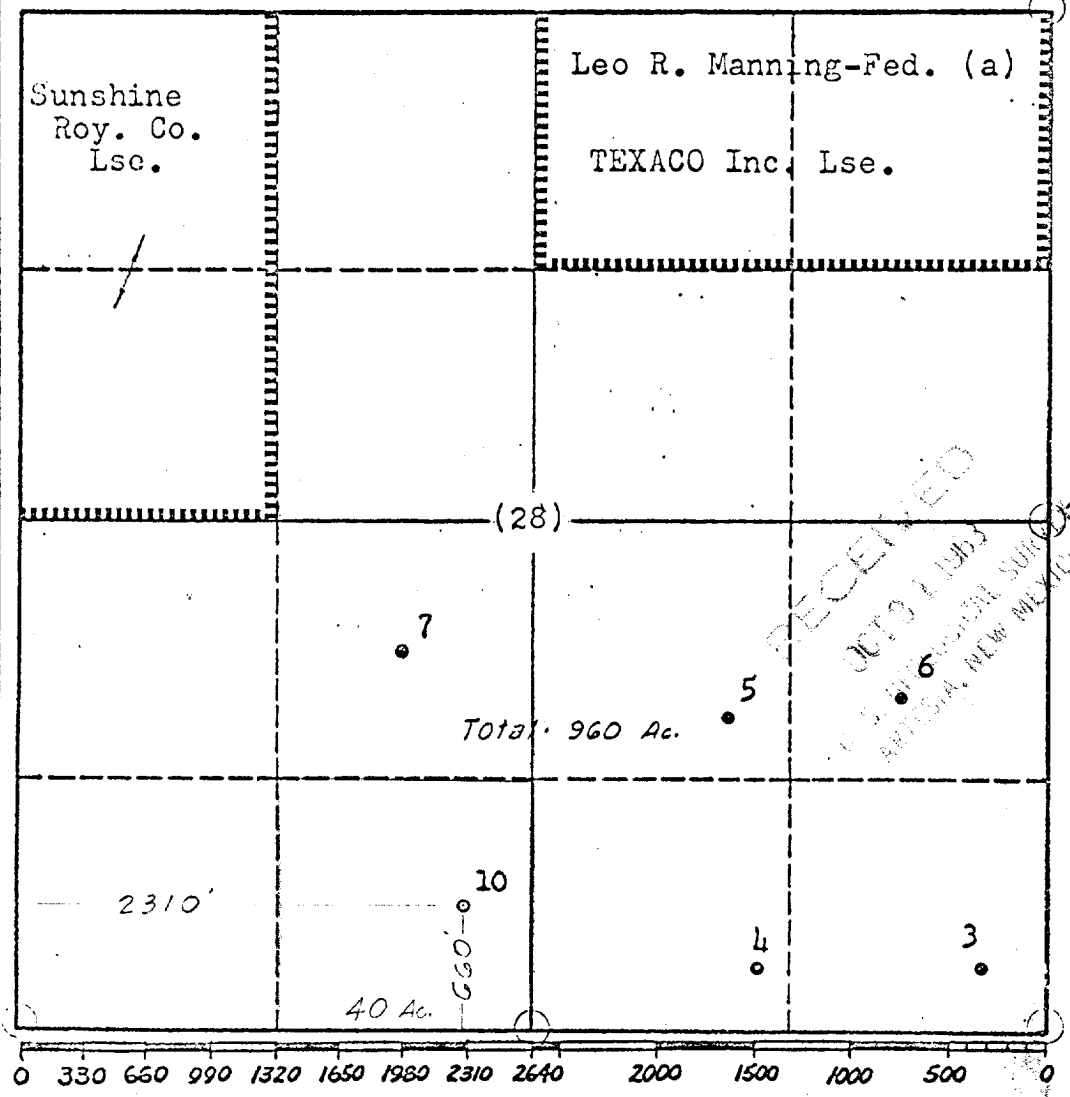

CERTIFICATION

I hereby certify that the information in SECTION A above is true and complete to the best of my knowledge and belief.

Name	J. J. Velten
Position	Division Civil Engineer
Company	TEXACO Inc.
Date	10/28/63

Markers

I hereby certify that the well location shown on the plat in SECTION B was plotted from field notes of actual surveys made by me or under my supervision, and that the same is true and correct to the best of my knowledge and belief.

Date Surveyed	10/26/63
Registered Professional Engineer and/or Land Surveyor	J. J. Velten
Certificate No.	8174