

NEW MEXICO OIL CONSERVATION COMMISSION
WELL LOCATION AND ACREAGE DEDICATION PLAT

FORM C-128
Revised 5/1/57

SEE INSTRUCTIONS FOR COMPLETING THIS FORM ON THE REVERSE SIDE

SECTION A

Operator SUNRAY DX OIL COMPANY		Lease NEW MEXICO STATE AM		Well No. 1
Well Letter A	Section 36	Township 18 SOUTH	Range 21 EAST	County EDDY
Actual Footage Location of Well: 660 feet from the NORTH line and 810 feet from the EAST line				
Ground Level Elev. 4122'	Producing Formation Strawn	Pool South Hope-Strawn	Dedicated Acreage: 640 Acres	

1. Is the Operator the only owner in the dedicated acreage outlined on the plat below? YES ☒ NO ☐ ("Owner" means the person who has the right to drill into and to produce from any pool and to appropriate the production either for himself or for himself and another. (65-3-29 (e) NMSA 1935 Comp.)
2. If the answer to question one is "no," have the interests of all the owners been consolidated by communization agreement or otherwise? YES ☐ NO ☐ If answer is "yes," Type of Consolidation _____
3. If the answer to question two is "no," list all the owners and their respective interests below:

Owner	Land Description

RECEIVED

DEC 2 1963

D. E. C.
CERTESIA, OFFICE
CERTIFICATION

SECTION B

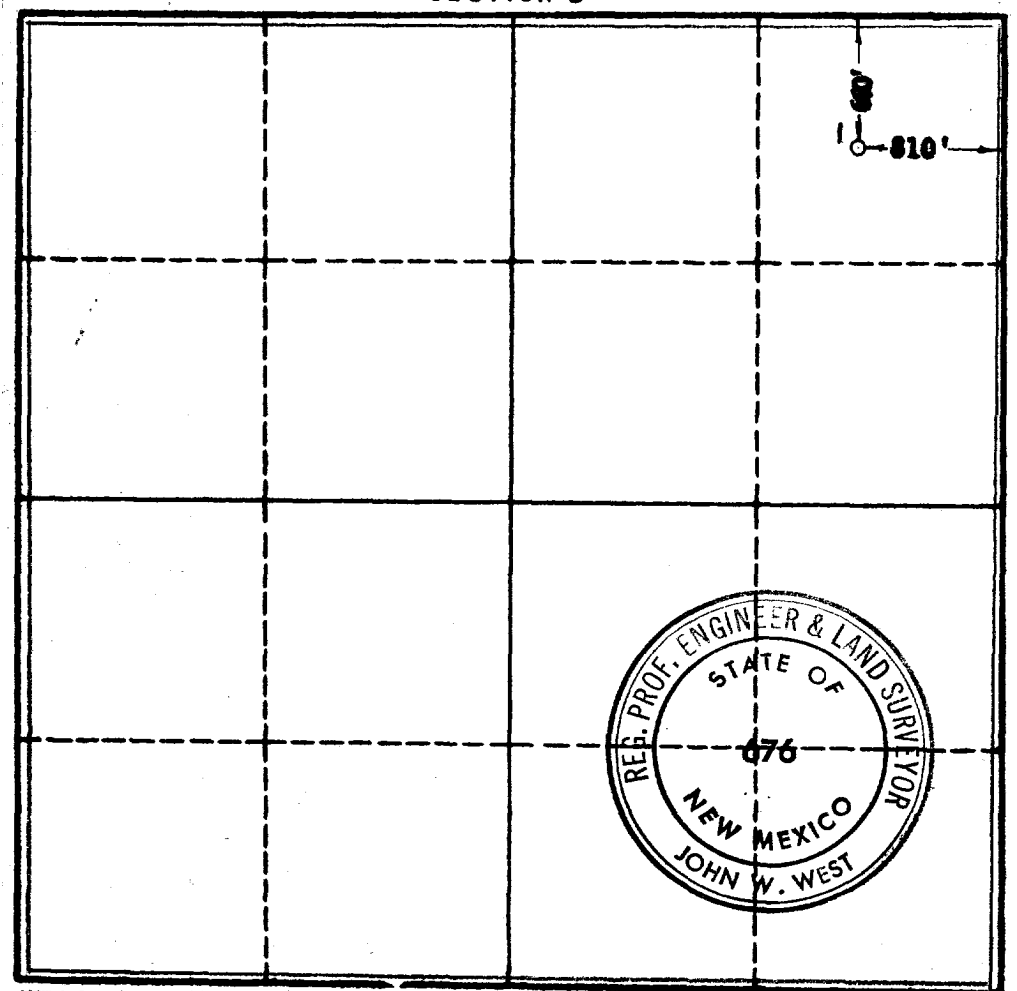

I hereby certify that the information in SECTION A above is true and complete to the best of my knowledge and belief.

Name D. E. Berry, Jr.

Position Engineer

Company Sunray DX Oil Company

Date November 27, 1963

I hereby certify that the well location shown on the plat in SECTION B was plotted from field notes of actual surveys made by me or under my supervision, and that the same is true and correct to the best of my knowledge and belief.

Date Surveyed 6-5-63

Registered Professional Engineer and/or Land Surveyor, JOHN W. WEST

John W. West

Certificate No. 676
N. M. - P. E. & L. S. No. 676

OIL CONSERVATION COMMISSION		
NOTE TO DISTRICT OFFICE		
NAME OF FIELD		3
LOCATION		
DATE		
OPERATION		
STATUS		
PROPERTY		/
STATE LAND		
U. S. LAND		/
TRANSFER		
FILE		
BUREAU OF LINES		/