

NO. OF COPIES RECEIVED	7
DISTRIBUTION	
SANTA FE	1
FILE	1
U.S.G.S.	2
LAND OFFICE	1
OPERATOR	2

NEW MEXICO OIL CONSERVATION COMMISSION

RECEIVED

SEP 5 1969

O. C. C.

ARTESIA OFFICE

Form C-101
Revised 1-1-65

5A. Indicate Type of Lease STATE <input checked="" type="checkbox"/> FEE <input type="checkbox"/>
5. State Oil & Gas Lease No. L-14552
7. Unit Agreement Name
8. Farm or Lease Name State
9. Well No. 1
10. Field and Pool, or Wildcat Atoka
12. County Eddy
19. Proposed Depth 1800'
19A. Formation San Andres
20. Rotary or C.T. C.T.
21. Elevations (Show whether DF, RT, etc.) 3358 K B
21A. Kind & Status Plug. Bond Blanket
21B. Drilling Contractor C.O. Fulton
22. Approx. Date Work will start 9-5-69

APPLICATION FOR PERMIT TO DRILL, DEEPEN, OR PLUG BACK					
1a. Type of Work					
b. Type of Well DRILL <input checked="" type="checkbox"/> DEEPEN <input type="checkbox"/> PLUG BACK <input type="checkbox"/> OIL WELL <input checked="" type="checkbox"/> GAS WELL <input type="checkbox"/> OTHER <i>Re Entry</i> SINGLE ZONE <input checked="" type="checkbox"/> MULTIPLE ZONE <input type="checkbox"/>					
2. Name of Operator C.O. Fulton					
3. Address of Operator P.O. Box 1121 Artesia, New Mexico 88210					
4. Location of Well UNIT LETTER P LOCATED 990 FEET FROM THE South LINE AND 990 FEET FROM THE East LINE OF SEC. 16 TWP. 18 S RGE. 26 E NMPM					
21. Elevations (Show whether DF, RT, etc.) 3358 K B					
21A. Kind & Status Plug. Bond Blanket					
21B. Drilling Contractor C.O. Fulton					
22. Approx. Date Work will start 9-5-69					

PROPOSED CASING AND CEMENT PROGRAM

SIZE OF HOLE	SIZE OF CASING	WEIGHT PER FOOT	SETTING DEPTH	SACKS OF CEMENT	EST. TOP
11"	8 5/8	24 lb.	1252	300	Circ.

as #1 Marathon A.M. State
This well was originally drilled by Yates Petroleum to a t.d. of 9,300'
And has been plugged & abanded. *RA approved 1-13-69*
I plan to re-enter this well & set 5 1/2" casing to 1800' & attempt to
complete in the San Andres section at approximately 1650'

APPROVAL VALID
FOR 90 DAYS UNLESS
DRILLING COMMENCED,
EXPIRES **12-4-69**

IN ABOVE SPACE DESCRIBE PROPOSED PROGRAM: IF PROPOSAL IS TO DEEPEN OR PLUG BACK, GIVE DATA ON PRESENT PRODUCTIVE ZONE AND PROPOSED NEW PRODUCTIVE ZONE. GIVE BLOWOUT PREVENTER PROGRAM, IF ANY.

I hereby certify that the information above is true and complete to the best of my knowledge and belief.

Signed *C.O. Fulton* Title Owner Date 9-5-69

(This space for State Use)
APPROVED BY *W.A. Gusselt* TITLE OIL AND GAS INSPECTOR DATE SEP 5 1969

CONDITIONS OF APPROVAL, IF ANY:
Cement behind the 5 1/2" cas. must come up at least 50' inside the 8 5/8"

NEW MEXICO OIL CONSERVATION COMMISSION
WELL LOCATION AND ACREAGE DEDICATION PLAT

Form C-102
Supersedes C-128
Effective 1-4-65

All distances must be from the outer boundaries of the Section.

Operator C.O. Fulton			Lease L-14552 State			Well No. 1
Unit Letter P	Section 16	Township 18 South	Range 26 East	County Eddy		
Actual Footage Location of Well: 990 feet from the South line and 990 feet from the east line						
Ground Level Elev. 3358	Producing Formation San Andres		Pool Atoka		Dedicated Acreage: 40 Acres	

1. Outline the acreage dedicated to the subject well by colored pencil or hachure marks on the plat below.
2. If more than one lease is dedicated to the well, outline each and identify the ownership thereof (both as to working interest and royalty).
3. If more than one lease of different ownership is dedicated to the well, have the interests of all owners been consolidated by communitization, unitization, force-pooling, etc?

☐ Yes ☐ No If answer is "yes," type of consolidation **C. O. C. AREA, OFFICE**

If answer is "no," list the owners and tract descriptions which have actually been consolidated. (Use reverse side of this form if necessary.)

No allowable will be assigned to the well until all interests have been consolidated (by communitization, unitization, forced-pooling, or otherwise) or until a non-standard unit, eliminating such interests, has been approved by the Commission.

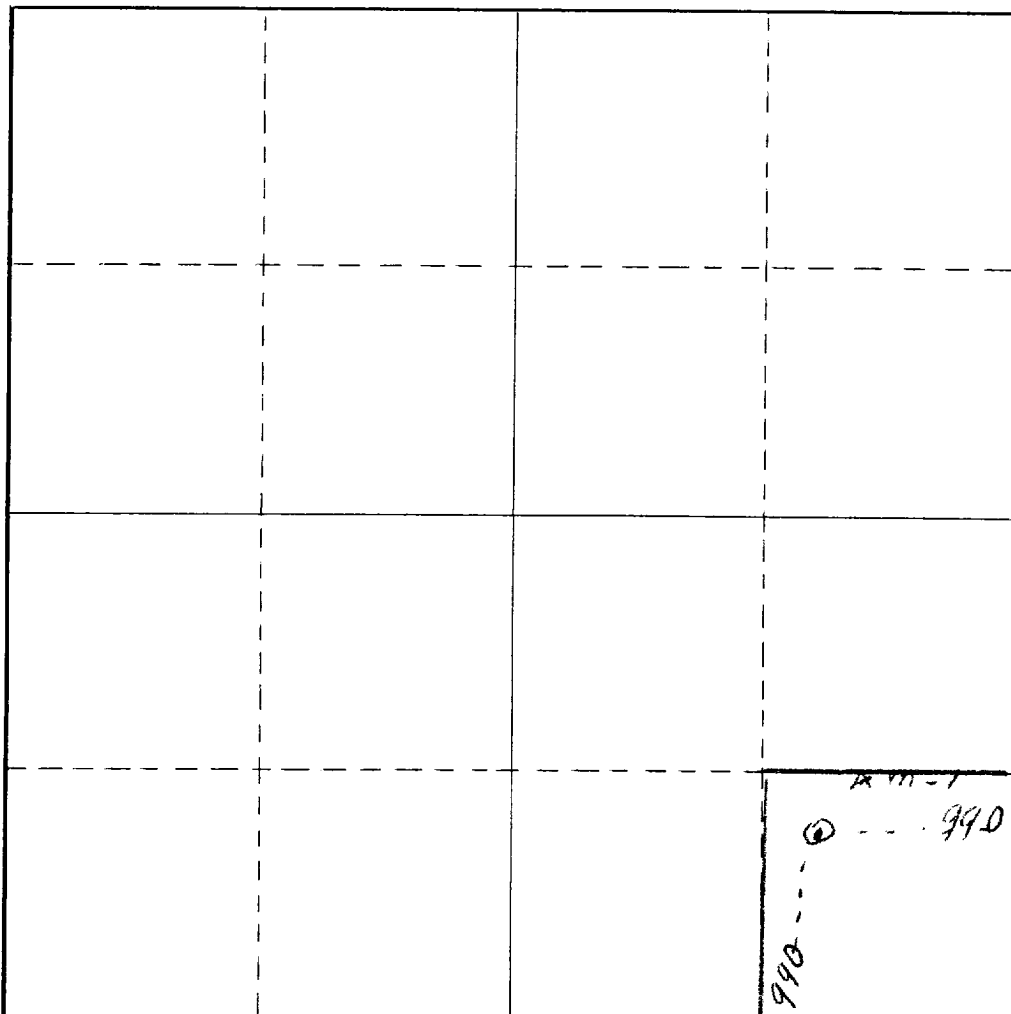

CERTIFICATION

I hereby certify that the information contained herein is true and complete to the best of my knowledge and belief.

Name
C. O. Fulton
Position
Owner
Company
C.O. Fulton
Date
9-5-69

I hereby certify that the well location shown on this plat was plotted from field notes of actual surveys made by me or under my supervision, and that the same is true and correct to the best of my knowledge and belief.

Date Surveyed
April 6, 1964
Registered Professional Engineer and/or Land Surveyor
Original

James H. Brown
Certificate No.
N.M.L.S. No. 542

0 330 660 990 1320 1650 1980 2310 2640 2000 1500 1000 500 0