

NEW MEXICO OIL CONSERVATION COMMISSION
Well Location and Acreage Dedication Plat

Section A.

Date May 19, 1959

Operator Granridge Corporation Lease Basler Yates State
Well No. 341 Unit Letter H Section 29 Township 18S Range 28E NMPM
Located 990 Feet From South Line, 1650 Feet From West Line
County Eddy G. L. Elevation 3546 Dedicated Acreage _____ Acres
Name of Producing Formation 1st Grayburg Pool Artesia

1. Is the Operator the only owner* in the dedicated acreage outlined on the plat below?
Yes X No _____.
2. If the answer to question one is "no," have the interests of all the owners been consolidated by communitization agreement or otherwise? Yes _____ No _____. If answer is "yes," Type of Consolidation _____
3. If the answer to question two is "no," list all the owners and their respective interests below:

Owner

Land Description

_____	_____
_____	_____
_____	_____

Section B

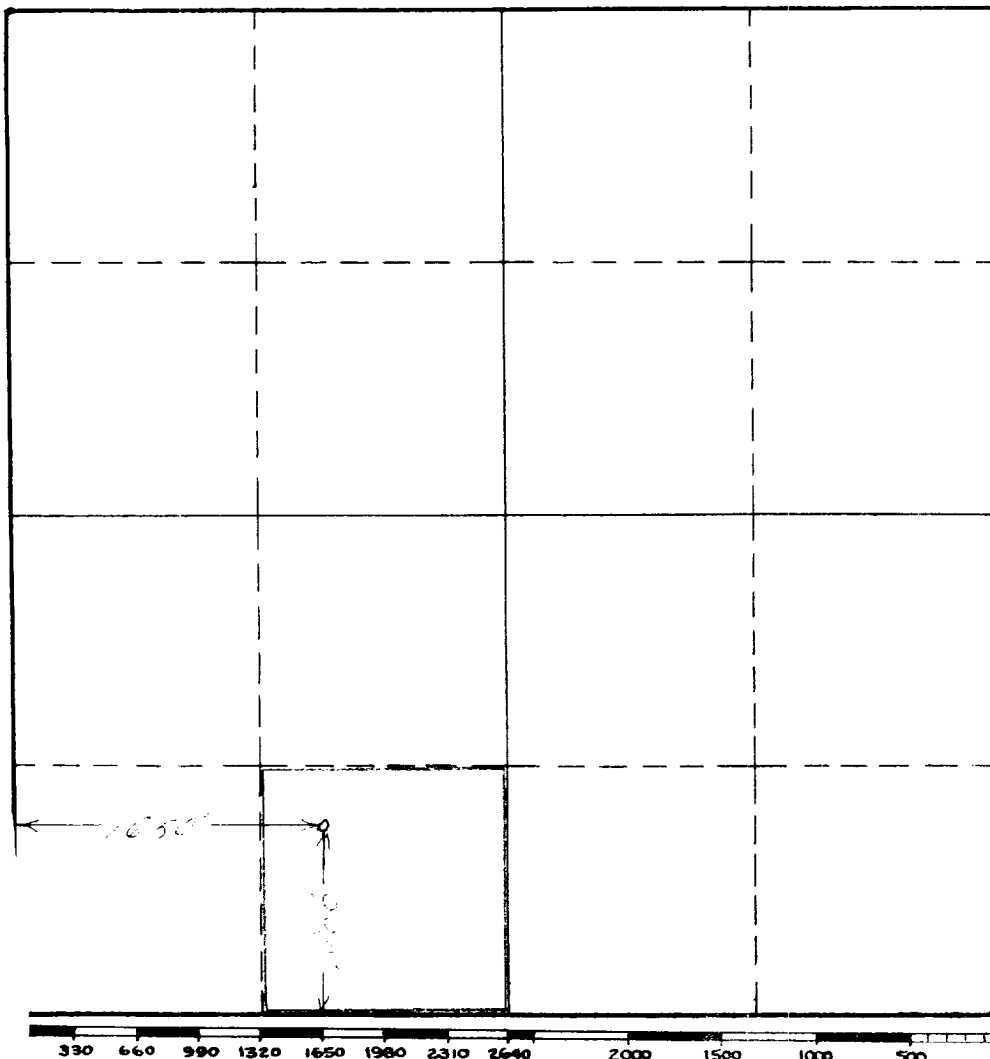

This is to certify that the information in Section A above is true and complete to the best of my knowledge and belief.

Granridge Corporation

(Operator)

Charles H. Smith
(Representative)

Breckenridge, Texas

Address

This is to certify that the well location shown on the plat in Section B was plotted from field notes of actual surveys made by me or under my supervision and that the same is true and correct to the best of my knowledge and belief.

Date Surveyed 5-23-59

W. P. Shilken
Registered Professional
Engineer and/or Land Surveyor.

Certificate No. 963

INSTRUCTIONS FOR COMPLETION:

1. Operator shall furnish and certify to the information called for in Section A.
2. Operator shall outline the dedicated acreage for both oil and gas wells on the plat in Section B.
3. A registered professional engineer or land surveyor registered in the State of New Mexico or approved by the Commission shall show on the plat the location of the well and certify this information in the space provided.
4. All distances shown on the plat must be from the outer boundaries of Section.
5. If additional space is needed for listing owners and their respective interests as required in question 3, Section A, please use space below

* "Owner" means the person who has the right to drill into and to produce from any pool and to appropriate the production either for himself or for himself and another. (65-3-29 (e) NMSA 1953 Comp.)