

NO. OF COPIES RECEIVED	7
DISTRIBUTION	
SANTA FE	1
FILE	1
U.S.G.S.	2
LAND OFFICE	1
OPERATOR	2

NEW MEXICO OIL CONSERVATION COMMISSION

Form C-101
Revised 1-1-65

5A. Indicate Type of Lease	
STATE <input checked="" type="checkbox"/>	FEE <input type="checkbox"/>
5. State Oil & Gas Lease No.	
R-2211	

APPLICATION FOR PERMIT TO DRILL, DEEPEN, OR PLUG BACK

1a. Type of Work		7. Unit Agreement Name	
b. Type of Well OIL WELL <input checked="" type="checkbox"/> GAS WELL <input type="checkbox"/> OTHER <input type="checkbox"/>		8. Farm or Lease Name State	
2. Name of Operator Harvey E. Yates		9. Well No. 2	
3. Address of Operator 305 Carper Bldg., Artesia, New Mexico		10. Field and Popl. or Wildcat North Benson Queen	
4. Location of Well UNIT LETTER B LOCATED 2310 FEET FROM THE East LINE AND 330 FEET FROM THE North LINE OF SEC. 32 TWP. 18S RGE. 30E NMPM		12. County Eddy	
19. Proposed Depth 3000		19A. Formation Queen	
20. Rotary or C.T. Cable tools		21. Elevations (Show whether DF, RT, etc.)	
21A. Kind & Status Plug. Bond Nationwide		21B. Drilling Contractor Harvey E. Yates	
22. Approx. Date Work will start 12-10-65			

23.

PROPOSED CASING AND CEMENT PROGRAM

SIZE OF HOLE	SIZE OF CASING	WEIGHT PER FOOT	SETTING DEPTH	SACKS OF CEMENT	EST. TOP
10"	8-5/8"	24#	500'	50	
8"	5-1/2"	15#	T.D.	100	

We intend to drill with cable tools a well to test the Queen section.

We will set 10-3/4" csg at approx. 380' if hole will not stand up. Then drill to top of salt section; run 8-5/8" csg. Pull 10-3/4" csg and cement the 8-5/8" csg. Then drill to total depth with 8" tools. Run 5-1/2" csg if commercial production is encountered.

APPROVAL VALID
FOR 90 DAYS UNLESS
DRILLING COMMENCED,

EXPIRES 2-28-66

RECEIVED

DEC 1 1965

IN ABOVE SPACE DESCRIBE PROPOSED PROGRAM: IF PROPOSAL IS TO DEEPEN OR PLUG BACK, GIVE DATA ON PRESENT PRODUCTIVE ZONE AND PROPOSED NEW PRODUCTIVE ZONE. GIVE BLOWOUT PREVENTER PROGRAM, IF ANY.

I hereby certify that the information above is true and complete to the best of my knowledge and belief.

Signed [Signature] Title Bookkeeper Date November 30, 1965

(This space for State Use)

APPROVED BY [Signature] TITLE OIL AND GAS INSPECTOR DATE DEC 1 1965

CONDITIONS OF APPROVAL, IF ANY:

NEW MEXICO OIL CONSERVATION COMMISSION
WELL LOCATION AND ACREAGE DEDICATION PLAT

Form C-102
Supersedes C-128
Effective 1-1-65

All distances must be from the outer boundaries of the Section.

Operator Harvey E. Yates		Lease State		Well No. 2
Unit Letter B	Section 32	Township 18S	Range 30E	County Eddy
Actual Footage Location of Well: 2310 feet from the East line and 330 feet from the North line				
Ground Level Elev:	Producing Formation Queen	Pool under North Benson Queen	Dedicated Acreage: 40 Acres	

1. Outline the acreage dedicated to the subject well by colored pencil or hachure marks on the plat below.
2. If more than one lease is dedicated to the well, outline each and identify the ownership thereof (both as to working interest and royalty).
3. If more than one lease of different ownership is dedicated to the well, have the interests of all wells be consolidated by communitization, unitization, force-pooling, etc?

☐ Yes ☐ No If answer is "yes," type of consolidation DEC 1 1965

If answer is "no," list the owners and tract descriptions which have actually been consolidated and use reverse side of this form if necessary.) ARTESIA, OFFICE

No allowable will be assigned to the well until all interests have been consolidated (by communitization, unitization, forced-pooling, or otherwise) or until a non-standard unit, eliminating such interests, has been approved by the Commission.

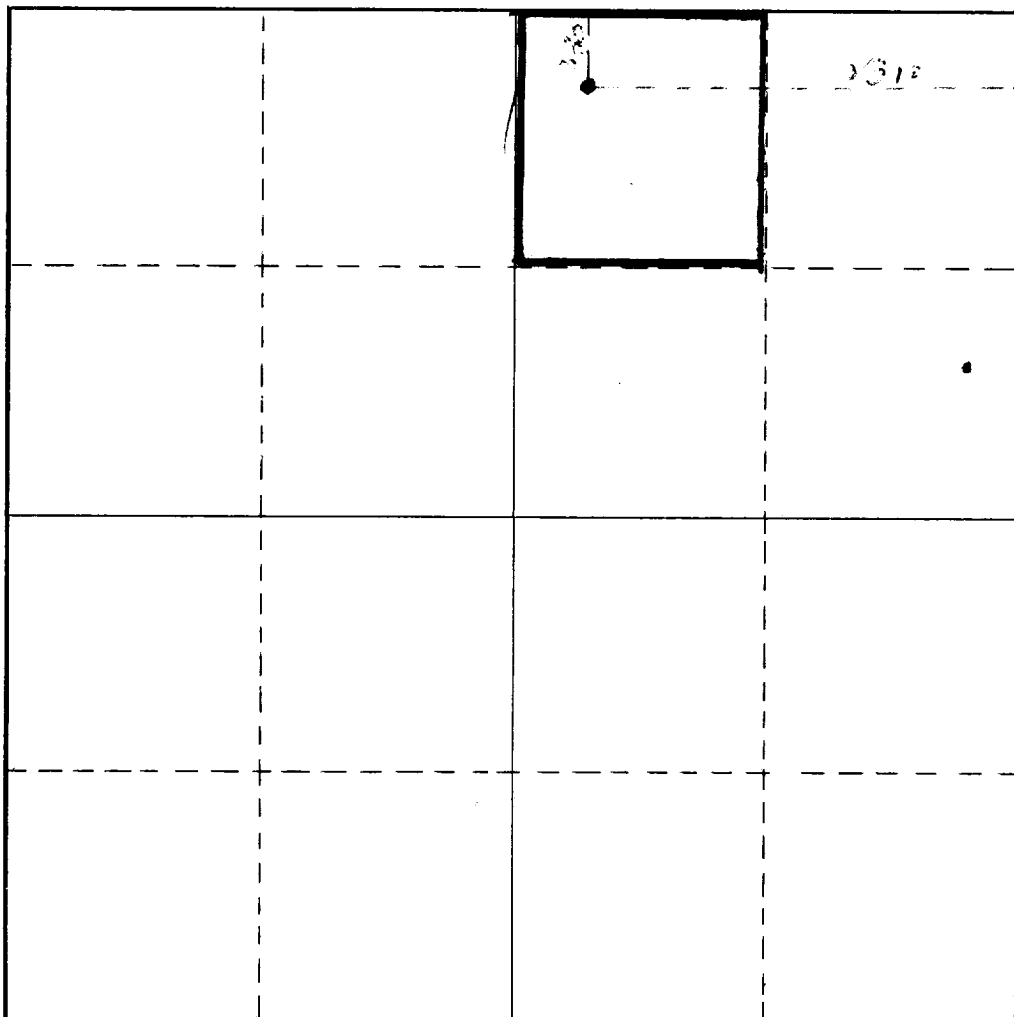

CERTIFICATION

I hereby certify that the information contained herein is true and complete to the best of my knowledge and belief.

Name
Harvey E. Yates
Position
Bookkeeper
Company
Harvey E. Yates
Date
November 30, 1965

I hereby certify that the well location shown on this plat was plotted from field notes of actual surveys made by me or under my supervision, and that the same is true and correct to the best of my knowledge and belief.

Date Surveyed
November 27, 1965
Registered Professional Engineer and/or Land Surveyor

Harvey E. Yates
Certificate No.
772



