

UNITED STATES
DEPARTMENT OF THE INTERIOR
GEOLOGICAL SURVEY(Other instructions on
reverse side)

APPLICATION FOR PERMIT TO DRILL, DEEPEN, OR PLUG BACK

1a. TYPE OF WORK

DRILL ☒DEEPEN ☐PLUG BACK ☐

b. TYPE OF WELL

OIL
WELL ☐GAS
WELL ☐

OTHER

SINGLE
ZONE ☐MULTIPLE
ZONE ☐

2. NAME OF OPERATOR

Yates Petroleum Corporation

3. ADDRESS OF OPERATOR

309 Carper Building-Artesia, New Mexico 88210

4. LOCATION OF WELL (Report location clearly and in accordance with any State requirements.)*

At surface 2310 FNL, 1980' FWL Sec. 25-18S-25E

At proposed prod. zone San Andres Yeso

14. DISTANCE IN MILES AND DIRECTION FROM NEAREST TOWN OR POST OFFICE*

11 South - Artesia, New Mexico

10. DISTANCE FROM PROPOSED*

LOCATION TO NEAREST
PROPERTY OR LEASE LINE, FT.
(Also to nearest drlg. unit line, if any)

16. NO. OF ACRES IN LEASE

40

17. NO. OF ACRES ASSIGNED
TO THIS WELL

40

18. DISTANCE FROM PROPOSED LOCATION*
TO NEAREST WELL, DRILLING, COMPLETED,
OR APPLIED FOR, ON THIS LEASE, FT.

19. PROPOSED DEPTH

3000 (est.)

20. ROTARY OR CABLE TOOLS

Rotary

21. ELEVATIONS (Show whether DF, RT, GR, etc.)

3461 GR

22. APPROX. DATE WORK WILL START*

11-25-66

23.

PROPOSED CASING AND CEMENTING PROGRAM

SIZE OF HOLE	SIZE OF CASING	WEIGHT PER FOOT	SETTING DEPTH	QUANTITY OF CEMENT
11"	8-5/8"	24#	Approx. 1050'	Approx. 300 Sx
7-7/8"	5-1/2"	14#	" 2600'	" 100 Sx

If necessary we plan to set DV tool, if circulation is lost, on the 8-5/8' casing at the basal part of the Grayburg, to help circulate the cement to the surface.

RECEIVED

NOV 21 1966

U. S. GEOLOGICAL SURVEY

ARTESIA, NEW MEXICO

RECEIVED
NOV 21 1966
U. S. GEOLOGICAL SURVEY
ARTESIA, NEW MEXICO

IN ABOVE SPACE DESCRIBE PROPOSED PROGRAM: If proposal is to deepen or plug back, give data on present productive zone and proposed new productive zone. If proposal is to drill or deepen directionally, give pertinent data on subsurface locations and measured and true vertical depths. Give blowout preventer program, if any.

24.

SIGNED

Richard C. Norman

TITLE

Geologist

DATE

11-21-66

(This space for Federal or State office use)

PERMIT NO.

DECLARED WATER BASH
C'MENT BEHIND THE
CASING MUST BE CIRCULATEDNOTIFY USGS IN SUFFICIENT TIME TO
SETTING DV ToolNOTIFY USGS IN SUFFICIENT TIME TO
WITNESS CEMENTING THE CASING.
all casing

*See Instructions On Reverse Side

APPROVED
NOV 23 1966
R. L. BEEKMAN
ACTING DISTRICT ENGINEER

NEW MEXICO OIL CONSERVATION COMMISSION
WELL LOCATION AND ACREAGE DEDICATION PLAT

Form C-102
Supersedes C-128
Effective 1-1-65

All distances must be from the outer boundaries of the Section.

Operator Yates Petroleum Corporation		Lease "AY" Federal "AY"		Well No. 1
Unit Letter F	Section 25	Township 18 North	Range 25 East	County Deer
Actual Footage Location of Well: 2310' feet from the North line and 1980' feet from the West line				
Ground Level Elev. 3411	Producing Formation S.A.	Pool PENASCO DRAW SA-4530	Dedicated Acreage: 1.0 Acres	

1. Outline the acreage dedicated to the subject well by colored pencil or hatchure marks on the plat below.
2. If more than one lease is dedicated to the well, outline each and identify the ownership thereof (both as to working interest and royalty).
3. If more than one lease of different ownership is dedicated to the well, have the interests of all owners been consolidated by communitization, unitization, force-pooling, etc?

☐ Yes ☐ No If answer is "yes," type of consolidation _____

If answer is "no," list the owners and tract descriptions which have actually been consolidated. (Use reverse side of this form if necessary.) _____

No allowable will be assigned to the well until all interests have been consolidated (by communitization, unitization, forced-pooling, or otherwise) or until a non-standard unit, eliminating such interests, has been approved by the Commission.

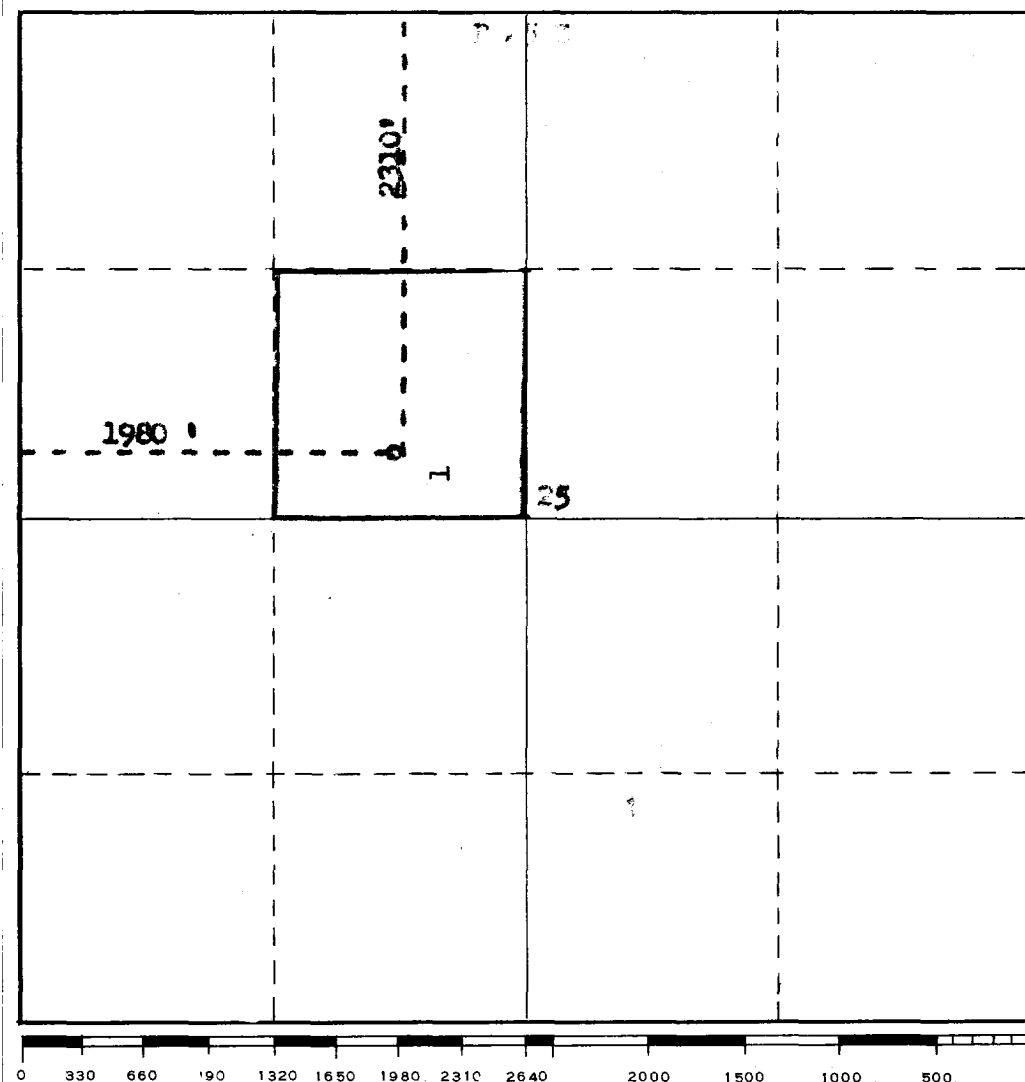

CERTIFICATION	
I hereby certify that the information contained herein is true and complete to the best of my knowledge and belief.	
<i>Richard E. Norman</i>	
Name	Geologist
Position	
Company	Yates Petroleum Corp
Date	11-21-66
I hereby certify that the well location shown on this plat was plotted from field notes of actual surveys made by me or under my supervision, and that the same is true and correct to the best of my knowledge and belief.	
Date Surveyed	11-21-66
Registered Professional Engineer and/or Land Surveyor	
<i>James H. Baker</i>	
Certificate No.	11-21-66