

NE' EXICO OIL CONSERVATION COMMISSIO
WELL LOCATION AND ACREAGE DEDICATION PLAT

Form C-102
Supersedes C-128
Effective 1-1-65

All distances must be from the outer boundaries of the Section

Operator Southwest Production Corp.			Lease Low "A" State		Well No. 1-A
First Letter H	Section 33	Township T-12-S	Range R-28-E	County Eddy	
Actual Footage Location of Well: 330 feet from the South line and 2310 feet from the West line					
Ground Level Elev. 3556	Producing Formation San Andres		Pool Artesia Hndsg.	Dedicated Acreage: 40 Acres	

- Outline the acreage dedicated to the subject well by colored pencil or hachure marks on the plat below.
- If more than one lease is dedicated to the well, outline each and identify the ownership thereof (both as to working interest and royalty).
- If more than one lease of different ownership is dedicated to the well, have the interests of all owners been consolidated by communitization, unitization, force-pooling, etc?

☐ Yes ☒ No If answer is "yes," type of consolidation Force Pooling

If answer is "no," list the owners and tract descriptions which have actually been consolidated. (Use reverse side of this form if necessary.)

No allowable will be assigned to the well until all interests have been consolidated (by communitization, unitization, forced-pooling, or otherwise) or until a non-standard unit, eliminating such interests, has been approved by the Commission.

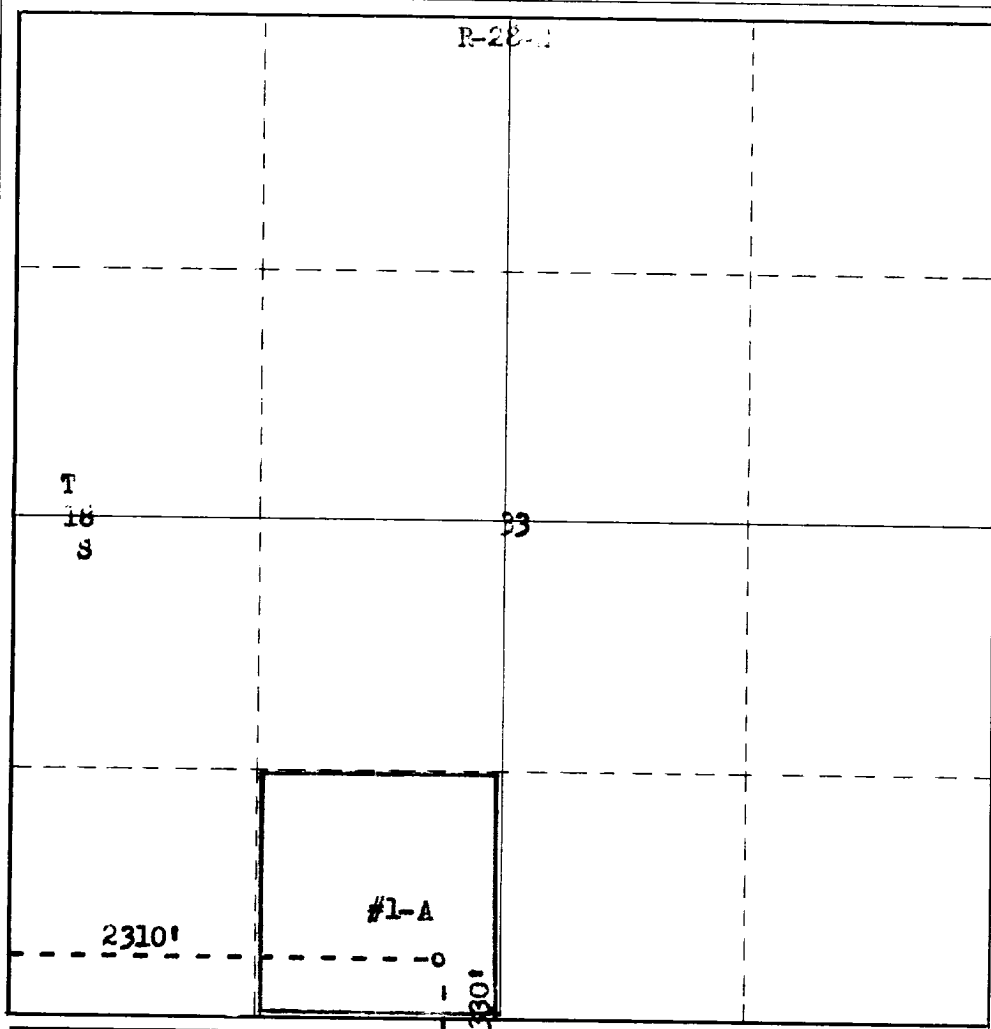

CERTIFICATION

I hereby certify that the information contained herein is true and complete to the best of my knowledge and belief.

Name Mark Clements
Position **Manager**
Company **Southwest Prod. Corp.**
Date **12/3/66**

I hereby certify that the well location shown on this plat was plotted from field notes of actual surveys made by me or under my supervision, and that the same is true and correct to the best of my knowledge and belief.

Date Surveyed **November 16, 1966**
Registered Professional Engineer and/or Land Surveyor

James H. Brown
Certificate No.

542