

030-15-10906

NO. OF COPIES RECEIVED	6
DISTRIBUTION	
SANTA FE	1
FILE	1
U.S.G.S.	2
LAND OFFICE	1
OPERATOR	1

NEW MEXICO OIL CONSERVATION COMMISSION

Form C-101
Revised 1-1-65

APPROVAL VALID
FOR 90 DAYS UNLESS
DRILLING COMMENCED,

EXPIRES 3-29-67

5A. Indicate Type of Lease STATE <input checked="" type="checkbox"/> FEE <input type="checkbox"/>
5. State Oil & Gas Lease No. E-9262
7. Unit Agreement Name -----
8. Farm or Lease Name State of New Mexico "CY" NCT-1
9. Well No. 3
10. Field and Pool, or Wildcat North Benson Queen
12. County Eddy
19. Proposed Depth 3205'
19A. Formation Queen
20. Rotary or C.T. Rotary
21. Elevations (Show whether DF, RT, etc.) GR - 3411'
21A. Kind & Status Plug. Bond \$10,000 blanket
21B. Drilling Contractor Unknown
22. Approx. Date Work will start At once

APPLICATION FOR PERMIT TO DRILL, DEEPEN, OR PLUG BACK

1a. Type of Work b. Type of Well OIL WELL <input checked="" type="checkbox"/> GAS WELL <input type="checkbox"/> OTHER <input type="checkbox"/> SINGLE ZONE <input checked="" type="checkbox"/> MULTIPLE ZONE <input type="checkbox"/>	DRILL <input checked="" type="checkbox"/> DEEPEN <input type="checkbox"/> PLUG BACK <input type="checkbox"/>
2. Name of Operator TEXACO INC.	
3. Address of Operator P. O. BOX 3109, MIDLAND, TEXAS 79701	
4. Location of Well UNIT LETTER <u>F</u> LOCATED <u>1980</u> FEET FROM THE <u>North</u> LINE AND <u>1980</u> FEET FROM THE <u>West</u> LINE OF SEC. <u>32</u> TWP. <u>18S</u> RGE. <u>30E</u> NMPM	
23. PROPOSED CASING AND CEMENT PROGRAM	

SIZE OF HOLE	SIZE OF CASING	WEIGHT PER FOOT	SETTING DEPTH	SACKS OF CEMENT	EST. TOP
9 7/8"	7 5/8"	24#, 15.28#	475'	*400	250% to circ.
6 3/4"	4 1/2"	10.5#	3205'	**800	300% to circ.

*Cement with 400 sx Class "C" neat (250% to circ.). Cement must circulate.

**Cement with 500 sx TLW w/10% salt, 12.2#/gal followed by 300 sx Class "C" salt saturated 14.8#/gal (300% to circ.).

COMPLETION REPORT

1. Selectively perf. pay w/2 jsapi. 2. Treat w/1500 gals 15% N.E. acid staged w/ball sealers.
 3. Frac w/30,000 gals refined oil w/40,000# of sand. Stage w/ball sealers. Max pres. 4400 psi.

FORMATION TOPS EXPECTED

Anhydrite 260'
 Base of Salt 1270'

RECEIVED

Queen 2580'
 Total Depth 3205'

DEC 30 1966

O. C. C.
ARTERIAL SERVICE

IN ABOVE SPACE DESCRIBE PROPOSED PROGRAM: IF PROPOSAL IS TO DEEPEN OR PLUG BACK, GIVE DATA ON PRESENT PRODUCTIVE ZONE AND PROPOSED NEW PRODUCTIVE ZONE. GIVE BLOWOUT PREVENTER PROGRAM, IF ANY.

I hereby certify that the information above is true and complete to the best of my knowledge and belief.

Signed W. M. Dampass Title Senior Civil Engineer Date 12/29/66
W. M. Dampass
 (This space for State Use)

APPROVED BY W. A. Gressett TITLE OIL AND GAS INSPECTOR DATE DEC 30 1966

CONDITIONS OF APPROVAL, IF ANY:

**MEXICO OIL CONSERVATION COMMISSION
WELL LOCATION AND ACREAGE DEDICATION PLAT**

Form C-102
Supersedes C-128
Effective 1-1-65

All distances must be from the outer boundaries of the Section.

Operator TEXACO Inc.			Lease State of New Mexico "CY" NCT-1		Well No. 3
Unit Letter F	Section 32	Township 18 South	Range 30 East	County Eddy	
Actual Footage Location of Well: 1980 feet from the North line and 1980 feet from the West line Sec. 32					
Ground Level Elev. 3411	Producing Formation Queen		Pool North Benson-Queen		Dedicated Acreage: 40 Acres

1. Outline the acreage dedicated to the subject well by colored pencil or hachure marks on the plat below.
2. If more than one lease is dedicated to the well, outline each and identify the ownership thereof (both as to working interest and royalty).
3. If more than one lease of different ownership is dedicated to the well, have the interests of all owners be consolidated by communitization, unitization, force-pooling, etc?

RECEIVED

☐ Yes ☐ No If answer is "yes," type of consolidation DEC 30 1966

If answer is "no," list the owners and tract descriptions which have actually been consolidated. (Use reverse side of this form if necessary.) ARTISIA, OILFIELD

No allowable will be assigned to the well until all interests have been consolidated (by communitization, unitization, forced-pooling, or otherwise) or until a non-standard unit, eliminating such interests, has been approved by the Commission.

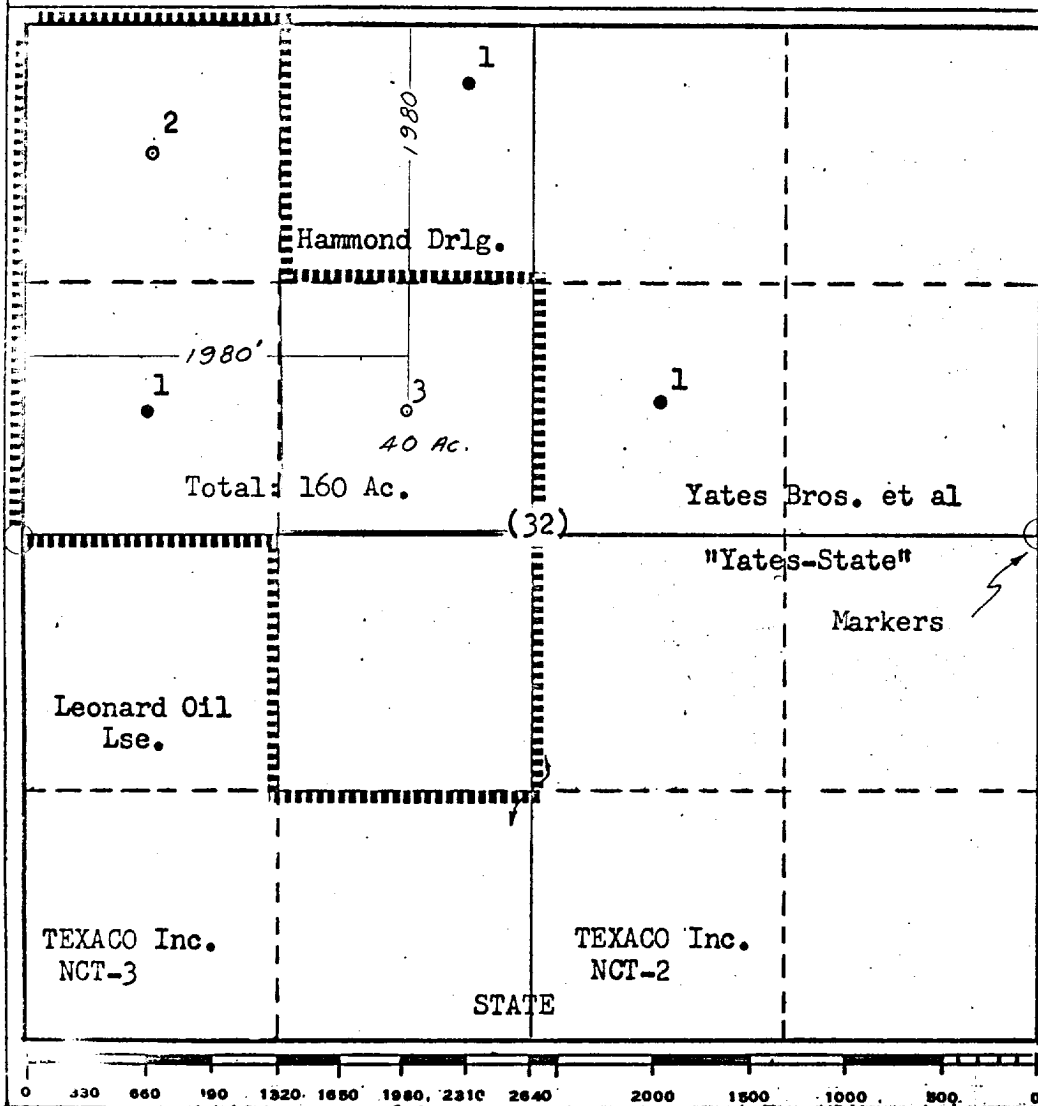

CERTIFICATION

I hereby certify that the information contained herein is true and complete to the best of my knowledge and belief.

Name
T. G. Landwermeyer
Position
Civil Engineer
Company
TEXACO Inc.

Date
12/29/66

I hereby certify that the well location shown on this plat was plotted from field notes of actual surveys made by me or under my supervision, and that the same is true and correct to the best of my knowledge and belief.

Date Surveyed
12/28/66

Registered Professional Engineer and/or Land Surveyor

T. G. Landwermeyer

Certificate No. **17617**