

| | |
|---------------------|----|
| NO. COPIES RECEIVED | 6 |
| DISTRIBUTION | |
| SANTA FE | 1 |
| FILE | 1- |
| U.S.G.S. | 2 |
| LAND OFFICE | |
| OPERATOR | 2 |

NEW MEXICO OIL CONSERVATION COMMISSION

Form C-101
Revised 1-1-65

| | |
|--------------------------------|---|
| 5A. Indicate Type of Lease | |
| STATE <input type="checkbox"/> | FEE <input checked="" type="checkbox"/> |

5. State Oil & Gas Lease No.

APPLICATION FOR PERMIT TO DRILL, DEEPEN, OR PLUG BACK

| | | | |
|--|--|---|--|
| 1a. Type of Work | | 7. Unit Agreement Name | |
| b. Type of Well DRILL <input checked="" type="checkbox"/> DEEPEN <input type="checkbox"/> PLUG BACK <input type="checkbox"/> OIL WELL <input checked="" type="checkbox"/> GAS WELL <input type="checkbox"/> OTHER <input type="checkbox"/> SINGLE ZONE <input type="checkbox"/> MULTIPLE ZONE <input type="checkbox"/> | | 8. Farm or Lease Name Hornbaker "BA" | |
| 2. Name of Operator Yates Petroleum Corporation | | 9. Well No. 1 | |
| 3. Address of Operator 309 Carper Building - Artesia, New Mexico 88210 | | 10. Field and Pool, or Wildcat Penasco Draw S.A. Yes | |
| 4. Location of Well UNIT LETTER G LOCATED 1900 FEET FROM THE North LINE AND 1650 FEET FROM THE East LINE OF SEC. 25 TWP. 18S RGE. 25E NMPM | | 12. County Eddy | |
| 19. Proposed Depth Approx. 2800' | | 19A. Formation S.A. Yeso | |
| 20. Rotary or C.T. Rotary | | 21. Elevations (Show whether DP, RT, etc.) 3456' GL | |
| 21A. Kind & Status Plug. Bond Blanket Bond | | 21B. Drilling Contractor Unknown | |
| 22. Approx. Date Work will start Unknown | | 23. | |

PROPOSED CASING AND CEMENT PROGRAM

| SIZE OF HOLE | SIZE OF CASING | WEIGHT PER FOOT | SETTING DEPTH | SACKS OF CEMENT | EST. TOP |
|--------------|----------------|-----------------|---------------|----------------------|----------|
| 13-3/4" | 9-5/8" OD | 32.30# H-40 | 1000 | Circulate to surface | |
| 8-3/4" | 7" OD | 14# H-40 | 2150 | 150 | |

If circulation is lost a DV tool and/or baskets will be set in the 9-5/8" casing string in order to circulate the cement to the surface.

APPROVAL VALID
FOR 90 DAYS UNLESS
DRILLING COMMENCED

EXPIRES 4-24-67

RECEIVED

JAN 25 1967

O. C. C.
ARTESIA, OFFICE

IN ABOVE SPACE DESCRIBE PROPOSED PROGRAM: IF PROPOSAL IS TO DEEPEN OR PLUG BACK, GIVE DATA ON PRESENT PRODUCTIVE ZONE AND PROPOSED NEW PRODUCTIVE ZONE. GIVE BLOWOUT PREVENTER PROGRAM, IF ANY.

I hereby certify that the information above is true and complete to the best of my knowledge and belief.

Signed Richard C. Norman Title Geologist Date 1-24-67

(This space for State Use)

APPROVED BY W.A. Gressett TITLE OIL AND GAS INSPECTOR

DATE JAN 25 1967

CONDITIONS OF APPROVAL, IF ANY:

all casing must be set and cemented in
compliance with Rules 2, 3 & 5 of Order R 3169

Notify N.M.O.C.C. in sufficient
time to witness cementing
the 9 7/8" casing

N MEXICO OIL CONSERVATION COMMISSION
WELL LOCATION AND ACREAGE DEDICATION PLAT

Form C-102
Supersedes C-128
Effective 1-1-65

All distances must be from the outer boundaries of the Section.

| | | | | | |
|--|---------------------------------------|------------------------------|-------------------------------------|---------------------------------------|--|
| Operator Yates Petroleum Corporation | | Lease Hornbaker BA | | Well No. 1 | |
| Unit Letter G | Section 25 | Township 18 South | Range 25 East | County Eddy | |
| Actual Footage Location of Well: 1000 feet from the North line and 1650 feet from the East line | | | | | |
| Ground Level Elev. 315' | Producing Formation SA yeso | | Pool Penasco Draw SA yeso | Dedicated Acreage: 40 Acres | |

1. Outline the acreage dedicated to the subject well by colored pencil or hachure marks on the plat below.
2. If more than one lease is dedicated to the well, outline each and identify the ownership thereof (both as to working interest and royalty).
3. If more than one lease of different ownership is dedicated to the well, have the interests of all owners been consolidated by communitization, unitization, force-pooling, etc?

☐ Yes ☐ No If answer is "yes," type of consolidation RECEIVED JAN 25 1967

If answer is "no," list the owners and tract descriptions which have actually been consolidated (Use reverse side of this form if necessary.) ARTERIA, OFFICE

No allowable will be assigned to the well until all interests have been consolidated (by communitization, unitization, forced-pooling, or otherwise) or until a non-standard unit, eliminating such interests, has been approved by the Commission.

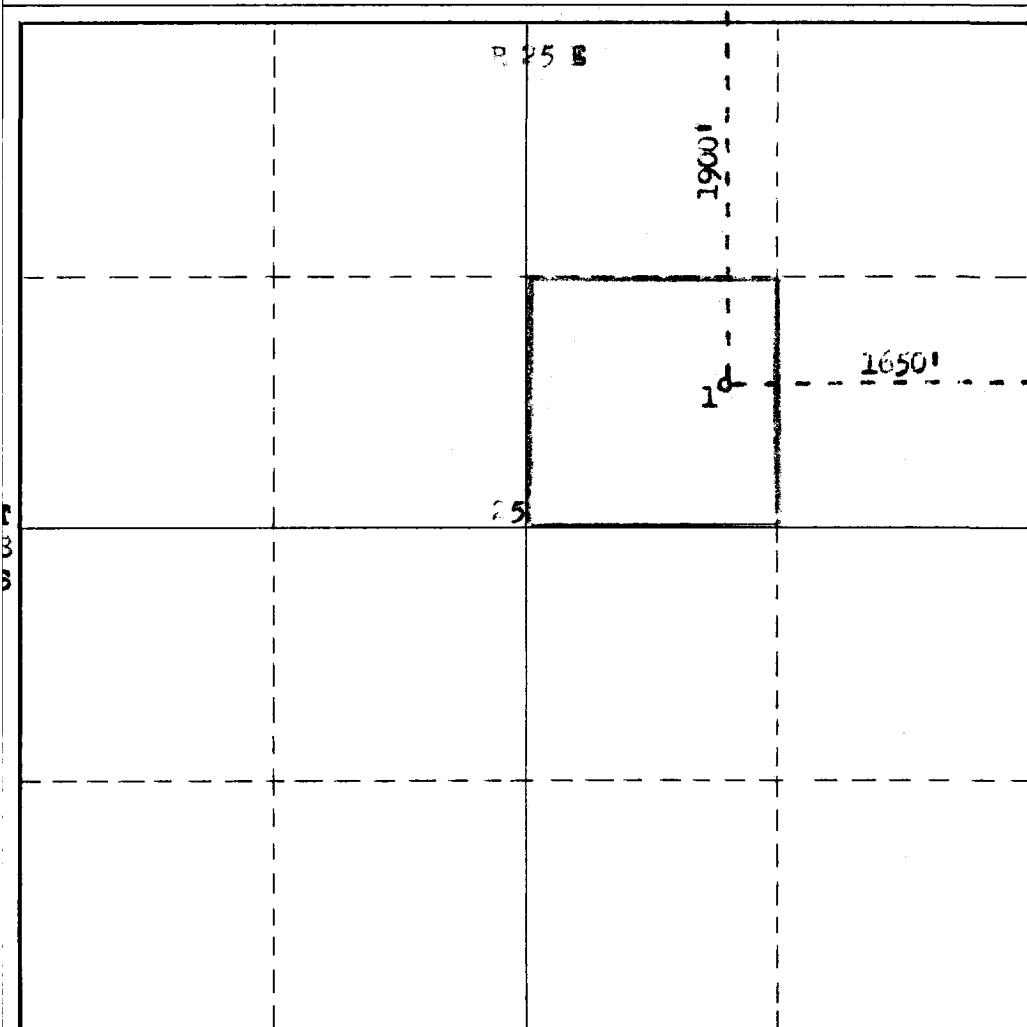

CERTIFICATION

I hereby certify that the information contained herein is true and complete to the best of my knowledge and belief.

Richard C. Norman

Name

Richard C. Norman

Position

Geologist

Company

Yates Petroleum Corp.

Date

1-24-67

I hereby certify that the well location shown on this plat was plotted from field notes of actual surveys made by me or under my supervision, and that the same is true and correct to the best of my knowledge and belief.

Date Surveyed

January 10 1967
Registered Professional Engineer
and/or Land Surveyor
542

James H. Brown
Certificate No.

N.M.L.S. No. 542

