

NO. OF COPIES RECEIVED	6
DISTRIBUTION	
SANTA FE	1
FILE	1-
U.S.G.S.	2
LAND OFFICE	
OPERATOR	2

NEW MEXICO OIL CONSERVATION COMMISSION

Form C-101
Revised 1-1-65

5A. Indicate Type of Lease
STATE <input type="checkbox"/> FEE <input checked="" type="checkbox"/>

5. State Oil & Gas Lease No.

APPLICATION FOR PERMIT TO DRILL, DEEPEN, OR PLUG BACK

1a. Type of Work		7. Unit Agreement Name	
b. Type of Well DRILL <input checked="" type="checkbox"/> DEEPEN <input type="checkbox"/> PLUG BACK <input type="checkbox"/> OIL WELL <input checked="" type="checkbox"/> GAS WELL <input type="checkbox"/> OTHER <input type="checkbox"/> SINGLE ZONE <input type="checkbox"/> MULTIPLE ZONE <input type="checkbox"/>		8. Farm or Lease Name Yates "AS" Fee	
2. Name of Operator Yates Petroleum Corporation		9. Well No. 2	
3. Address of Operator 309 Carper Building - Artesia, New Mexico 88210		10. Field and Pool, or Wildcat Penasco Draw S.A. Yeso	
4. Location of Well UNIT LETTER L LOCATED 2310 FEET FROM THE South LINE AND 990 FEET FROM THE West LINE OF SEC. 25 TWP. 18S RGE. 25E NMPM		12. County Eddy	
19. Proposed Depth Approx. 2800		19A. Formation S.A. Yeso	
20. Rotary or C.T. Rotary		21. Elevations (Show whether DT, RT, etc.) 3465' .GL	
21A. Kind & Status Plug. Bond Blanket Bond		21B. Drilling Contractor Unknown	
22. Approx. Date Work will start Unknown			

PROPOSED CASING AND CEMENT PROGRAM

SIZE OF HOLE	SIZE OF CASING	WEIGHT PER FOOT	SETTING DEPTH	SACKS OF CEMENT	EST. TOP
13-3/4"	9-5/8" OD	32.30 H-40	1000'	Circulate to surface	
8-3/4"	7" OD	17# H-40	2150'	150	

If lost circulation is encountered, a DV tool and/or baskets will be set in the 9-5/8" casing string in order to circulate the cement to the surface.

APPROVAL VALID
FOR 90 DAYS UNLESS
DRILLING COMMENCED

EXPIRES 4-24-67

RECEIVED

JAN 25 1967

O. C. C.
ARTESIA, OFFICE

IN ABOVE SPACE DESCRIBE PROPOSED PROGRAM: IF PROPOSAL IS TO DEEPEN OR PLUG BACK, GIVE DATA ON PRESENT PRODUCTIVE ZONE AND PROPOSED NEW PRODUCTIVE ZONE. GIVE BLOWOUT PREVENTER PROGRAM, IF ANY.

I hereby certify that the information above is true and complete to the best of my knowledge and belief.

Signed Richard C. Norman Title Geologist Date 1-24-67

(This space for State Use)

APPROVED BY W. A. Gressett TITLE OIL AND GAS INSPECTOR

DATE

JAN 25 1967

CONDITIONS OF APPROVAL, IF ANY:

all casing must be set and cemented in compliance with Rules 2, 3 & 5 of Order R-3169

Notify N.M.O.C.C. in sufficient time to witness cementing the 9 5/8" casing.

**N MEXICO OIL CONSERVATION COMMISSION
WELL LOCATION AND ACREAGE DEDICATION PLAT**

Form C-102
Supersedes C-128
Effective 1-1-65

All distances must be from the outer boundaries of the Section.

Operator Yates Petroleum Corporation			Lease Yates "AS" Free		Well No. 2
Unit Letter L	Section 25	Township 18 South	Range 25 East	County Eddy	
Actual Footage Location of Well: 2310 feet from the South line and 990 feet from the West line					
Ground Level Elev. 3465	Producing Formation S. A. Yeso		Pool Penasco Draw SA Yeso		Dedicated Acreage: 40 Acres

1. Outline the acreage dedicated to the subject well by colored pencil or hachure marks on the plat below.
2. If more than one lease is dedicated to the well, outline each and identify the ownership thereof (both as to working interest and royalty).
3. If more than one lease of different ownership is dedicated to the well, have the interests of all owners been consolidated by communitization, unitization, force-pooling, etc?

☐ Yes ☐ No If answer is "yes," type of consolidation _____

JAN 25 1967

If answer is "no," list the owners and tract descriptions which have actually been consolidated (Use reverse side of this form if necessary.) _____

No allowable will be assigned to the well until all interests have been consolidated (by communitization, unitization, forced-pooling, or otherwise) or until a non-standard unit, eliminating such interests, has been approved by the Commission.

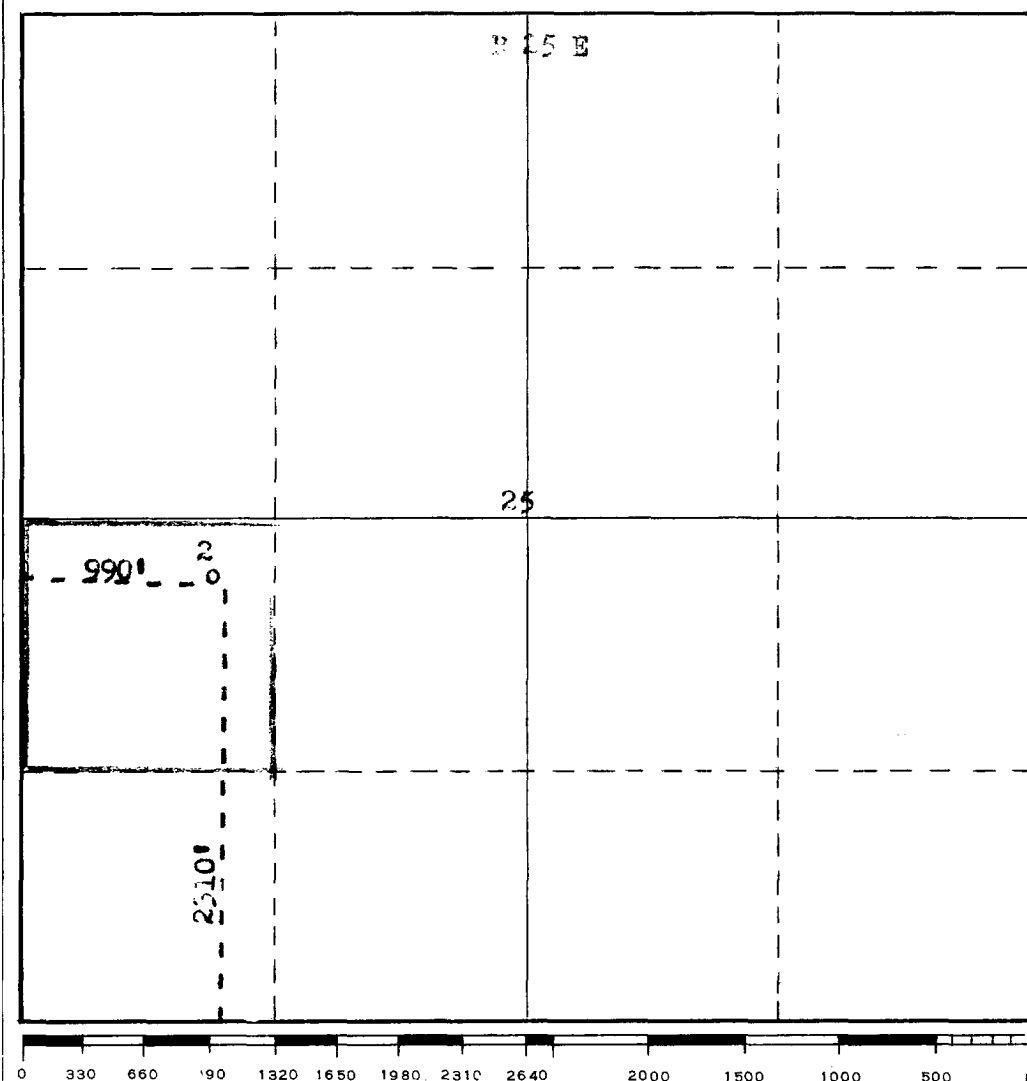

CERTIFICATION

I hereby certify that the information contained herein is true and complete to the best of my knowledge and belief.

Richard C. Norman

Name

Richard C. Norman

Position

Geologist

Company

Yates Petroleum Corp

Date

1-24-67

I hereby certify that the well location shown on this plat was plotted from field notes of actual surveys made by me or under my supervision, and that the same is true and correct to the best of my knowledge and belief.

Date Surveyed

January 10, 1967

Registered Professional Engineer and/or Land Surveyor

Certificate No.

