

NO. OF COPIES RECEIVED	6
DISTRIBUTION	
SANTA FE	1
FILE	1
U.S.G.S.	2
LAND OFFICE	1
OPERATOR	1

# NEW MEXICO OIL CONSERVATION COMMISSION

Form C-101  
Revised 1-1-65

5A. Indicate Type of Lease	
STATE <input checked="" type="checkbox"/>	FEE <input type="checkbox"/>
5. State Oil & Gas Lease No. <b>647</b>	

## APPLICATION FOR PERMIT TO DRILL, DEEPEN, OR PLUG BACK

1a. Type of Work		7. Unit Agreement Name	
b. Type of Well DRILL <input checked="" type="checkbox"/> DEEPEN <input type="checkbox"/> PLUG BACK <input type="checkbox"/> OIL WELL <input checked="" type="checkbox"/> GAS WELL <input type="checkbox"/> OTHER <input type="checkbox"/> SINGLE ZONE <input checked="" type="checkbox"/> MULTIPLE ZONE <input type="checkbox"/>		8. Farm or Lease Name <b>State 647</b>	
2. Name of Operator <b>DEPCO, Inc.</b>		9. Well No. <b>216</b>	
3. Address of Operator <b>Suite 204, First National Bank, Artesia, New Mexico</b>		10. Field and Pool, or Wildcat <b>Wildcat Artesia</b>	
4. Location of Well UNIT LETTER <b>A</b> LOCATED <b>330</b> FEET FROM THE <b>North</b> LINE AND <b>330</b> FEET FROM THE <b>East</b> LINE OF SEC. <b>6</b> TWP. <b>18S</b> RGE. <b>20 E.</b> NMPM		12. County <b>Eddy</b>	
21. Elevations (Show whether DF, RT, etc.) <b>3680</b>		19. Proposed Depth <b>3280</b>	19A. Formation <b>San Andres</b>
21A. Kind & Status Plug. Bond <b>Blanket</b>	21B. Drilling Contractor <b>WEK Drilling Co.</b>	20. Rotary or C.T. <b>Rotary</b>	
		22. Approx. Date Work will start <b>2-14-67</b>	

## PROPOSED CASING AND CEMENT PROGRAM

SIZE OF HOLE	SIZE OF CASING	WEIGHT PER FOOT	SETTING DEPTH	SACKS OF CEMENT	EST. TOP
11	8 5/8	24#	500	100	Circulate
7 7/8	4 1/2	11.6#	3280	300	

RECEIVED

APPROVAL VALID  
FOR 90 DAYS UNLESS  
DRILLING COMMENCED,

EXPIRES

5-9-67

FEB 9 1967

IN ABOVE SPACE DESCRIBE PROPOSED PROGRAM: IF PROPOSAL IS TO DEEPEN OR PLUG BACK, GIVE DATA ON PRESENT PRODUCTIVE ZONE AND PROPOSED NEW PRODUCTIVE ZONE. GIVE BLOWOUT PREVENTER PROGRAM, IF ANY.

I hereby certify that the information above is true and complete to the best of my knowledge and belief.

Signed Justina Title District Engineer Date February 7, 1967

(This space for State Use)

APPROVED BY W. A. Gressett TITLE OIL AND GAS INSPECTOR DATE 1967

CONDITIONS OF APPROVAL, IF ANY:

**MEXICO OIL CONSERVATION COMMISSION**  
**WELL LOCATION AND ACREAGE DEDICATION PLAT**

Form C-102  
 Supersedes C-128  
 Effective 1-1-65

All distances must be from the outer boundaries of the Section.

Operator <b>STATE 347</b>			Lease <b>STATE 347</b>		Well No. <b>216</b>
Unit Letter <b>A</b>	Section <b>6</b>	Township <b>18 South</b>	Range <b>28 East</b>	County <b>Eddy</b>	
Actual Footage Location of Well: <b>330</b> feet from the <b>North</b> line and <b>330</b> feet from the <b>East</b> line					
Ground Level Elev. <b>3680</b>	Producing Formation <b>San Andres</b>		Pool <b>Wildcat artesian</b>		Dedicated Acreage: <b>40</b> Acres

1. Outline the acreage dedicated to the subject well by colored pencil or hachure marks on the plat below.
2. If more than one lease is dedicated to the well, outline each and identify the ownership thereof (both as to working interest and royalty).
3. If more than one lease of different ownership is dedicated to the well, have the interests of all owners been consolidated by communitization, unitization, force-pooling, etc?

☐ Yes    ☐ No    If answer is "yes," type of consolidation \_\_\_\_\_ **RECEIVED FEB 9 1967**

If answer is "no," list the owners and tract descriptions which have actually been consolidated. (Use reverse side of this form if necessary.) \_\_\_\_\_ **ARTESIA, OFFICE**

No allowable will be assigned to the well until all interests have been consolidated (by communitization, unitization, forced-pooling, or otherwise) or until a non-standard unit, eliminating such interests, has been approved by the Commission.

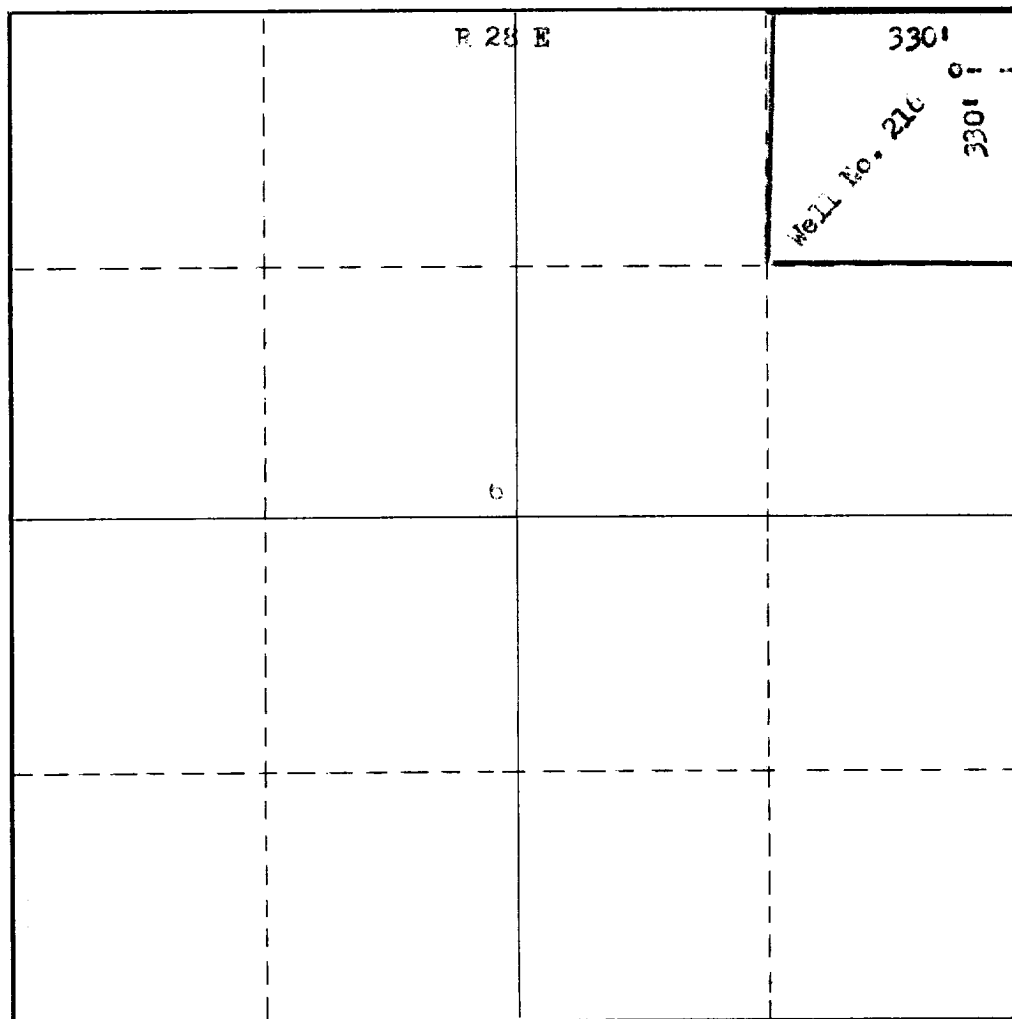

**CERTIFICATION**

I hereby certify that the information contained herein is true and complete to the best of my knowledge and belief.

Name **Janet Hard**  
 Position **Production Clerk**  
 Company **DEPCO, Inc.**  
 Date **February 7, 1967**

I hereby certify that the well location shown on this plat was plotted from field notes of actual surveys made by me or under my supervision, and that the same is true and correct to the best of my knowledge and belief.

Date Surveyed **February 7, 1967**  
 Registered Professional Engineer and/or Land Surveyor **James H. Brown**  
 Certificate No. **N.M.L.S. No. 542**

