

30-015-20023

NO. OF COPIES RECEIVED	6
DISTRICT OFFICE	1
SANTA FE	1
ALBUQUERQUE	2
LAND OFFICE	1
OPERATOR	1

NEW MEXICO CONSERVATION COMMISSION VALID Form C-101
 RECEIVED FOR 90 DAYS UNLESS revised 1-1-65
 DRILLING COMMENCED

FEB 24 1967

EXPIRES 5-24-67

Indicate Type of Lease
 STATE ☒ FEE ☐
 State Oil & Gas Lease No.
 E-9262

ARTERIAL OFFICE

APPLICATION FOR PERMIT TO DRILL, DEEPEN, OR PLUG BACK

1. Type of Work DRILL <input checked="" type="checkbox"/> DEEPEN <input type="checkbox"/> PLUG BACK <input type="checkbox"/>		7. Unit Agreement Name -----
2. Type of Well OIL WELL <input checked="" type="checkbox"/> GAS WELL <input type="checkbox"/> OTHER <input type="checkbox"/> SINGLE ZONE <input checked="" type="checkbox"/> MULTIPLE ZONE <input type="checkbox"/>		8. Farm or Lease Name New Mexico "CY" St. NCT-1
3. Name of Operator TEXACO INC.		9. Well No. 4
4. Address of Operator P. O. BOX 3109, MIDLAND, TEXAS 79701		10. Field and Pool, or Wildcat N. Benson Queen-Grass
5. Location UNIT LETTER K LOCATED 1980 FEET FROM THE South LINE AND 1980 FEET FROM THE West LINE OF SEC. 32 TWP. 18S RGE. 30E NMPM		12. County Eddy
19. Proposed Depth 3235'		19A. Formation Queen
20. Rotary or C.T. Rotary		21. Elevations (Show whether DE, RT, etc.) GR - 3384'
21A. Kind & Status Plug. Bond \$10,000 blanket		21B. Drilling Contractor Unknown
22. Approx. Date Work will start At once		

23.

PROPOSED CASING AND CEMENT PROGRAM

SIZE OF HOLE	SIZE OF CASING	WEIGHT PER FOOT	SETTING DEPTH	SACKS OF CEMENT	EST. TOP
9 7/8"	7 5/8"	24#, 15.28#	475'	*400	250% to circ.
6 3/4"	4 1/2"	10.5#	3285'	**800	300% to circ.

*Cement with 400 sx Class "C" neat (250% to circ.) Cement must circulate.

**Cement with 500 sx TLW w/10% salt, 12.2#/gal followed by 300 sx Class "C" salt sat. 14.8#/gal. (300% to circulate).

COMPLETION PROGRAM

1. Selectively perf. pay w/2 JSPI. 2. Treat w/2000 gal 15% N.E. acid staged w/balls. 3. Frac w/45,000 gal gelled brine & 67,500# 20-40 sd. Stage w/ball sealers. (3 stages). Limit pressure to 4000 psi.

FORMATION TOPS EXPECTED

Anhydrite	260'	Queen	2605'
Base of Salt	1300'	Total Depth	3235'

IN ABOVE SPACE DESCRIBE PROPOSED PROGRAM; IF PROPOSAL IS TO DEEPEN OR PLUG BACK, GIVE DATA ON PRESENT PRODUCTIVE ZONE AND PROPOSED NEW PRODUCTIVE ZONE. GIVE BLOWOUT PREVENTER PROGRAM, IF ANY.

I hereby certify that the information above is true and complete to the best of my knowledge and belief.

Signed J. J. Vetter Title Division Civil Engineer Date 2/23/67J. J. Vetter
(This space for State Use)APPROVED BY W. A. Gressett TITLE OIL AND GAS INSPECTOR DATE FEB 24 1967

LOCAL OR ADDRESS, IF ANY

**NEW MEXICO OIL CONSERVATION COMMISSION
WELL LOCATION AND ACREAGE DEDICATION PLAT**

Form C-102
Supersedes C-128
Effective 1-1-65

All distances must be from the outer boundaries of the Section.

Operator TEXACO Inc.			Lease New Mexico "CY" State NCT-1		Well No. 4
Unit Letter K	Section 32	Township 18 South	Range 30 East	County Eddy	
Actual Footage Location of Well: <div style="display: flex; justify-content: space-between;"> 1980 feet from the South line and 1980 feet from the West line </div>					
Ground Level Elev. 3384	Producing Formation Queen	Pool North Benson Queen-Grayburg		Dedicated Acreage: 40 Acres	

1. Outline the acreage dedicated to the subject well by colored pencil or hatchure marks on the plat below.
2. If more than one lease is dedicated to the well, outline each and identify the ownership thereof (both as to working interest and royalty).
3. If more than one lease of different ownership is dedicated to the well, have the interests of all owners been consolidated by communitization, unitization, force-pooling, etc?

☐ Yes ☐ No If answer is "yes," type of consolidation _____

If answer is "no," list the owners and tract descriptions which have actually been consolidated. (Use reverse side of this form if necessary.) _____

No allowable will be assigned to the well until all interests have been consolidated (by communitization, unitization, forced-pooling, or otherwise) or until a non-standard unit, eliminating such interests, has been approved by the Commission.

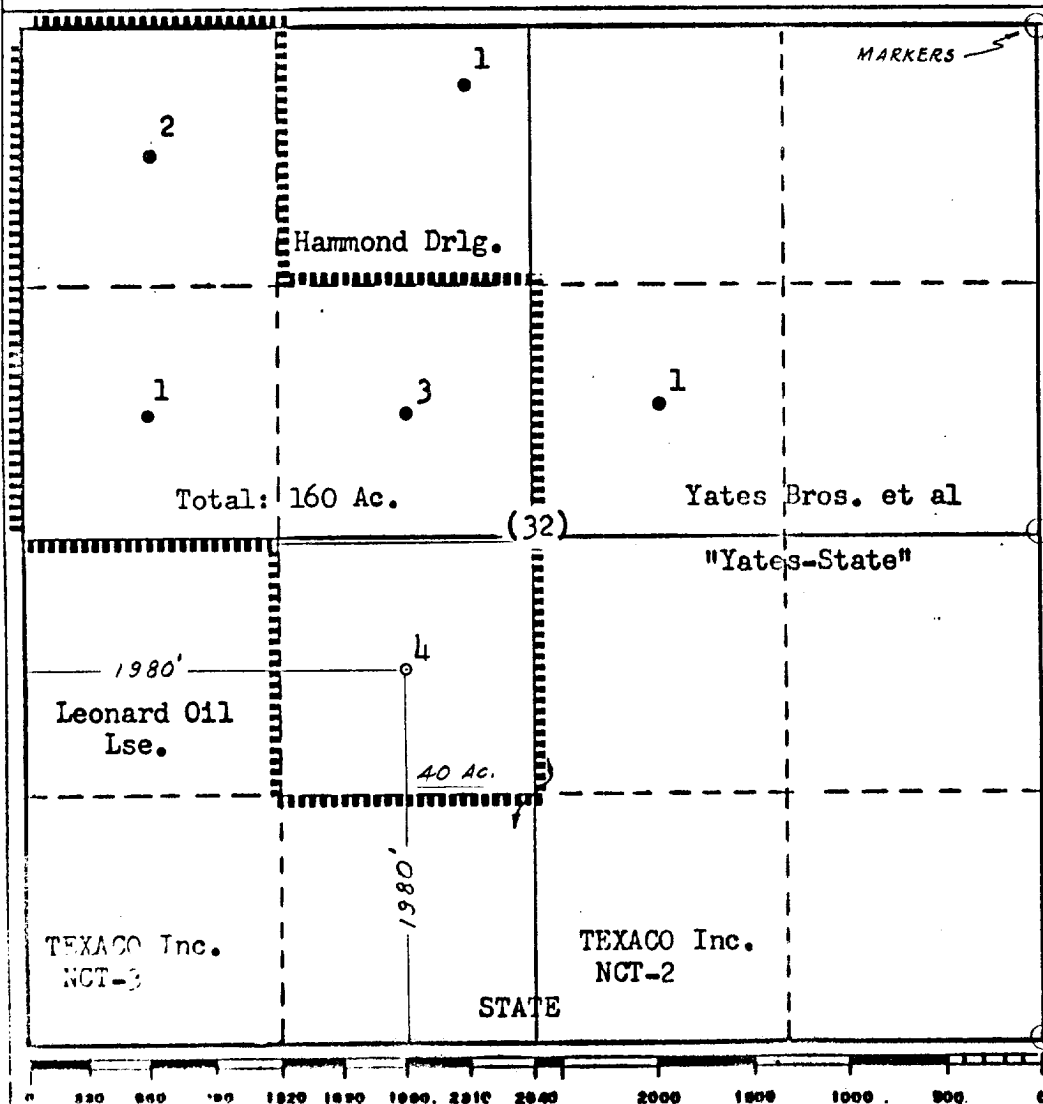

CERTIFICATION	
I hereby certify that the information contained herein is true and complete to the best of my knowledge and belief.	
Name	<i>J. J. Velten</i> J. J. Velten
Position	Division Civil Engineer
Company	TEXACO Inc.
Date	2/23/67
I hereby certify that the well location shown on this plat was plotted from field notes of actual surveys made by me or under my supervision, and that the same is true and correct to the best of my knowledge and belief.	
Date Surveyed	2/21/67
Registered Professional Engineer and/or Land Surveyor	<i>J. J. Velten</i> J. J. Velten
Certificate No.	8174