

District I
PO Box 1980, Hobbs, NM 88241-1980
District II
PO Drawer DD, Artesia, NM 88211-0719
District III
1000 Rio Brazos Rd., Aztec, NM 87410
District IV
PO Box 2088, Santa Fe, NM 87504-2088

State of New Mexico
Energy, Minerals & Natural Resources Department

OIL CONSERVATION DIVISION
PO Box 2088
Santa Fe, NM 87504-2088

Form C-101
Revised February 10, 1994
Instructions on back
Submit to Appropriate District Office
State Lease - 6 Copies
Fee Lease - 5 Copies

☐ AMENDED REPORT

APPLICATION FOR PERMIT TO DRILL, RE-ENTER, DEEPEN, PLUGBACK, OR ADD A ZONE

| | | |
|---|--|---|
| Operator Name and Address. YATES PETROLEUM CORPORATION 105 South Fourth Street Artesia, New Mexico 88210 | | OGRID Number API Number 30 - 0 15-20137 |
| Property Code Wilkinson "AZ" | Property Name O. C. D. ARTESIA, OFFICE | Well No. 2 |

7 Surface Location

| UL or lot no. | Section | Township | Range | Lot Idn | Feet from the | North/South line | Feet from the | East/West line | County |
|---------------|---------|----------|-------|---------|---------------|------------------|---------------|----------------|--------|
| M | 25 | 18S | 25E | | 990 | South | 990 | West | Eddy |

8 Proposed Bottom Hole Location If Different From Surface

| UL or lot no. | Section | Township | Range | Lot Idn | Feet from the | North/South line | Feet from the | East/West line | County |
|---|---------|----------|-------|---------|-----------------|------------------|---------------|----------------|--------|
| Proposed Pool 1 Penasco Draw San Andres Yeso 50270 | | | | | Proposed Pool 2 | | | | |

| | | | | |
|---------------------|-------------------------|-------------------|----------------------------|---------------------------------|
| Work Type Code D | Well Type Code O | Cable/Rotary R | Lease Type Code P | Ground Level Elevation 3467' |
| Multiple No | Proposed Depth 2450' | Formation Yeso | Contractor Undesignated | Spud Date 8/15/94 |

21 Proposed Casing and Cement Program

| Hole Size | Casing Size | Casing weight/foot | Setting Depth | Sacks of Cement | Estimated TOC |
|-----------|-----------------|--------------------|---------------|-----------------|----------------|
| 11" | 8 5/8" In place | 28# | 1043' | 400 sacks | Surface |
| 7 7/8" | 5 1/2" In place | 14# | 1527' | 180 sacks | 460' Post TD-1 |
| 4 3/4" | 3 1/2" | 9.2# | 2450' | As warranted | 8-12-94 |
| | | | | | New Log & API |

22 Describe the proposed program. If this application is to DEEPEN or PLUG BACK give the data on the present productive zone and proposed new productive zone. Describe the blowout prevention program, if any. Use additional sheets if necessary.

Yates Petroleum Corporation proposes to deepen this well to test the Yeso formation. Will drill to a depth of 2450'; run 3 1/2" casing to TD, cement with adequate cover, perforate and stimulate as needed for production. Will drill to TD using fresh water BOPE will be installed on the 5 1/2" casing and tested daily for operational.

23 I hereby certify that the information given above is true and complete to the best of my knowledge and belief.

Signature:

Printed name: Clifton R. May

Title: Permit Agent

Date: 8/4/94

Phone: 748-1471

OIL CONSERVATION DIVISION

Approved by:

Title: GEOLOGIST

Approval Date: 8-5-94

Expiration Date: 2-5-95

Conditions of Approval:

Attached ☐

MEXICO OIL CONSERVATION COMMISSION
WELL LOCATION AND ACREAGE DEDICATION PLAT

Form C-102
Supersedes C-128
Effective 1-4-65

All distances must be from the outer boundaries of the Section.

| | | | | |
|--|--|---------------------------------------|--------------------------------------|-----------------------|
| Operator Yates Petroleum Corp. | | Lease Wilkinson AZ | | Well No. 2 |
| Unit Letter M | Section 25 | Township T-18-S | Range R-25-E | County Eddy |
| Actual Footage Location of Well: 990 feet from the South line and 990 feet from the West line | | | | |
| Ground Level Elev. 3467 | Producing Formation San Andres | Pool Penasco Draw S.A. Yeso | Dedicated Acreage 40 Acres | |

1. Outline the acreage dedicated to the subject well by colored pencil or hachure marks on the plat below.
2. If more than one lease is dedicated to the well, outline each and identify the ownership thereof (both as to working interest and royalty).
3. If more than one lease of different ownership is dedicated to the well, have the interests of all owners been consolidated by communitization, unitization, force-pooling, etc?

☐ Yes ☐ No If answer is "yes," type of consolidation _____

RECEIVED

APR 19 1968

O. C. C.
ARTESIA, OFFICE

If answer is "no," list the owners and tract descriptions which have actually been consolidated. (Use reverse side of this form if necessary.) _____

No allowable will be assigned to the well until all interests have been consolidated (by communitization, unitization, forced-pooling, or otherwise) or until a non-standard unit, eliminating such interests, has been approved by the Commission.

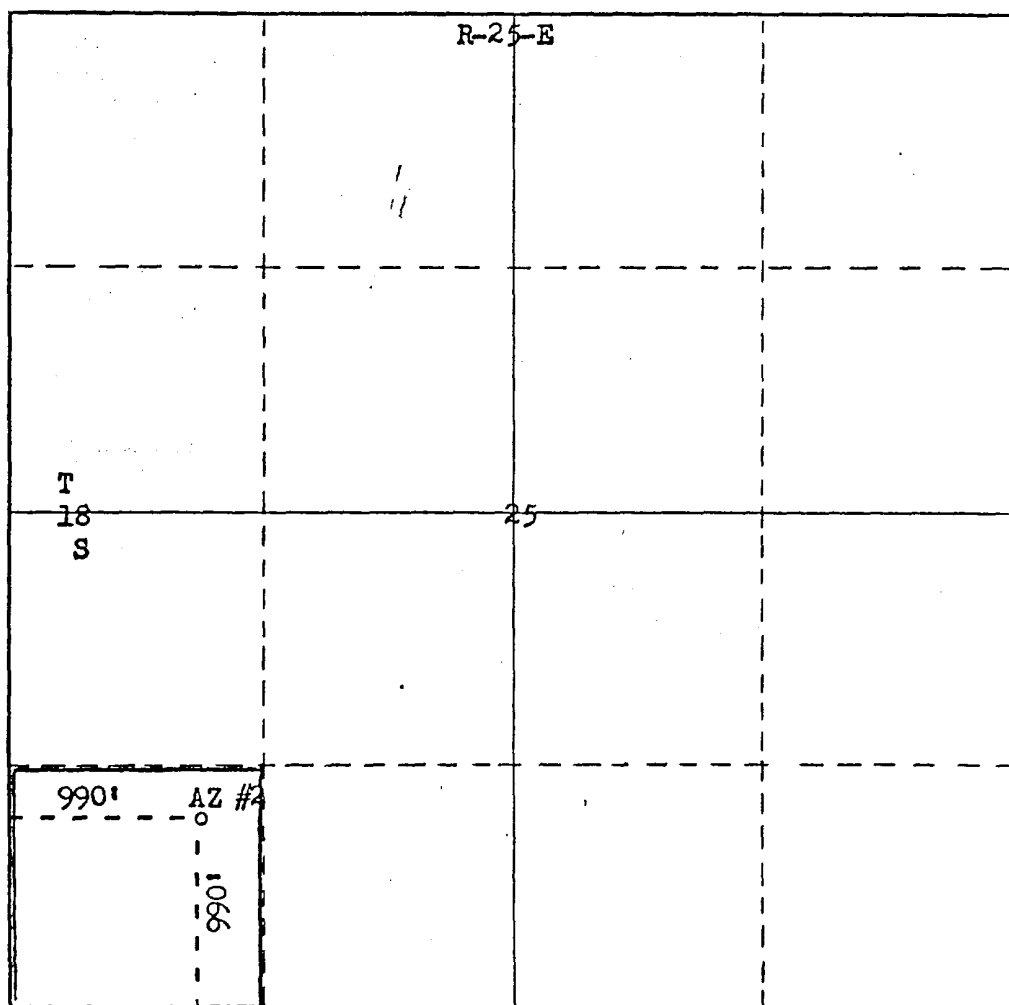

CERTIFICATION

I hereby certify that the information contained herein is true and complete to the best of my knowledge and belief.

Paul G. White

Name

Paul G. White

Position

Engineer

Company

Yates Petroleum Corp.

Date

4-18-68

I hereby certify that the well location shown on this plat was plotted from field notes of actual surveys made by me or under my supervision, and that the same is true and correct to the best of my knowledge and belief.

Date Surveyed

May 26, 1967

Registered Professional Engineer
and/or Land Surveyor

James H. Luvall

Certificate No.

542

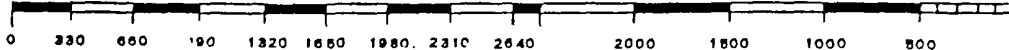

YATES PETROLEUM CORPORATION

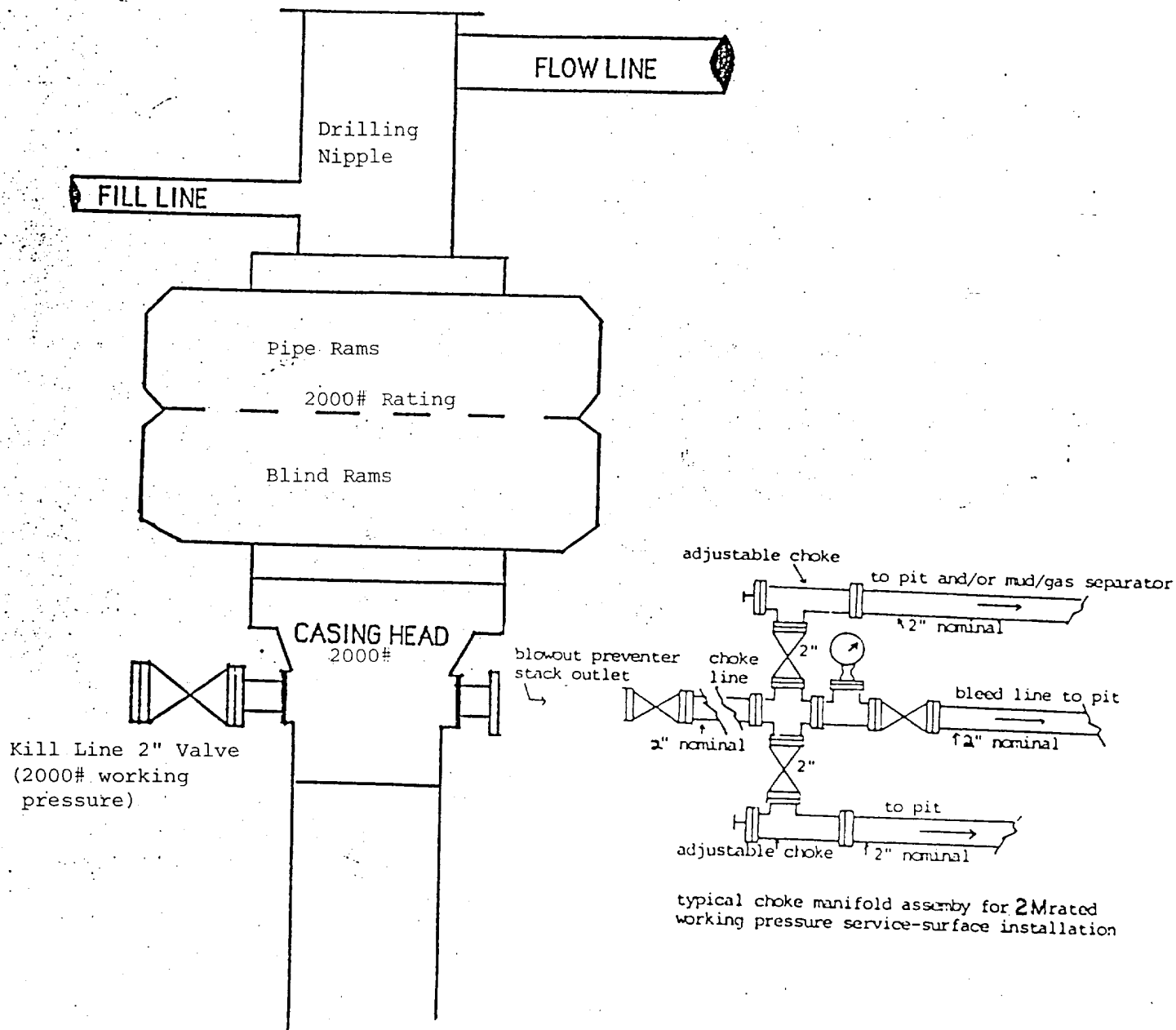

**BLOWOUT PREVENTER
2M SYSTEM**