

NO. OF COPIES RECEIVED	6
DISTRIBUTION	
SANTA FE	1
FILE	1
U.S.G.S.	2
LAND OFFICE	1
OPERATOR	1

**RECEIVED**  
**NEW MEXICO OIL CONSERVATION COMMISSION**  
**MAY 27 1968**  
**O. C. C.**  
**ARTESIA OFFICE**

30-015-20148  
Form C-101  
Revised 1-1-65

5A. Indicate Type of Lease	
STATE <input checked="" type="checkbox"/>	FEE <input type="checkbox"/>
5. State Oil & Gas Lease No.	
647	

**APPLICATION FOR PERMIT TO DRILL, DEEPEN, OR PLUG BACK**

1a. Type of Work			7. Unit Agreement Name		
b. Type of Well DRILL <input checked="" type="checkbox"/> DEEPEN <input type="checkbox"/> PLUG BACK <input type="checkbox"/> OIL WELL <input checked="" type="checkbox"/> GAS WELL <input type="checkbox"/> OTHER <input type="checkbox"/> SINGLE ZONE <input checked="" type="checkbox"/> MULTIPLE ZONE <input type="checkbox"/>			8. Farm or Lease Name		
2. Name of Operator			9. Well No.		
DEPCO, Inc.			224		
3. Address of Operator			10. Field and Pool, or Wildcat		
800 Central, Odessa, Texas 79760			Artesia Field		
4. Location of Well			12. County		
UNIT LETTER <u>K</u> LOCATED <u>2310</u> FEET FROM THE <u>South</u> LINE			Eddy		
AND <u>2310</u> FEET FROM THE <u>West</u> LINE OF SEC. <u>32</u> TWP. <u>18S</u> RGE. <u>28 E</u> NMPM					
19. Proposed Depth			19A. Formation		20. Rotary or C.T.
2025			Loco Hills		Rotary
21. Elevations (Show whether DF, RT, etc.)		21A. Kind & Status Plug. Bond	21B. Drilling Contractor		22. Approx. Date Work will start
3549 GL		Blanket	WEK Drilling Co.		6-3-68

**PROPOSED CASING AND CEMENT PROGRAM**

SIZE OF HOLE	SIZE OF CASING	WEIGHT PER FOOT	SETTING DEPTH	SACKS OF CEMENT	EST. TOP
11"	8 5/8	28#	500	175	Circulate
7 7/8	5 1/2	14#	2025	150	1200'

APPROVAL VALID  
FOR 90 DAYS UNLESS  
DRILLING COMMENCED,  
EXPIRES 8-25-68

IN ABOVE SPACE DESCRIBE PROPOSED PROGRAM: IF PROPOSAL IS TO DEEPEN OR PLUG BACK, GIVE DATA ON PRESENT PRODUCTIVE ZONE AND PROPOSED NEW PRODUCTIVE ZONE. GIVE BLOWOUT PREVENTER PROGRAM, IF ANY.

I hereby certify that the information above is true and complete to the best of my knowledge and belief.

Signed [Signature] Title District Engineer Date 5-24-68

(This space for State Use)

APPROVED BY W. A. Gressett TITLE OIL AND GAS INSPECTOR DATE MAY 27 1968

CONDITIONS OF APPROVAL, IF ANY:

NEW MEXICO OIL CONSERVATION COMMISSION  
WELL LOCATION AND ACREAGE DEDICATION PLAT

Form C-102  
Supersedes C-128  
Effective 1-1-65

All distances must be from the outer boundaries of the Section.

Operator <del>UNITED</del>		Lease State <u>TX</u>		Well No. <u>224</u>
Unit Number <u>K</u>	Section <u>32</u>	Township <u>N 31</u>	Range <u>E 23</u>	County <u>Gray</u>
Actual Horizontal Location of Well: <u>550</u> feet from the <u>Southern</u> line and <u>2300</u> feet from the <u>West</u> line				
Ground Level Elev. <u>3549</u>	Producing Formation <u>Loce Hills</u>		Well <u>Artesia</u>	Dedicated Acreage: <u>40</u> Acres

1. Outline the acreage dedicated to the subject well by colored pencil or hatchure marks on the plat below.
2. If more than one lease is dedicated to the well, outline each and identify the ownership thereof (both as to working interest and royalty).
3. If more than one lease of different ownership is dedicated to the well, have the interests of all owners been consolidated by communitization, unitization, force-pooling, etc?

☐ Yes ☐ No If answer is "yes" type of consolidation \_\_\_\_\_

If answer is "no" list the owners and tract descriptions which have actually been consolidated. (Use reverse side of this form if necessary.) \_\_\_\_\_

No allowable will be assigned to the well until all interests have been consolidated (by communitization, unitization, forced-pooling, or otherwise) or until a non-standard unit, eliminating such interests, has been approved by the Commission.

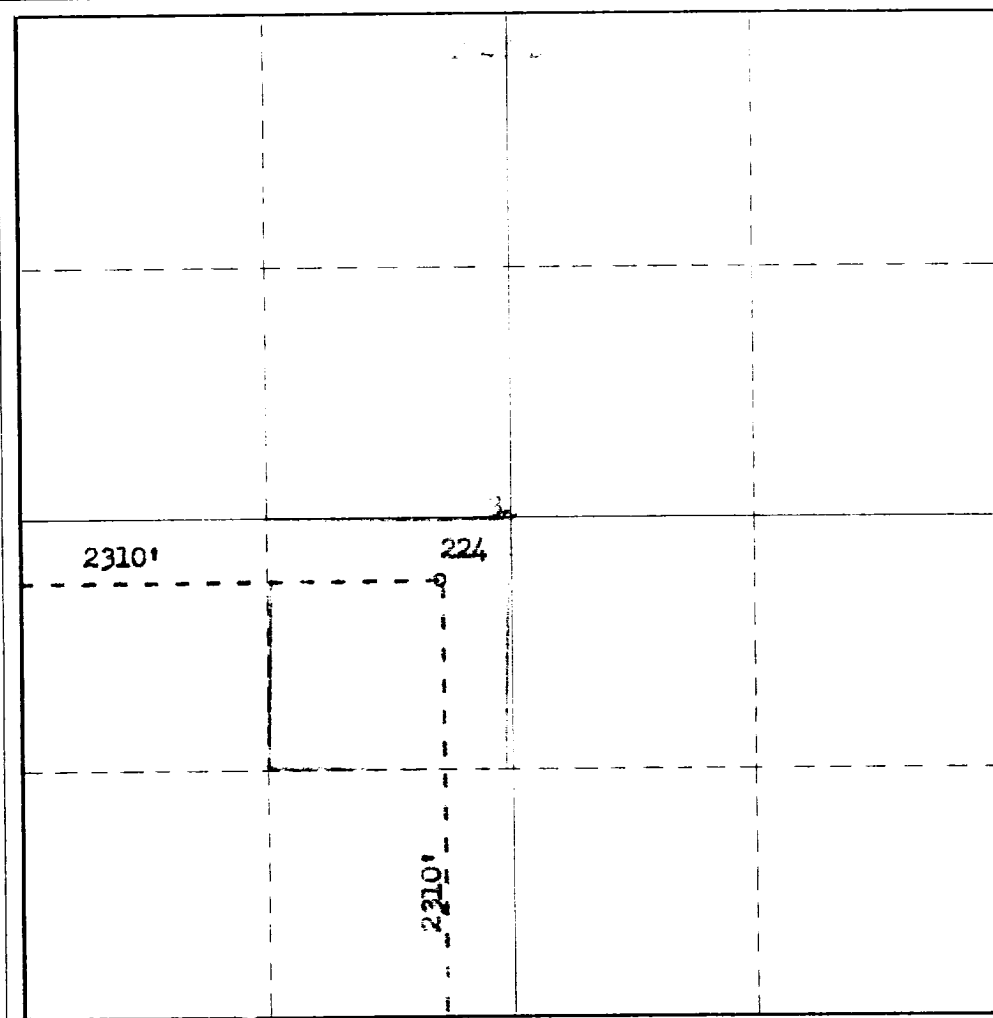

CERTIFICATION

I hereby certify that the information contained herein is true and complete to the best of my knowledge and belief.

*[Signature]*  
Name

District Engineer

Position

DEPCO, Inc.

Company

May 24, 1968

Date

I hereby certify that the well location shown on this plat was plotted from field notes of actual surveys made by me or under my supervision, and that the same is true and correct to the best of my knowledge and belief.

Date Surveyed

Registered Professional Engineer  
and/or Land Surveyor

Certificate No.

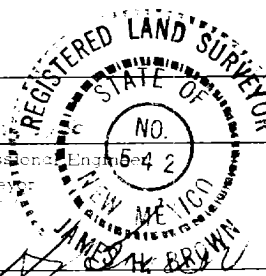

542