

UNITED STATES
DEPARTMENT OF THE INTERIOR
GEOLOGICAL SURVEY

APPLICATION FOR PERMIT TO DRILL, DEEPEN, OR PLUG BACK

1a. TYPE OF WORK

DRILL ☐DEEPEN ☐PLUG BACK ☐

b. TYPE OF WELL

OIL
WELL ☒GAS
WELL ☐

OTHER

SINGLE
ZONE ☒MULTIPLE
ZONE ☐

2. NAME OF OPERATOR

NEWMONT OIL COMPANY

3. ADDRESS OF OPERATOR

P. O. Box 1305, ARTESIA, NEW MEXICO 88210

4. LOCATION OF WELL (Report location clearly and in accordance with any State requirements.)*

At surface

1330' FSL & 330' FWL of Sec. 3, T-18S, R-29E

At proposed prod. zone

14. DISTANCE IN MILES AND DIRECTION FROM NEAREST TOWN OR POST OFFICE*

15. DISTANCE FROM PROPOSED*

LOCATION TO NEAREST
PROPERTY OR LEASE LINE, FT.
(Also to nearest drlg. line, if any)18. DISTANCE FROM PROPOSED LOCATION*
TO NEAREST WELL, DRILLING, COMPLETED,
OR APPLIED FOR, ON THIS LEASE, FT.

16. NO. OF ACRES IN LEASE

19. PROPOSED DEPTH

2600'

17. NO. OF ACRES ASSIGNED
TO THIS WELL

20. ROTARY OR CABLE TOOLS

Rotary

21. ELEVATIONS (Show whether DF, RT, GR, etc.)

3520'

22. APPROX. DATE WORK WILL START*

December 26, 1968

23. PROPOSED CASING AND CEMENTING PROGRAM

SIZE OF HOLE	SIZE OF CASING	WEIGHT PER FOOT	SETTING DEPTH	QUANTITY OF CEMENT
10-3/4	8-5/8	24	480	50 sks
7-7/8	4-1/2	9.5	2600'	100 sks

We propose to drill a 10-3/4" hole to top of salt at approximately 400' and cement 8-5/8" casing with 50 sks. We will drill 7-7/8" hole to TD about 2600' and complete as a producing oil well. This location was approved by Oil Commission Order No. R-3626.

RECEIVED

DEC 24 1968

O. C. C.
ARTESIA, OFFICE

IN ABOVE SPACE DESCRIBE PROPOSED PROGRAM: If proposal is to deepen or plug back, give data on present productive zone and proposed new productive zone. If proposal is to drill or deepen directionally, give pertinent data on subsurface locations and measured and true vertical depths. Give blowout preventer program, if any.

24.

SIGNED

Hermon D. L. Lutter

TITLE

Division Superintendent

DATE

12/19/68

(This space for Federal or State office use)

PERMIT NO.

APPROVAL OPERATIONS

THIS APPROVAL IS RESCINDED IF
THIS WITHIN 3 MONTHS.
EXPIRES
MAR 23 1969

DATE

APPROVED
DEC 23 1968
R. L. BECKMAN
ACTING DISTRICT SUPERVISOR

*See Instructions On Reverse Side

NEW MEXICO OIL CONSERVATION COMMISSION
WELL LOCATION AND ACREAGE DEDICATION PLAT

Form C-102
Supersedes C-128
Effective 1-1-65

All distances must be from the outer boundaries of the Section.

Operator Newmont Oil Company			Lease <i>W. Loco Hills S 4 & 4th</i> West Loco Hills Unit Sec. 10 A		Well No. 202-7
Unit Letter 1	Section 3	Township 18 South	Range 29 East	County Elddy	
Actual Footage Location of Well: 1330 feet from the South line and 330 feet from the West line					
Ground Level Elev. 3520	Producing Formation Grayburg San Andres		Pool Loco Hills	Dedicated Acreage: 40 Acres	

1. Outline the acreage dedicated to the subject well by colored pencil or hatchure marks on the plat below.
2. If more than one lease is dedicated to the well, outline each and identify the ownership thereof (both as to working interest and royalty).
3. If more than one lease of different ownership is dedicated to the well, have the interests of all owners been consolidated by communitization, unitization, force-pooling, etc?

☐ Yes ☐ No If answer is "yes," type of consolidation _____

If answer is "no," list the owners and tract descriptions which have actually been consolidated. (Use reverse side of this form if necessary.) _____

No allowable will be assigned to the well until all interests have been consolidated (by communitization, unitization, forced-pooling, or otherwise) or until a non-standard unit, eliminating such interests, has been approved by the Commission.

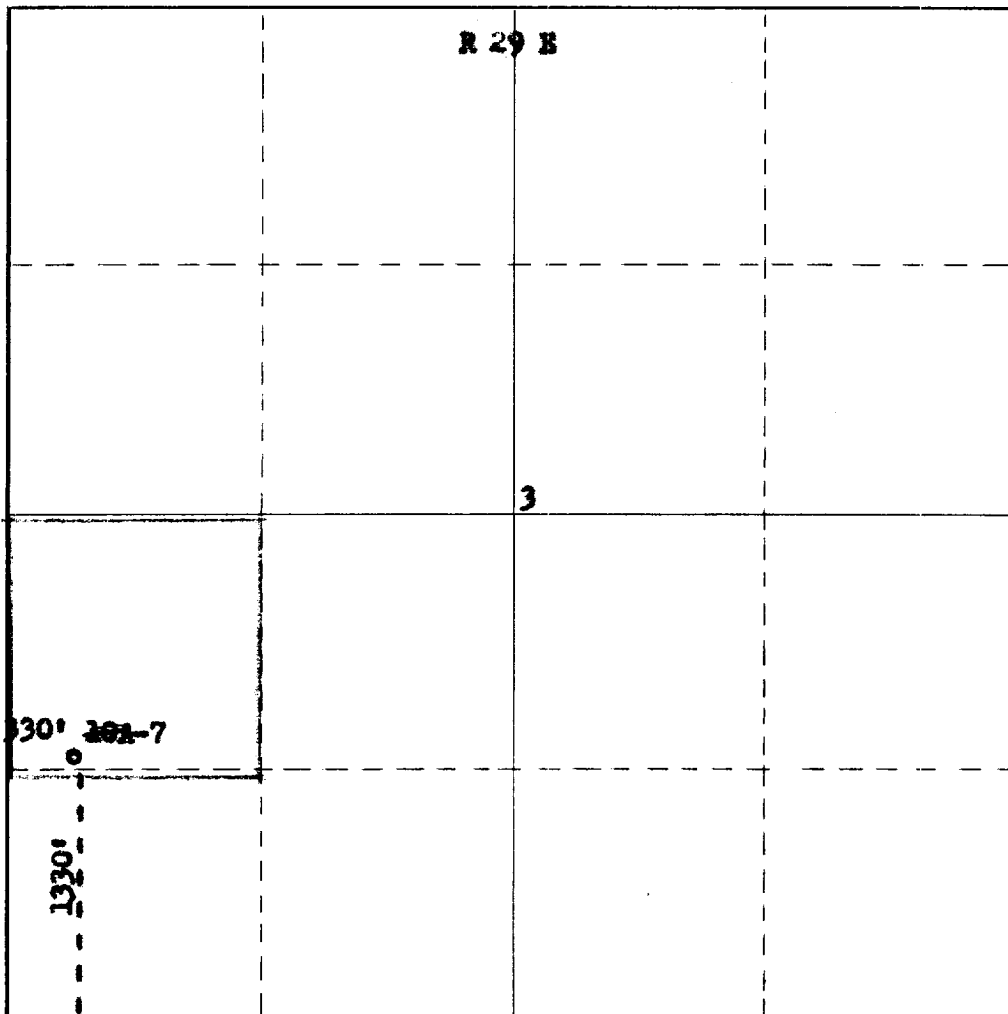

CERTIFICATION

I hereby certify that the information contained herein is true and complete to the best of my knowledge and belief.

Herman J. Ledbetter
Name

Herman J. Ledbetter
Position
Division Superintendent
Company

NEWMONT OIL COMPANY

Date
12/19/68

I hereby certify that the well location shown on this plat was plotted from field notes of actual surveys made by me or under my supervision, and that the same is true and correct to the best of my knowledge and belief.

Date Surveyed **542**
December 11, 1968

Registered Professional Engineer
and/or Land Surveyor
H. BROWN

James H. Brown
Certificate No.

N.M.L.S.No. 542

