

NO. OF COPIES RECEIVED	6
DISTRIBUTION	
SANTA FE	1
FILE	1
U.S.G.S.	1
LAND OFFICE	1
OPERATOR	1

NEW MEXICO OIL CONSERVATION COMMISSION

RECEIVED

JUL 13 1970

Form C-101
Revised 1-1-65

5A. Indicate Type of Lease	
STATE <input checked="" type="checkbox"/>	FEE <input type="checkbox"/>
5. State Oil & Gas Lease No.	
7. Unit Agreement Name Artesia Unit	
8. Farm or Lease Name	
9. Well No. 66	
10. Field and Pool, or Wildcat Artesia	
12. County Eddy	
19. Proposed Depth 2500	19A. Formation Grayburg
20. Rotary or C.T. Rotary	
21. Elevations (Show whether DF, RT, etc.) 3662 GR	22. Approx. Date Work will start On Approval

1a. Type of Work ARTESIA, OFFICE	
b. Type of Well DRILL <input checked="" type="checkbox"/> DEEPEN <input type="checkbox"/> PLUG BACK <input type="checkbox"/> OIL WELL <input type="checkbox"/> GAS WELL <input type="checkbox"/> OTHER Injection SINGLE ZONE <input checked="" type="checkbox"/> MULTIPLE ZONE <input type="checkbox"/>	
2. Name of Operator DEPCO, Inc.	
3. Address of Operator 800 Central, Odessa, Texas 79760	
4. Location of Well UNIT LETTER F LOCATED 1550 FEET FROM THE North LINE AND 1950 FEET FROM THE West LINE OF SEC. 3 TWP. 18S. RGE. 28E NMPM	
21. Kind & Status Plug. Bond Blanket	
21B. Drilling Contractor WEK Drlg. Co.	

PROPOSED CASING AND CEMENT PROGRAM

SIZE OF HOLE	SIZE OF CASING	WEIGHT PER FOOT	SETTING DEPTH	SACKS OF CEMENT	EST. TOP
11"	8 5/8"	24#	500'	100	Circ.
7 7/8"	4 1/2"	10.50#	2500'	150	1750

WFX 347

APPROVAL VALID
FOR 90 DAYS UNLESS
DRILLING COMMENCED,
EXPIRES 11-6-70

IN ABOVE SPACE DESCRIBE PROPOSED PROGRAM: IF PROPOSAL IS TO DEEPEN OR PLUG BACK, GIVE DATA ON PRESENT PRODUCTIVE ZONE AND PROPOSED NEW PRODUCTIVE ZONE. GIVE BLOWOUT PREVENTER PROGRAM, IF ANY.

I hereby certify that the information above is true and complete to the best of my knowledge and belief.

Signed D. R. Mason Title Chief Production Clerk Date 7-9-70

(This space for State Use)

APPROVED BY [Signature] TITLE OIL AND GAS INSPECTOR DATE AUG 6 1970

CONDITIONS OF APPROVAL, IF ANY:

MEXICO OIL CONSERVATION COMMISS
WELL LOCATION AND ACREAGE DEDICATION PLAT

Form C-102
Supersedes C-128
Effective 1-1-65

All distances must be from the outer boundaries of the Section.

Operator DEPCO Inc.			Lease Arteria Unit		Well No. 66
Unit Letter F	Section 3	Township 18 S	Range 28 E	County Eddy	
Actual Footage Location of Well: 1550 feet from the North line and 1950 feet from the West line					
Ground Level Elev. 3662	Producing Formation sh		Pool artisia		Dedicated Acreage: 40 Acres

- Outline the acreage dedicated to the subject well by colored pencil or hachure marks on the plat below.
- If more than one lease is dedicated to the well, outline each and identify the ownership thereof (both as to working interest and royalty).
- If more than one lease of different ownership is dedicated to the well, have the interests of all owners been consolidated by communitization, unitization, force-pooling, etc?

☐ Yes ☐ No If answer is "yes," type of consolidation _____

If answer is "no," list the owners and tract descriptions which have actually been consolidated. (Use reverse side of this form if necessary.) _____

No allowable will be assigned to the well until all interests have been consolidated (by communitization, forced-pooling, or otherwise) or until a non-standard unit, eliminating such interests, has been approved by the Commission.

RECEIVED

JUL 13 1970

D. R. Mason
ARTESIA, N.M.

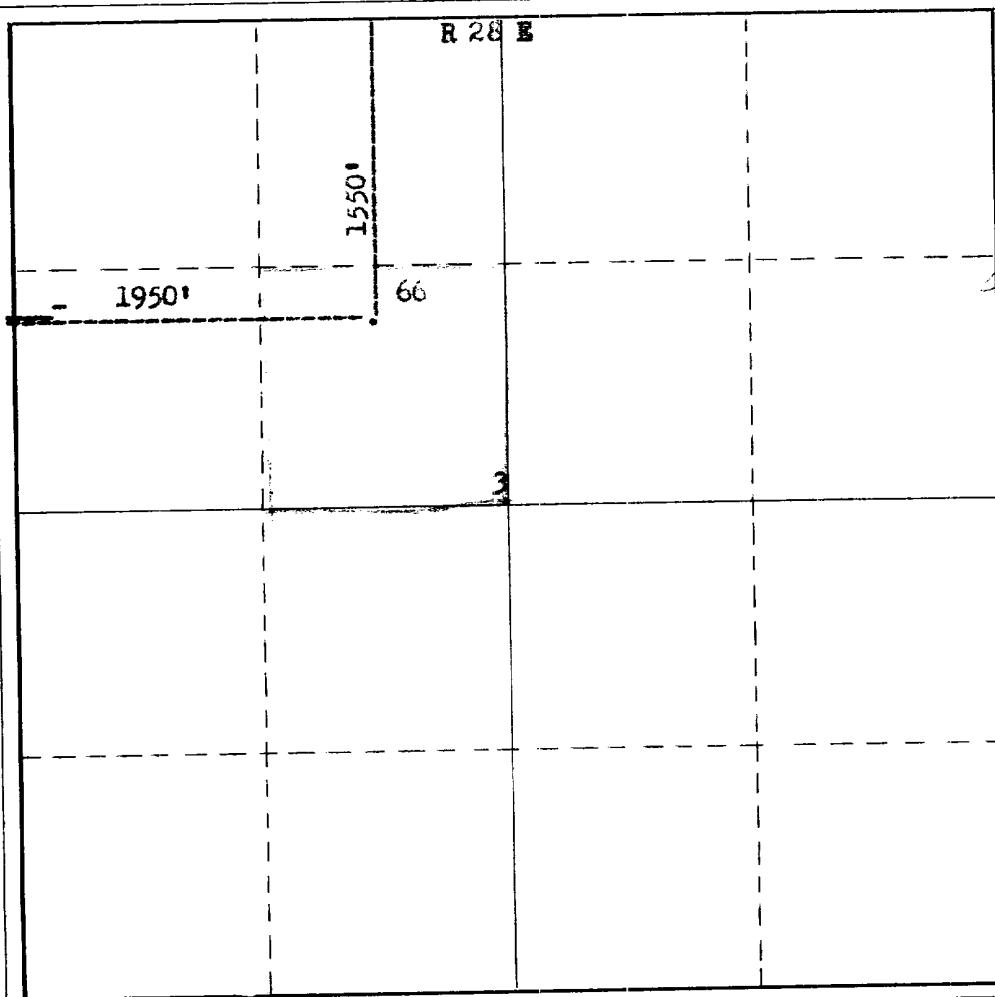

CERTIFICATION

I hereby certify that the information contained herein is true and complete to the best of my knowledge and belief.

Name **D. R. Mason**

Position **Chief Production Clerk**

Company **DEPCO, INC.**

Date **7-9-70**

I hereby certify that the well location shown on this plat was plotted from field notes of actual surveys made by me or under my supervision, and that the same is true and correct to the best of my knowledge and belief.

Date Surveyed **July 7th 1970**

Registered Professional Engineer and/or Land Surveyor

James H. Brown
Certificate No. **542**

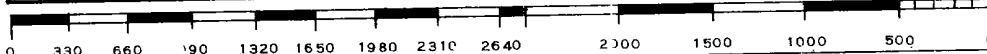

T
18
S

30-015-20327

OGFID 184460
PROP 260-1
100L 3100

IT IS THEREFORE ORDERED:

That the applicant, Depco. Inc., be and the same is hereby authorized to inject water into the Grayburg formation through the following described wells for purposes of secondary recovery, to wit:

Unit Well No. 20 located in Unit I of Section 35, and
Unit Well No. 23 located in Unit L of Section 35, both
in Township 17 South, Range 28 East, NMPM,
Unit Well No. 36 located in Unit D of Section 2,
Unit Well No. 66 located in Unit F of Section 3, ✓
and Unit Well No. 67 located in Unit K of Section 3, ✓
all in Township 18 South, Range 28 East, NMPM.

PROVIDED HOWEVER, That the applicant shall inject water through tubing with packers set well below the top of the cement surrounding the production casing in the above-described wells.