

NO. OF COPIES RECEIVED	
DISTRIBUTION	
SANTA FE	
FILE	
U.S.G.S.	
LAND OFFICE	
OPERATOR	

RECEIVED
NEW MEXICO OIL CONSERVATION COMMISSION

JUL 13 1970

O. O. C.
ARTESIA, OFFICE

Form C-101
Revised 1-1-65

5A. Indicate Type of Lease	
STATE <input checked="" type="checkbox"/>	FEE <input type="checkbox"/>
5. State Oil & Gas Lease No.	

APPLICATION FOR PERMIT TO DRILL, DEEPEN, OR PLUG BACK

1a. Type of Work DRILL <input checked="" type="checkbox"/> DEEPEN <input type="checkbox"/> PLUG BACK <input type="checkbox"/>		7. Unit Agreement Name Artesia Unit
b. Type of Well OIL WELL <input type="checkbox"/> GAS WELL <input type="checkbox"/> OTHER Injection		8. Farm or Lease Name
2. Name of Operator DEPCO, Inc.		9. Well No. 67
3. Address of Operator 800 Central, Odessa, Texas 79760		10. Field and Pool, or Wildcat Artesia
4. Location of Well UNIT LETTER K LOCATED 2200 FEET FROM THE South LINE AND 2200 FEET FROM THE West LINE OF SEC. 3 TWP. 18S RGE. 28E NMPM		12. County Eddy
19. Proposed Depth 2500		19A. Formation Grayburg
20. Rotary or C.T. Rotary		
21. Elevations (Show whether DF, RT, etc.) 3657 GR	21A. Kind & Status Plug. Bond Blanket	21B. Drilling Contractor WEK Drlg. Co.
22. Approx. Date Work will start On Approval		

23. PROPOSED CASING AND CEMENT PROGRAM

SIZE OF HOLE	SIZE OF CASING	WEIGHT PER FOOT	SETTING DEPTH	SACKS OF CEMENT	EST. TOP
11"	8 5/8"	24#	500'	100	Circ.
7 7/8"	4 1/2"	10.50#	2500'	150	1750

APPROVAL VALID
FOR 90 DAYS UNLESS
DRILLING COMMENCED,
EXPIRES 11-20-70

IN ABOVE SPACE DESCRIBE PROPOSED PROGRAM: IF PROPOSAL IS TO DEEPEN OR PLUG BACK, GIVE DATA ON PRESENT PRODUCTIVE ZONE AND PROPOSED NEW PRODUCTIVE ZONE. GIVE BLOWOUT PREVENTER PROGRAM, IF ANY.

I hereby certify that the information above is true and complete to the best of my knowledge and belief.

Signed D. R. Mason Title Chief Production Clerk Date 7-9-70

(This space for State Use)

APPROVED BY W. A. Gressett TITLE OIL AND GAS DATE AUG 20 1970

CONDITIONS OF APPROVAL, IF ANY:

N MEXICO OIL CONSERVATION COMMISS.
WELL LOCATION AND ACREAGE DEDICATION PLAT

Form C-102
Supersedes C-128
Effective 1-1-65

All distances must be from the outer boundaries of the Section.

Operator DEPCO Inc.			Lease Artesia Unit		Well No. 67
Unit Letter K	Section 3	Township 18 S	Range 28 E	County Eddy	
Actual Footage Location of Well: 2200 feet from the South line and 2200 feet from the West line					
Ground Level Elev. 3351	Producing Formation Sh.		Pool Artesia	Dedicated Acreage: 40 Acres	

1. Outline the acreage dedicated to the subject well by colored pencil or hachure marks on the plat below.
2. If more than one lease is dedicated to the well, outline each and identify the ownership thereof (both as to working interest and royalty).
3. If more than one lease of different ownership is dedicated to the well, have the interests of all owners been consolidated by communitization, unitization, force-pooling, etc?

☐ Yes ☐ No If answer is "yes," type of consolidation _____

If answer is "no," list the owners and tract descriptions which have actually been consolidated (by communitization, unitization, forced-pooling, or otherwise) or until a non-standard unit, eliminating such interests, has been approved by the Commission. RECEIVED
JUL 13 1970

No allowable will be assigned to the well until all interests have been consolidated (by communitization, unitization, forced-pooling, or otherwise) or until a non-standard unit, eliminating such interests, has been approved by the Commission.

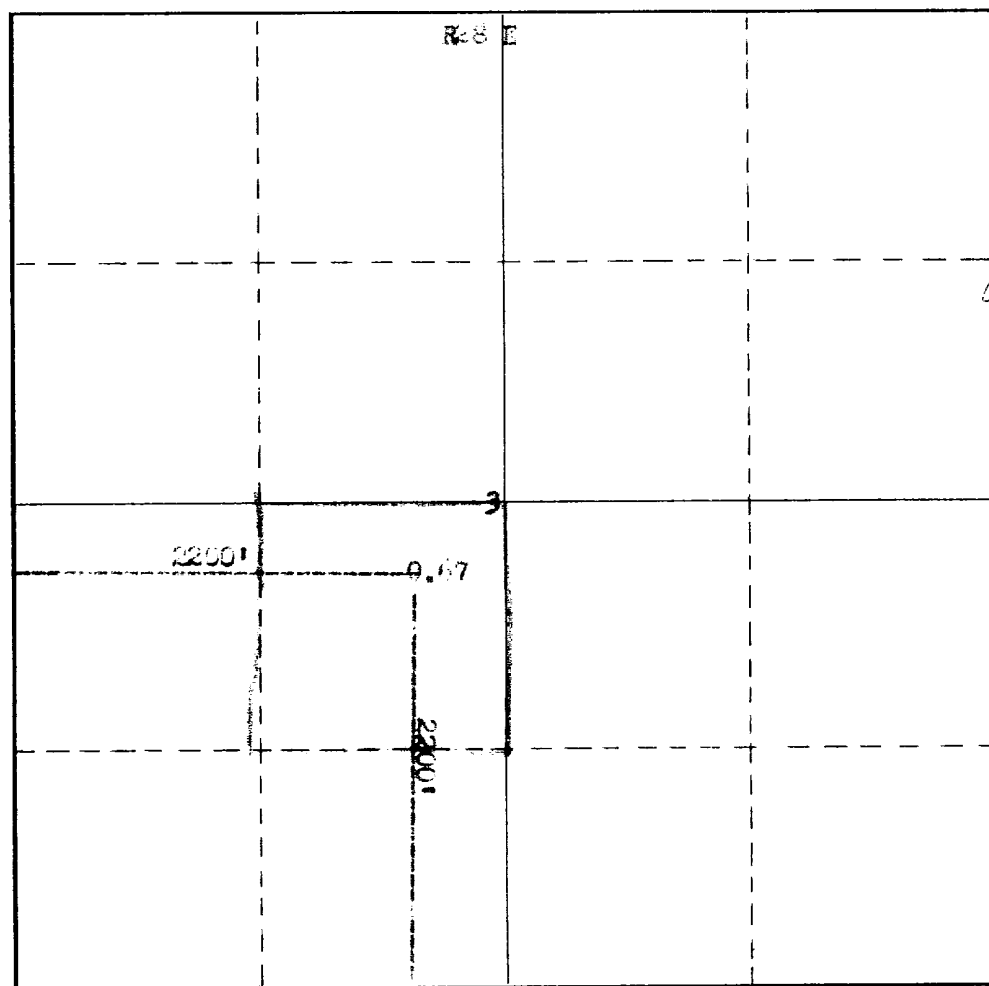

CERTIFICATION

I hereby certify that the information contained herein is true and complete to the best of my knowledge and belief.

Name D. R. Mason
Position Chief Production Clerk
Company DEPCO, Inc.
Date 7-9-70

I hereby certify that the well location shown on this plat was plotted from field notes of actual surveys made by me or under my supervision, and that the same is true and correct to the best of my knowledge and belief.

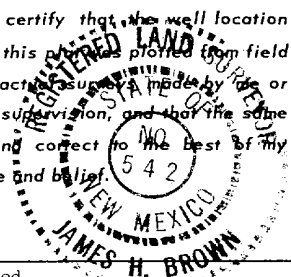

Date Surveyed July 1st 1970
Registered Professional Engineer and/or Land Surveyor

James H. Brown
Certificate No.

N.M.L.S. No. 542

T
18
S



30-015-3000

10-2000

10-2000

10-2000

1

4-17-98
Comp. Neutron
10' - 2992
Chambers Reg
Correlation/CC & Reg
700' - 3064'
B-100-4-1