

NO. OF COPIES RECEIVED	5
DISTRIBUTION	
SANTA FE	1
FILE	1
U.S.G.S.	2
LAND OFFICE	
OPERATOR	1

NEW MEXICO OIL CONSERVATION COMMISSION

RECEIVED

DEC 14 1970

O. C. C.
ARTESIA, OFFICE

30-015-20358

Form C-101
Revised 1-1-65

5A. Indicate Type of Lease	
STATE <input type="checkbox"/>	FEE <input checked="" type="checkbox"/>
5. State Oil & Gas Lease No.	
7. Unit Agreement Name	
8. Farm or Lease Name	
Brown-Yates Com	
9. Well No.	
1	
10. Field and Pool, or Wildcat	
Undesignated	
12. County	
Eddy	
19. Proposed Depth	19A. Formation
9000'	Morrow
20. Rotary or C.T.	
Rotary	
21. Elevations (Show whether DF, RT, etc.)	21A. Kind & Status Plug. Bond
3451 Grd.	Blanket
21B. Drilling Contractor	22. Approx. Date Work will start
Warton Drilling Co.	12-15-70

APPLICATION FOR PERMIT TO DRILL, DEEPEN, OR PLUG BACK

1a. Type of Work	
DRILL <input checked="" type="checkbox"/>	DEEPEN <input type="checkbox"/>
b. Type of Well	
OIL WELL <input type="checkbox"/>	GAS WELL <input checked="" type="checkbox"/>
OTHER	
2. Name of Operator	
David Fasken	
3. Address of Operator	
608 First National Bank Building, Midland, Texas 79701	
4. Location of Well	
UNIT LETTER I	LOCATED 990 FEET FROM THE East LINE
AND 1650 FEET FROM THE South LINE OF SEC. 24	TWP. 18 S RGE. 25 E NMPM
19. Proposed Depth	
9000'	
19A. Formation	
Morrow	
20. Rotary or C.T.	
Rotary	
21. Elevations (Show whether DF, RT, etc.)	21A. Kind & Status Plug. Bond
3451 Grd.	Blanket
21B. Drilling Contractor	22. Approx. Date Work will start
Warton Drilling Co.	12-15-70

23. PROPOSED CASING AND CEMENT PROGRAM

SIZE OF HOLE	SIZE OF CASING	WEIGHT PER FOOT	SETTING DEPTH	SACKS OF CEMENT	EST. TOP
17-1/2"	13-3/8"	48#	500'	500	Circulate
12-1/4"	8-5/8"	24#	1300'	600	Circulate
7-7/8"	4-1/2"	Various	9000'	450	7000

1. Drill 17-1/2" hole to 500' w/mud and set 13-3/8" casing w/400 sxs. Halliburton-Lite plus 100 sxs. Incor neat - circulate. WOC 12 hrs.
2. Drill 12-1/4" hole to 1300' w/mud and set 8-5/8" casing w/400 sxs. Halliburton-Lite plus 200 sxs. Incor neat - circulate. WOC 12 hrs.
3. Test casing, casing spool, B.O.P. and choke manifold to 1500 psig.
4. Drill 7-7/8" hole to T.D. w/water (to estimated 6800') and mud (on to T.D.).
5. Drill stem test all shows of oil or gas.
6. Log open hole.
7. Set and cement 4-1/2" casing with 450 sxs. Incor.
8. Perforate pay zones.
9. B.O.P., 12" - 600 Series on surface casing.
10. B.O.P., 10" - 900 Series on intermediate casing.

APPROVAL VALID
FOR 90 DAYS UNLESS
DRILLING COMMENCED,
EXPIRES 3-14-71

IN ABOVE SPACE DESCRIBE PROPOSED PROGRAM: IF PROPOSAL IS TO DEEPEN OR PLUG BACK, GIVE DATA ON PRESENT PRODUCTIVE ZONE AND PROPOSED NEW PRODUCTIVE ZONE. GIVE BLOWOUT PREVENTER PROGRAM, IF ANY.

I hereby certify that the information above is true and complete to the best of my knowledge and belief.

Signed S. L. Parks Title Agent Date 12-11-70

(This space for State Use)

APPROVED BY W. A. Gressett TITLE OIL AND GAS INSPECTOR DATE DEC 14 1970

CONDITIONS OF APPROVAL, IF ANY:

Cement must be circulated to
surface behind 13 3/8" + 8 5/8" casing

Notify N.M.O.C.C. in sufficient
time to witness cementing
the 8 5/8" casing

**NEW MEXICO OIL CONSERVATION COMMISSION
WELL LOCATION AND ACREAGE DEDICATION PLAT**

Form C-102
Supersedes C-128
Effective 1-1-65

All distances must be from the outer boundaries of the Section

Operator DAVID FASKEN			Lease BROWN - YATES Com		Well No. 1
Unit Letter I	Section 24	Township 16 South	Range 25 East	County Eddy	
Actual Footage Location of Well:					
1650	feet from the South	line and	990	feet from the East	line
Ground Level Elev 3451	Producing Formation Morrow	Pool Atoka Penn. Undesignated	Dedicated Acreage: 320 Acres		

1. Outline the acreage dedicated to the subject well by colored pencil or hatchure marks on the plat below.
2. If more than one lease is dedicated to the well, outline each and identify the ownership thereof (both as to working interest and royalty).
3. If more than one lease of different ownership is dedicated to the well, have the interests of all owners been consolidated by communitization, unitization, force-pooling, etc?

☒ Yes ☐ No If answer is "yes," type of consolidation Communitization

If answer is "no," list the owners and tract descriptions which have actually been consolidated. (Use reverse side of this form if necessary) _____

No allowable well be assigned to the well until all interests have been consolidated (by communitization, unitization, forced-pooling, or otherwise) or until a non-standard unit, eliminating such interests, has been approved by the Commission.

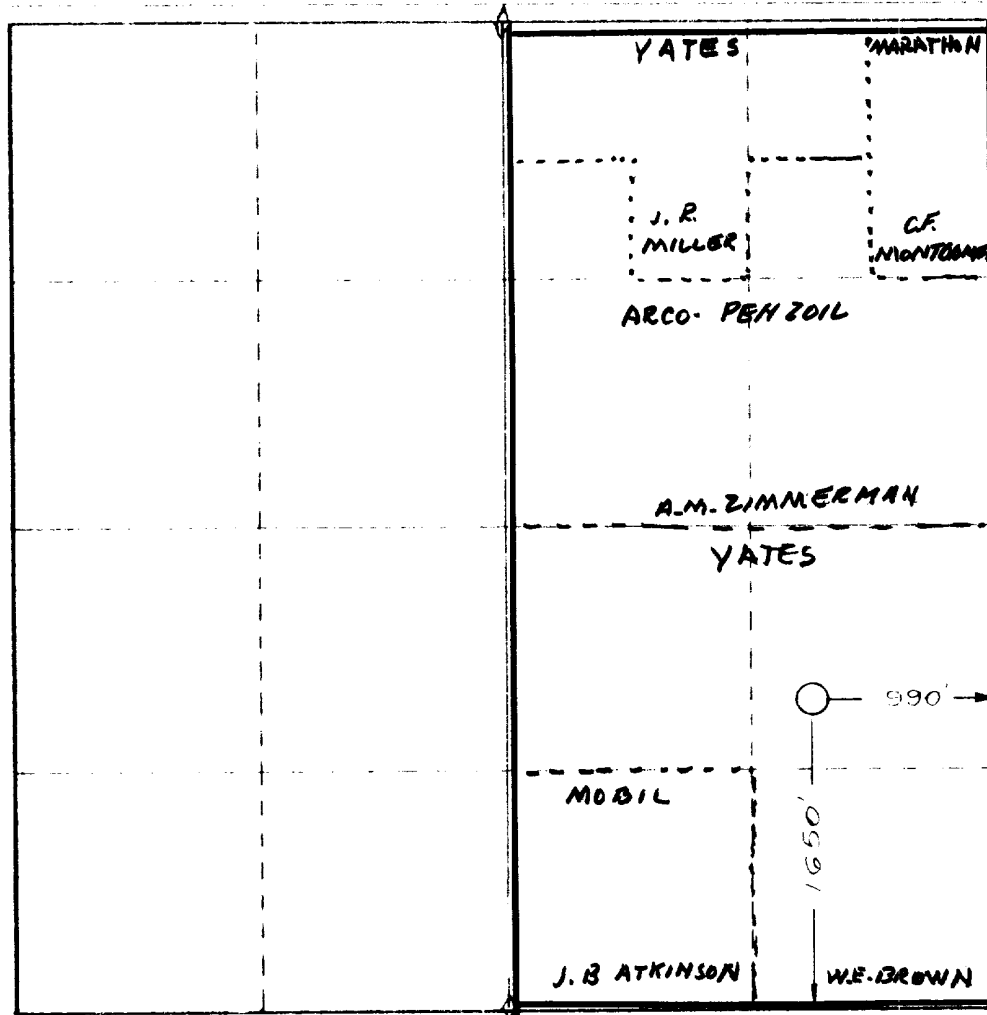

CERTIFICATION

I hereby certify that the information contained herein is true and complete to the best of my knowledge and belief.

Signature: *James B. Henry*
Name: **James B. Henry**

Position:
Agent

Company:
David Fasken

Date:
12-11-70

I hereby certify that the well location shown on this plat was plotted from field notes of actual surveys made by me or under my supervision, and that the same is true and correct to the best of my knowledge and belief.

Date Surveyed:
November 27, 1970

Registered Professional Engineer and/or Land Surveyor

Signature: *John W. Shearn*
Certificate No.: **1559**

Scale: 0 500 1000 1500 2000 2500 3000 3500 4000 4500 5000 5500 6000 6500 7000 7500 8000 8500 9000 9500 10000