

NEW MEXICO OIL CONSERVATION COMMISSION
WELL LOCATION AND ACREAGE DEDICATION PLAT

Form C-102
Supersedes C-128
Effective 1-1-65

All distances must be from the outer boundaries of the Section.

Operator THE EASTLAND OIL COMPANY		Lease ALLIED FEDERAL		Well No. 2
Unit Letter B	Section 6	Township 18 SOUTH	Range 31 EAST	County EDDY
Actual Footage Location of Well: 660 feet from the NORTH line and 1980 feet from the EAST line				
Ground Level Elev. 3633	Producing Formation Grayburg	Pool Undesignated	Dedicated Acreage: 40 39.98 Acres	

1. Outline the acreage dedicated to the subject well by colored pencil or hachure marks on the plat below.
2. If more than one lease is dedicated to the well, outline each and identify the ownership thereof (both as to working interest and royalty).
3. If more than one lease of different ownership is dedicated to the well, have the interests of all owners been consolidated by communitization, unitization, force-pooling, etc?

☐ Yes ☐ No If answer is "yes," type of consolidation _____

If answer is "no," list the owners and tract descriptions which have actually been consolidated. (Use reverse side of this form if necessary.) _____

No allowable will be assigned to the well until all interests have been consolidated (by communitization, unitization, forced-pooling, or otherwise) or until a non-standard unit, eliminating such interests, has been approved by the Commission.

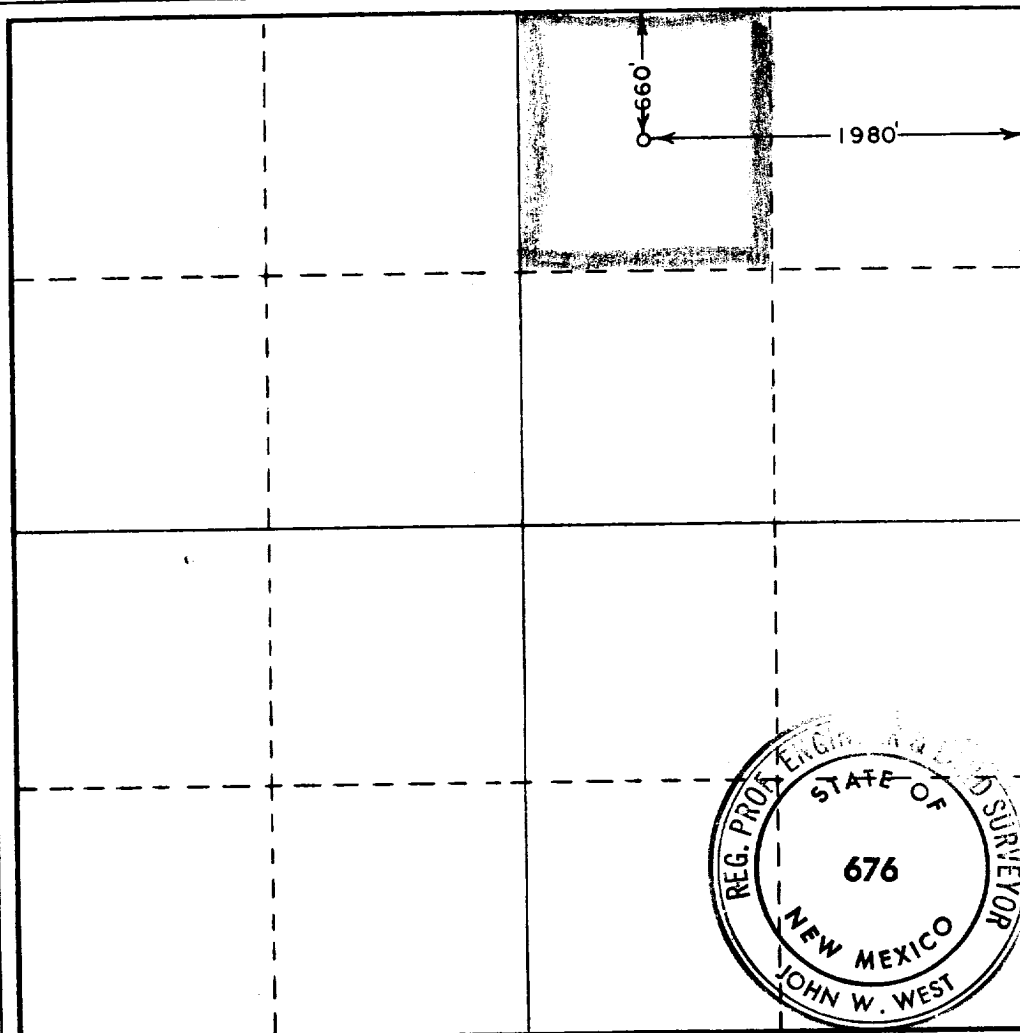

CERTIFICATION

I hereby certify that the information contained herein is true and complete to the best of my knowledge and belief.

Name
George D. Neal

Position
Vice-President

Company
The Eastland Oil Company

Date
December 24, 1970

I hereby certify that the well location shown on this plat was plotted from field notes of actual surveys made by me or under my supervision, and that the same is true and correct to the best of my knowledge and belief.

Date Surveyed
DECEMBER 18, 1970

Registered Professional Engineer and/or Land Surveyor

John W. West
Certificate No. **676**

0 220 440 660 880 1100 1320 1540 1760 1980 2200 2420 2640 2860 3080 3300 3520 3740 3960 4180 4400 4620 4840 5060 5280 5500 5720 5940 6160 6380 6600