

N. M. O. C. C. COBY

SUBMIT IN ' LIGATE*
(Other instructions on
reverse side)Form approved.
Budget Bureau No. 42-R1425.UNITED STATES
DEPARTMENT OF THE INTERIOR
GEOLOGICAL SURVEY

30-C15-20380

APPLICATION FOR PERMIT TO DRILL, DEEPEN, OR PLUG BACK

1a. TYPE OF WORK

DRILL ☒DEEPEN ☐PLUG BACK ☐

5. LEASE DESIGNATION AND SERIAL NO.

NM 0299468

6. IF INDIAN, ALLOTTEE OR TRIBE NAME

7. UNIT AGREEMENT NAME

8. FARM OR LEASE NAME

ARCO-Federal

9. WELL NO.

three (3)

10. FIELD AND POOL, OR WILDCAT

Power Grayburg-San Andres

11. SEC., T., R., M., OR BLK.

Section 5,

T-18-S, R-31-E

12. COUNTY OR PARISH 13. STATE

b. TYPE OF WELL

OIL
WELL ☒GAS
WELL ☐

OTHER

SINGLE
ZONE ☒MULTIPLE
ZONE ☐

2. NAME OF OPERATOR

The Eastland Oil Company

3. ADDRESS OF OPERATOR

704 Western United Life Building, Midland, Texas 79701

4. LOCATION OF WELL (Report location clearly and in accordance with any State requirements.)*

At surface

330 feet from the North line and 1980 feet from the West line.

At proposed prod. zone same

14. DISTANCE IN MILES AND DIRECTION FROM NEAREST TOWN OR POST OFFICE*

9 miles SE Loco Hills, New Mexico

15. DISTANCE FROM PROPOSED* LOCATION TO NEAREST PROPERTY OR LEASE LINE, FT. (Also to nearest drilg. unit line, if any)

330' from lease line

330' from unit line

16. NO. OF ACRES IN LEASE

160

17. NO. OF ACRES ASSIGNED TO THIS WELL

40

18. DISTANCE FROM PROPOSED LOCATION*

TO NEAREST WELL, DRILLING, COMPLETED, OR APPLIED FOR, ON THIS LEASE, FT.

1170' from well

19. PROPOSED DEPTH

3,700

20. ROTARY OR CABLE TOOLS

Rotary

21. ELEVATIONS (Show whether DF, RT, GR, etc.)

3704' GR, 3714' DF

22. APPROX. DATE WORK WILL START*

2/15/71

23.

PROPOSED CASING AND CEMENTING PROGRAM

SIZE OF HOLE	SIZE OF CASING	WEIGHT PER FOOT	SETTING DEPTH	QUANTITY OF CEMENT
11"	8-5/8"	20 #	700'	350 sx reg. 2% CaCl ₂
7-7/8"	6-1/2"	9.5#	3700'	250 sx Incor-Fox 2% gel.

API 3M-8-Rd blowout preventor

IN ABOVE SPACE DESCRIBE PROPOSED PROGRAM: If proposal is to deepen or plug back, give data on present productive zone and proposed new productive zone. If proposal is to drill or deepen directionally, give pertinent data on subsurface locations and measured and true vertical depths. Give blowout preventer program, if any.

24.

SIGNED

TITLE

Vice President

DATE

Feb. 5, 1971

(This space for Federal or State office use)

PERMIT NO.

APPROVAL DATE

DATE

APPROVED
FEB 10 1971
R. L. BEEKMAN
ACTING DISTRICTTHIS APPROVAL IS RESCINDED IF OPERATIONS
ARE NOT COMMENCED WITHIN 2 MONTHS
EXPIRES
MAY 10 1971
*See Instructions On Reverse Side

Instructions

General: This form is designed for submitting proposals to perform certain well operations, as indicated, on all types of lands and leases for appropriate action by either a Federal or a State agency, or both, pursuant to applicable Federal and State laws and regulations. Any necessary special instructions concerning the use of this form and the number of copies to be submitted, particularly with regard to local, area, or regional procedures and practices, either are shown below or will be issued by, or may be obtained from, the local Federal and/or State office.

Item 1: If the proposal is to redrill to the same location as a different subsurface location or to a new reservoir, use this form with appropriate notations. Consult applicable State or Federal regulations concerning the proposed well proposals or reports on the well.

Item 4: If there are no applicable State regulations, the location of the well should be described in accordance with Federal requirements. Consult local State or Federal office for specific instructions.

Item 14: Needed only when location of well cannot readily be found by road from the land or lease description. A plat, or plats, separate or on this reverse side, showing the roads to, and the surveyed location of, the well, and other required information, should be furnished when required by Federal or State agency offices.

Items 15 and 18: If well is to be, or has been directionally drilled, give distances for subsurface location of hole in any present or objective production zone.

Item 22: Consult applicable Federal or State regulations, or appropriate officials, concerning approval of the proposal before operations are started.

NEW MEXICO OIL CONSERVATION COMMISSION
WELL LOCATION AND ACREAGE DEDICATION PLAT

Form C-102
Supersedes C-128
Effective 1-1-65

All distances must be from the outer boundaries of the Section.

Operator THE EASTLAND OIL CO.			Lease ARCO FEDERAL		Well No. 3
Unit Letter C	Section 5	Township 18 SOUTH	Range 31 EAST	County EDDY	
Actual Footage Location of Well: 330 feet from the NORTH line and 1980 feet from the WEST line					
Ground Level Elev. 3703.5	Producing Formation Grayburg San Andres	Pool <i>under</i> Power Grayburg - San Andres		Dedicated Acreage: 40 Acres	

1. Outline the acreage dedicated to the subject well by colored pencil or hatchure marks on the plat below.
2. If more than one lease is dedicated to the well, outline each and identify the ownership thereof (both as to working interest and royalty).
3. If more than one lease of different ownership is dedicated to the well, have the interests of all owners been consolidated by communitization, unitization, force-pooling, etc?

☐ Yes ☐ No If answer is "yes," type of consolidation _____

If answer is "no," list the owners and tract descriptions which have actually been consolidated. (Use reverse side of this form if necessary.) _____

No allowable will be assigned to the well until all interests have been consolidated (by communitization, unitization, forced-pooling, or otherwise) or until a non-standard unit, eliminating such interests, has been approved by the Commission.

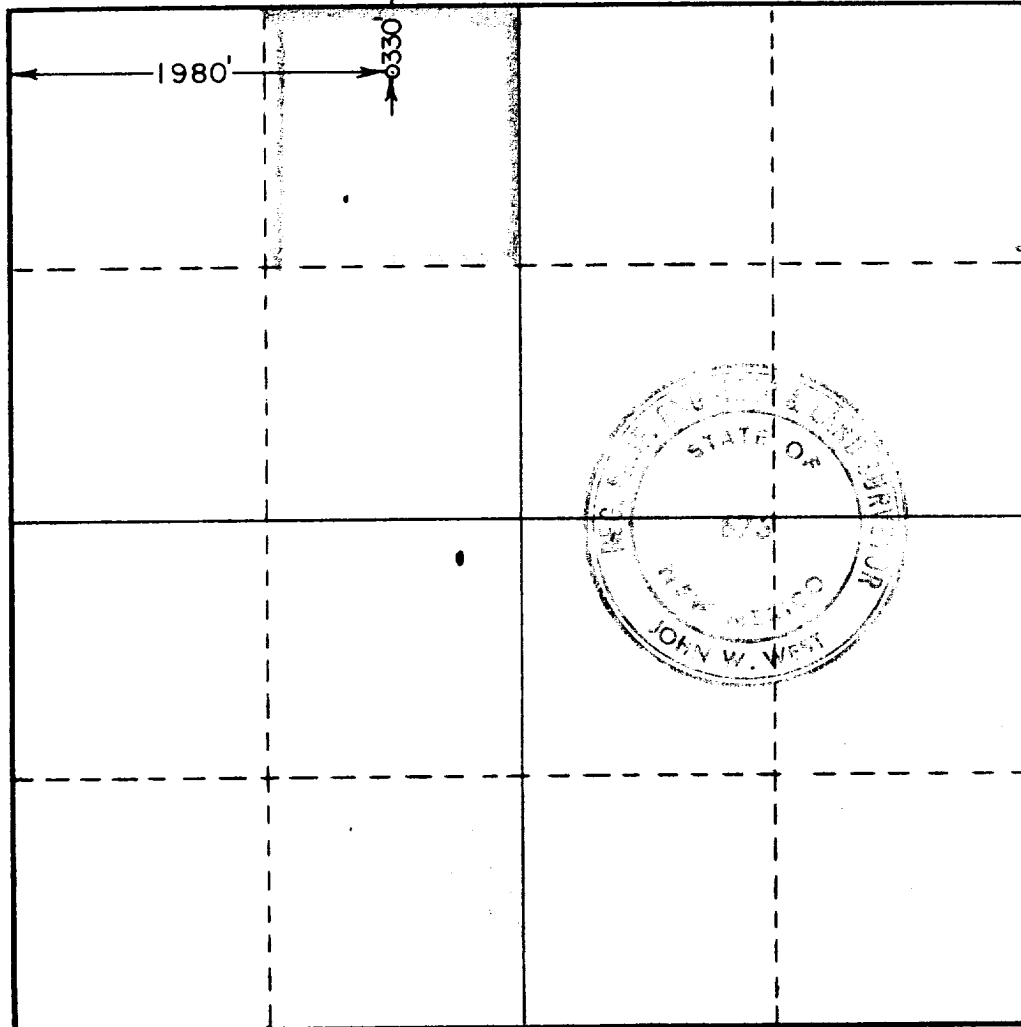

CERTIFICATION

I hereby certify that the information contained herein is true and complete to the best of my knowledge and belief.

George D. Neal
Name

George D. Neal

Position

Vice President

Company

The Eastland Oil Company

Date

February 5, 1971

RECEIVED
FEB 9 1971

I hereby certify that the well location shown on this plat was plotted from field notes of actual survey or from the original survey or under the supervision of the undersigned and is true to the best of my knowledge and belief.

Date Surveyed

JANUARY 29, 1971

Registered Professional Engineer and/or Land Surveyor

John W. West
Certificate No.

676

0 320 640 960 1280 1600 1920 2240 2560 2880 3200 3520 3840 4160 4480 4800 5120 5440 5760 6080 6400