

UNITED STATES
DEPARTMENT OF THE INTERIOR
GEOLOGICAL SURVEY

APPLICATION FOR PERMIT TO DRILL, DEEPEN, OR PLUG BACK

1a. TYPE OF WORK

DRILL ☒

RECEIVED

PLUG BACK ☐

b. TYPE OF WELL

OIL
WELL ☒GAS
WELL ☐OTHER ☐SINGLE
ZONE ☐MULTIPLE
ZONE ☐

2. NAME OF OPERATOR

The Eastland Oil Company

3. ADDRESS OF OPERATOR

704 Western United Life Building, El Paso, Texas 79701

4. LOCATION OF WELL (Report location clearly and in accordance with any State requirements.)*

At surface

1650 feet from North line and 660 feet from West line

At proposed prod. zone

14. DISTANCE IN MILES AND DIRECTION FROM NEAREST TOWN OR POST OFFICE*

10 miles SE Loco Hills, New Mexico

15. DISTANCE FROM PROPOSED* LOCATION TO NEAREST PROPERTY OR LEASE LINE, FT. (Also to nearest drilg. unit line, if any)

660' from lease line

330' from unit line

18. DISTANCE FROM PROPOSED LOCATION*

TO NEAREST WELL, DRILLING, COMPLETED, OR APPLIED FOR, ON THIS LEASE, FT.

990'

16. NO. OF ACRES IN LEASE

2K 307

19. PROPOSED DEPTH

2000'

17. NO. OF ACRES ASSIGNED TO THIS WELL

34 (Lot 5)

20. ROTARY OR CABLE TOOLS

Rotary

21. ELEVATIONS (Show whether DF, RT, GR, etc.)

22. APPROX. DATE WORK WILL START*

June 1, 1971

23.

PROPOSED CASING AND CEMENTING PROGRAM

SIZE OF HOLE	SIZE OF CASING	WEIGHT PER FOOT	SETTING DEPTH	QUANTITY OF CEMENT
15"	12-3/4	32	30'	20 sk to circulate
11"	8-5/8	20	700'	350 sk reg. 21 sk
7-7/8"	4-1/2	9.5	Total depth	250 sk Incer-Pos 27 sk

Drilling procedure proposed:

1. Set 1 joint conductor @ approx. 35' and cement to surface using rat-hole.
2. Drill to 700' with 11" hole using rotary rig.
3. Reduce hole to 7-7/8" and drill no deeper than 2000' to evaluate formations.
4. If well is considered to have productive possibilities in deeper horizons:
 - a. Application will be made to drill deeper and,
 - b. 8-5/8" casing will be set at 700' and cemented as outlined above.
5. If well is dry and no additional drilling is planned below 2000', application will be made to plug and abandon using plugging procedure as recommended.
6. No completion string of casing will be run without first setting and cementing surface casing to approx. 700 feet.

IN ABOVE SPACE DESCRIBE PROPOSED PROGRAM: If proposal is to deepen or plug back, give data on present productive zone and proposed new productive zone. If proposal is to drill or deepen directionally, give pertinent data on subsurface locations and measured and true vertical depths. Give blowout preventer program, if any.

24.

SIGNED

TITLE Vice President

DATE May 25, 1971

(This space for Federal or State office use)

PERMIT NO.

APPROVAL DATE

APPROVED BY

TITLE OF OPERATIONS

DATE

APPROVED
MAY 25 1971
R. L. BEEKMAN
ACTING DISTRICT ENGINEERTHIS APPROVAL IS RECORDED
ARE NOT COMMENCED WITHIN 3 MONTHS.
EXPIRES
AUG 26 1971This well replaces previous
application of location
1980/W 9 660/W 6-18-31
which was never drilled.

5. LEASE DESIGNATION AND SERIAL NO.

LC-029389 (e)

6. IF INDIAN, ALLOTTEE OR TRIBE NAME

7. UNIT AGREEMENT NAME

8. FARM OR LEASE NAME

Kenwood Federal

9. WELL NO.

2

10. FIELD AND POOL, OR WILDCAT

Indesignated

11. SEC., T., R., M., OR BLK.
AND SURVEY OR AREASection 6,
T-18-S, R-31-E

12. COUNTY OR PARISH

13. STATE

Eddy

New Mexico

Instructions

General: This form is designed for submitting proposals to perform certain well operations, as indicated, on all types of lands and leases for appropriate action by either a Federal or a State agency, or both, pursuant to applicable Federal and/or State laws and regulations. Any necessary special instructions concerning the use of this form and the number of copies to be submitted, particularly with regard to local, area, or regional procedures and practices, either are shown below or will be issued by, or may be obtained from, the local Federal and/or State office.

Item 1: If the proposal is to redrill to the same reservoir at a different subsurface location or to a new reservoir, use this form with appropriate notations. Consult applicable State or Federal regulations concerning subsequent work proposals or reports on the well.

Item 4: If there are no applicable State requirements, locations on Federal or Indian land should be described in accordance with Federal requirements. Consult local State or Federal office for specific instructions.

Item 14: Needed only when location of well cannot readily be found by road from the land or lease description. A plat, or plats, separate or on this reverse side, showing the roads to, and the surveyed location of, the well, and any other required information, should be furnished when required by Federal or State agency offices.

Items 15 and 18: If well is to be, or has been directionally drilled, give distances for subsurface location of hole in any present or objective production zone.

Item 22: Consult applicable Federal or State regulations, or appropriate officials, concerning approval of the proposal before operations are started.

NEW MEXICO OIL CONSERVATION COMMISSION
WELL LOCATION AND ACREAGE DEDICATION PLAT

Form C-102
Supersedes C-128
Effective 1-1-65

All distances must be from the outer boundaries of the Section.

Operator THE EASTLAND OIL CO.			Lease KENWOOD FEDERAL		Well No. 2
Unit Letter E	Section 6	Township 18 SOUTH	Range 31 EAST	County EDDY	
Actual Footage Location of Well: 1650 feet from the NORTH line and 660 feet from the WEST line					
Ground Level Elev.	Producing Formation Yates		Pool Wildcat Undesignated	Dedicated Acreage: 33.76 34 Acres	

1. Outline the acreage dedicated to the subject well by colored pencil or hachure marks on the plat below.
2. If more than one lease is dedicated to the well, outline each and identify the ownership thereof (both as to working interest and royalty).
3. If more than one lease of different ownership is dedicated to the well, have the interests of all owners been consolidated by communitization, unitization, force-pooling, etc?

☐ Yes ☐ No If answer is "yes," type of consolidation _____

If answer is "no," list the owners and tract descriptions which have actually been consolidated. (Use reverse side of this form if necessary.) _____

No allowable will be assigned to the well until all interests have been consolidated (by communitization, unitization, forced-pooling, or otherwise) or until a non-standard unit, eliminating such interests, has been approved by the Commission.

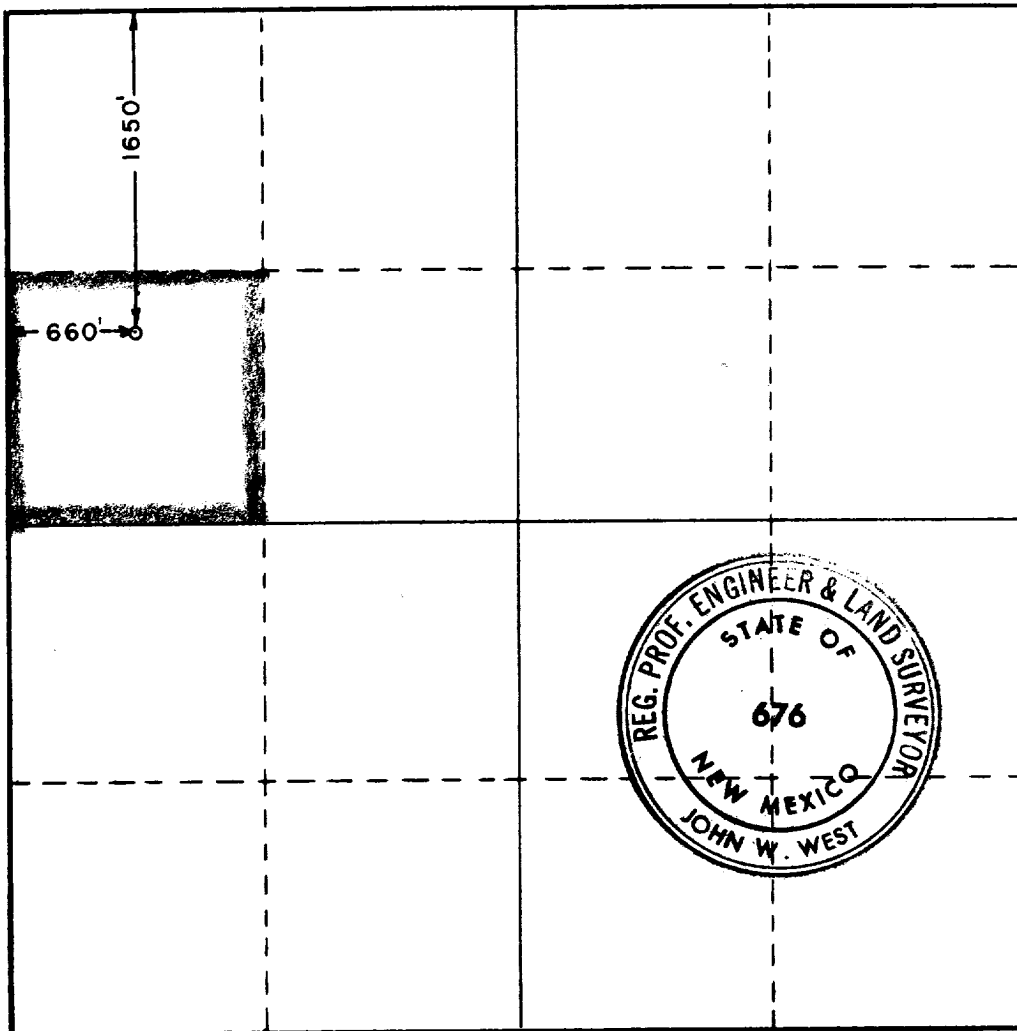

CERTIFICATION

I hereby certify that the information contained herein is true and complete to the best of my knowledge and belief.

Name

Rex J. Power

Position

Office Manager

Company

The Eastland Company

Date

May 25, 1971

I hereby certify that the well location shown on this plat was plotted from field notes of actual surveys made by me or under my supervision, and that the same is true and correct to the best of my knowledge and belief.

Date Surveyed

MAY 25, 1971

Registered Professional Engineer and/or Land Surveyor

Certificate No.

676