

NEW MEXICO OIL CONSERVATION COMMISSION
WELL LOCATION AND ACREAGE DEDICATION PLAT

Form C-102
Supersedes C-128
Effective 1-4-65

All distances must be from the outer boundaries of the Section.

Operator THE EASTLAND OIL CO.			Lease "A" ALLIED FEDERAL		Well No. 1
Unit Letter M	Section 31	Township 17 SOUTH	Range 31 EAST	County EDDY	
Actual Footage Location of Well: 330 feet from the SOUTH line and 660 feet from the WEST line					
Ground Level Elev. 3606	Producing Formation Grayburg-San Andres		Pool and Power Grayburg-San Andres	Dedicated Acreage: 34 Acres	

1. Outline the acreage dedicated to the subject well by colored pencil or hachure marks on the plat below.
2. If more than one lease is dedicated to the well, outline each and identify the ownership thereof (both as to working interest and royalty).
3. If more than one lease of different ownership is dedicated to the well, have the interests of all owners been consolidated by communitization, unitization, force-pooling, etc?

☐ Yes ☐ No If answer is "yes," type of consolidation _____

If answer is "no," list the owners and tract descriptions which have actually been consolidated. (Use reverse side of this form if necessary.) _____

No allowable will be assigned to the well until all interests have been consolidated (by communitization, unitization, forced-pooling, or otherwise) or until a non-standard unit, eliminating such interests, has been approved by the Commission.

RECEIVED

JUN 2 1971

O. E. C.
ARTESIA OFFICE

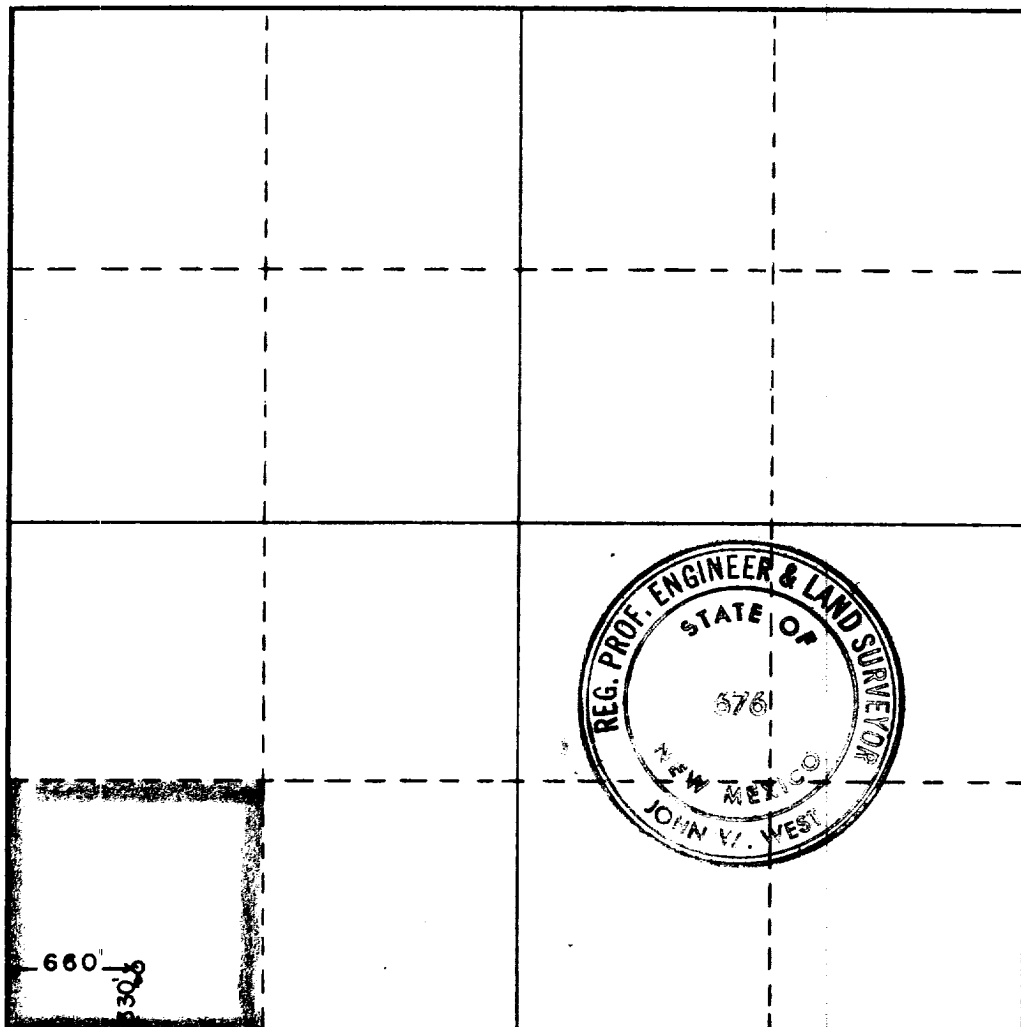

CERTIFICATION

I hereby certify that the information contained herein is true and complete to the best of my knowledge and belief.

Name *George D. Neal*

George D. Neal

Position

Vice President

Company

The Eastland Oil Company

Date

May 26, 1971

I hereby certify that the well location shown on this plat is true and correct to the best of my knowledge and belief.

RECEIVED
MAY 27 1971

U. S. GEOLOGICAL SURVEY
ARTESIA, NEW MEXICO

Date Surveyed

MAY 25, 1971

Registered Professional Engineer and/or Land Surveyor

John V. West
Certificate No. 676

