

UNITED STATES
DEPARTMENT OF THE INTERIOR
GEOLOGICAL SURVEY

APPLICATION FOR PERMIT TO DRILL, DEEPEN, OR PLUG BACK

1a. TYPE OF WORK

DRILL ☒DEEPEN ☐PLUG BACK ☐

b. TYPE OF WELL

OIL
WELL ☐GAS
WELL ☐

OTHER

Water Injection ☒SINGLE
ZONE ☒MULTIPLE
ZONE ☐

2. NAME OF OPERATOR

NEWMONT OIL COMPANY

3. ADDRESS OF OPERATOR

P. O. BOX 1305, ARTESIA, N.M. 88210

4. LOCATION OF WELL (Report location clearly and in accordance with any State requirements.)*

At surface

1400' FEL & 10 FNL Sec. 9-18S-29E

At proposed prod. zone

Same

14. DISTANCE IN MILES AND DIRECTION FROM NEAREST TOWN OR POST OFFICE*

ARTESIA, OFFICE

15. DISTANCE FROM PROPOSED*

LOCATION TO NEAREST
PROPERTY OR LEASE LINE, FT.
(Also to nearest drlg. line, if any)

18. DISTANCE FROM PROPOSED LOCATION*

TO NEAREST WELL, DRILLING, COMPLETED,
OR APPLIED FOR, ON THIS LEASE, FT.

16. NO. OF ACRES IN LEASE

19. PROPOSED DEPTH

2625'

17. NO. OF ACRES ASSIGNED
TO THIS WELL

40

20. ROTARY OR CABLE TOOLS

Rotary

21. ELEVATIONS (Show whether DF, RT, GR, etc.)

3508' Gr.

22. APPROX. DATE WORK WILL START*

23.

PROPOSED CASING AND CEMENTING PROGRAM

SIZE OF HOLE	SIZE OF CASING	WEIGHT PER FOOT	SETTING DEPTH	QUANTITY OF CEMENT
12	9 5/8"		330'	100 sacks
8 3/4"	4 1/2"	9.5#	2625'	200 sacks

We propose to drill a 12" hole to 330' and set 9 5/8" casing at 330' with 100 sacks of cement, drill 8 3/4" hole to 2625' and set 4 1/2" casing with 200 sacks.

Administrative Order NSL - 502 approves this well

RECEIVED

JUN 9 1971

U. S. GEOLOGICAL SURVEY
ARTESIA, NEW MEXICO

IN ABOVE SPACE DESCRIBE PROPOSED PROGRAM: If proposal is to deepen or plug back, give data on present productive zone and proposed new productive zone. If proposal is to drill or deepen directionally, give pertinent data on subsurface locations and measured and true vertical depths. Give blowout preventer program, if any.

24.

SIGNED

TITLE

Division Superintendent

DATE

6/8/71

(This space for Federal or State office use)

PERMIT NO.

APPROVAL DATE

DATE

APPROVED
JUN - 2 1971R. L. BECKMAN
ACTING DISTRICT ENGINEERTHIS APPROVAL IS RESCINDED IF OPERATIONS
ARE NOT COMMENCED WITHIN 3 MONTHS
EXPIRES
SEP - 9 1971

*See Instructions On Reverse Side

NEW MEXICO OIL CONSERVATION COMMISSION
WELL LOCATION AND ACREAGE DEDICATION PLAT

Form C-102
Supersedes C-128
Effective 1-1-65

All distances must be from the outer boundaries of the Section.

Operator Newmont Oil Company			Lease West Loco Hills Unit ^{G 45} 19B		Well No. 198 -7
Unit Letter B	Section 9	Township 18S	Range 29E	County Eddy	
Actual Footage Location of Well: 1400 feet from the East line and 10 feet from the North line					
Ground Level Elev. 3508	Producing Formation Grayburg		Pool Loco Hills	Dedicated Acreage: Acres	

1. Outline the acreage dedicated to the subject well by colored pencil or hachure marks on the plat below.
2. If more than one lease is dedicated to the well, outline each and identify the ownership thereof (both as to working interest and royalty).
3. If more than one lease of different ownership is dedicated to the well, have the interests of all owners been consolidated by communitization, unitization, force-pooling, etc?

☐ Yes ☐ No If answer is "yes," type of consolidation _____

If answer is "no," list the owners and tract descriptions which have actually been consolidated. (Use reverse side of this form if necessary.) _____

No allowable will be assigned to the well until all interests have been consolidated (by communitization, unitization, forced-pooling, or otherwise) or until a non-standard unit, eliminating such interests, has been approved by the Commission.

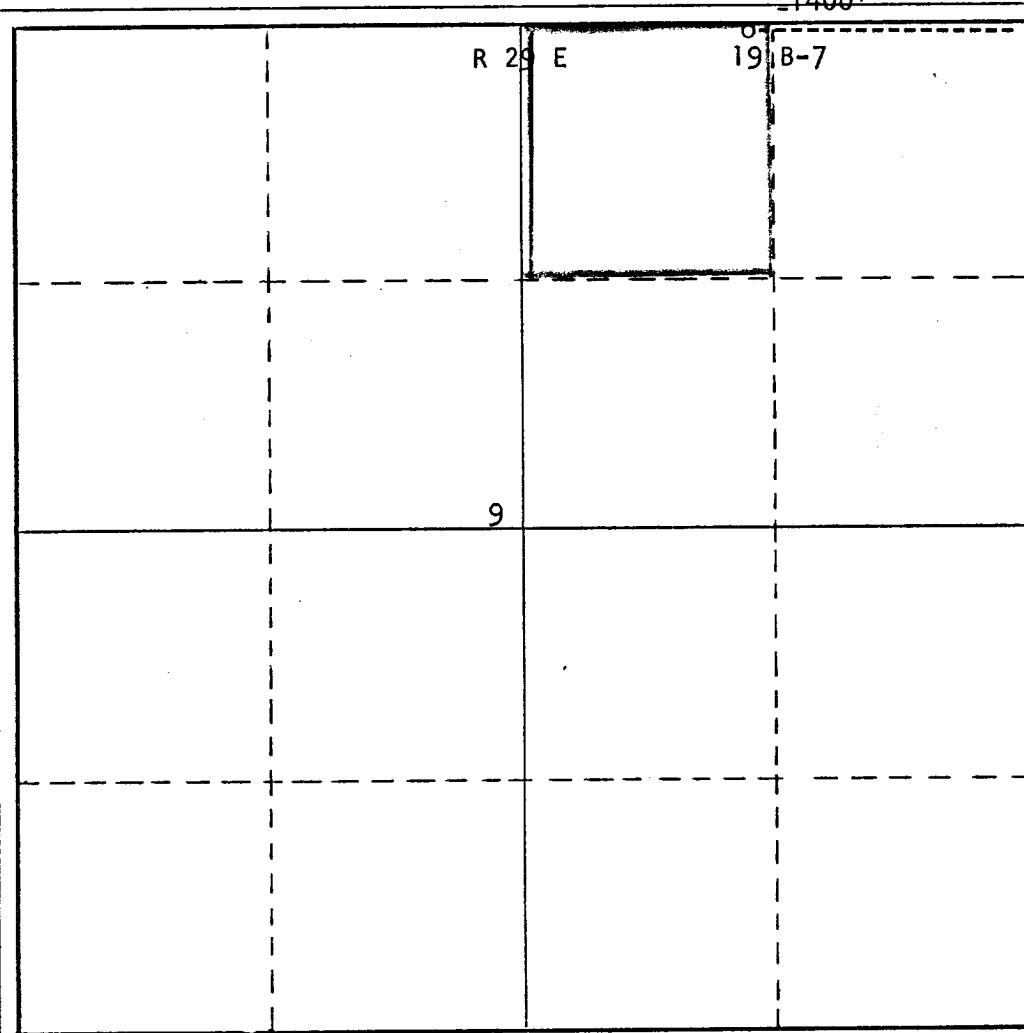

CERTIFICATION

I hereby certify that the information contained herein is true and complete to the best of my knowledge and belief.

Name
Harmon L. Lutter
Position
Division Superintendent

Company
Newmont Oil Company

Date
6/8/71

I hereby certify that the well location shown on this plat was plotted from notes of actual survey made by me or under my supervision, and that the same is true and correct to the best of my knowledge and belief.

RECEIVED
JUN 9 1971
U.S. GEOLOGICAL SURVEY
ARTESIA, NEW MEXICO

Date Surveyed
6/7/71

Registered Professional Engineer
and/or Land Surveyor

Harmon L. Lutter
Certificate No.

P. E. 3498