



UNITED STATES
DEPARTMENT OF THE INTERIOR
GEOLOGICAL SURVEY

P. O. Drawer 1857
Roswell, New Mexico 88201

October 8, 1971

Hanson Oil Corporation
Post Office Box 1515
Roswell, New Mexico 88201

Gentlemen:

Your Notice of Intention to Drill well No. 9 Ginsberg Federal in the SE¹/₄ sec. 26, T. 18 S., R. 30 E., N.M.P.M., Eddy County, New Mexico, lease New Mexico 025503, to a depth of 4,150 feet to test the Grayburg formation in the Potash Area, is hereby approved.

One copy of the Notice is returned herewith. Please notify the District Engineer, Geological Survey, Post Office Drawer U, Artesia, New Mexico, 88210, in sufficient time for a representative to witness all cementing operations.

Sincerely yours,

(ORIG. SGD.) N. O. FREDERICK

N. O. FREDERICK
Regional Oil and Gas Supervisor

Attachment

cc:
Washington
Mining Branch (2)
NMOCC-Artesia (2) (w/2 cys Notice) ✓
Artesia (w/cy Notice)
Roswell (2) (w/cy Notice)

RECEIVED

OCT 13 1971

O. C. C.
ARTESIA, OFFICE

1. The first part of the report is a general introduction to the subject of the study. It discusses the importance of the study and the objectives of the research.

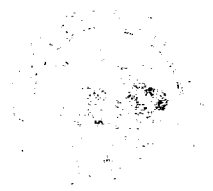

U.S. DEPARTMENT OF THE INTERIOR

Geological Survey

WATER RESOURCES DIVISION
WASHINGTON, D.C. 20506

UNITED STATES
DEPARTMENT OF THE INTERIOR
GEOLOGICAL SURVEY

30-015-20513

5. LEASE DESIGNATION AND SERIAL NO.

NM 025503

6. IF INDIAN, ALLOTTEE OR TRIBE NAME

7. UNIT AGREEMENT NAME

8. FARM OR LEASE NAME

Ginsberg Federal

9. WELL NO.

#9

10. FIELD AND POOL, OR WILDCAT

Shugart

11. SEC., T., R., M., OR BLK.
AND SURVEY OR AREA

Sec. 26, T-18S, R-30E

12. COUNTY OR PARISH

Eddy

N. Mex.

APPLICATION FOR PERMIT TO DRILL, DEEPEN, OR PLUG BACK

1a. TYPE OF WORK

DRILL ☒DEEPEN ☐PLUG BACK ☐

b. TYPE OF WELL

OIL
WELL ☒GAS
WELL ☐

OTHER

SINGLE
ZONE ☒MULTIPLE
ZONE ☐

2. NAME OF OPERATOR

Hanson Oil Corporation

3. ADDRESS OF OPERATOR

P. O. Box 1515 - Roswell, New Mexico 88201

4. LOCATION OF WELL (Report location clearly and in accordance with any State requirements.)*

At surface 1650' FNL & 330' FEL

At proposed prod. zone Sec. 26, T-18-S, R-30-E, NMPM

Eddy County, New Mexico

14. DISTANCE IN MILES AND DIRECTION FROM NEAREST TOWN OR POST OFFICE*

6 miles south of Loco Hills, New Mexico

15. DISTANCE FROM PROPOSED*

LOCATION TO NEAREST
PROPERTY OR LEASE LINE, FT.
(Also to nearest drlg. unit line, if any)

330'

16. NO. OF ACRES IN LEASE

800

17. NO. OF ACRES ASSIGNED
TO THIS WELL

40

18. DISTANCE FROM PROPOSED LOCATION*

TO NEAREST WELL, DRILLING, COMPLETED,
OR APPLIED FOR, ON THIS LEASE, FT.

1320'

19. PROPOSED DEPTH

4150'

20. ROTARY OR CABLE TOOLS

Rotary

21. ELEVATIONS (Show whether DF, RT, GR, etc.)

3485.1 GL

22. APPROX. DATE WORK WILL START*

October 11, 1971

23.

PROPOSED CASING AND CEMENTING PROGRAM

SIZE OF HOLE	SIZE OF CASING	WEIGHT PER FOOT	SETTING DEPTH	QUANTITY OF CEMENT
15"	12-3/4	33#	715'	166 sx. (circulate)
11"	8-5/8	23#	1740'	50 sx.
7-7/8"	5-1/2	15.5#	3900'	512 sx. (circulate)

We propose drilling the referenced well with rotary tools to a total depth of approximately 3900 feet or to a sufficient depth to test the Grayburg formation. Surface casing will be set in the top of the salt and cemented to the surface. A salt protection casing will be run to approximately 1740 feet (100 feet below the top of the salt) and cemented with 50 sacks. If commercial production is encountered the free portion of the salt protection casing will be pulled, 5-1/2 inch casing run to total depth, and cemented with a sufficient amount of cement to circulate to the surface. The well will then be stimulated as conditions indicate.

RECEIVED

OCT- 8 1971

IN ABOVE SPACE DESCRIBE PROPOSED PROGRAM: If proposal is to deepen or plug back, give data on present productive zone and proposed new productive zone. If proposal is to drill or deepen directionally, give pertinent data on subsurface locations and measured and true vertical depths. Give blowout preventer program, if any.

24.

SIGNED

Reagan Sweet

TITLE

Manager

DATE

October 7, 1971

(This space for Federal or State office use)

PERMIT NO.

APPROVAL DATE

RECEIVED

APPROVED BY

TITLE

DATE

CONDITIONS OF APPROVAL, IF ANY:

OCT 13 1971

N MEXICO OIL CONSERVATION COMMISS
WELL LOCATION AND ACREAGE DEDICATION PLAT

Form C-102
Supersedes C-128
Effective 1-1-65

All distances must be from the outer boundaries of the Section

Operator HANSON OIL CORP.		Lease GINSBURG FEDERAL		Well No. 9
Unit Letter H	Section 26	Township 18 SOUTH	Range 30 EAST	County EDDY
Actual Footage Location of Well: 1650 feet from the NORTH line and 330 feet from the EAST line				
Ground Level Elev. 3485.1	Producing Formation Yates, 7 Rivers, Queen, Grayburg		Pool und. Shugart	Dedicated Acreage: 40 Acres

1. Outline the acreage dedicated to the subject well by colored pencil or hachure marks on the plat below.
2. If more than one lease is dedicated to the well, outline each and identify the ownership thereof (both as to working interest and royalty).
3. If more than one lease of different ownership is dedicated to the well, have the interests of all owners been consolidated by communitization, unitization, force-pooling, etc?

☐ Yes ☐ No If answer is "yes," type of consolidation _____

If answer is "no," list the owners and tract descriptions which have actually been consolidated. (Use reverse side of this form if necessary.) _____

No allowable will be assigned to the well until all interests have been consolidated (by communitization, unitization, forced-pooling, or otherwise) or until a non-standard unit, eliminating such interests, has been approved by the Commission.

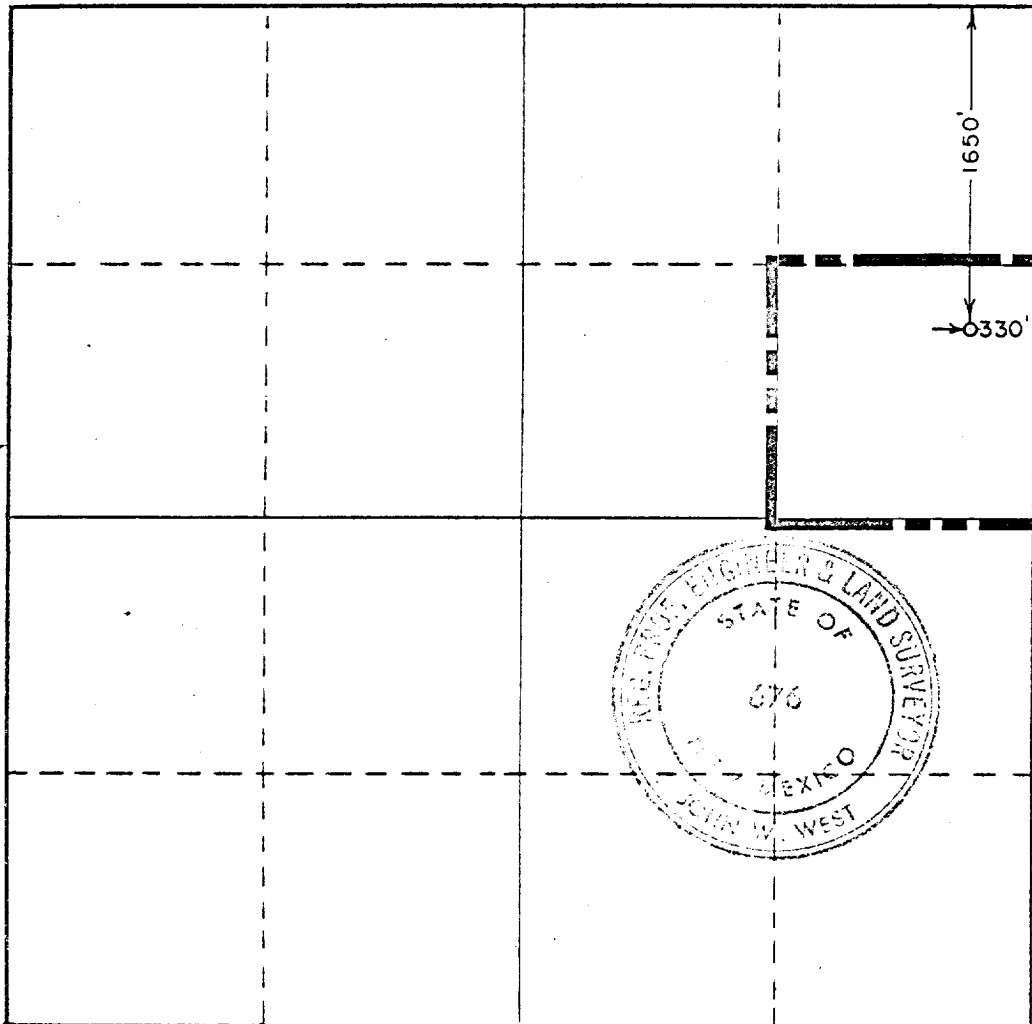

CERTIFICATION

I hereby certify that the information contained herein is true and complete to the best of my knowledge and belief.

Name Reagan Sweet
Position Manager

Company Hanson Oil Corporation

Date October 7, 1971

I hereby certify that the well location shown on this plat was plotted from field notes of actual location made by me or under my supervision, and that the same is true and correct to the best of my knowledge and belief.

RECEIVED
OCT-8-1971
U.S. GEOLOGICAL SURVEY
ARTIFICIAL

Date Surveyed

OCTOBER 4, 1971

Registered Professional Engineer and/or Land Surveyor

John W. West
Certificate No. **676**



N. M. O. C. C. COPY



POST OFFICE BOX 511 CARLSBAD NEW MEXICO 88220

October 8, 1971

Hanson Oil Corporation
P. O. Box 1515
Roswell, New Mexico 88201

Gentlemen:

Duval Corporation has no objection to the drilling of your proposed Ginsberg Federal #9 in Section 26 T-18-S, R-30-E, which is located 1,650 feet from the north line and 330 feet from the east line, Eddy County, New Mexico.

We understand that the casing requirements of R-111-A will be observed.

Very truly yours,

DUVAL CORPORATION

K. E. Elers, Resident Manager
Carlsbad Properties

KEE/aws

RECEIVED
OCT 12 1971
U. S. GEOLOGICAL SURVEY
ARTESIA, NEW MEXICO