



IN REPLY REFER TO:

UNITED STATES  
DEPARTMENT OF THE INTERIOR  
GEOLOGICAL SURVEY  
P. O. Drawer 1857  
Roswell, New Mexico 88201

November 1, 1971

RECEIVED

Hanson Oil Corporation  
Post Office Box 1515  
Roswell, New Mexico 88201

NOV 3 1971

O. C. C.  
ARTESIA, OFFICE

Gentlemen:

Your Notice of Intention to Drill well No. 11 Ginsburg Federal in the SE $\frac{1}{4}$  sec. 26, T. 18 S., R. 30 E., N.M.P.M., Eddy County, New Mexico, lease New Mexico 025901, to a depth of 4,150 feet to test the Grayburg formation in the Potash Area, is hereby approved.

One copy of the Notice is returned herewith. Please notify the District Engineer, Geological Survey, Post Office Drawer U, Artesia, New Mexico, 88210, in sufficient time for a representative to witness all cementing operations.

Sincerely yours,

(ORIG. 88-4) N. O. FREDERICK

N. O. FREDERICK  
Regional Oil and Gas Supervisor

Attachment

cc:  
Washington  
Mining Branch (2)  
/BIOCC-Artesia (2) (w/2 cys Notice)  
Artesia (w/cy Notice)  
Roswell (2) (w/cy Notice)

THE UNITED STATES OF AMERICA  
DEPARTMENT OF JUSTICE  
FEDERAL BUREAU OF INVESTIGATION  
WASHINGTON, D. C. 20535



CR 71-187

RE: [illegible]

[illegible]

[illegible]

[illegible]

[illegible]

[illegible]

[illegible]

[illegible]

[illegible]

UNITED STATES  
DEPARTMENT OF THE INTERIOR  
GEOLOGICAL SURVEY

30-015-20529

## APPLICATION FOR PERMIT TO DRILL, DEEPEN, OR PLUG BACK

## 1a. TYPE OF WORK

DRILL ☒DEEPEN ☐ PLUG BACK ☐

## b. TYPE OF WELL

OIL  
WELL ☒GAS  
WELL ☐OTHER ☐SINGLE  
ZONE ☒MULTIPLE  
ZONE ☐

## 2. NAME OF OPERATOR

Hanson Oil Corporation

## 3. ADDRESS OF OPERATOR

P. O. Box 1515 Roswell, New Mexico 88201

## 4. LOCATION OF WELL (Report location clearly and in accordance with any State requirements.)\*

At surface

990' FSL &amp; 330' FEL

At proposed prod. zone

Sec. 26, T-18-S, R-30-E, N.M.P.M.

Eddy County, New Mexico

## 14. DISTANCE IN MILES AND DIRECTION FROM NEAREST TOWN OR POST OFFICE\*

6 miles south of Loco Hills, New Mexico

## 15. DISTANCE FROM PROPOSED\*

LOCATION TO NEAREST

PROPERTY OR LEASE LINE, FT.

(Also to nearest drlg. unit line, if any)

330'

## 18. DISTANCE FROM PROPOSED LOCATION\*

TO NEAREST WELL, DRILLING, COMPLETED,

OR APPLIED FOR, ON THIS LEASE, FT.

1320'

## 16. NO. OF ACRES IN LEASE

800

## 19. PROPOSED DEPTH

4150'

## 17. NO. OF ACRES ASSIGNED

TO THIS WELL

40

## 20. ROTARY OR CABLE TOOLS

Rotary

## 21. ELEVATIONS (Show whether DF, RT, GR, etc.)

3456.3

## 22. APPROX. DATE WORK WILL START\*

Dec. 1, 1971

## 23.

## PROPOSED CASING AND CEMENTING PROGRAM

SIZE OF HOLE	SIZE OF CASING	WEIGHT PER FOOT	SETTING DEPTH	QUANTITY OF CEMENT
11"	8-5/8"	32#	730'	150 sx.
7-5/8"	5-1/2"	15.5#	3590'	275 sx.

We propose to drill the above captioned well with a Rotary to a depth of 3590' in the Grayburg formation. If oil or gas is encountered in commercial quantities, the proposed casing program will be followed. The production string will be cemented with a sufficient amount of cement to cover the loss of the salt-estimated base of salt 1640'. The well will be perforated and stimulated as conditions indicate.

RECEIVED  
OCT 27 1971  
U. S. GEOLOGICAL SURVEY  
ARTESIA, NEW MEXICO

IN ABOVE SPACE DESCRIBE PROPOSED PROGRAM: If proposal is to deepen or plug back, give data on present productive zone and proposed new productive zone. If proposal is to drill or deepen directionally, give pertinent data on subsurface locations and measured and true vertical depths. Give blowout preventer program, if any.

## 24.

SIGNED

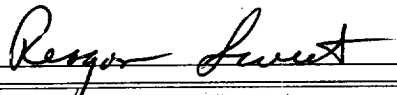

TITLE

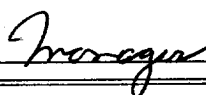

DATE

10-25-71

(This space for Federal or State office use)

PERMIT NO.

APPROVAL DATE

APPROVED BY

TITLE

CONDITIONS OF APPROVAL, IF ANY:

RECEIVED  
NOV 1 1971

NOV 1 1971

\*See Instructions On Reverse Side

NEW MEXICO OIL CONSERVATION COMMISSION  
WELL LOCATION AND ACREAGE DEDICATION PLAT

Form C-102  
Supersedes C-128  
Effective 1-1-65

All distances must be from the outer boundaries of the Section.

Operator <b>HANSON OIL CORP.</b>			Lease <b>GINSBERG FEDERAL</b>			Well No. <b>11</b>		
Unit Letter <b>P</b>	Section <b>26</b>	Township <b>18 SOUTH</b>	Range <b>30 EAST</b>	County <b>EDDY</b>				
Actual Footage Location of Well: 990 feet from the <b>SOUTH</b> line and 330 feet from the <b>EAST</b> line								
Ground Level Elev. <b>3456.3</b>	Producing Formation <b>Shugart</b>		Pool <b>Yates, Seven Rivers, Queen, Grayburg</b>			Dedicated Acreage: <b>40</b> Acres		

1. Outline the acreage dedicated to the subject well by colored pencil or hachure marks on the plat below.
2. If more than one lease is dedicated to the well, outline each and identify the ownership thereof (both as to working interest and royalty).
3. If more than one lease of different ownership is dedicated to the well, have the interests of all owners been consolidated by communitization, unitization, force-pooling, etc?

☐ Yes ☐ No If answer is "yes," type of consolidation \_\_\_\_\_

If answer is "no," list the owners and tract descriptions which have actually been consolidated. (Use reverse side of this form if necessary.) \_\_\_\_\_

No allowable will be assigned to the well until all interests have been consolidated (by communitization, unitization, forced-pooling, or otherwise) or until a non-standard unit, eliminating such interests, has been approved by the Commission.

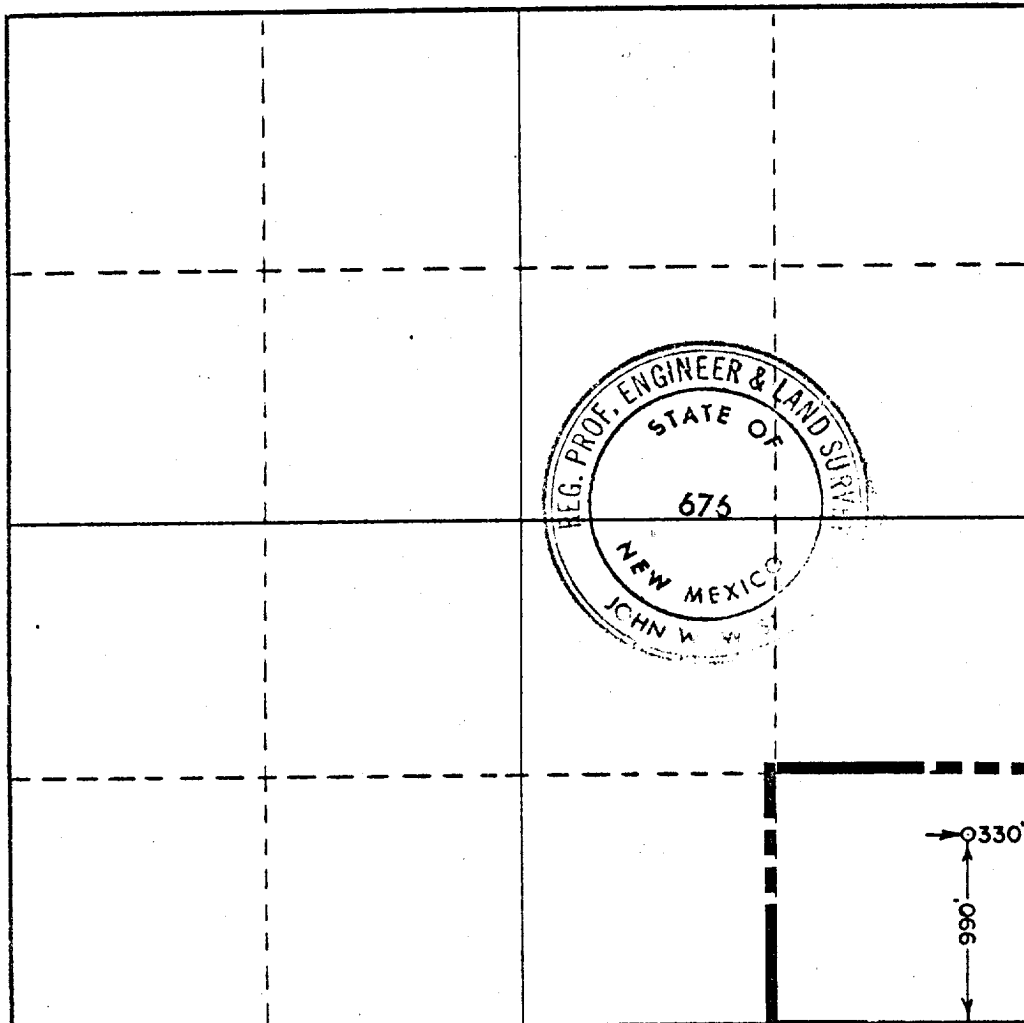

CERTIFICATION

I hereby certify that the information contained herein is true and complete to the best of my knowledge and belief.

Name *Reagan Sweet*  
Position **Manager**  
Company **Hanson Oil Corp.**

Date **October 26, 1971**

I hereby certify that the well location shown on this plat was obtained from field notes of actual surveys made by me or under my supervision, and that the same is true and correct to the best of my knowledge and belief.

Date Surveyed **OCTOBER 4, 1971**  
Registered Professional Engineer and/or Land Surveyor

*John W. West*  
Certificate No. **676**

