



UNITED STATES
DEPARTMENT OF THE INTERIOR
GEOLOGICAL SURVEY
P. O. Drawer 1357
Roswell, New Mexico 88201

RECEIVED

JAN 13 1972

D. C. C.
ARTESIA OFFICE

January 11, 1972

Hanson Oil Corporation
Post Office Box 1515
Roswell, New Mexico 88201

Gentlemen:

Your Notice of Intention to Drill well No. 12-Ginsberg Federal in the SW $\frac{1}{4}$ sec. 26, T. 13 S., R. 30 E., N.M.P.M., Eddy County, New Mexico, lease New Mexico 025503, to a depth of 3700 feet to test the Yates-Seven Rivers-Queen-Grayburg formation in the Potash Area, is hereby approved.

One copy of the Notice is returned herewith. Please notify the District Engineer, Geological Survey, Post Office Drawer U, Artesia, New Mexico, 88210, in sufficient time for a representative to witness all cementing operations.

Sincerely yours,

CARL C. TRAYWICK
Acting Oil and Gas Supervisor

Attachment

cc:

Washington

Mining Branch (2)

NMOC-~~Artesia~~ (2) (w/2 cys Notice)

Artesia (w/cy Notice)

Roswell (2) (w/cy Notice)

1



THE
LIBRARY OF THE
UNITED STATES DEPARTMENT OF AGRICULTURE
WASHINGTON, D. C.

UNITED STATES
DEPARTMENT OF THE INTERIOR
GEOLOGICAL SURVEY

30-015-20567

APPLICATION FOR PERMIT TO DRILL, DEEPEN, OR PLUG BACK

1a. TYPE OF WORK

DRILL ☒DEEPEN ☐PLUG BACK ☐

b. TYPE OF WELL

OIL
WELL ☒GAS
WELL ☐

OTHER

SINGLE
ZONE ☒MULTIPLE
ZONE ☐

2. NAME OF OPERATOR

Hanson Oil Corporation

3. ADDRESS OF OPERATOR

P. O. Box 1515 - Roswell, New Mexico 88201

4. LOCATION OF WELL (Report location clearly and in accordance with any State requirements.*)

At surface

990' FSL & 1650' FEL

At proposed prod. zone

Sec. 26, T-18-S, R-36-E R-30-E
Eddy County, New Mexico

14. DISTANCE IN MILES AND DIRECTION FROM NEAREST TOWN OR POST OFFICE*

6 miles south of Loco Hills, New Mexico

15. DISTANCE FROM PROPOSED*

LOCATION TO NEAREST
PROPERTY OR LEASE LINE, FT.
(Also to nearest drlg. unit line, if any)

990' - 330'

16. NO. OF ACRES IN LEASE

800

17. NO. OF ACRES ASSIGNED
TO THIS WELL

40

18. DISTANCE FROM PROPOSED LOCATION*

TO NEAREST WELL, DRILLING, COMPLETED,
OR APPLIED FOR, ON THIS LEASE, FT.

1320'

19. PROPOSED DEPTH

3700'

20. ROTARY OR CABLE TOOLS

Rotary

21. ELEVATIONS (Show whether DF, RT, GR, etc.)

3481.1 GL

22. APPROX. DATE WORK WILL START*

January 15, 1972

23.

PROPOSED CASING AND CEMENTING PROGRAM

SIZE OF HOLE	SIZE OF CASING	WEIGHT PER FOOT	SETTING DEPTH	QUANTITY OF CEMENT
11"	8-5/8"	23#	750'	150 sx
7-7/8"	5-1/2"	15.5#	3740'	275 sx

We propose to drill the above captioned well with a rotary to a depth of 3750 feet in the Grayburg formation. If oil & gas is encountered in commercial quantities, the proposed casing program will be followed. The production string will be cemented with a sufficient amount of cement to cover the base of the salt. The well will be perforated and stimulated as conditions indicate.

RECEIVED
JAN-4 1972
U. S. GEOLOGICAL SURVEY
ARTESIA, NEW MEXICO

IN ABOVE SPACE DESCRIBE PROPOSED PROGRAM: If proposal is to deepen or plug back, give data on present productive zone and proposed new productive zone. If proposal is to drill or deepen directionally, give pertinent data on subsurface locations and measured and true vertical depths. Give blowout preventer program, if any.

24.

SIGNED

Gerald E. Harrington

TITLE

Geologist

DATE January 4, 1972

(This space for Federal or State office use)

PERMIT NO.

APPROVAL DATE

APPROVED BY

TITLE

DATE

CONDITIONS OF APPROVAL, IF ANY:

NEW MEXICO OIL CONSERVATION COMMISSION
WELL LOCATION AND ACREAGE DEDICATION PLAT

Form C-102
Supersedes C-128
Effective 1-1-65

All distances must be from the outer boundaries of the Section

Operator HANSON OIL CORP.		Lessee GINSBURG FEDERAL		Well No. 35 12
Post Letter O	Section 26	Township 18 SOUTH	Range 30 EAST	County EDDY
Actual Footage Location of Well: 990 feet from the SOUTH line and 1650 feet from the EAST line				
Ground Level Elev. 3481.1	Producing Formation Yates, 7-Rivers, Queen, Grayburg		Pool Shugart	Dedicated Acreage: 40 Acres

1. Outline the acreage dedicated to the subject well by colored pencil or hatchure marks on the plat below.
2. If more than one lease is dedicated to the well, outline each and identify the ownership thereof (both as to working interest and royalty).
3. If more than one lease of different ownership is dedicated to the well, have the interests of all owners been consolidated by communitization, unitization, force-pooling, etc?

☐ Yes ☐ No If answer is "yes," type of consolidation _____

If answer is "no," list the owners and tract descriptions which have actually been consolidated. (Use reverse side of this form if necessary.) _____

No allowable will be assigned to the well until all interests have been consolidated (by communitization, unitization, forced-pooling, or otherwise) or until a non-standard unit, eliminating such interests, has been approved by the Commission.

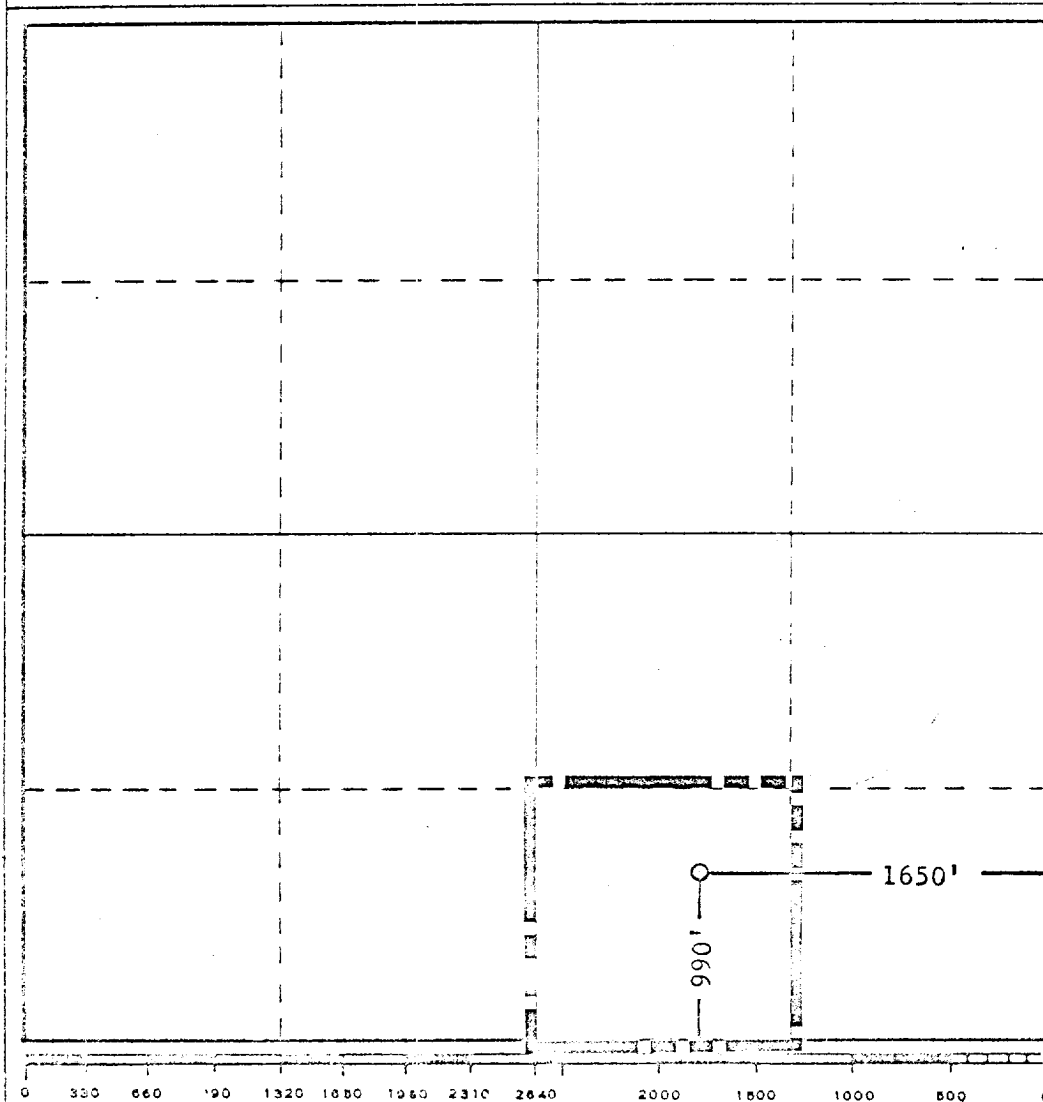

CERTIFICATION

I hereby certify that the information contained herein is true and complete to the best of my knowledge and belief.

Gerald E. Harrington
Name

Gerald E. Harrington
Position

Geologist

Company

Hanson Oil Corp.

Date

January 4, 1972

I hereby certify that the location shown on this plat was plotted from field notes of actual surveys and by reference under my supervision, and that the same is true and correct to the best of my knowledge and belief.

Date Surveyed

Nov. 16, 1971

Registered Professional Engineer and/or Land Surveyor

John W. West
Certificate No.

676