



UNITED STATES  
DEPARTMENT OF THE INTERIOR  
GEOLOGICAL SURVEY  
P. O. Drawer 1057  
Roswell, New Mexico 88201

RECEIVED IN REPLY REFER TO:

MAR 13 1972

E. E. C.  
ARTESIA, OFFICE

March 10, 1972

Hanson Oil Corporation  
Post Office Box 1515  
Roswell, New Mexico 88201

Gentlemen:

Your Notice of Intention to Drill well No. 14 Ginsberg Federal in the NW $\frac{1}{4}$  sec. 26, T. 18 S., R. 30 E., N.M.P.M., Eddy County, New Mexico, lease New Mexico 025503, to a depth of 3700 feet to test the Yates-Seven Rivers-Queen-Cragburg formation in the Potash Area, is hereby approved.

One copy of the Notice is returned herewith. Please notify the District Engineer, Geological Survey, Post Office Drawer U, Artesia, New Mexico, 88210, in sufficient time for a representative to witness all cementing operations.

Sincerely yours,

(ORIG. SGD.) N. O. FREDERICK

N. O. FREDERICK  
Regional Oil and Gas Supervisor

Attachment

CC:

Washington

Mining Branch (2)

✓ NSMCC-Artesia (2) (w/2 cys Notice)

Artesia (w/cy Notice)

Roswell (2) (w/cy Notice)

100-100000

100-100000

100-100000

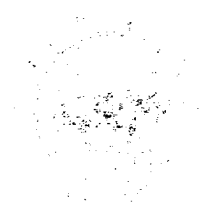

100-100000

100-100000

100-100000

100-100000

100-100000

100-100000

100-100000

100-100000

100-100000

100-100000

100-100000

100-100000

100-100000

100-100000

100-100000

100-100000

100-100000

100-100000

100-100000

100-100000

100-100000

100-100000

100-100000

100-100000

100-100000

100-100000

100-100000

UNITED STATES  
DEPARTMENT OF THE INTERIOR  
GEOLOGICAL SURVEY

30-018-20589

5. LEASE DESIGNATION AND SERIAL NO.

NM-025503

6. IF INDIAN, ALLOTTEE OR TRIBE NAME

7. UNIT AGREEMENT NAME

8. FARM OR LEASE NAME

Ginsberg Federal

9. WELL NO.

14

10. FIELD AND POOL, OR WILDCAT

Shugart

11. SEC., T., R., M., OR BLK.  
AND SURVEY OR AREA

Sec. 26, T-18S, R-30E

12. COUNTY OR PARISH 13. STATE

Eddy

New Mexico

## APPLICATION FOR PERMIT TO DRILL, DEEPEN, OR PLUG BACK

1a. TYPE OF WORK

DRILL ☒DEEPEN ☐ REEVE ☐ PLUG BACK ☐

b. TYPE OF WELL

OIL  
WELL ☒GAS  
WELL ☐

OTHER

SINGLE  
ZONE ☒MULTIPLE  
ZONE ☐

2. NAME OF OPERATOR

Hanson Oil Corporation

3. ADDRESS OF OPERATOR

P. O. Box 1515 - Roswell, New Mexico 88201

4. LOCATION OF WELL (Report location clearly and in accordance with any State requirements.)\*

At surface

660' FNL &amp; 1650' FEL

At proposed prod. zone

Sec. 26, T-18-S, R-30-E, NMPM

Eddy County, New Mexico

14. DISTANCE IN MILES AND DIRECTION FROM NEAREST TOWN OR POST OFFICE\*

6 miles south of Loco Hills, New Mexico

16. DISTANCE FROM PROPOSED\*

660' - 330'

LOCATION TO NEAREST  
PROPERTY OR LEASE LINE, FT.  
(Also to nearest drig. unit line, if any)

17. NO. OF ACRES IN LEASE

800

17. NO. OF ACRES ASSIGNED  
TO THIS WELL

40

18. DISTANCE FROM PROPOSED LOCATION\*

990'

TO NEAREST WELL, DRILLING, COMPLETED,  
OR APPLIED FOR, ON THIS LEASE, FT.

19. PROPOSED DEPTH

3700'

20. ROTARY OR CABLE TOOLS

Rotary

21. ELEVATIONS (Show whether DF, RT, GR, etc.)

3449.0 GL

22. APPROX. DATE WORK WILL START\*

February 15, 1972

23.

## PROPOSED CASING AND CEMENTING PROGRAM

| SIZE OF HOLE | SIZE OF CASING | WEIGHT PER FOOT | SETTING DEPTH | QUANTITY OF CEMENT  |
|--------------|----------------|-----------------|---------------|---------------------|
| 15"          | 12-3/4"        | 33#             | 715'          | 200 sx. - circulate |
| 11"          | 8-5/8"         | 23#             | 1740'         | 50 sx.              |
| 7-7/8"       | 5-1/2"         | 15.5#           | 3700'         | 450 sx. - circulate |

We propose drilling the referenced well with rotary tools to a total depth of approximately 3700 feet or to a sufficient depth to test the Grayburg Formation. Surface casing will be set in the top of the salt and cemented to surface. A salt protection casing will be run to 100' below base of salt and cemented with 50 sacks. If commercial production is encountered the free portion of the salt protection casing will be pulled and 5½" casing will be run to total depth and cemented with a sufficient amount of cement to circulate to surface. The well will then be perforated and stimulated as conditions indicate. (Requirements of R-111-A will be observed.)

IN ABOVE SPACE DESCRIBE PROPOSED PROGRAM: If proposal is to deepen or plug back, give data on present productive zone and proposed new productive zone. If proposal is to drill or deepen directionally, give pertinent data on subsurface locations and measured and true vertical depths. Give blowout preventer program, if any.

24.

SIGNED

*Ernest E. Harrington*

TITLE

Geologist

DATE

2-7-1972

(This space for Federal or State office use)

PERMIT NO.

APPROVAL DATE

APPROVED BY

TITLE

DATE

CONDITIONS OF APPROVAL, IF ANY:

NEW MEXICO OIL CONSERVATION COMMISSION  
WELL LOCATION AND ACREAGE DEDICATION PLAT

Form C-102  
Supersedes C-128  
Effective 1-4-65

All distances must be from the outer boundaries of the Section

|                                                                                                                               |                                                                  |                                  |                         |                                       |
|-------------------------------------------------------------------------------------------------------------------------------|------------------------------------------------------------------|----------------------------------|-------------------------|---------------------------------------|
| Operator<br><b>HANSON OIL CORP.</b>                                                                                           |                                                                  | Lease<br><b>GINSBURG FEDERAL</b> |                         | Well No.<br><b>1219</b>               |
| Unit Letter<br><b>B</b>                                                                                                       | Section<br><b>26</b>                                             | Township<br><b>18 SOUTH</b>      | Range<br><b>30 EAST</b> | County<br><b>EDDY</b>                 |
| Actual Footage Location of Well:<br><b>660</b> feet from the <b>NORTH</b> line and <b>1650</b> feet from the <b>EAST</b> line |                                                                  |                                  |                         |                                       |
| Ground Level Elev.<br><b>3449.0</b>                                                                                           | Producing Formation <b>Yates, 7-<br/>Rivers, Queen, Grayburg</b> |                                  | Pool<br><b>Shugart</b>  | Dedicated Acreage:<br><b>40</b> Acres |

1. Outline the acreage dedicated to the subject well by colored pencil or hachure marks on the plat below.
2. If more than one lease is dedicated to the well, outline each and identify the ownership thereof (both as to working interest and royalty).
3. If more than one lease of different ownership is dedicated to the well, have the interests of all owners been consolidated by communitization, unitization, force-pooling, etc?

☐ Yes ☐ No If answer is "yes," type of consolidation \_\_\_\_\_

If answer is "no," list the owners and tract descriptions which have actually been consolidated. (Use reverse side of this form if necessary.) \_\_\_\_\_

No allowable will be assigned to the well until all interests have been consolidated (by communitization, unitization, forced-pooling, or otherwise) or until a non-standard unit, eliminating such interests, has been approved by the Commission.

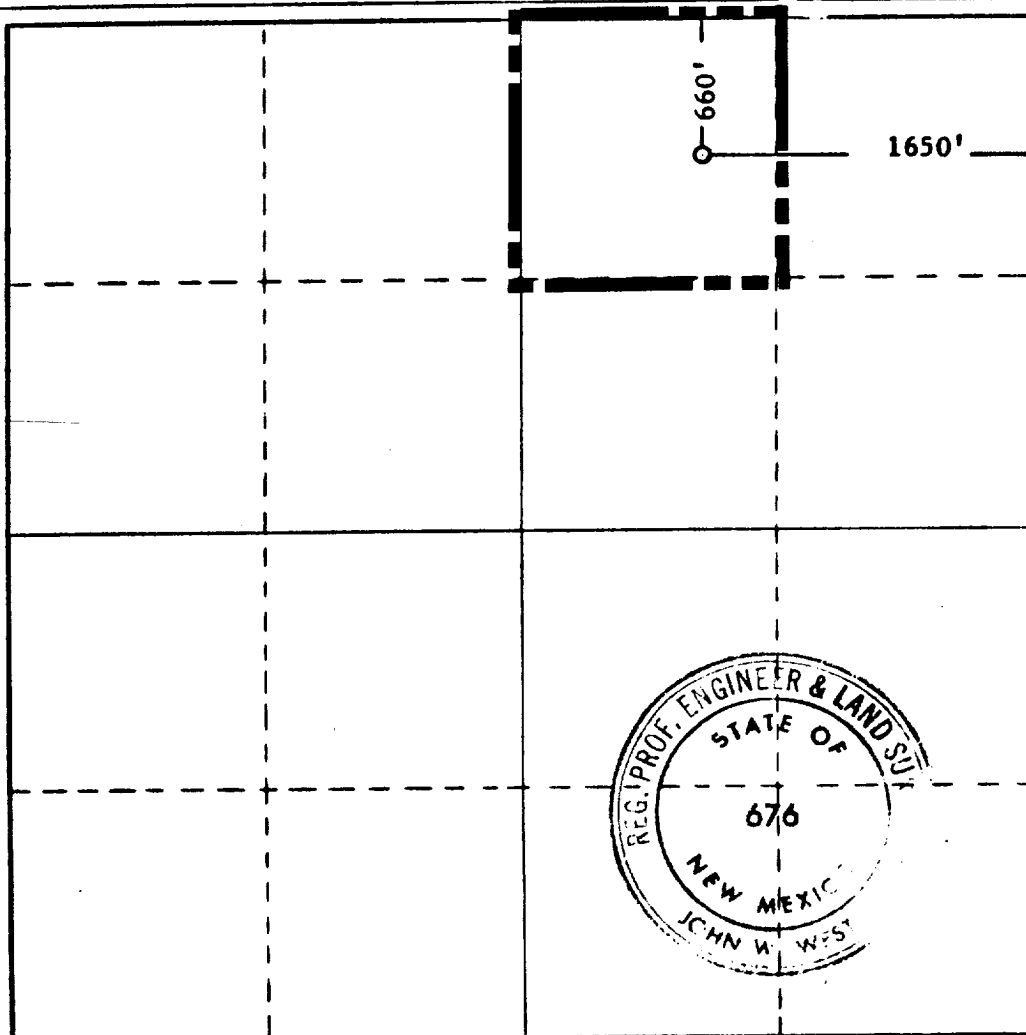

CERTIFICATION

I hereby certify that the information contained herein is true and complete to the best of my knowledge and belief.

Name  
**Gerald E. Harrington**  
Position  
**Geologist**

Company  
**Hanson Oil Corporation**

Date  
**February 7, 1972**

I hereby certify that the well location shown on this plat was plotted from field notes of a survey made by me or under my supervision, and that the same is true and correct to the best of my knowledge and belief.

Date Surveyed  
**11-17-1971**

Registered Professional Engineer and/or Land Surveyor

Certificate No.  
**676**

