



IN REPLY REFER TO:

UNITED STATES  
DEPARTMENT OF THE INTERIOR  
GEOLOGICAL SURVEY  
P. O. Drawer 1857  
Roswell, New Mexico 88201

RECEIVED

MAR 28 1972

O. C. C.  
ARTESIA, OFFICE  
March 24, 1972

Glen F. Featherstone  
Glen F. Featherstone II  
1717 West Second Street  
Roswell, New Mexico 88201

Gentlemen:

Your Notice of Intention to Drill well No. 1 Federal "B" in the SE $\frac{1}{4}$  sec. 26, T. 18 N., R. 30 E., N.M.P.M., Eddy County, New Mexico, lease Las Cruces 064226, to a depth of 3500 feet to test the Queen-Grayburg formation in the Potash Area, is hereby approved.

One copy of the Notice is returned herewith. Please notify the District Engineer, Geological Survey, Post Office Drawer U, Artesia, New Mexico, 88210, in sufficient time for a representative to witness all cementing operations. The office phone number is Area Code 505-746-4841.

Sincerely yours,

(ORIG. SGD.) N. O. FREDERICK

N. O. FREDERICK  
Regional Oil and Gas Supervisor

Attachment

cc:  
Washington  
Mining Branch (2)  
✓ NMOCC-Artesia (2) (w/2 cys Notice)  
Artesia (w/cy Notice)  
Roswell (2) (w/cy Notice)

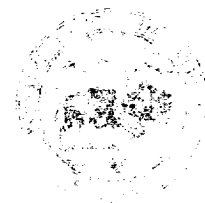

RECEIVED

APR 11 1964

(ORIG. SCD) N. O. FREDERICK

UNITED STATES  
DEPARTMENT OF THE INTERIOR  
GEOLOGICAL SURVEY

APPLICATION FOR PERMIT TO DRILL, DEEPEN, OR PLUG BACK

1a. TYPE OF WORK

DRILL ☒

DEEPEN ☐

PLUG BACK ☐

b. TYPE OF WELL

OIL WELL ☐

NATURAL GAS WELL ☐

OTHER ☐

SINGLE ZONE ☐

MULTIPLE ZONE ☐

2. NAME OF OPERATOR

Olen F. Featherstone II & Olen F. Featherstone

3. ADDRESS OF OPERATOR

1717 West Second, Roswell, N.M.

4. LOCATION OF WELL (Report location clearly and in accordance with any State requirements.)\*

At surface

990' FSL & 2310' FWL Sec. 26, T-18S, R-30E

At proposed prod. zone

14. DISTANCE IN MILES AND DIRECTION FROM NEAREST TOWN OR POST OFFICE\*

10 mi. SW Loco Hills

16. DISTANCE FROM PROPOSED LOCATION TO NEAREST PROPERTY OR LEASE LINE, FT.

(Also to nearest city, town, or village, if any)

17. NO. OF ACRES IN LEASE

600

18. NO. OF ACRES ASSIGNED TO THIS WELL

40

18. DISTANCE FROM PROPOSED LOCATION TO NEAREST WELL, DRILLING, COMPLETED, OR APPLIED FOR, ON THIS LEASE, FT.

19. PROPOSED DEPTH

3500

20. ROTARY OR CABLE TOOLS

Rotary

21. ELEVATIONS (Show whether M.F., F.T., G.R., etc.)

G.L. 3475

22. APPROX. DATE WORK WILL START\*

3-25-72

23.

PROPOSED CASING AND CEMENTING PROGRAM

SIZE OF HOLE	SIZE OF CASING	WEIGHT PER FOOT	SETTING DEPTH	QUANTITY OF CEMENT
11"	8-5/8"	20#/Ft.	720'	400 sx (Circ.)
7-7/8"	5-1/2"	14#/Ft.	3500'	250 sx

RECEIVED  
MAR 28 1972  
U.S. GEOLOGICAL SURVEY  
ARTESIA, OFFICE

IN ABOVE SPACE DESCRIBE PROPOSED PROGRAM: If proposal is to deepen or plug back, give data on present productive zone and proposed new productive zone. If proposal is to drill or deepen directionally, give pertinent data on subsurface locations and measured and true vertical depths. Give blowout preventer program, if any.

24.

SIGNED

TITLE

DATE

(This space for Federal or State office use)

PERMIT NO.

APPROVAL DATE

APPROVED BY

TITLE

DATE

CONDITIONS OF APPROVAL, IF ANY:

NEW MEXICO OIL CONSERVATION COMMISSION  
WELL LOCATION AND ACREAGE DEDICATION AT

Form C-102  
Supersedes C-128  
Effective 1-1-65

All distances must be from the outer boundaries of the Section.

Operator <b>Olen F. Featherstone &amp; Olen F. Featherstone, II</b>		Lease <b>Federal N</b>		Well No. <b>1</b>
Unit Letter <b>N</b>	Section <b>26</b>	Township <b>18</b>	Range <b>30</b>	County <b>Eddy</b>
Actual Footage Location of Well: <b>990</b> feet from the <b>south</b> line and <b>2310</b> feet from the <b>west</b> line				
Ground Level Elev. <b>3475</b>	Producing Formation <b>Grayburg</b>	Pool <b>Undesignated</b>		Dedicated Acreage: <b>40</b> Acres

1. Outline the acreage dedicated to the subject well by colored pencil or hachure marks on the plat below.
2. If more than one lease is dedicated to the well, outline each and identify the ownership thereof (both as to working interest and royalty).
3. If more than one lease of different ownership is dedicated to the well, have the interests of all owners been consolidated by communitization, unitization, force-pooling, etc?

☐ Yes ☐ No If answer is "yes," type of consolidation \_\_\_\_\_

If answer is "no," list the owners and tract descriptions which have actually been consolidated. (Use reverse side of this form if necessary.) \_\_\_\_\_

No allowable will be assigned to the well until all interests have been consolidated (by communitization, unitization, forced-pooling, or otherwise) or until a non-standard unit, eliminating such interests, has been approved by the Commission.

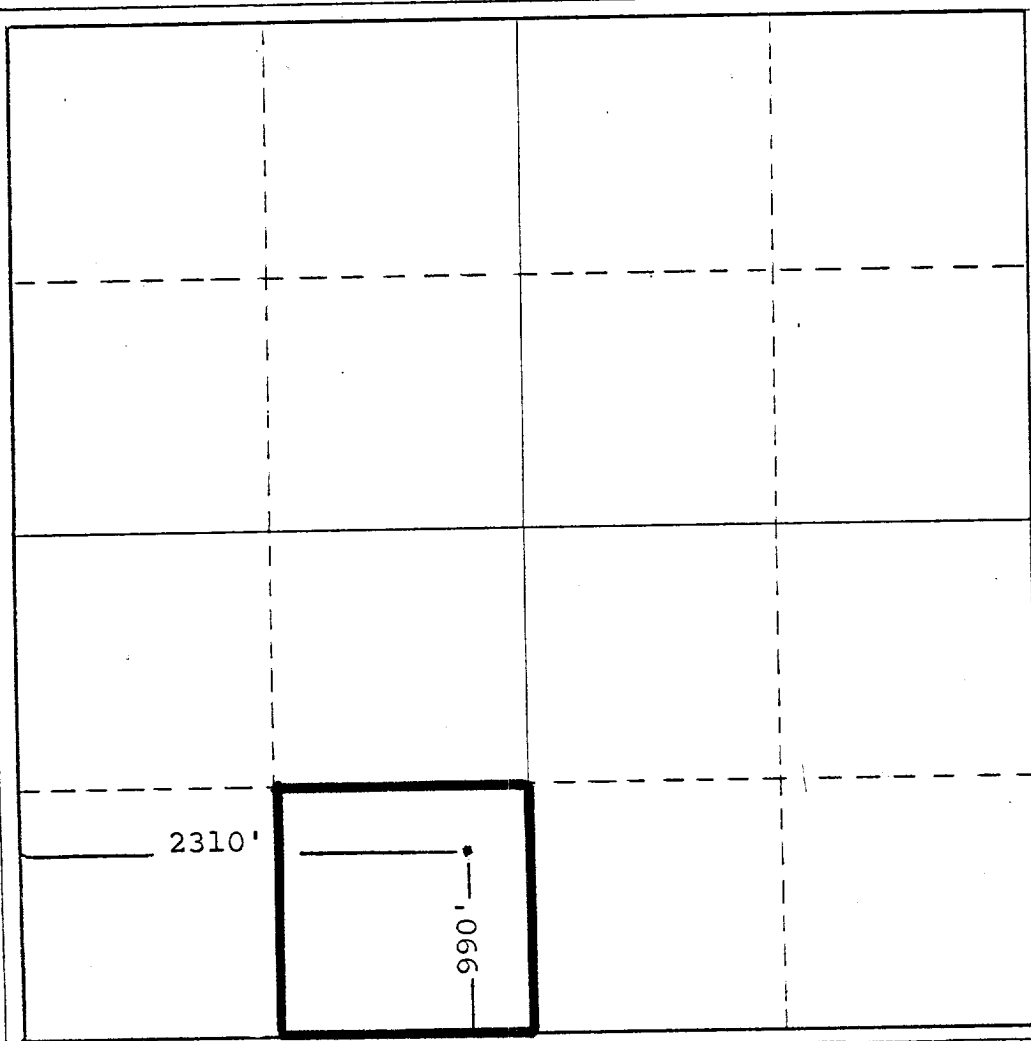

CERTIFICATION

I hereby certify that the information contained herein is true and complete to the best of my knowledge and belief.

Name

Position

Company

Date

3-23-72

I hereby certify that the well location shown on this plat was plotted from field notes of actual surveys made by me or under my supervision, and that the same is true and correct to the best of my knowledge and belief.

Date Surveyed

March 21, 1972

Registered Professional Engineer and/or Land Surveyor

N. Raymond Lamb

Certificate No.

929

0 330 660 990 1320 1650 1980 2310 2640 2000 1500 1000 500 0