

NO. OF COPIES RECEIVED	6
DISTRIBUTION	
SANTA FE	1
FILE	1
U.S.G.S.	2
LAND OFFICE	1
OPERATOR	1

# NEW MEXICO OIL CONSERVATION COMMISSION

30-015-20771

Form C-101  
Revised 1-1-65

5A. Indicate Type of Lease
STATE <input type="checkbox"/> FEE <input checked="" type="checkbox"/>
5. State Oil & Gas Lease No.

## APPLICATION FOR PERMIT TO DRILL, DEEPEN, OR PLUG BACK

1a. Type of Work		7. Unit Agreement Name	
b. Type of Well DRILL <input checked="" type="checkbox"/> DEEPEN <input type="checkbox"/> PLUG BACK <input type="checkbox"/> OIL WELL <input checked="" type="checkbox"/> GAS WELL <input type="checkbox"/> OTHER <input type="checkbox"/> SINGLE ZONE <input type="checkbox"/> MULTIPLE ZONE <input type="checkbox"/>		Far West Loco Hills Sand Unit	
2. Name of Operator Anadarko Production Company		8. Farm or Lease Name FWLH Unit	
3. Address of Operator P. O. Box 67, Loco Hills, New Mexico 88255		9. Well No. 33	
4. Location of Well UNIT LETTER L LOCATED 1980 FEET FROM THE South LINE AND 1310' FEET FROM THE West LINE OF SEC. 9 TWP. 18-S RGE. 29-E NMPM		10. Field and Pool, or Wildcat Loco Hills	
		12. County Bddy	
		19. Proposed Depth 2500'	
		19A. Formation Grayburg	
		20. Rotary or C.T. Rotary	
21. Elevations (Show whether DF, RT, etc.) 3488 GL		21A. Kind & Status Plug. Bond Blanket-Current	
		21B. Drilling Contractor WEK Drilling Co.	
		22. Approx. Date Work will start 13 December 1972	

23.

## PROPOSED CASING AND CEMENT PROGRAM

SIZE OF HOLE	SIZE OF CASING	WEIGHT PER FOOT	SETTING DEPTH	SACKS OF CEMENT	EST. TOP
12 1/4"	8 5/8"	24	350'	150	
7 7/8"	5 1/2"	14	2500'	200	

Intend to drill with Rotary Tools to approximately 350', set and cement 8 5/8" surface casing, drill to approximately 2500', run open hole logs, set and cement 5 1/2" casing, perforate Grayburg Sand Zone as, stimulate and put well on production.

Application has been made for a hearing to approve this unorthodox well location and it is understood that an allowable will not be issued for this well until the location has been approved.

APPROVAL VALID FOR 90 DAYS UNLESS DRILLING COMMENCED, EXPIRES 3-1-73

IN ABOVE SPACE DESCRIBE PROPOSED PROGRAM: IF PROPOSAL IS TO DEEPEN OR PLUG BACK, GIVE DATA ON PRESENT PRODUCTIVE ZONE AND PROPOSED NEW PRODUCTIVE ZONE, GIVE BLOWOUT PREVENTER PROGRAM, IF ANY.

I hereby certify that the information above is true and complete to the best of my knowledge and belief.

Original Signed by

Signed D. R. Layton Title Area Supervisor Date November 22, 1972

(This space for State Use)

APPROVED BY W. A. Gressett TITLE OIL AND GAS INSPECTOR DATE DEC 1 1972

CONDITIONS OF APPROVAL, IF ANY:

N MEXICO OIL CONSERVATION COMMISS.  
WELL LOCATION AND ACREAGE DEDICATION PLAT

Form C-102  
Supersedes C-128  
Effective 1-1-65

All distances must be from the outer boundaries of the Section.

Operator <b>ANADARKO PRODUCTION Co.</b>			Lease <b>FAR WEST LOCO HILLS SAND UNIT Tr. 10</b>		Well No. <b>33</b>
Unit Letter <b>L</b>	Section <b>9</b>	Township <b>18 SOUTH</b>	Range <b>29 EAST</b>	County <b>EDDY</b>	
Actual Footage Location of Well: <b>1980</b> feet from the <b>SOUTH</b> line and <b>1310</b> feet from the <b>WEST</b> line					
Ground Level Elev. <b>3487.8</b>	Producing Formation <b>Grayburg</b>		Pool <b>Loco Hills</b>	Dedicated Acreage: <b>40</b> Acres	

1. Outline the acreage dedicated to the subject well by colored pencil or hachure marks on the plat below.
2. If more than one lease is dedicated to the well, outline each and identify the ownership thereof (both as to working interest and royalty).
3. If more than one lease of different ownership is dedicated to the well, have the interests of all owners been consolidated by communitization, unitization, force-pooling, etc?

☒ Yes ☐ No If answer is "yes," type of consolidation **Unitization**

If answer is "no," list the owners and tract descriptions which have actually been consolidated. (Use reverse side of this form if necessary.) \_\_\_\_\_

No allowable will be assigned to the well until all interests have been consolidated (by communitization, unitization, forced-pooling, or otherwise) or until a non-standard unit, eliminating such interests, has been approved by the Commission.

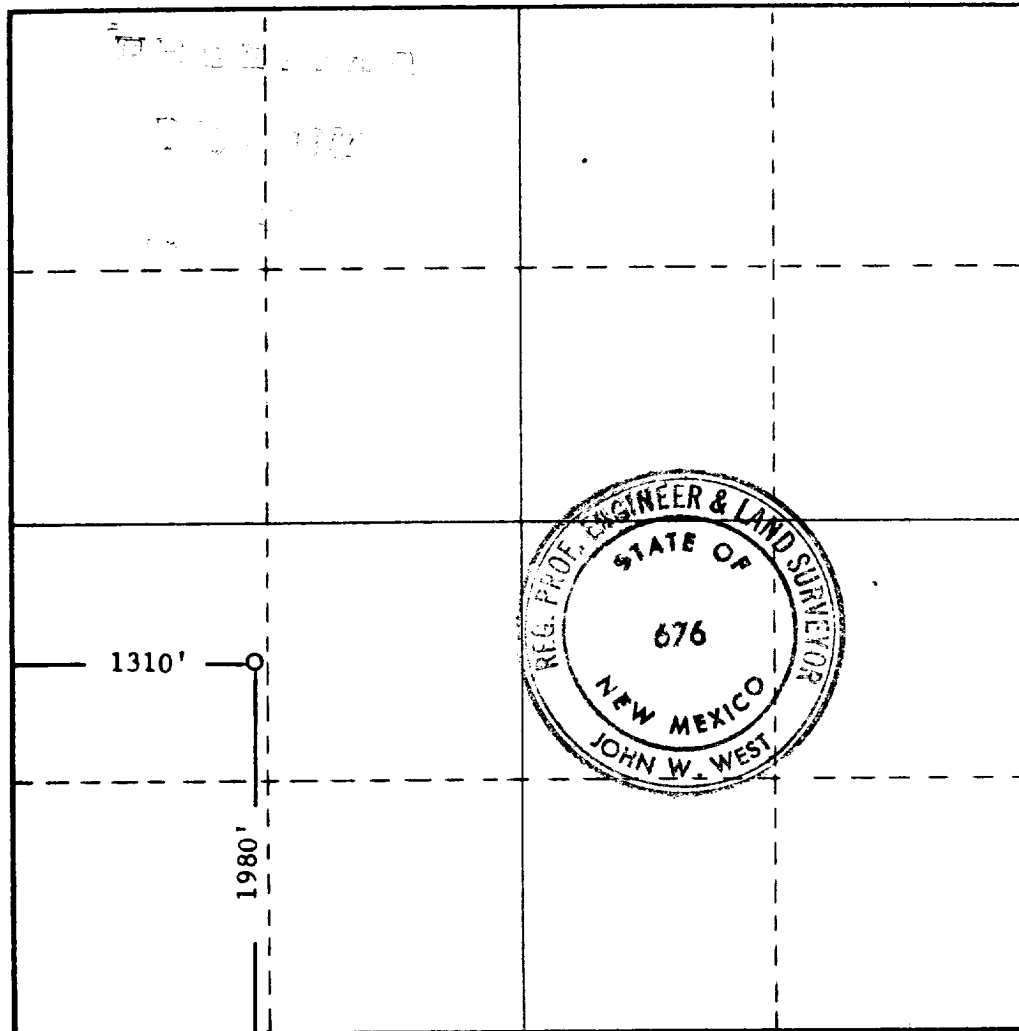

CERTIFICATION

I hereby certify that the information contained herein is true and complete to the best of my knowledge and belief.

Name **Original signed by  
D. R. Layton**

Position  
**Area Supervisor**

Company  
**Anadarko Production Company**

Date  
**22 November 1972**

I hereby certify that the well location shown on this plat was plotted from field notes of actual surveys made by me or under my supervision, and that the same is true and correct to the best of my knowledge and belief.

Date Surveyed  
**11-16-1972**

Registered Professional Engineer  
and/or Land Surveyor

*John W. West*  
Certificate No. **676**

0 330 660 990 1320 1650 1980 2310 2640 2000 1500 1000 500