

NEW MEXICO OIL CONSERVATION COMMISSION
WELL LOCATION AND ACREAGE DEDICATION

RECEIVED

Form C-102
Supersedes C-128
Effective 12-65

DEC 21 1972

All distances must be from the outer boundaries of the Section

Operator C & K PETROLEUM Inc.			Lease Vandiver Unit			Well No. 1		
Unit Letter M	Section 18	Township 18 SOUTH	Range 26 EAST	County McKENNA, OFFICE				
Actual Footage Location of Well: 990 feet from the SOUTH line and 660 feet from the WEST line								
Ground Level Elev. 3430.3	Producing Formation Morrow		Pool Atoka Morrow, West (Gas)			Dedicated Acreage: 317.24		

1. Outline the acreage dedicated to the subject well by colored pencil or hatchure marks on the plat below.
2. If more than one lease is dedicated to the well, outline each and identify the ownership thereof (both as to working interest and royalty). See Reverse Side
3. If more than one lease of different ownership is dedicated to the well, have the interests of all owners been consolidated by communitization, unitization, force-pooling, etc?

☒ Yes ☐ No If answer is "yes," type of consolidation Unitization* (See Reverse Side)

If answer is "no," list the owners and tract descriptions which have actually been consolidated. (Use reverse side of this form if necessary.) See Reverse Side

No allowable will be assigned to the well until all interests have been consolidated (by communitization, unitization, forced-pooling, or otherwise) or until a non-standard unit, eliminating such interests, has been approved by the Commission.

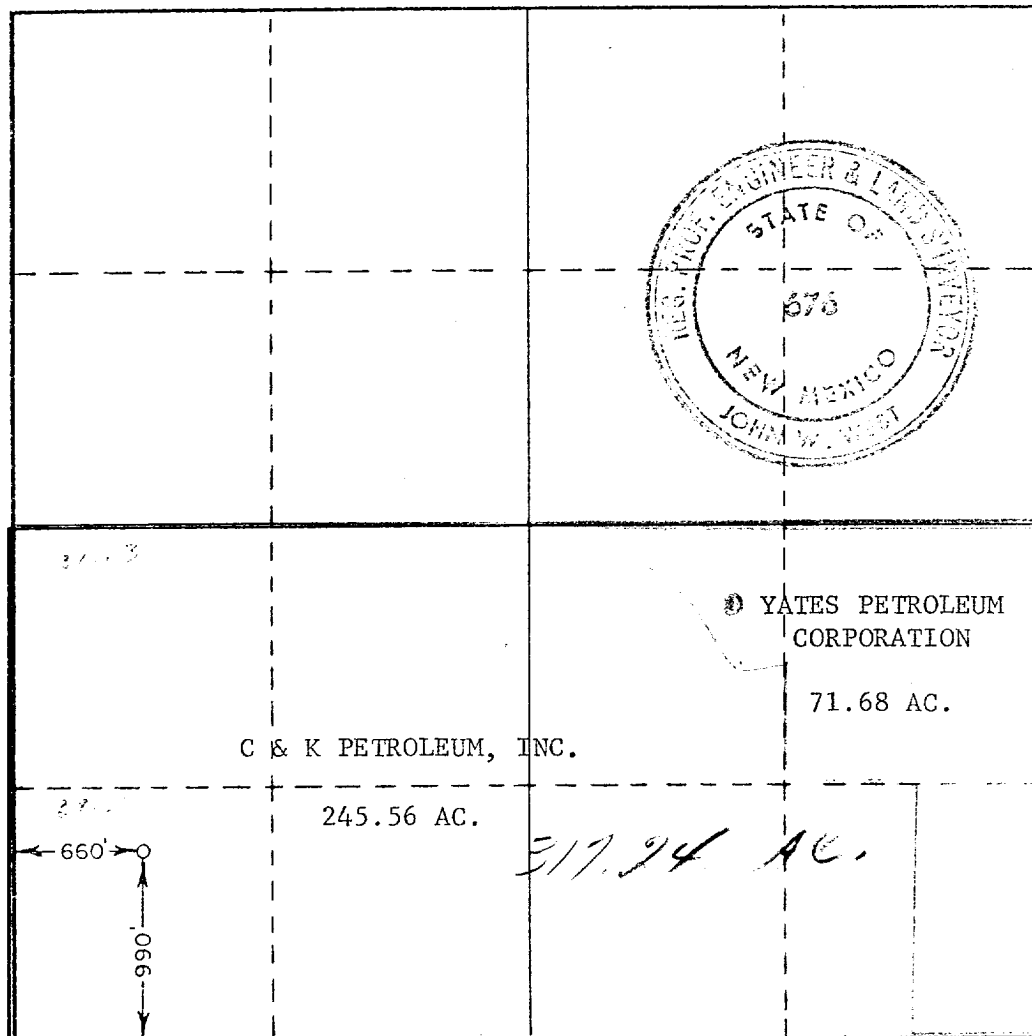

CERTIFICATION

I hereby certify that the information contained herein is true and complete to the best of my knowledge and belief.

Name DE Corp
Position
Administrative Supervisor
Company
C & K Petroleum, Inc.
Date
December 19, 1972

I hereby certify that the well location shown on this plat was plotted from field notes of actual surveys made by me or under my supervision, and that the same is true and correct to the best of my knowledge and belief.

Date Surveyed
NOVEMBER 14, 1972
Registered Professional Engineer and/or Land Surveyor

John W. West
Certificate No. 676

NOTE: All the working interests have been unitized. A search of the records is now being made to determine the royalty interest. After this determination has been made, the unit agreement will be circulated to the royalty interest for their approval.

Working Interest

C & K Petroleum, Inc. - 245.56 acres - 77.41%
Yates Petroleum Corp. - 71.68 acres - 22.59%