

DISTRIBUTION	
SANTA FE	/
FILE	/
U.S.G.S.	
LAND OFFICE	
TRANSPORTER	OIL / GAS /
OPERATOR	/
PRODUCTION OFFICE	

NEW MEXICO OIL CONSERVATION COMMISSION
REQUEST FOR ALLOWABLE
AND
AUTHORIZATION TO TRANSPORT OIL AND NATURAL GAS
RECEIVED

Form C-104
Supersedes Old C-104 and C-11
Effective 1-1-65

MAR 9 1977

I. Operator **Yates Petroleum Corporation** **O.C.C.**
Address **207 South 4th Street - Artesia, NM 88210**
Reason(s) for filing (Check proper box) Other (Please explain)
New Well ☒ Change in Transporter of: Oil ☐ Dry Gas ☐
Recompletion ☐ Casinghead Gas ☐ Condensate ☐
Change in Ownership ☐

If change of ownership give name and address of previous owner **P-5460 7-1-77**

II. DESCRIPTION OF WELL AND LEASE **Eagle Creek Permian-Lower**
Lease Name **Federal "CX"** Well No. **1** Pool Name, including Formation **Wildcat Cisco** Kind of Lease **6440087** Lease No. **State, Federal or Fee Fed.**
Location
Unit Letter **H** ; **1980** Feet From The **North** Line and **660** Feet From The **East**
Line of Section **7** Township **18S** Range **25E** , NMPM, **Eddy** County

III. DESIGNATION OF TRANSPORTER OF OIL AND NATURAL GAS
Name of Authorized Transporter of Oil ☐ or Condensate ☒ Address (Give address to which approved copy of this form is to be sent)
Navajo Crude Oil Purchasing Company **No. Freeman Ave. - Artesia, NM 88210**
Name of Authorized Transporter of Casinghead Gas ☐ or Dry Gas ☒ Address (Give address to which approved copy of this form is to be sent)
Transwestern Pipeline Company **P. O. Box 2521-Houston, TX 77001**
If well produces oil or liquids, give location of tanks. Unit **H** Sec. **7** Twp. **18S** Rge. **25E** Is gas actually connected? **Yes** When **3-1-77**

If this production is commingled with that from any other lease or pool, give commingling order number:

V. COMPLETION DATA
Designate Type of Completion - (X) Oil Well Gas Well New Well Workover Deepen Plug Back Same Res'v. Diff. Res'v.
X **X** **X**
Date Spudded **9-22-73** Date Compl. Ready to Prod. **11-7-73** Total Depth **8625'** P.B.T.D. **7479'**
Elevations (DF, RKB, RT, GR, etc.) **3615' GR** Name of Producing Formation **Cisco** Top Oil/Gas Pay **6545** Tubing Depth **6521'**
Perforations **6545-6768 1/2'** Depth Casing Shoe **7503'**
TUBING, CASING, AND CEMENTING RECORD
HOLE SIZE CASING & TUBING SIZE DEPTH SET SACKS CEMENT
17 1/2" **13-3/8"** **215'** **125**
12 1/4" **9-5/8"** **1077'** **500**
8-3/4" **5 1/2"** **7503'** **300**
2-3/8" **6521'**

V. TEST DATA AND REQUEST FOR ALLOWABLE OIL WELL (Test must be after recovery of total volume of load oil and must be equal to or exceed top allowable for this depth or be for full 24 hours)
Date First New Oil Run To Tanks Date of Test Producing Method (Flow, pump, gas lift, etc.)
Length of Test Tubing Pressure Casing Pressure Choke Size
Actual Prod. During Test Oil-Bbls. Water-Bbls. Gas-MCF

GAS WELL
Actual Prod. Test-MCF/D Length of Test Bbls. Condensate/MMCF Gravity of Condensate
4100 **24** **3.0** **43.7**
Testing Method (pilot, back pr.) Tubing Pressure (Shut-in) Casing Pressure (Shut-in) Choke Size
Back Pressure **1873** **- Packer** **1"**

VI. CERTIFICATE OF COMPLIANCE
I hereby certify that the rules and regulations of the Oil Conservation Commission have been complied with and that the information given above is true and complete to the best of my knowledge and belief.
Christine Tomlinson (Signature)
Christine Tomlinson - Geol. Secty (Title)
3-1-77 (Date)
OIL CONSERVATION COMMISSION
APR 6 1977
APPROVED BY **W. A. Gussert**
TITLE **SUPERVISOR, DISTRICT II**
This form is to be filed in compliance with RULE 1104.
If this is a request for allowable for a newly drilled or deepened well, this form must be accompanied by a tabulation of the deviation tests taken on the well in accordance with RULE 111.
All sections of this form must be filled out completely for allowable on new and recompleted wells.
Fill out only Sections I, II, III, and VI for changes of owner, well name or number, or transporter, or other such change of condition.

**NEW MEXICO OIL CONSERVATION COMMISSION
WELL LOCATION AND ACREAGE DEDICATION AT**

Form C-102
Supersedes C-128
Effective 1-1-65

All distances must be from the outer boundaries of the Section.

Operator Yates Petroleum Corporation			Lease Federal "CX" Com		Well No. 1
Unit Letter II	Section 7	Township 18S	Range 25E	County Eddy	
Actual Footage Location of Well: 1980 feet from the North line and 660 feet from the East line					
Ground Level Elev. 3615'	Producing Formation Cisco		Pool Wildcat		Dedicated Acreage: 320 Acres

1. Outline the acreage dedicated to the subject well by colored pencil or hatchure marks on the plat below.
2. If more than one lease is dedicated to the well, outline each and identify the ownership thereof (both as to working interest and royalty).
3. If more than one lease of different ownership is dedicated to the well, have the interests of all owners been consolidated by communitization, unitization, force-pooling, etc?

☐ Yes ☐ No If answer is "yes," type of consolidation To be communitized

If answer is "no," list the owners and tract descriptions which have actually been consolidated. (Use reverse side of this form if necessary.) _____

No allowable will be assigned to the well until all interests have been consolidated (by communitization, unitization, forced-pooling, or otherwise) or until a non-standard unit, eliminating such interests, has been approved by the Commission.

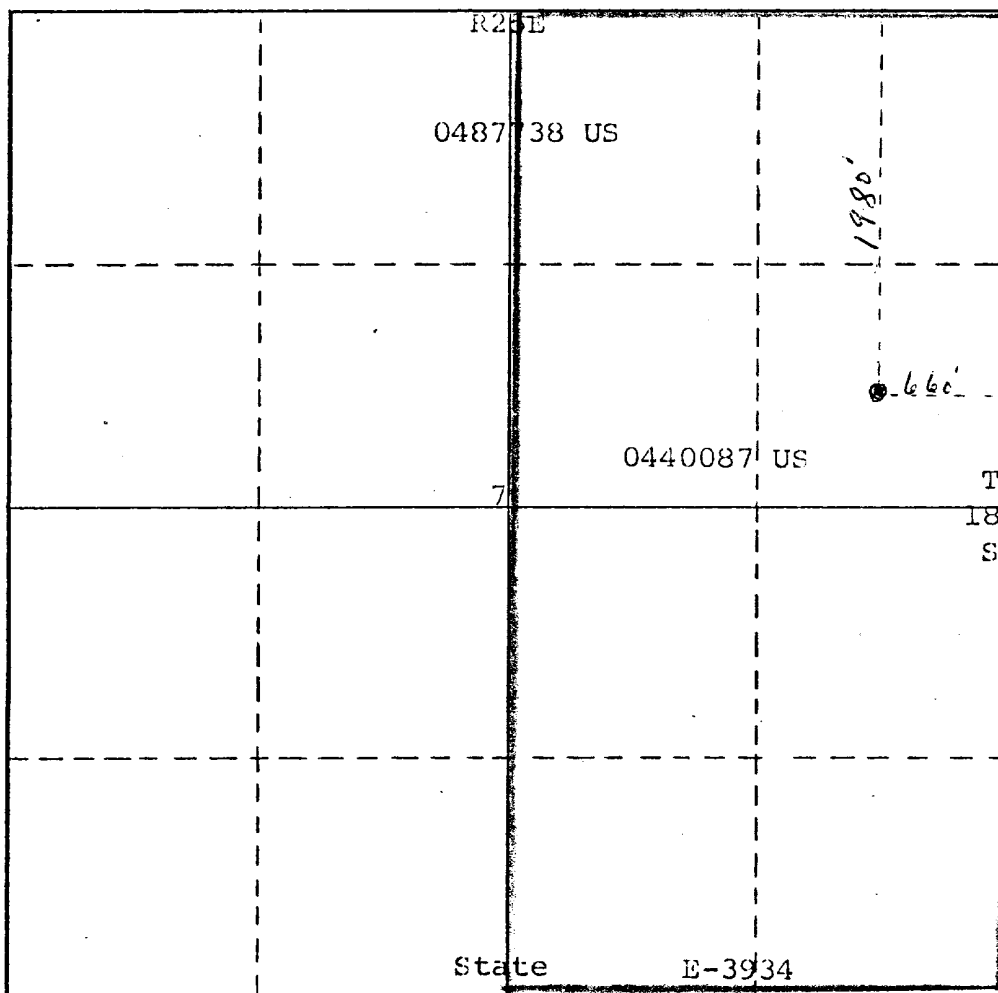

CERTIFICATION

I hereby certify that the information contained herein is true and complete to the best of my knowledge and belief.

Eddie M. Mahfood et al
Name

Eddie M. Mahfood

Position

Engineer

Company

Yates Petroleum Corp.

Date

3-1-77

I hereby certify that the well location shown on this plat was plotted from field notes of actual surveys made by me or under my supervision, and that the same is true and correct to the best of my knowledge and belief.

Refer to Original Plat

Date Surveyed

Dated September 3, 1973

Registered Professional Engineer
and/or Land Surveyor

Certificate No.

0 330 660 990 1320 1650 1980 2310 2640 2000 1500 1000 500 0

RECEIVED

NEW MEXICO OIL CONSERVATION COMMISSION

MAR 7 1977

P. O. DRAWER "DD"

ARTESIA, NEW MEXICO 88210

O. C. C.
ARTESIA, OFFICE
AIR MAIL

NOTICE OF GAS CONNECTION

DATE March 4, 1977

This is to notify the Oil Conservation Commission that connection
for the purchase of gas from the Yates Petroleum Corp. . Federal "CX"
Operator Lease

Well #1-Unit Letter* . 7-18S-25E . Wildcat . Transwestern .
Well Unit S.T.R. Pool Name of purchaser
*Unknown Eddy County (Cisco)
was made on March 1, 1977 .

Transwestern Pipeline Company



H. N. Aicklen

Representative

Supervisor Gas Purchase Contract Administration
Title

cc: Operator
Oil Conservation Commission - Santa Fe