

N MEXICO OIL CONSERVATION COMMISS
WELL LOCATION AND ACREAGE DEDICATION PLAT

Form C-102
Supersedes C-128
Effective 1-1-65

All distances must be from the outer boundaries of the Section

Operator ANADARKO PRODUCTION COMPANY			Lease BALLARD GRAYBURG SAN ANDRES UNIT TRACT 8		Well No. 5
Unit Letter B	Section 5	Township 18S	Range 29E	County EDDY	
Actual Footage Location of Well: 20 feet from the NORTH line and 1500 feet from the EAST line					
Ground Level Elev. 3557.1	Producing Formation Grayburg		Pool Loce Hills Queen Grayburg San Andres		Dedicated Acreage: 40 Acres

1. Outline the acreage dedicated to the subject well by colored pencil or hachure marks on the plat below.
2. If more than one lease is dedicated to the well, outline each and identify the ownership thereof (both as to working interest and royalty).
3. If more than one lease of different ownership is dedicated to the well, have the interests of all owners been consolidated by communitization, unitization, force-pooling, etc?

☒ Yes ☐ No If answer is "yes," type of consolidation **Unitization**

If answer is "no," list the owners and tract descriptions which have actually been consolidated. (Use reverse side of this form if necessary.) _____

No allowable will be assigned to the well until all interests have been consolidated (by communitization, unitization, forced-pooling, or otherwise) or until a non-standard unit eliminating such interests, has been approved by the Commission.

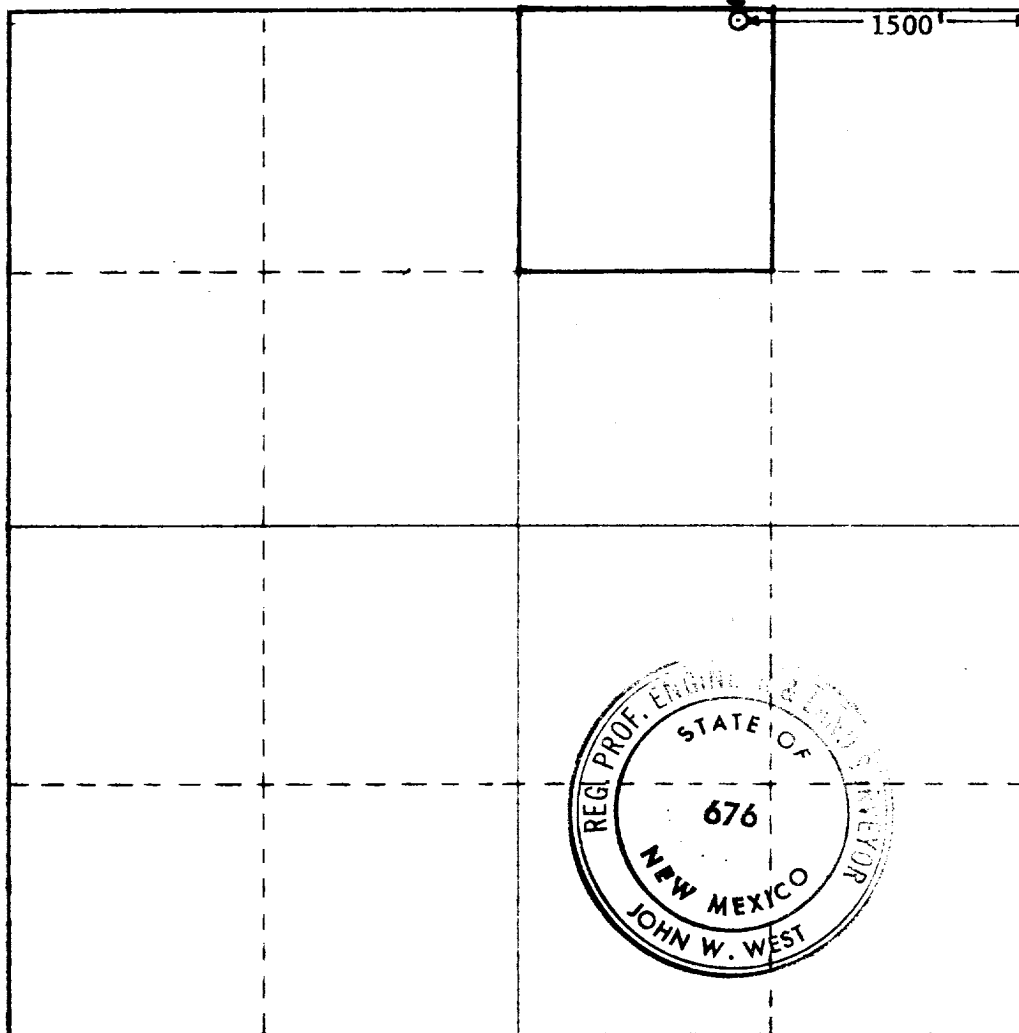

CERTIFICATION

I hereby certify that the information contained herein is true and complete to the best of my knowledge and belief.

Name
John W. West
Position
Area Supervisor
Company
Anadarko Production Co.
Date
September 25, 1973

I hereby certify that the well location shown on this plat was plotted from field notes of actual surveys made by me or under my supervision, and that the same is true and correct to the best of my knowledge and belief.

Date Surveyed
SEPTEMBER 22, 1973
Registered Professional Engineer
and/or Land Surveyor
John W. West
Certificate No. **676**

