

NEW MEXICO OIL CONSERVATION COMMISSION
WELL LOCATION AND ACREAGE DEDICATION PLAT

Form 7-10,
Supersedes C-12B
Effective 1-1-65

All distances must be from the outer boundaries of the Section. **DOUGLAS COUNTY, NEW MEXICO**

Operator Yates Petroleum Corp			Lease No. Superior Federal			Well No. 2		
Unit Letter K	Section 1	Township 18s	Range 25E	County Eddy				
Actual Footage Location of Well: 1980 feet from the South line of 1980 West line								
Ground Level Elev. 3436	Producing Formation Cisno		Unders. Permian Kenn			Estimated Acreage 320		

1. Outline the acreage dedicated to the subject well by colored pencil or hatchure marks on the plat below.
2. If more than one lease is dedicated to the well, outline each and identify the ownership thereof (both as to working interest and royalty).
3. If more than one lease of different ownership is dedicated to the well, have the interests of all owners been consolidated by communitization, unitization, force-pooling, etc?

☒ Yes ☐ No If answer is "yes," type of consolidation **Communitization**

If answer is "no," list the owners and tract descriptions which have actually been consolidated. (Use reverse side of this form if necessary.) _____

No allowable will be assigned to the well until all interests have been consolidated (by communitization, unitization, forced-pooling, or otherwise) or until a non-standard unit, eliminating such interests, has been approved by the Commission.

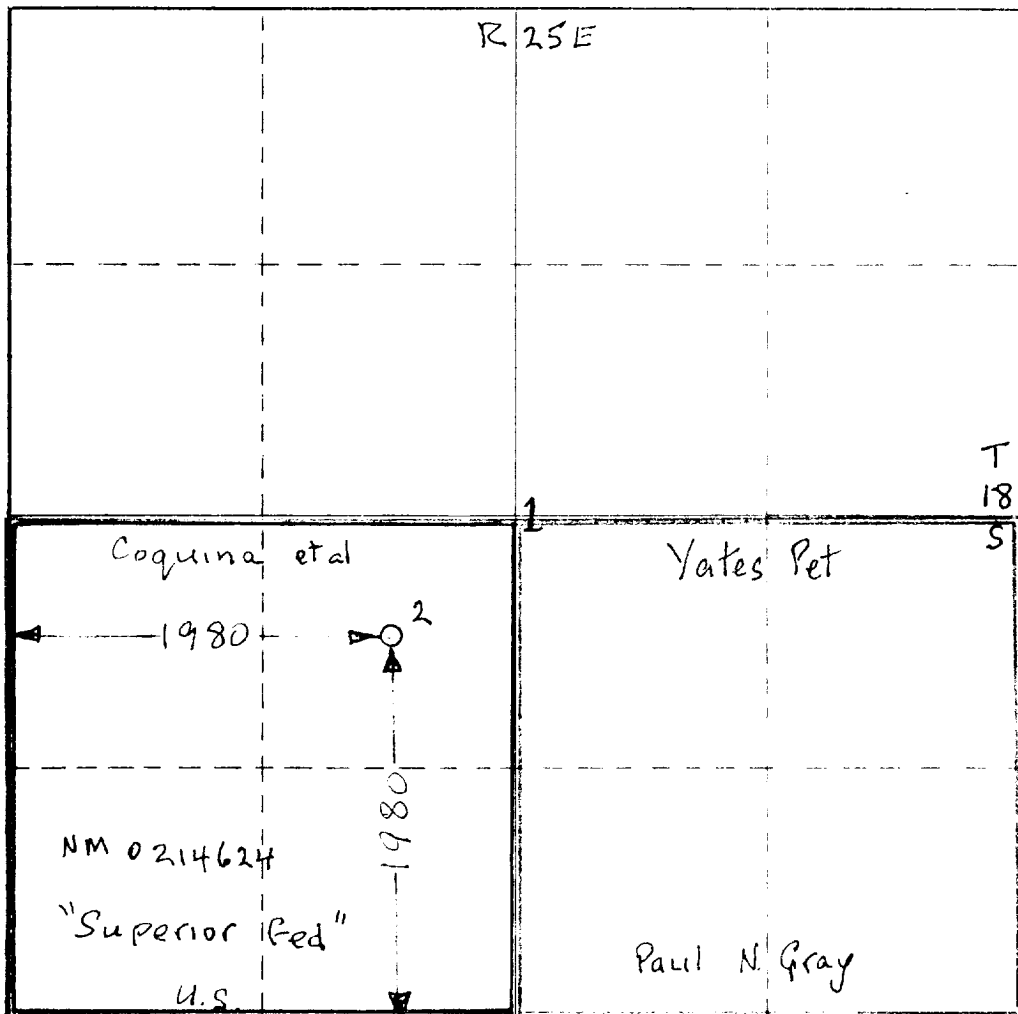

CERTIFICATION

I hereby certify that the information contained herein is true and complete to the best of my knowledge and belief.

Eddie M. Mahfood
Eddie M. Mahfood
Engineer

Yates Petroleum Corp

12-12-80

I hereby certify that the well location shown on this plat was plotted from field notes of actual surveys made by me or under my supervision, and that the same is true and correct to the best of my knowledge and belief.

Refer to Original Plat

Chief Surveyor

Registered Professional Engineer and/or Licensed Surveyor

Witness

