

N. MEXICO OIL CONSERVATION COMMISSION
WELL LOCATION AND ACREAGE DEDICATION PLAT

Form C-102
Supersedes C-128
Effective 1-4-65

All distances must be from the outer boundaries of the Section.

DAVID FASKEN			Lease YATES "6" FEDERAL		Well No. 1
Section "1"	6	Township 18 South	Range 26 East	County Eddy	
Acres of the Section of Well: 1980 feet from the South line and 660 feet from the West line					
Original Well File 3435.7	Producing Formation Atoka	Pool Undesignated	Dedicated Acreage: 314.56 Acres		

1. Outline the acreage dedicated to the subject well by colored pencil or hachure marks on the plat below.
2. If more than one lease is dedicated to the well, outline each and identify the ownership thereof (both as to working interest and royalty).
3. If more than one lease of different ownership is dedicated to the well, have the interests of all owners been consolidated by communitization, unitization, force-pooling, etc?

RECEIVED

APR 5 - 1974

☒ Yes ☐ No If answer is "yes," type of consolidation Pooling Form Leases

O. C. C.

If answer is "no," list the owners and tract descriptions which have actually been consolidated. (Use reverse side of this form if necessary.)

No allowable will be assigned to the well until all interests have been consolidated (by communitization, unitization, forced-pooling, or otherwise) or until a non-standard unit, eliminating such interests, has been approved by the Commission.

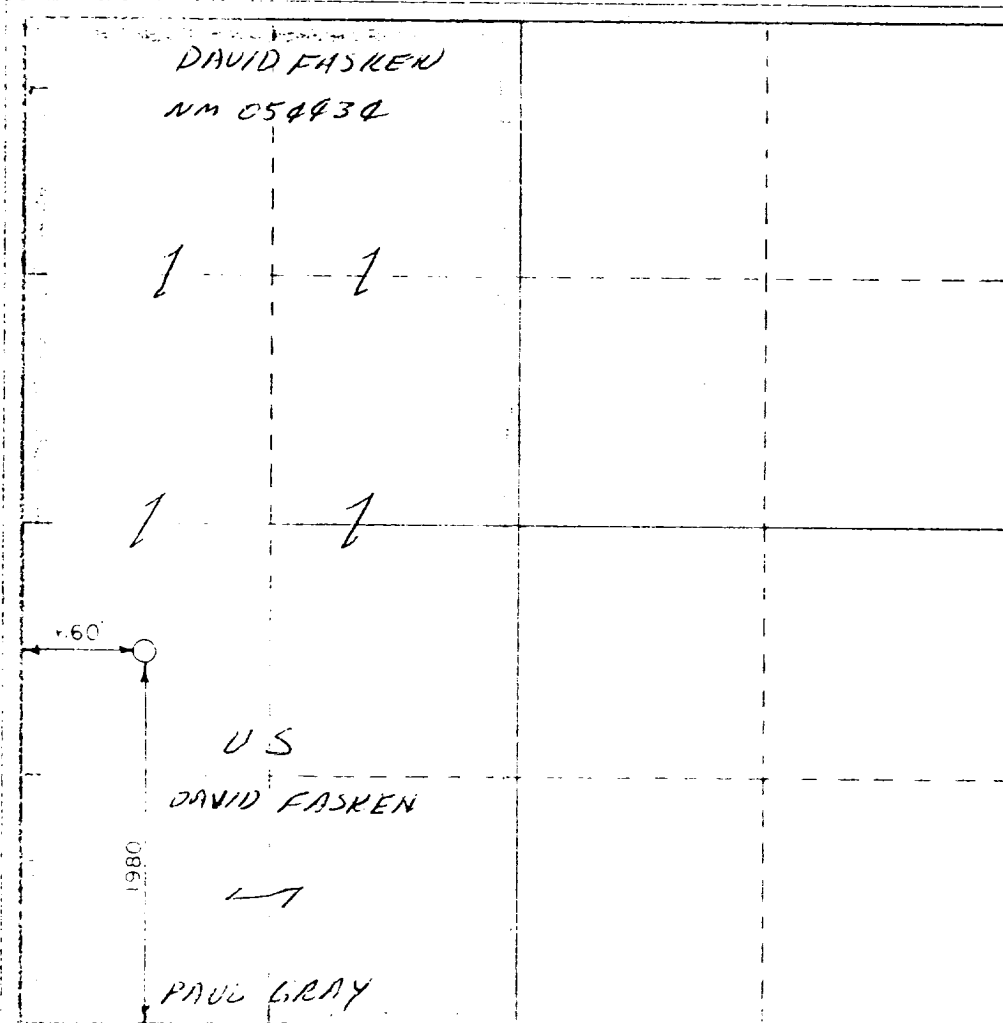

CERTIFICATION

I hereby certify that the information contained herein is true and complete to the best of my knowledge and belief.

Name
James B. Henry
James B. Henry

Position
Agent

Company
DAVID FASKEN

Date
12-11-73

I hereby certify that the well location shown on this plat was plotted from field notes of actual surveys made by me or under my supervision, and that the same is true and correct to the best of my knowledge and belief.

Date Surveyed
December 7, 1973

Registered Professional Engineer and/or Land Surveyor

Certificate No.

3640