

UNITED STATES
DEPARTMENT OF THE INTERIOR
BUREAU OF LAND MANAGEMENT

NOV 28 1986

Form approved.
Budget Bureau No. 1004-0136
Expires August 31, 1985

APPLICATION FOR PERMIT TO DRILL, DEEPEN, OR PLUG BACK

1a. TYPE OF WORK

DRILL ☒ RE-ENTRY ☐ DEEPEN ☐

b. TYPE OF WELL

OIL WELL ☒

GAS WELL ☐

OTHER ☐

SINGLE ZONE ☒

MULTIPLE ZONE ☐

2. NAME OF OPERATOR

Meridian Oil Inc.

3. ADDRESS OF OPERATOR

21 Desta Drive Midland Texas 79705

4. LOCATION OF WELL (Report location clearly and in accordance with any State requirements.)

At surface

1980' FSL & 660' FWL, Sec. 4, T-18-S, R-30-E

At proposed prod. zone

14. DISTANCE IN MILES AND DIRECTION FROM NEAREST TOWN OR POST OFFICE*

3 miles south of Loco Hills, New Mexico

15. DISTANCE FROM PROPOSED*

LOCATION TO NEAREST PROPERTY OR LEASE LINE, FT.

(Also to nearest drig. unit line, if any)

660'

18. DISTANCE FROM PROPOSED LOCATION* TO NEAREST WELL, DRILLING, COMPLETED, OR APPLIED FOR, ON THE LEASE, FT.

NA

16. NO. OF ACRES IN LEASE

40

19. PROPOSED DEPTH

11,050'

17. NO. OF ACRES ASSIGNED TO THIS WELL

40

20. ROTARY OR CABLE TOOLS

Rotary

21. ELEVATIONS (Show whether DF, RT, GR, etc.)

3539.7' GR

22. APPROX. DATE WORK WILL START*

12-10-86

23.

PROPOSED CASING AND CEMENTING PROGRAM

SIZE OF HOLE	SIZE OF CASING	WEIGHT PER FOOT	SETTING DEPTH	QUANTITY OF CEMENT
17 1/2"	13 3/8"	54#	375'	375' CIRCULATE
12 1/4"	9 5/8"	40#	3650'	600' CIRCULATE @ 220'
7 7/8"	5 1/2"	15.5 & 17#	11,050'	500' CIRCULATE TO C @ + 9000'

circulate New 95/8"

Well P&A'd 10-3-75. See Attached Re-Entry Procedure.

Perf & stimulate Strawn for production.

MUD PROGRAM: 0-1200' brine; 1200-10,000' cut birne; 10,000-11,050' cut bine + salt gel, starch & sweeps. MW 8.8-9, VIS 32-36, 10-15 cc. BHP @ TD expected to be 5000 psi.

BOP PROGRAM: 11"-5M BOP stack to be installed on 9 5/8" and left on for remainder of drilling. Stack to consist of annular BOP, blind ram BOP and one pipe ram BOP. Test BOP's after each new installation w/Yellow Jacket, Inc. Install rotating head after setting surface pipe.

Former: Franklin, Hixon & Fair Inc,
OTD-12,645

Revised ID-1
NL
12-10-86

IN ABOVE SPACE DESCRIBE PROPOSED PROGRAM: If proposal is to deepen or plug back, give data on present productive zone and proposed new productive zone. If proposal is to drill or deepen directionally, give pertinent data on subsurface locations and measured and true vertical depths. Give blowout preventer program, if any.

24.

SIGNED

Cathy Stokes

TITLE

Engineering Tech III

DATE

11/26/86

(This space for Federal or State office use)

PERMIT NO.

APPROVAL DATE

APPROVED BY

TITLE

DATE

12-4-86

CONDITIONS OF APPROVAL, IF ANY:

APPROVAL SUBJECT TO
GENERAL REQUIREMENTS AND
SPECIAL STIPULATIONS

*See Instructions On Reverse Side

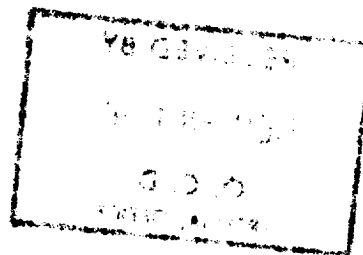

MEXICAN OIL CONSERVATION COMMISSION
WELL LOCATION AND ACREAGE DEDICATION PLAT

All distances are true, measured from the outer boundaries of the Section

Meridian Oil, <u>INC</u> ✓		F. A. F. Federal	
Letter <u>L</u>	Section <u>4</u>	Township <u>18 South</u>	Range <u>30 East</u>
		County <u>Eddy</u>	

Actual Enclosed Location of Well:

1980	feet from the <u>South</u>	line and <u>660</u>	feet from the <u>West</u>	line
Ground Level Elev. <u>3539.7</u>	Producing Formation <u>Strawn</u>	Pool <u>Sand Tank Wildcat</u>	Dedicated Acreage: <u>40</u> Acres	

- Outline the acreage dedicated to the subject well by colored pencil or hatchure marks on the plat below.
- If more than one lease is dedicated to the well, outline each and identify the ownership thereof (both as to working interest and royalty).
- If more than one lease of different ownership is dedicated to the well, have the interests of all owners been consolidated by communitization, unitization, force-pooling, etc?

☐ Yes ☐ No If answer is "yes," type of consolidation O. C. D.

RECEIVED BY

DEC -8 1986

ARTESIA, OFFICE

If answer is "no," list the owners and tract descriptions which have actually been consolidated. (Use reverse side of this form if necessary.)

No allowable will be assigned to the well until all interests have been consolidated (by communitization, unitization, forced-pooling, or otherwise) or until a non-standard unit, eliminating such interests, has been approved by the Commission.

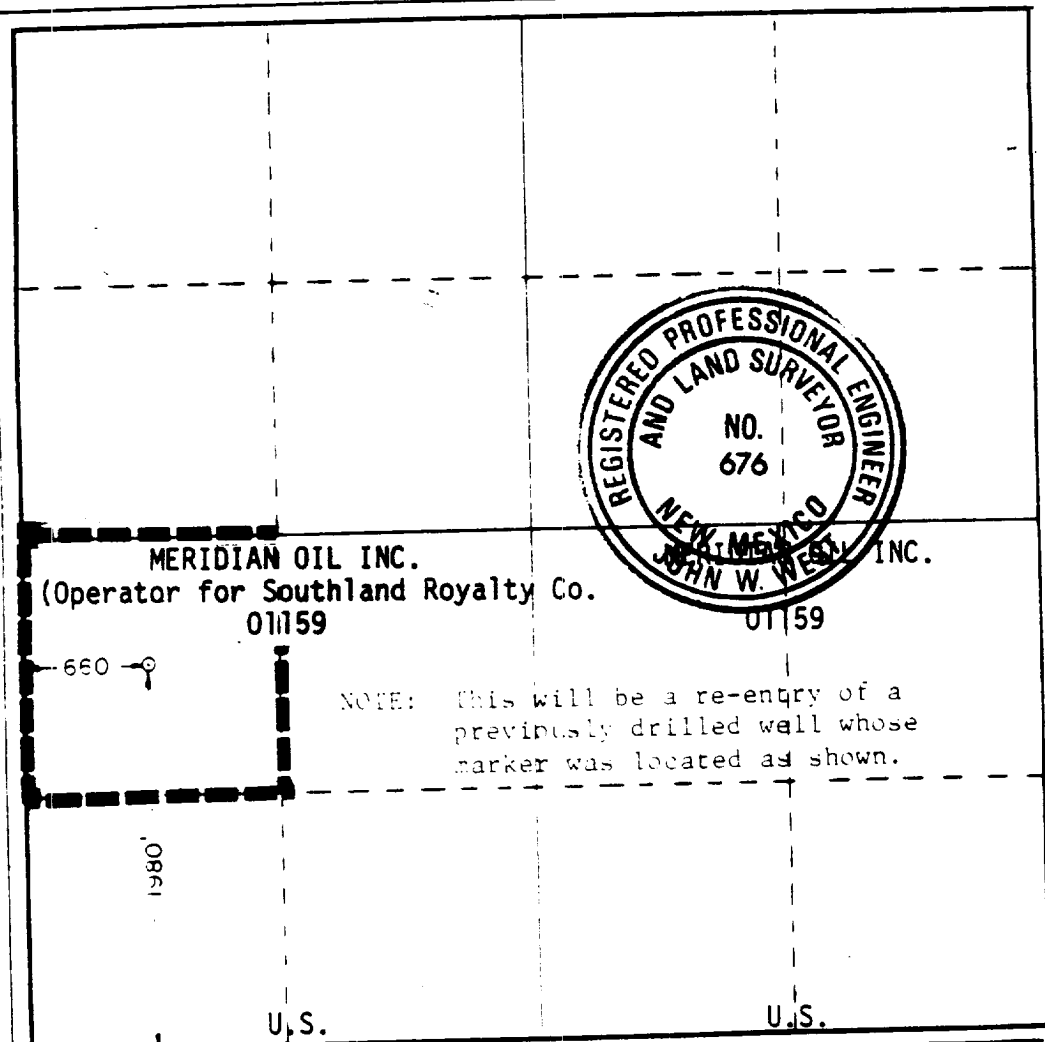

CERTIFICATION

I hereby certify that the information contained herein is true and complete to the best of my knowledge and belief.

Cathy Nokes

Name

Cathy Nokes

Position

Engineering Tech III

Company

Meridian Oil Inc.

Date

11/20/86

I hereby certify that the well location shown on this plat was plotted from field notes of actual surveys made by me or under my supervision, and that the same is true and correct to the best of my knowledge and belief.

Date Surveyed

November 17, 1986

Registered Professional Engineer and/or Land Surveyor

John W. West

Certificate No. JOHN W. WEST, 676
RONALD J. EIDSON, 3239

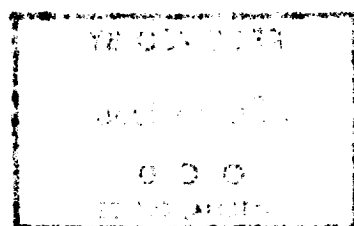

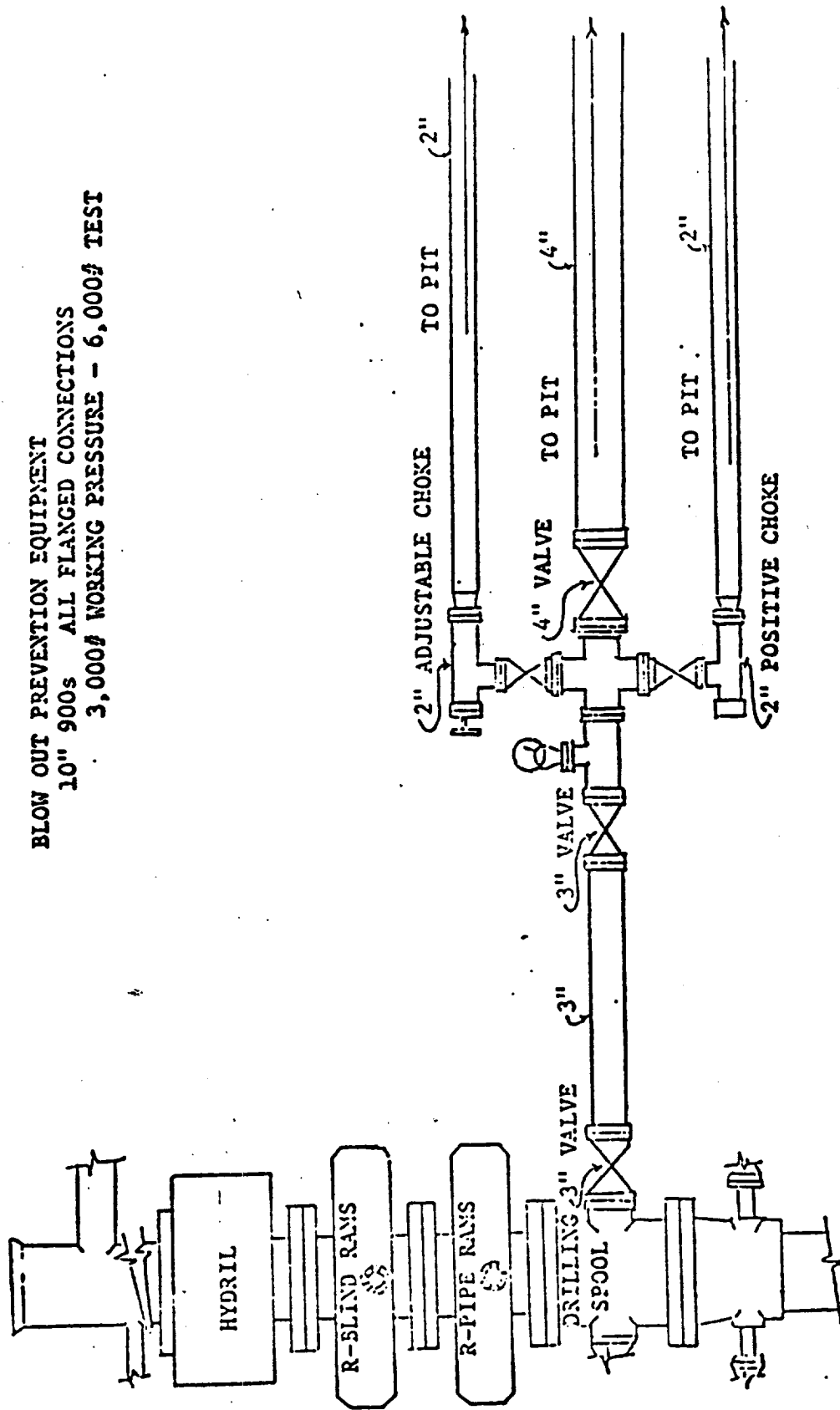

BLOW OUT PREVENTION EQUIPMENT
 10" 900s ALL FLANGED CONNECTIONS
 3,000# WORKING PRESSURE - 6,000# TEST

ATTACHMENT TO FORM C-101

MERIDIAN OIL INC.

F.A.F. FEDERAL No. 1
1980' FSL & 660' FWL
Sec. 4, T-18-S, R-30-E
Eddy County, New Mexico
NM-01159

To supplement USGS Form 9-331C Application to Drill the following additional information is submitted concerning questions on Page 5 of NTL-6:

1. See Form 9-331C.
2. See Form 9-331C.
3. The geological name of surface formation is: Ochoa
4. See Form 9-331C.
5. See Form 9-331C.
6. The logged tops of important geological markers are:

Rustler Anhydrite	260'	Abo	7990'
Salt	550'	Wolfcamp	8423'
Base Salt	1250'	Strawn	10,440'
Yates	1418'	Atoka	10,700'
Queen	2418'	Morrow	11,241'
Grayburg	2800'	Chester	11,819'
San Andres	3253'	Mississippian	11,950'
Glorieta	4626'		

7. The estimated depths at which anticipated water, oil gas and mineral bearing strata are as follows:

Strawn	10,440'	- Oil
Atoka	10,700'	- Gas

8. See Form 9-331C. All casing will be new.
9. See Form 9-331C for depths of strings. Cement volumes and additions as follows:
 - a. 9 5/8" csg: Tied back to surface per attached procedure.
 - b. 5 1/2" csg: Tied back to surface per attached procedure.

A caliper log will be run prior to setting 5 1/2" pipe to determine exact cement volumes required.

10. The pressure control diagram is attached to Form 9-331C. The following additional information is as follows:

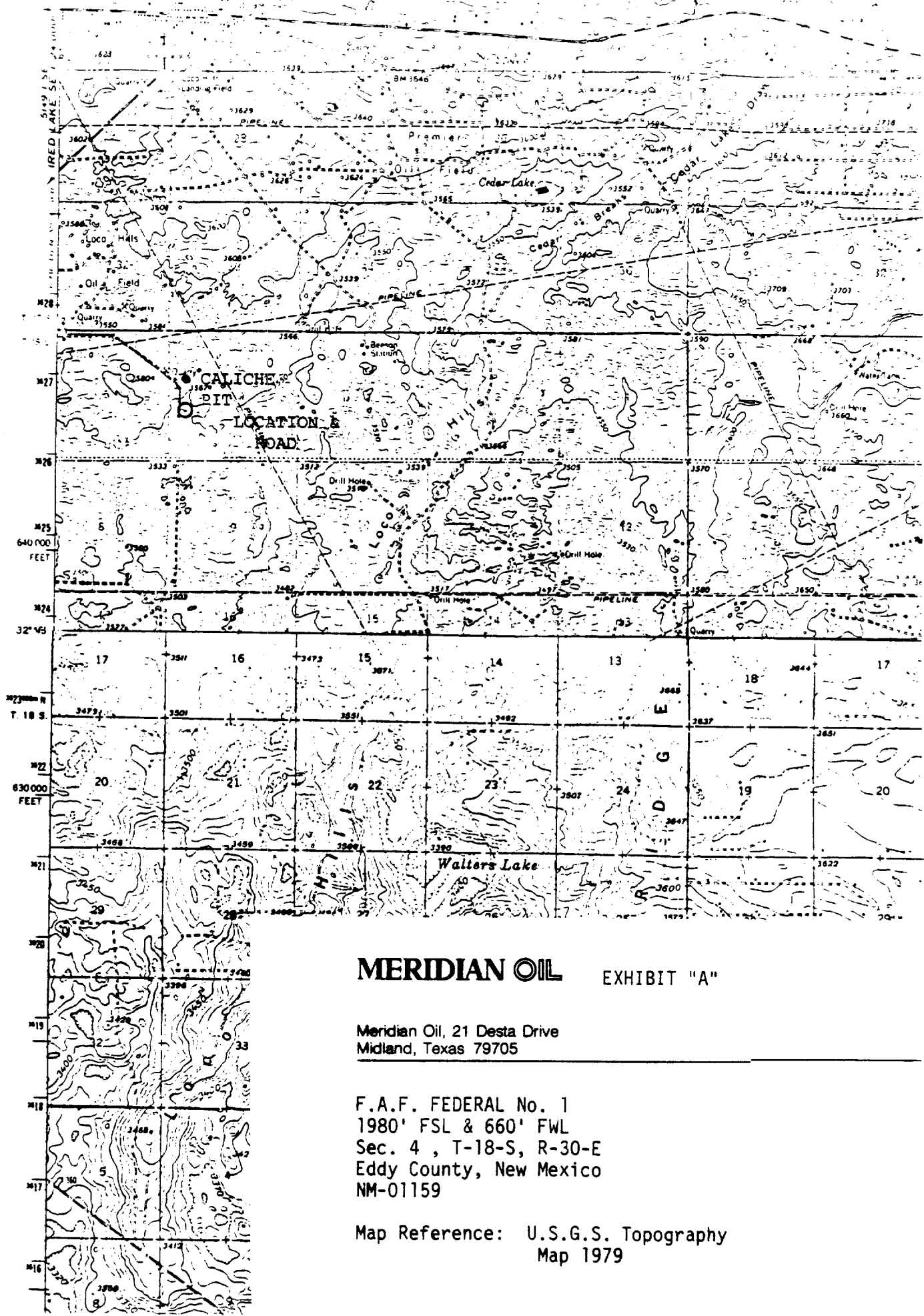

MERIDIAN OIL EXHIBIT "A"

Meridian Oil, 21 Desta Drive
Midland, Texas 79705

F.A.F. FEDERAL No. 1
1980' FSL & 660' FWL
Sec. 4 , T-18-S, R-30-E
Eddy County, New Mexico
NM-01159

Map Reference: U.S.G.S. Topography
Map 1979

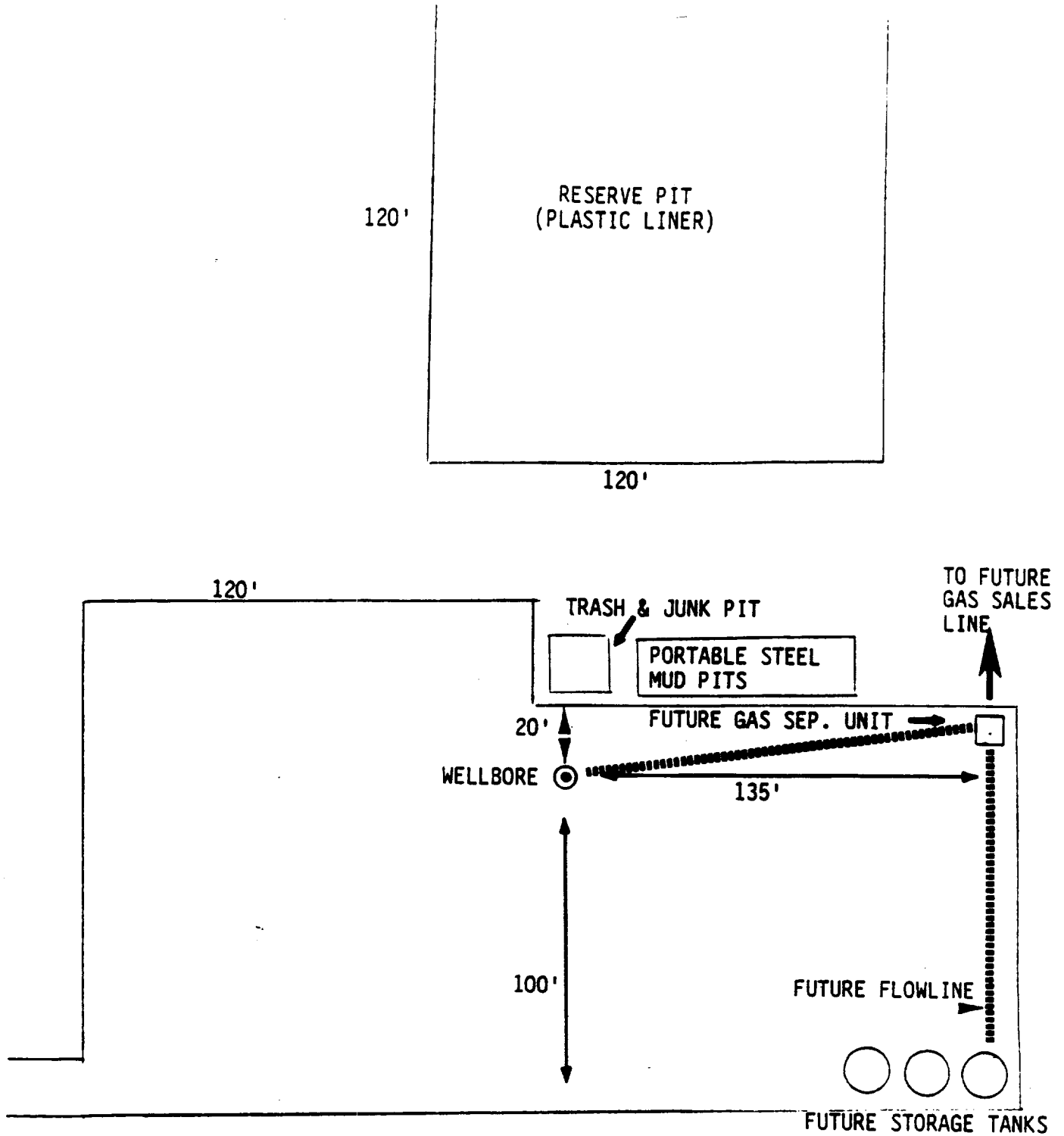

MERIDIAN OIL

EXHIBIT "C"

Meridian Oil, 21 Desta Drive
Midland, Texas 79705

F.A.F. FEDERAL No. 1
1980' FSL & 660' FWL
Sec. 4, T-18-S, R-30-E
Eddy County, New Mexico
NM-01159