

NO. OF COPIES RECEIVED	6
DISTRIBUTION	
SANTA FE	1
FILE	1 ✓
U.S.G.S.	2
LAND OFFICE	1
OPERATOR	1

NEW MEXICO OIL CONSERVATION COMMISSION

RECEIVED

FEB 24 1975

30-015-21485

Form C-101
Revised 1-1-65

1. Indicate Type of Lease STATE <input checked="" type="checkbox"/> FEE <input type="checkbox"/>
5. State Oil & Gas Lease No. B-6583
7. Unit Agreement Name Artesia State Unit
8. Farm or Lease Name Tract No. 1
9. Well No. 2
10. Field and Pool, or Wildcat Artesia
12. County Eddy
19. Proposed Depth 2,000'
19A. Formation Queen, GB or SA
20. Rotary or C.T. Rotary
21. Elevations (Show whether DF, RT, etc.) Blanket on File
21A. Kind & Status Plug. Bond Blanket on File
21B. Drilling Contractor Not Available
22. Approx. Date Work will start January 1975

APPLICATION FOR PERMIT TO DRILL, DEEPEN, OR PLUG BACK

1a. Type of Work
DRILL ☒ DEEPEN ☐ PLUG BACK ☐

b. Type of Well
OIL WELL ☐ GAS WELL ☐ OTHER **Water Injection** SINGLE ZONE ☐ MULTIPLE ZONE ☐

2. Name of Operator
Anadarko Production Company

3. Address of Operator
P. O. Box 67, Lee Hills, New Mexico 88255

4. Location of Well
UNIT LETTER **0** LOCATED **1310** FEET FROM THE **South** LINE
AND **1435** FEET FROM THE **East** LINE OF SEC. **14** TWP. **18S** RGE. **27E** NMPM

23. PROPOSED CASING AND CEMENT PROGRAM

SIZE OF HOLE	SIZE OF CASING	WEIGHT PER FOOT	SETTING DEPTH	SACKS OF CEMENT	EST. TOP
12 1/4"	8 5/8"	24#	300'	400	Circ.
7 7/8"	4 1/2"	10.5#	21,000'	300	900'

1. Rig up rotary tools.
2. Drill to approximately 300'; set and cement 8 5/8" casing.
3. Drill to TD 2,000'; run open hole logs.
4. Set and cement 4 1/2" casing on TD.
5. Perforate and Acidize Queen, Grayburg and/or San Andres Zones.
6. Equip for water injection.
7. Place well on injection.

APPROVAL VALID
FOR 90 DAYS UNLESS
DRILLING COMMENCED,

EXPIRES **5-28-75**

IN ABOVE SPACE DESCRIBE PROPOSED PROGRAM: IF PROPOSAL IS TO DEEPEN OR PLUG BACK, GIVE DATA ON PRESENT PRODUCTIVE ZONE AND PROPOSED NEW PRODUCTIVE ZONE. GIVE BLOWOUT PREVENTER PROGRAM, IF ANY.

I hereby certify that the information above is true and complete to the best of my knowledge and belief.

Signed **Original Signed by Jerry E. Bullock** Title **Area Supervisor** Date **December 26, 1974**
(This space for State Use)

APPROVED BY **W. C. Gussett** TITLE **SUPERVISOR, DISTRICT II** DATE **FEB 28 1975**
CONDITIONS OF APPROVAL, IF ANY:

Cement must be circulated to
surface behind **8 7/8"** casing

**NE MEXICO OIL CONSERVATION COMMISSION
WELL LOCATION AND ACREAGE DEDICATION PLAT**

Form C-102
Supersedes C-128
Effective 1-1-65

All distances must be from the outer boundaries of the Section.

Operator ANADARKO PRODUCTION COMPANY			Lease ARTESIA FIELD UNIT No. 1		Well No. X-2
Unit Letter "O"	Section 14	Township 18S	Range 27E	County EDDY	
Actual Footage Location of Well: 1310 feet from the South line and 1435 feet from the East line					
Ground Level Elev. 3490.1	Producing Formation, Queen-Grayburg-S. A.		Pool Artesia		Dedicated Acreage: 40 Acres

1. Outline the acreage dedicated to the subject well by colored pencil or hachure marks on the plat below.
2. If more than one lease is dedicated to the well, outline each and identify the ownership thereof (both as to working interest and royalty).
3. If more than one lease of different ownership is dedicated to the well, have the interests of all owners been consolidated by communitization, unitization, force-pooling, etc?

☐ Yes ☐ No If answer is "yes," type of consolidation _____

If answer is "no," list the owners and tract descriptions which have actually been consolidated. (Use reverse side of this form if necessary.) _____

No allowable will be assigned to the well until all interests have been consolidated (by communitization, unitization, forced-pooling, or otherwise) or until a non-standard unit, eliminating such interests, has been approved by the Commission.

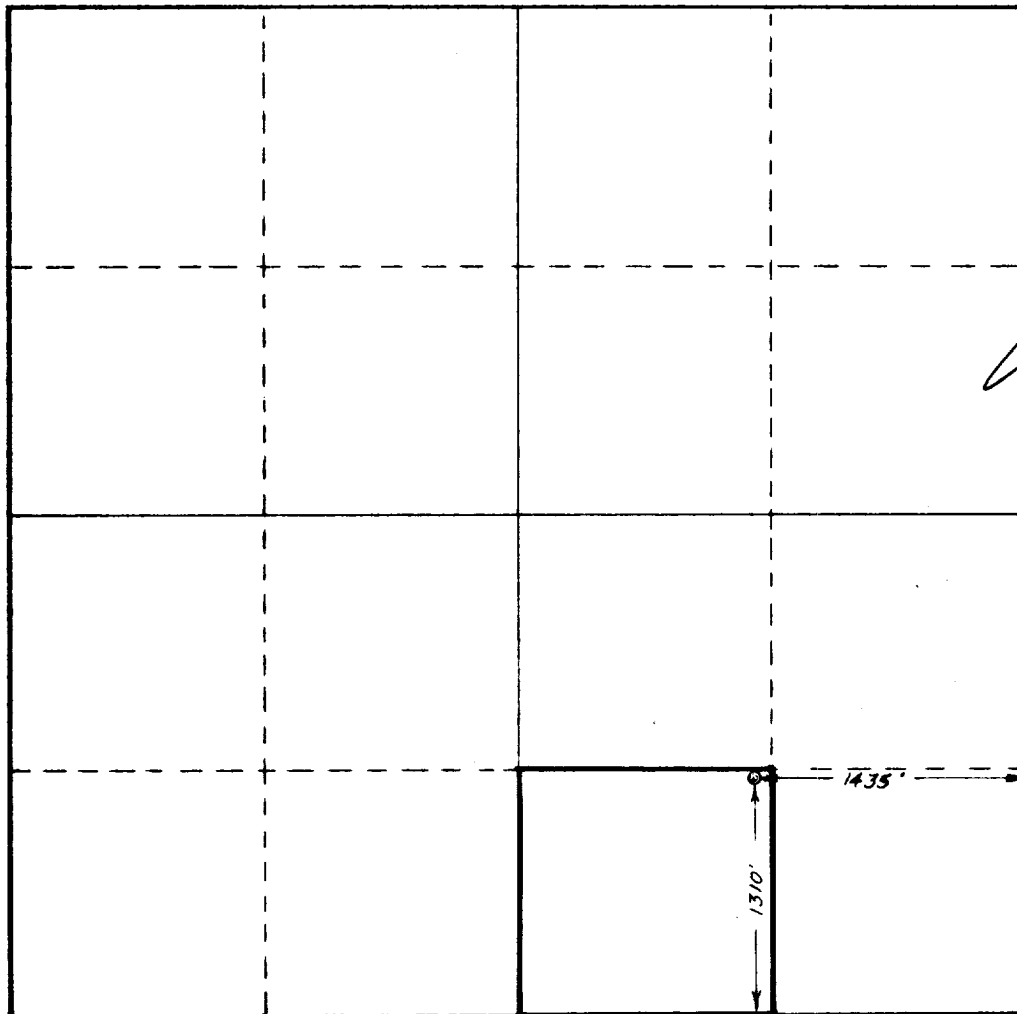

CERTIFICATION

I hereby certify that the information contained herein is true and complete to the best of my knowledge and belief.

Name _____
 Position _____
 Company _____
 Date _____

I hereby certify that the well location shown on this plat was plotted from field notes of actual surveys made by me or under my supervision, and that the same is true and correct to the best of my knowledge and belief.

Date Surveyed _____
 Registered Professional Engineer and/or Land Surveyor
HERSCHEL L. JONES
 Certified _____

