

NO. OF COPIES RECEIVED	6
DISTRIBUTION	
SANTA FE	1
FILE	1 ✓
U.S.G.S.	2
LAND OFFICE	1
OPERATOR	1

NEW MEXICO OIL CONSERVATION COMMISSION

30-015-21487

Form C-101
Revised 1-1-65

RECEIVED

JAN 6 - 1975

O.C.C.

5A. Indicate Type of Lease
STATE <input checked="" type="checkbox"/> FEE <input type="checkbox"/>

5. State Oil & Gas Lease No.
B-11083

APPLICATION FOR PERMIT TO DRILL, DEEPEN, OR PLUG BACK

1a. Type of Work		7. Unit Agreement Name	
b. Type of Well OIL WELL <input type="checkbox"/> GAS WELL <input type="checkbox"/> OTHER <input checked="" type="checkbox"/> Injection Well		Artesia State Unit	
2. Name of Operator Anadarko Production Company		8. Farm or Lease Name Tract No. 7	
3. Address of Operator P. O. Box 67, Lees Hills, New Mexico 88255		9. Well No. 1	
4. Location of Well UNIT LETTER B LOCATED 10 FEET FROM THE North LINE AND 2580 FEET FROM THE East LINE OF SEC. 23 TWP. 18S RGE. 27E NMPM		10. Field and Pool, or Wildcat Artesia	
		12. County Eddy	
		19. Proposed Depth 2,000'	
		19A. Formation Queen, GB or SA	
		20. Rotary or C.T. Rotary	
21. Elevations (Show whether DF, RT, etc.) 3480.9 GR		21B. Drilling Contractor Not Available	
21A. Kind & Status Plug. Bond Blanket on File		22. Approx. Date Work will start January 1975	

PROPOSED CASING AND CEMENT PROGRAM

SIZE OF HOLE	SIZE OF CASING	WEIGHT PER FOOT	SETTING DEPTH	SACKS OF CEMENT	EST. TOP
12 1/4"	8 5/8"	24#	300'	400	Circ.
7 7/8"	4 1/2"	10.5#	2,000'	300	900'

1. Rig up rotary Tools.
2. Drill to approximately 300'; set and cement 8 5/8" casing.
3. Drill to T. D. 2,000'; run open hole logs.
4. Set and cement 4 1/2" casing on T. D.
5. Perforate and Acidize Queen, Grayburg and or San Andres Zones.
6. Equip for water injection.
7. Place well on injection.

APPROVAL VALID
FOR 90 DAYS UNLESS
DRILLING COMMENCED,

EXPIRES 5-28-75

IN ABOVE SPACE DESCRIBE PROPOSED PROGRAM: IF PROPOSAL IS TO DEEPEN OR PLUG BACK, GIVE DATA ON PRESENT PRODUCTIVE ZONE AND PROPOSED NEW PRODUCTIVE ZONE. GIVE BLOWOUT PREVENTER PROGRAM, IF ANY.

I hereby certify that the information above is true and complete to the best of my knowledge and belief.

Signed Original Signed by Jerry E. Buckles Title Area Supervisor Date December 10, 1974

(This space for State Use)

APPROVED BY W. A. Gussert TITLE SUPERVISOR, DISTRICT II DATE FEB 28 1975

CONDITIONS OF APPROVAL, IF ANY:

Cement must be circulated to
surface behind 8 5/8" casing

**NEW MEXICO OIL CONSERVATION COMMISSION
WELL LOCATION AND ACREAGE DEDICATION PLAT**

Form C-102
Supersedes C-128
Effective 1-1-65

All distances must be from the outer boundaries of the Section.

Operator ANADARKO PRODUCTION COMPANY			Lease ARTESIA UNIT State N.M.		Well No. 4-1
Unit Letter 23	Section 23	Township 18S	Range 27E	County EDDY	
Actual Footage Location of Well: <div style="display: flex; justify-content: space-between;"> 10 feet from the North line and 2580 feet from the East line </div>					
Ground Level Elev. 3480.9	Producing Formation Queen-Grayburg	Pool Artesia	Dedicated Acreage: 40 Acres		

1. Outline the acreage dedicated to the subject well by colored pencil or hatchure marks on the plat below.
2. If more than one lease is dedicated to the well, outline each and identify the ownership thereof (both as to working interest and royalty).
3. If more than one lease of different ownership is dedicated to the well, have the interests of all owners been consolidated by communitization, unitization, force-pooling, etc?

☐ Yes ☐ No If answer is "yes," type of consolidation _____

If answer is "no," list the owners and tract descriptions which have actually been consolidated. (Use reverse side of this form if necessary.) _____

No allowable will be assigned to the well until all interests have been consolidated (by communitization, unitization, forced-pooling, or otherwise) or until a non-standard unit, eliminating such interests, has been approved by the Commission.

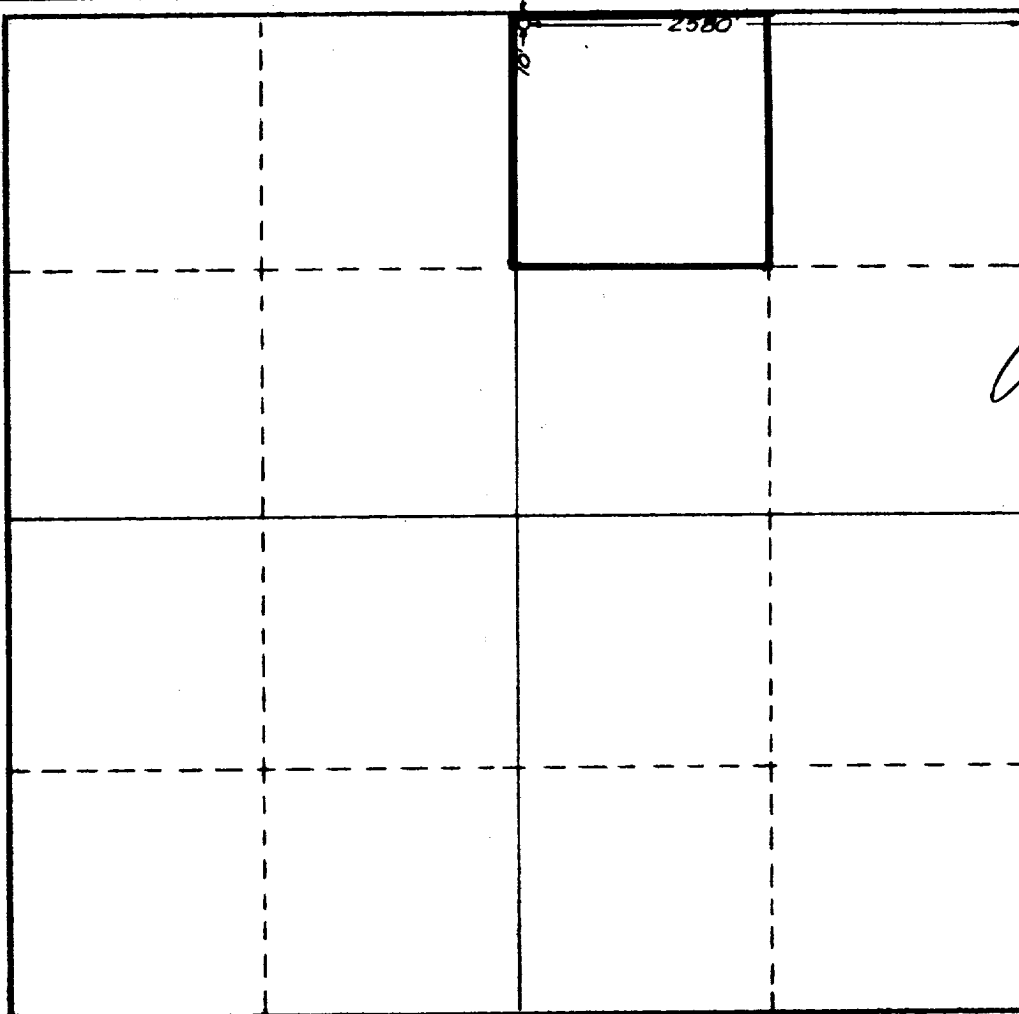

CERTIFICATION

I hereby certify that the information contained herein is true and complete to the best of my knowledge and belief.

Name *James E. Hughes*
Position *Area Supervisor*
Company *Anadarko Production Co.*
Date *Jan 3, 1975*

I hereby certify that the well location shown on this plat was plotted from field notes of actual surveys made by me or under my supervision, and that the same is true and correct to the best of my knowledge and belief.

Date Surveyed **December 24, 1974**
Registered Professional Engineer and/or Land Surveyor
Herschel L. Jones
Certificate No. **3840**

