

NO. OF COPIES RECEIVED 6

DISTRIBUTION

SANTA FE	<u>1</u>	
FILE	<u>1</u>	<u>✓</u>
U.S.G.S.	<u>2</u>	
LAND OFFICE	<u>1</u>	
OPERATOR	<u>1</u>	

RECEIVED
NEW MEXICO OIL CONSERVATION COMMISSION

APR 10 1975

O.C.C.
ARTESIA, OFFICE

30-015-21512

Form C-101
Revised 1-1-65

5A. Indicate Type of Lease
STATE ☒ FEE ☐

5. State Oil & Gas Lease No.
E-2211

APPLICATION FOR PERMIT TO DRILL, DEEPEN, OR PLUG BACK

1a. Type of Work
b. Type of Well DRILL ☒ DEEPEN ☐ PLUG BACK ☐
OIL WELL ☒ GAS WELL ☐ OTHER ☐ SINGLE ZONE ☐ MULTIPLE ZONE ☐

2. Name of Operator
Harvey E. Yates Company, Inc.

3. Address of Operator
Suite 1000 Security National Bank Bldg., Roswell, NM

4. Location of Well
UNIT LETTER **A** LOCATED **330** FEET FROM THE **North** LINE
AND **990** FEET FROM THE **East** LINE OF SEC. **32** TWP. **18S** RGE. **30E** NMPM

7. Unit Agreement Name

8. Farm or Lease Name
State

9. Well No.
3

10. Field and Pool, or Wildcat
N. Benson Queen Grayburg

12. County
Eddy

19. Proposed Depth
3300'

19A. Formation
Loco Hills

20. Rotary or C.T.
C. T.

21. Elevations (Show whether DF, RT, etc.)
3425 GR

21A. Kind & Status Plug. Bond

21B. Drilling Contractor
HEYCO

22. Approx. Date Work will start
4/20/75

23.

PROPOSED CASING AND CEMENT PROGRAM

SIZE OF HOLE	SIZE OF CASING	WEIGHT PER FOOT	SETTING DEPTH	SACKS OF CEMENT	EST. TOP
10"	8 5/8"	32	600'	circ 60 sx	
8"	5 1/2"	9.5	3300'	480 sx	

APPROVAL VALID
FOR 90 DAYS UNLESS
DRILLING COMMENCED,

EXPIRES 7-14-75

IN ABOVE SPACE DESCRIBE PROPOSED PROGRAM: IF PROPOSAL IS TO DEEPEN OR PLUG BACK, GIVE DATA ON PRESENT PRODUCTIVE ZONE AND PROPOSED NEW PRODUCTIVE ZONE. GIVE BLOWOUT PREVENTER PROGRAM, IF ANY.

I hereby certify that the information above is true and complete to the best of my knowledge and belief.

Signed Jack Yates Title Vice President Date 4/10/75
(This space for State Use)

APPROVED BY W. A. Gussett TITLE SUPERVISOR, DISTRICT II DATE APR 14 1975

CONDITIONS OF APPROVAL, IF ANY:

Cement must be circulated to
surface behind 8 5/8" casing

OPV1975A

ENCLOSURE

ENCLOSURE

RECEIVED

APR 14 1975

O.C.C.
ARTERIA, OFFICE

NEW MEXICO OIL CONSERVATION COMMISSION
WELL LOCATION AND ACREAGE DEDICATION PLAT

Form C-102
Supersedes C-128
Effective 1-1-65

All distances must be from the outer boundaries of the Section.

Operator <i>Harvey Yates</i>		Lease <i>State</i>		Well No. <i>3</i>	
Unit Letter <i>A</i>	Section <i>32</i>	Township <i>18 South</i>	Range <i>30 East</i>	County <i>Eddy</i>	
Actual Footage Location of Well: <i>330</i> feet from the <i>North</i> line and <i>990</i> feet from the <i>East</i> line					
Ground Level Elev. <i>3425</i>	Producing Formation <i>Loco Hills</i>		Pool <i>N. Bensen Queen Grayburg</i>		Dedicated Acreage: <i>40</i> Acres

1. Outline the acreage dedicated to the subject well by colored pencil or hachure marks on the plat below.
2. If more than one lease is dedicated to the well, outline each and identify the ownership thereof (both as to working interest and royalty).
3. If more than one lease of different ownership is dedicated to the well, have the interests of all owners been consolidated by communitization, unitization, force-pooling, etc?

☐ Yes ☐ No If answer is "yes," type of consolidation _____

If answer is "no," list the owners and tract descriptions which have actually been consolidated. (Use reverse side of this form if necessary.) _____

No allowable will be assigned to the well until all interests have been consolidated (by communitization, unitization, forced-pooling, or otherwise) or until a non-standard unit, eliminating such interests, has been approved by the Commission.

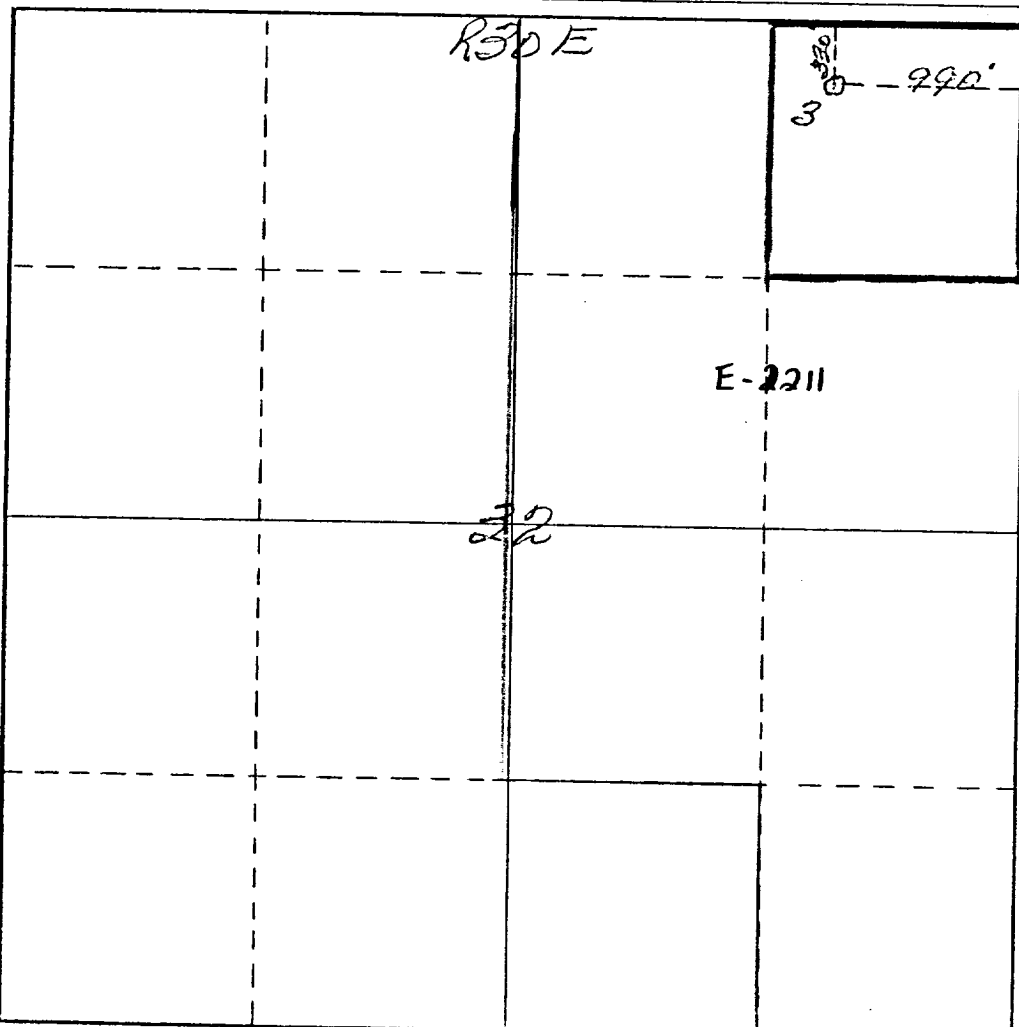

CERTIFICATION

I hereby certify that the information contained herein is true and complete to the best of my knowledge and belief.

Harvey Yates

Name
Vice President

Position
Harvey E. Yates Company

Company
April 10, 1975

Date

I hereby certify that the well location shown on this plat was plotted from field notes of actual surveys made by me or under my supervision, and that the same is true and correct to the best of my knowledge and belief.

JAMES H. BROWN

Date Surveyed

April 8th 1975

Registered Professional Engineer
and/or Land Surveyor

James H. Brown

Certificate No.

542

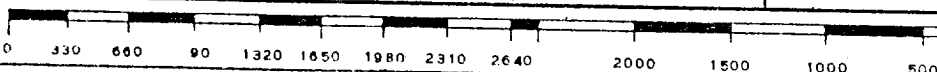

RECEIVED

APR 14 1975

**J.C.C.
ARTESIA, OFFICE**

Upper Station 412
A. 22-7-50

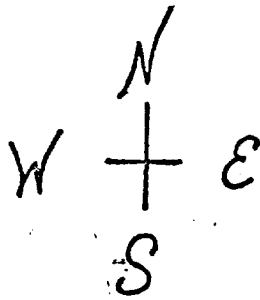

← 100' →

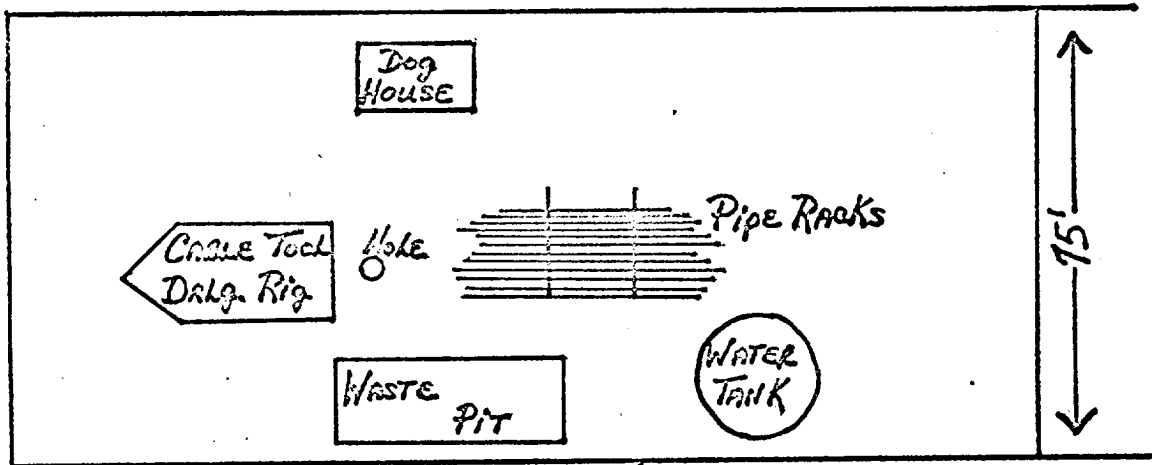

75'

1200'





OIL CONSERVATION COMMISSION

STATE OF NEW MEXICO
P. O. DRAWER DD - ARTESIA
88210

April 10, 1975

I. R. TRUJILLO
CHAIRMAN

LAND COMMISSIONER
PHIL R. LUCERO
MEMBER

STATE GEOLOGIST
A. L. PORTER, JR.
SECRETARY - DIRECTOR

Harvey E. Yates Co., Inc.
Suite 1000 Security National Bank Building
Roswell, New Mexico 88201

Re: State #3-A, 32-18-30
Eddy County, New Mexico

Gentlemen:

We are returning the enclosed Form C-101 and C-102 on the subject well for additional information. On Form C-101, show kind and status of bond, weight of casing, and amount of cement on 8 5/8" and cement 5½" similar to well #2 and sign all copies.

On Form C-102 show producing formation, pool name, outline dedicated acreage and sign all copies.

Sincerely yours,

OIL CONSERVATION COMMISSION

W. A. Gressett
Supervisor, District II

WAG:jw
Encl:

