

UNITED STATES  
DEPARTMENT OF THE INTERIOR  
GEOLOGICAL SURVEY

## APPLICATION FOR PERMIT TO DRILL, DEEPEN, OR PLUG BACK

1a. TYPE OF WORK  
DRILL ☒ DEEPEN ☐ PLUG BACK ☐

b. TYPE OF WELL  
OIL WELL ☐ GAS WELL ☒ OTHER ☐ SINGLE ZONE ☒ MULTIPLE ZONE ☐

2. NAME OF OPERATOR  
Yates Petroleum Corporation

3. ADDRESS OF OPERATOR  
207 South 4th Street - Artesia, NM 88210

4. LOCATION OF WELL (Report location clearly and in accordance with any State requirements)  
At surface  
660' FSL & 1980' FEL of Sec. 6-18S-25E  
At proposed prod. zone

14. DISTANCE IN MILES AND DIRECTION FROM NEAREST TOWN OR POST OFFICE\*  
Approx. 10 miles SW of Artesia, NM

15. DISTANCE FROM PROPOSED\* LOCATION TO NEAREST PROPERTY OR LEASE LINE, FT. (Also to nearest drilg. unit line, if any)

16. NO. OF ACRES IN LEASE

17. NO. OF ACRES ASSIGNED TO THIS WELL

18. DISTANCE FROM PROPOSED LOCATION\* TO NEAREST WELL, DRILLING, COMPLETED, OR APPLIED FOR, ON THIS LEASE, FT.

19. PROPOSED DEPTH  
Approx. 8600'

20. ROTARY OR CABLE TOOLS  
Rotary

21. ELEVATIONS (Show whether DF, RT, GR, etc.)  
3632' GR

22. APPROX. DATE WORK WILL START\*  
As soon as approved

5. LEASE DESIGNATION AND SERIAL NO.  
NM 15664

6. IF INDIAN, ALLOTTEE OR TRIBE NAME

7. UNIT AGREEMENT NAME

8. FARM OR LEASE NAME  
Federal "EF" Com

9. WELL NO.  
1

10. FIELD AND POOL, OR WILDCAT  
Richard Knob

11. SEC., T., R., M., OR BLK. AND SURVEY OR AREA  
Sec. 6-18S-25E  
Unit 0 NMPM

12. COUNTY OR PARISH  
Eddy

13. STATE  
NM

PROPOSED CASING AND CEMENTING PROGRAM				
SIZE OF HOLE	SIZE OF CASING	WEIGHT PER FOOT	SETTING DEPTH	QUANTITY OF CEMENT
17½"	12-3/4 or 13-3/8"	48#	Approx 200'	Circulate
12½"	8-5/8"	32.4#	Approx 1000'	Circulate
7-7/8"	4½ or 5½"	10.5-11.6 or 15.5-17#	Approx 8600'	Approx 250 sxs

Propose to drill and test the Morrow sand and intermediate formations. Approx 200' of surface casing will be cemented for protection from surface gravel, 8-5/8" casing will be run and cemented 100' below the Artesian zone and if production is encountered will run 4½ or 5½" casing.

Mud Program: Fresh water gel to 1000', water to 6500', flosal and drispak to total depth.

BOP Program: BOP's will be installed on intermediate. Hydrill will be installed and tested prior to drilling the Wolfcamp; pipe rams will be tested daily, blind rams on trips.

IN ABOVE SPACE DESCRIBE PROPOSED PROGRAM: If proposal is to deepen or plug back, give data on present productive zone and proposed new productive zone. If proposal is to drill or deepen directionally, give pertinent data on subsurface locations and measured and true vertical depths. Give blowout preventer program, if any.

24. SIGNED Eddie L. Beekman TITLE Engineer DATE 4-10-75

(This space for Federal or State office use)

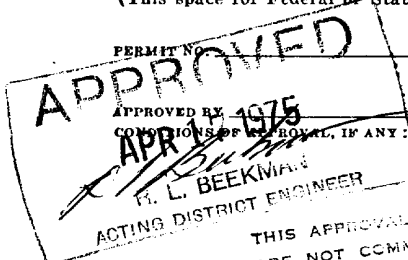

SUBJECT TO ATTACHED DEEP WELL CONTROL REQUIREMENTS DATED JUN 22 1973  
TITLE \_\_\_\_\_

THIS APPROVAL IS RESCINDED IF OPERATIONS ARE NOT COMMENCED WITHIN 3 MONTHS.  
\*See Instructions On Reverse Side  
JUL 17 1975

NOTIFY USGS IN SUFFICIENT TIME TO (1) CEMENT BEHIND THE CASING.  
DECLARED WATER BASIN  
13 1/4  
8 1/2  
CASING MUST BE CIRCULATED

RECEIVED

AUG 11 1975

G. B. G.  
ARTESIA, OFFICE

RECEIVED

AUG 18 1975

G. B. G.  
ARTESIA, OFFICE

NEW MEXICO OIL CONSERVATION COMMISSION  
WELL LOCATION AND ACREAGE DEDICATION PLAT

Form C-102  
Supersedes C-128  
Effective 1-1-65

All distances must be from the outer boundaries of the Section.

Operator <i>Yates Petroleum Corporation</i>			Lease <i>Federal EF</i>			Well No. <i>1</i>
Unit Letter <i>0</i>	Section <i>6</i>	Township <i>18 South</i>	Range <i>25 East</i>	County <i>Eddy</i>		
Actual Footage Location of Well: <i>660</i> feet from the <i>South</i> line and <i>1980</i> feet from the <i>East</i> line						
Ground Level Elev. <i>3432</i>	Producing Formation <i>Morrow</i>		Pool <i>Richard's Knob</i>	Dedicated Acreage: <i>320</i> Acres		

1. Outline the acreage dedicated to the subject well by colored pencil or hachure marks on the plat below.
2. If more than one lease is dedicated to the well, outline each and identify the ownership thereof (both as to working interest and royalty).
3. If more than one lease of different ownership is dedicated to the well, have the interests of all owners been consolidated by communitization, unitization, force-pooling, etc?

☒ Yes ☐ No If answer is "yes," type of consolidation Communitization

If answer is "no," list the owners and tract descriptions which have actually been consolidated. (Use reverse side of this form if necessary.)

No allowable will be assigned to the well until all interests have been consolidated (by communitization, unitization, forced-pooling, or otherwise) or until a non-standard unit, eliminating such interests, has been approved by the Commission.

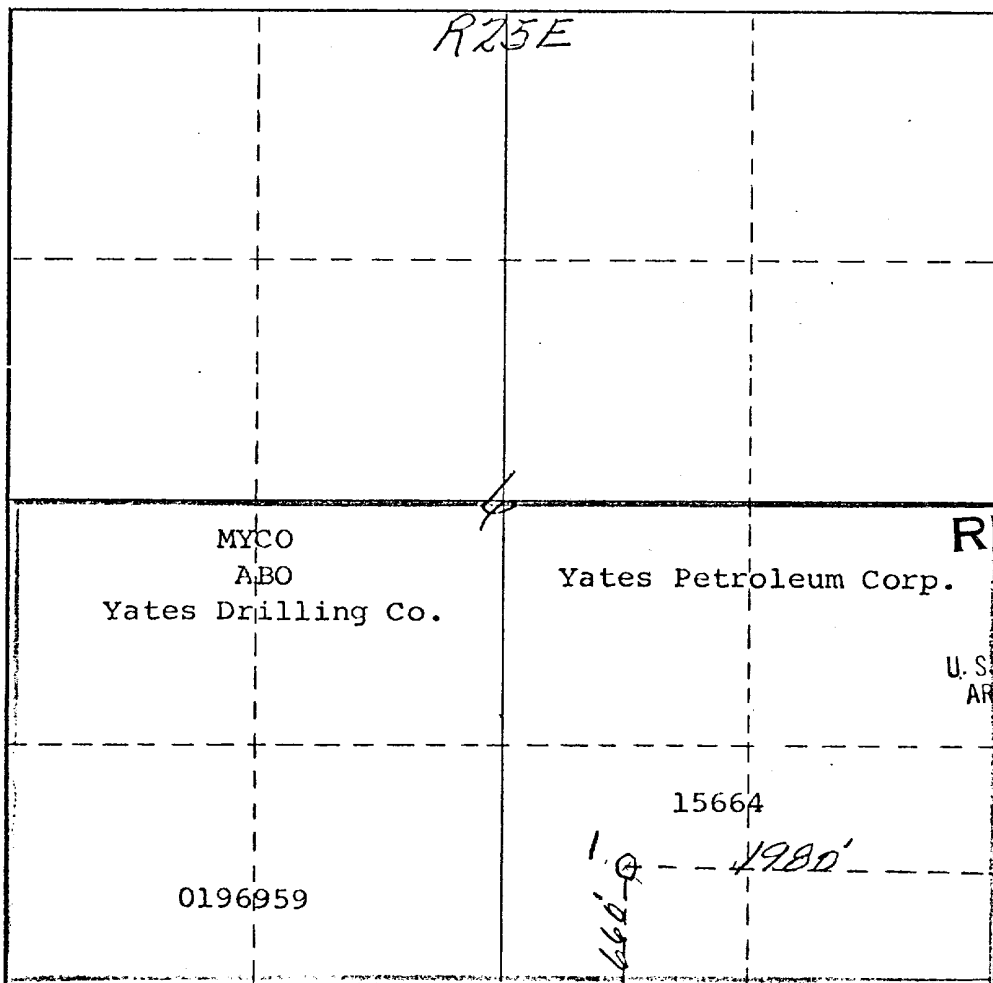

CERTIFICATION

I hereby certify that the information contained herein is true and complete to the best of my knowledge and belief.

*Eddie M. Mahfood*  
Name  
Eddie M. Mahfood

Position  
Engineer

Company  
Yates Petroleum Corp.

Date  
4-10-75

RECEIVED

I hereby certify that the well location shown on this plat was plotted from field notes of actual surveys made by me or U.S. GEOLOGICAL SURVEY, and that the same are correct to the best of my knowledge and belief.

APR 10 1975  
U.S. GEOLOGICAL SURVEY  
ARTESIA, NEW MEXICO  
NO. 542  
JAMES H. BROWN

Date Surveyed  
April 8th 1975  
Registered Professional Engineer  
and/or Land Surveyor

*James H. Brown*  
Certificate No. 542

0 330 660 990 1320 1650 1980 2310 2640 2000 1500 1000 500 0

Yates Petroleum Corporation  
Federal "EF" No. 1  
660' FSL & 1980' FEL of Section 6-18S-25E  
Eddy County, New Mexico

Development plan to accompany "Applications to Drill, Federal Lease".  
12-Point Plan.

1. EXISTING ROADS: See Plat (Exhibit A) Caliched roads maintained and watered as needed.
2. PLANNED ACCESS ROADS: See Plat (Exhibit A) Access road approx. 1200' west from existing road.
3. LOCATION OF WELLS: See Plat (Exhibit A) Relatively flat terrain with good drainage in standard gas well location.
4. LATERAL ROADS TO LOCATION: See Plat (Exhibit A)
5. LOCATION OF TANK BATTERY & FLOWLINES: See Plat (Exhibit C) Tank battery and flowlines on east side of location.
6. LOCATION & TYPES OF WATER SUPPLY: See Plat (Exhibit A) Drilling water to be trucked from source well in Section 1-18S-24E
7. METHODS FOR HANDLING WASTE DISPOSAL: See Sketch (Exhibit C) Pits for mud, separate pit for trash and engine oil.
8. LOCATION OF CAMPS: Not Applicable.
9. LOCATION OF AIRSTRIPS: Not Applicable.
10. LOCATION LAYOUT (rig, tanks, pits, racks, etc): See Sketch (Exhibit C)
11. PLANS FOR RESTORATION OF SURFACE: If dry hole, will erect marker, level pits, restore ground as near original as possible. If producer will fence and level pits as needed.
12. OTHER ENVIRONMENT INFORMATION: Sparse mesquite, tumbleweed and prairie grass. Road and pipeline on common right-of-way with minimum environmental disturbance. Access road satisfactory to rancher.

Yates Petroleum Corporation  
Federal "EF" No. 1  
660' FSL & 1980' FEL of Section 6-18S-25E  
Eddy County, New Mexico

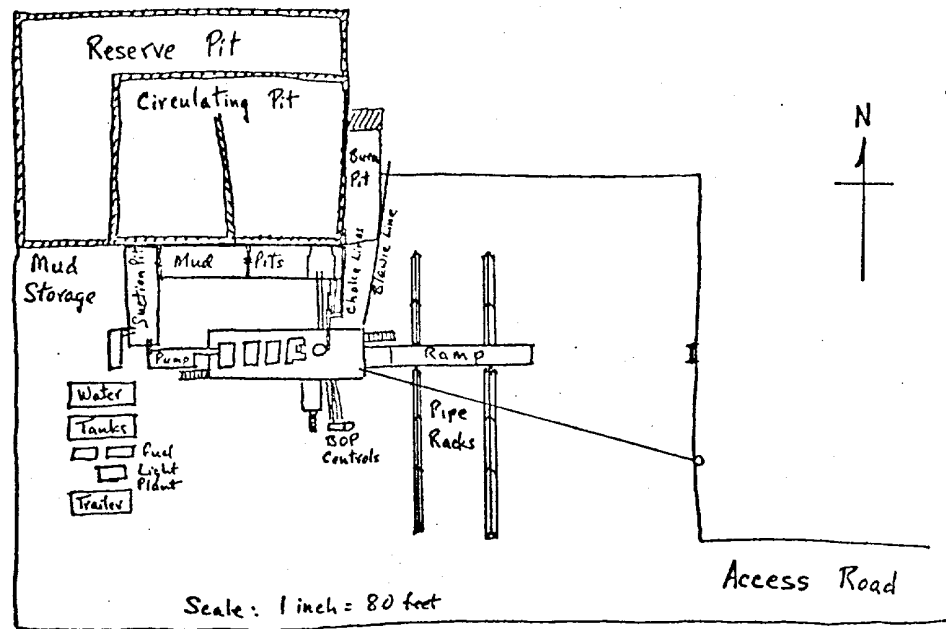

Layout of Drilling Rig & Equipment

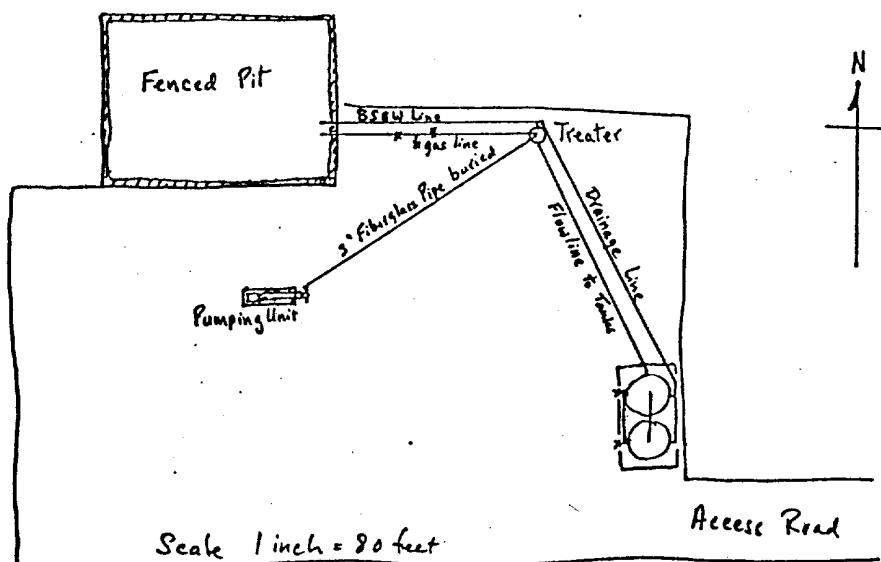

Layout of Production Facilities

Exhibit "C"

DIAGRAMMATIC SKETCH OF 3000 PSI BOP ASSEMBLY

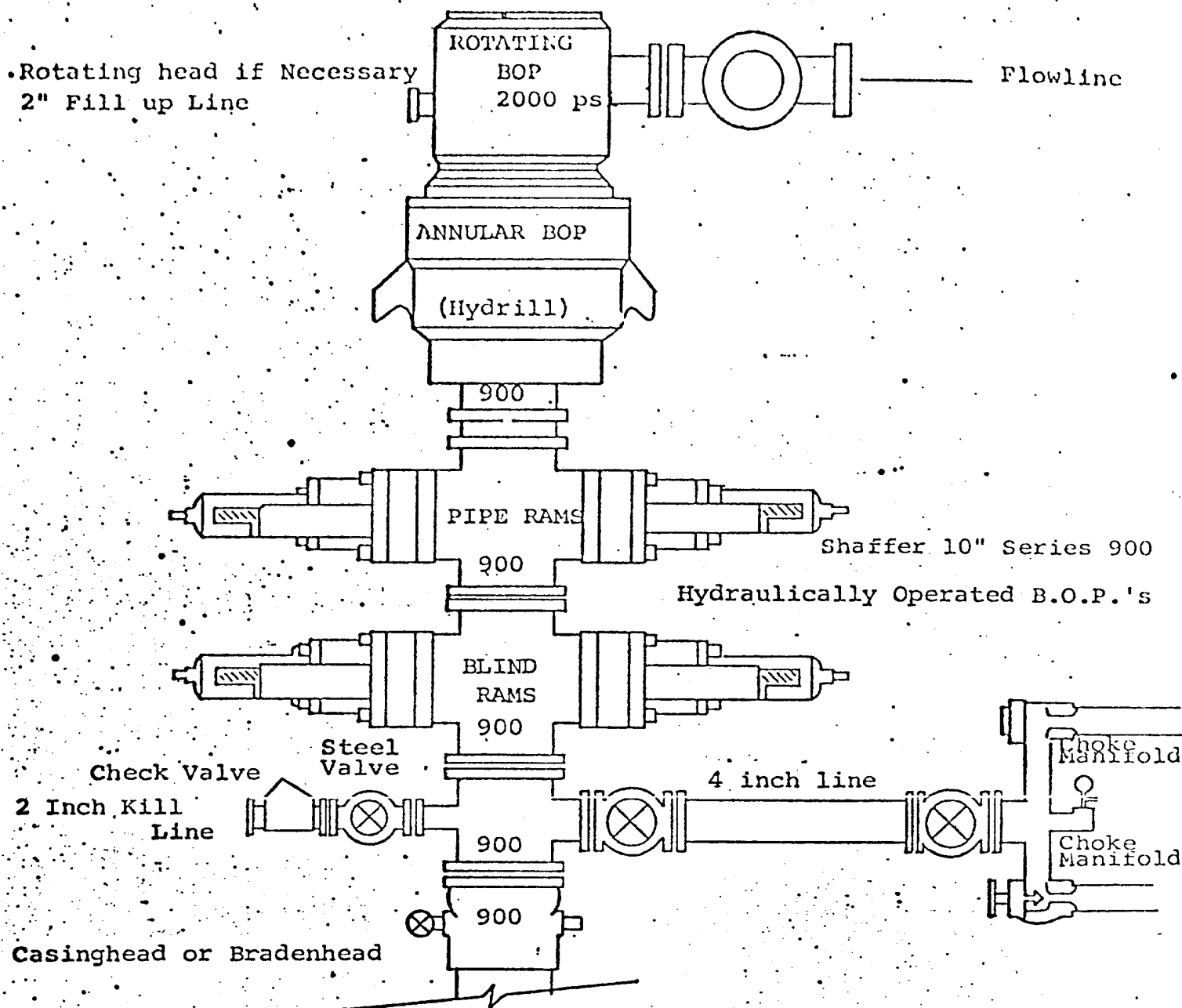

THE FOLLOWING CONSTITUTE MINIMUM BLOWOUT PREVENTER REQUIREMENTS

1. All preventers to be hydraulically operated with secondary manual controls installed prior to drilling out from under casing.
2. Choke outlet to be a minimum of 4" diameter.
3. Kill line to be of all steel construction of 2" minimum diameter.
4. All connections from operating manifolds to preventers to be all steel hole or tube a minimum of one inch in diameter.
5. The available closing pressure shall be at least 15% in excess of that required with sufficient volume to operate the B.O.P.'s.
6. All Connections to and from preventer to have a pressure rating equivalent to that of the B.O.P.'s.
7. Inside blowout preventer to be available on rig floor.
8. Operating controls located a safe distance from the rig floor.
9. Hole must be kept filled on trips below intermediate casing. Operator not responsible for blowouts resulting from not keeping hole full.
10. D.P. float must be installed and used below zone of first gas intrusion.

