

MEXICO OIL CONSERVATION COMMISS
WE. LOCATION AND ACREAGE DEDICATION PLAT

Form C-102
Supersedes C-128
Effective 1-1-65

All distances must be from the outer boundaries of the Section

Grantor Atlantic Richfield Company			Lease Stirling Com		Well No. 1
Section F	Section 7	Township 18 South	Range 27 East	County Eddy	
Acres of the Section of Well:					
1650 feet from the North line and		1980 feet from the West line			
Ground Level Elev. 3285.5	Producing Formation Morrow Gas	Pool Red Lake Penn Undesignated	Dedicated Acreage: 321.47 Acres		

- Outline the acreage dedicated to the subject well by colored pencil or hachure marks on the plat below.
- If more than one lease is dedicated to the well, outline each and identify the ownership thereof (both as to working interest and royalty).
- If more than one lease of different ownership is dedicated to the well, have the interests of all owners been consolidated by communitization, unitization, force-pooling, etc?

☐ Yes ☒ No If answer is "yes," type of consolidation _____

If answer is "no," list the owners and tract descriptions which have actually been consolidated. (Use reverse side of this form if necessary.) See Plat below

No allowable will be assigned to the well until all interests have been consolidated (by communitization, unitization, forced-pooling, or otherwise) or until a non-standard unit, eliminating such interests, has been approved by the Commission.

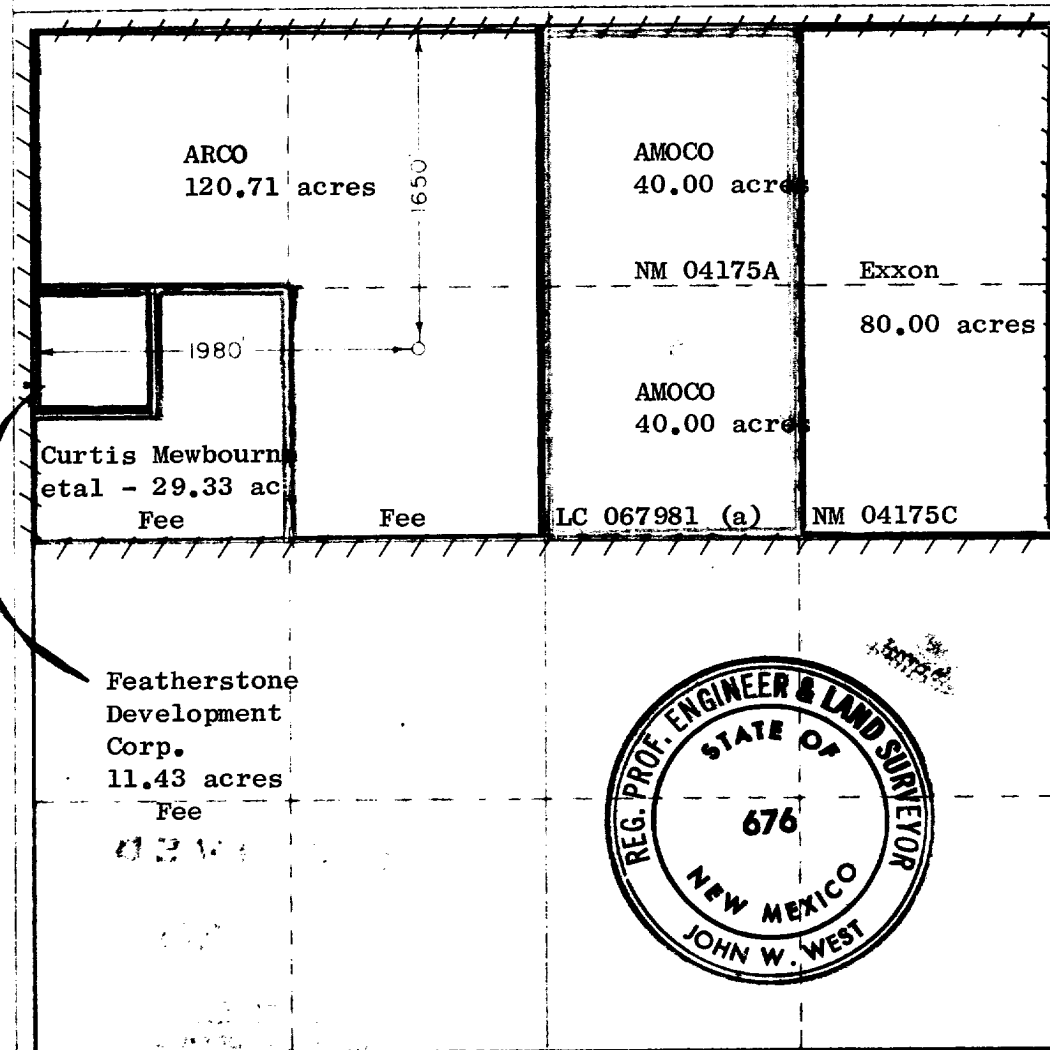

CERTIFICATION

I hereby certify that the information contained herein is true and complete to the best of my knowledge and belief.

Name

Position

Dist. Drlg. Supv.

Company

Atlantic Richfield Co.

Date

4/29/75

I hereby certify that the well location shown on this plat was plotted from field notes of actual surveys made by me or under my supervision, and that the same is true and correct to the best of my knowledge and belief.

Date Surveyed

April 24, 1975

Registered Professional Engineer and/or Land Surveyor

Certificate No.

676

RECEIVED

MAY 7 1975

**O. G. C.
ARTERIA, OFFICE**