

**MEXICO OIL CONSERVATION COMMISSION
WE - LOCATION AND ACREAGE DEDICATION PLAT**

Form C-102
Supersedes C-128
Effective 1-1-65

All distances must be from the outer boundaries of the Section

Devon Energy Corporation (Nevada)			Lease Sterling		Well No. 1
Section F	Section 7	Township 18 South	Range 27 East	County Eddy	
Actual Well Location at Well: 1650 feet from the North line and 1980 feet from the West line					
Ground Level Elev. 3285.5	Producing Formation		Pool Red Lake; Glorieta-Yeso		Dedicated Acreage: Acres

1. Outline the acreage dedicated to the subject well by colored pencil or hatchure marks on the plat below.
2. If more than one lease is dedicated to the well, outline each and identify the ownership thereof (both as to working interest and royalty).
3. If more than one lease of different ownership is dedicated to the well, have the interests of all owners been consolidated by communitization, unitization, force-pooling, etc?

☐ Yes ☐ No If answer is "yes," type of consolidation _____

If answer is "no," list the owners and tract descriptions which have actually been consolidated. (Use reverse side of this form if necessary.) _____

No allowable will be assigned to the well until all interests have been consolidated (by communitization, unitization, forced-pooling, or otherwise) or until a non-standard unit, eliminating such interests, has been approved by the Commission.

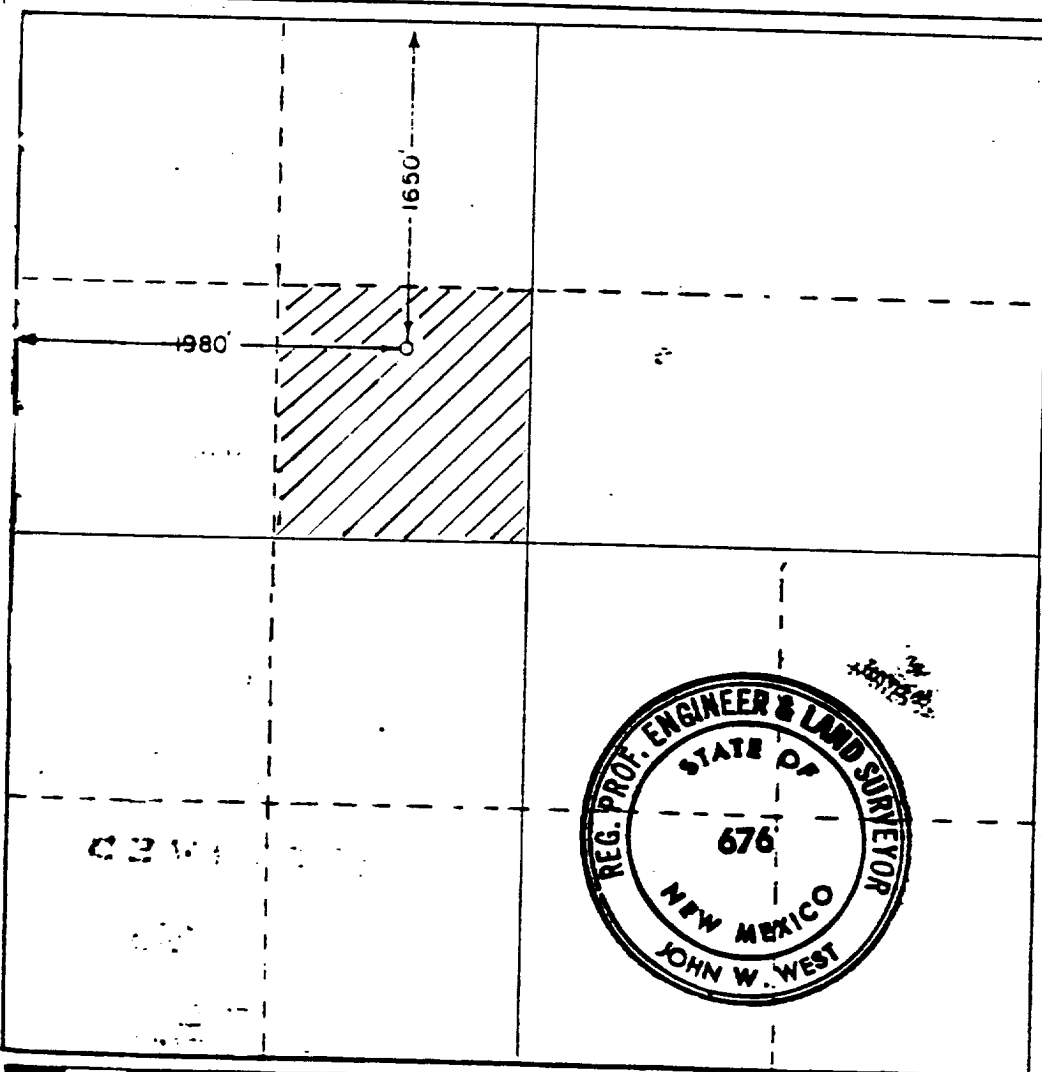

CERTIFICATION

I hereby certify that the information contained herein is true and complete to the best of my knowledge and belief.

Name E. L. Bateman, Jr.
 Position District Engineer
 Company Devon Energy Corp. (Nevada)
 Date February 2, 2000

I hereby certify that the well location shown on this plat was plotted from field notes of actual surveys made by me or under my supervision, and that the same is true and correct to the best of my knowledge and belief.

Date Surveyed April 24, 1975
 Registered Professional Engineer and/or Land Surveyor

John W. West
 Certificate No. **676**

330 580 90 1320 1680 1880 2310 2640 2000 1800 1000 500 0