

NO. OF COPIES RECEIVED	6
DISTRIBUTION	
SANTA FE	
FILE	
U.S.G.S.	
LAND OFFICE	
OPERATOR	

NEW MEXICO OIL CONSERVATION COMMISSION

RECEIVED

SEP 8 1975

30-015-21626

Form C-101
Revised 1-1-65

5A. Indicate Type of Lease	
STATE <input checked="" type="checkbox"/>	FEE <input type="checkbox"/>
5. State Oil & Gas Lease No. 647	

APPLICATION FOR PERMIT TO DRILL, DEEPEN, OR PLUG BACK

1a. Type of Work DRILL <input checked="" type="checkbox"/> DEEPEN <input type="checkbox"/> PLUG BACK <input type="checkbox"/>		7. Unit Agreement Name
b. Type of Well OIL WELL <input checked="" type="checkbox"/> GAS WELL <input type="checkbox"/> OTHER <input type="checkbox"/>		8. Farm or Lease Name Empire Abo Unit "J"
2. Name of Operator Atlantic Richfield Company		9. Well No. 231
3. Address of Operator P. O. Box 1710, Hobbs, New Mexico 88240		10. Field and Pool, or Wildcat Empire Abo
4. Location of Well UNIT LETTER G LOCATED 1361 FEET FROM THE North LINE AND 2531 FEET FROM THE East LINE OF SEC. 6 TWP. 18S RGE. 28E NMPM		12. County Eddy
19. Proposed Depth 6380'		19A. Formation Abo
20. Rotary or C.T. Rotary		
21. Elevations (Show whether DF, RT, etc.) 3654.4' GL	21A. Kind & Status Plug. Bond GCA #8	22. Approx. Date Work will start 10/15/75

PROPOSED CASING AND CEMENT PROGRAM

SIZE OF HOLE	SIZE OF CASING	WEIGHT PER FOOT	SETTING DEPTH	SACKS OF CEMENT	EST. TOP
11"	8-5/8" OD	24#	1000'	375	Circ
7-7/8"	5-1/2" OD	14#	6380'	1075	Circ

Propose to drill an oilwell to develop the Abo Reef formation within the Empire Abo Unit boundaries in order to decrease gas voidage and maintain oil production.

Unorthodox well location approved by Administrative Order NSL-719 under the provisions of Rule 14 of Order No. R-4549B. BOP to be installed as per attached diagram.

APPROVAL VALID
FOR 90 DAYS UNLESS
DRILLING COMMENCED,

EXPIRES 12-11-75

IN ABOVE SPACE DESCRIBE PROPOSED PROGRAM: IF PROPOSAL IS TO DEEPEN OR PLUG BACK, GIVE DATA ON PRESENT PRODUCTIVE ZONE AND PROPOSED NEW PRODUCTIVE ZONE. GIVE BLOWOUT PREVENTER PROGRAM, IF ANY.

I hereby certify that the information above is true and complete to the best of my knowledge and belief.

Signed [Signature] Title Dist. Drlg. Supv. Date 9/3/75

(This space for State Use)

APPROVED BY W. A. Gressett TITLE SUPERVISOR, DISTRICT II DATE SEP 11 1975

CONDITIONS OF APPROVAL, IF ANY:

NEW MEXICO OIL CONSERVATION COMMISSION
WELL LOCATION AND ACREAGE DEDICATION PLAT

Form C-102
Supersedes C-128
Effective 1-1-65

All distances must be from the outer boundaries of the Section

Owner Atlantic Richfield Company			Lease Empire Abo Unit J		Well No. 231
Section G	Section 6	Township 18 South	Range 28 East	County Eddy	
Approximate Location of Well:					
1361 feet from the North line and		2531 feet from the East line			
Ground Level 3654.4	Producing Formation Abo		Pool Empire		Dedicated Acreage: 40 Acres

- Outline the acreage dedicated to the subject well by colored pencil or hachure marks on the plat below.
- If more than one lease is dedicated to the well, outline each and identify the ownership thereof (both as to working interest and royalty).
- If more than one lease of different ownership is dedicated to the well, have the interests of all owners been consolidated by communitization, unitization, force-pooling, etc?

RECEIVED

SEP 8 1975

☒ Yes ☐ No If answer is "yes," type of consolidation **Unitization** **O. C. C. ARTESIA, OFFICE**

If answer is "no," list the owners and tract descriptions which have actually been consolidated. (Use reverse side of this form if necessary.)

No allowable will be assigned to the well until all interests have been consolidated (by communitization, unitization, forced-pooling, or otherwise) or until a non-standard unit, eliminating such interests, has been approved by the Commission.

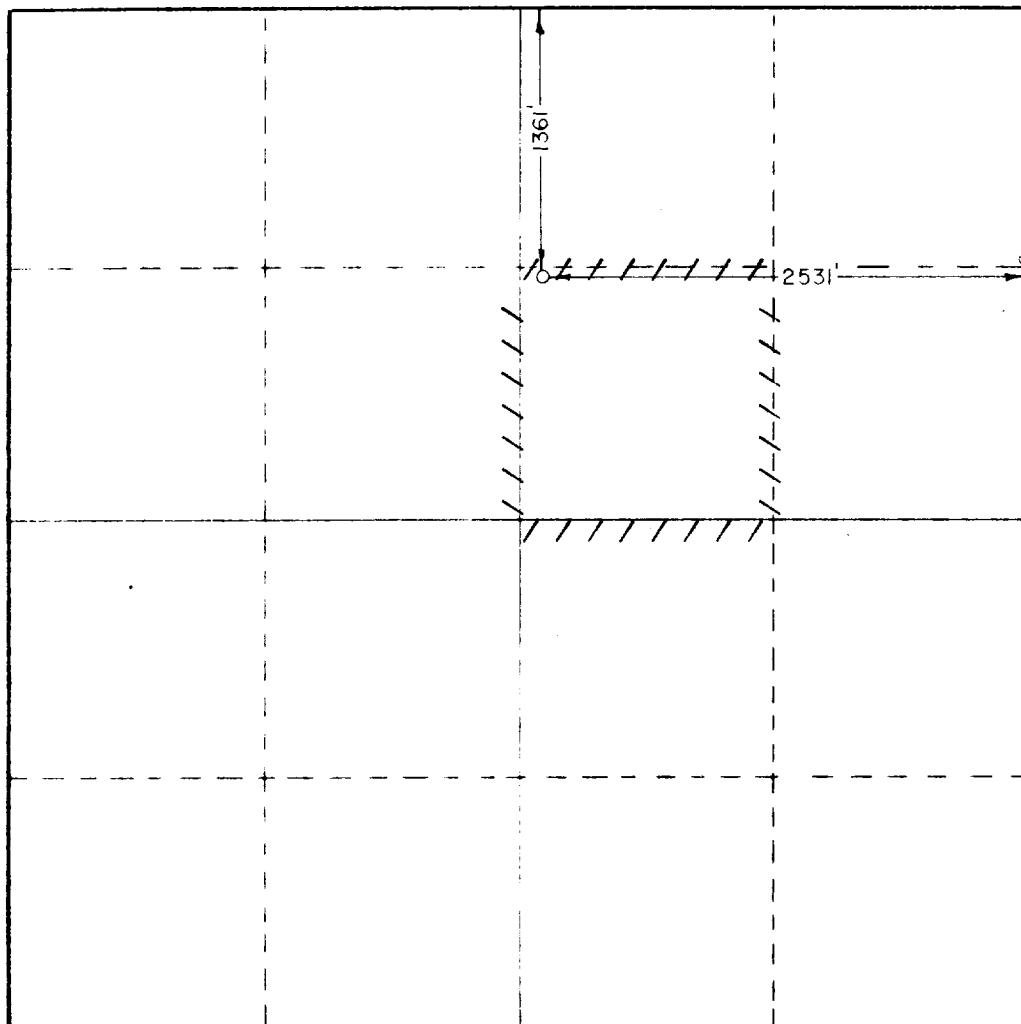

CERTIFICATION

I hereby certify that the information contained herein is true and complete to the best of my knowledge and belief.

Name [Signature]
Position [Signature]
Dist. Dir. Supv.
Company **Atlantic Richfield Company**
Date **9/5/75**

I hereby certify that the well location shown on this plat was plotted from field notes of actual surveys made by me or under my supervision, and that the same is true and correct to the best of my knowledge and belief.

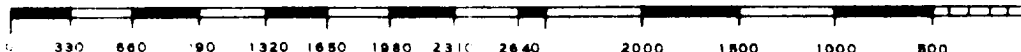
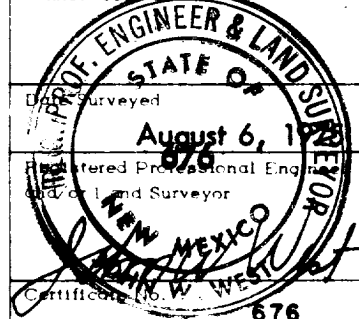

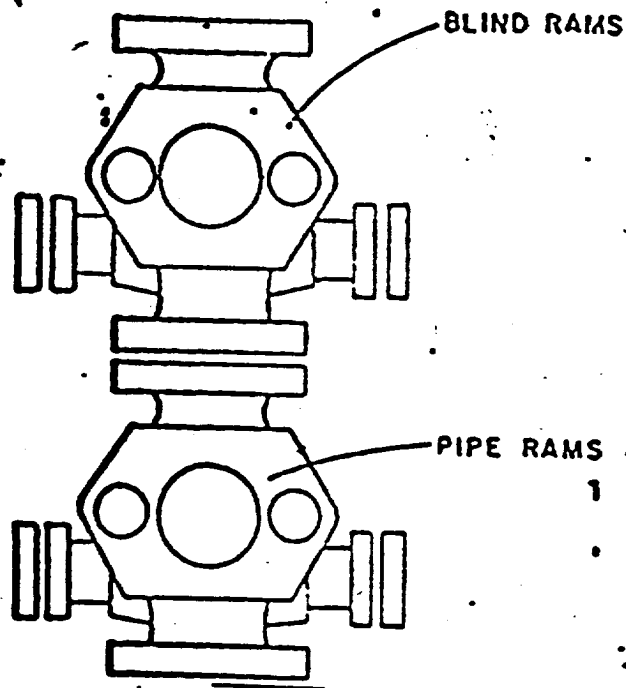

ATLANTIC RICHFIELD COMPANY
Blow Out Preventer Program

Lease Name Empire Abo Unit "J"

Well No. 231

Location 1361' FNL & 2531' FEL
Sec 6, T18S, R28E, Eddy Co.

BOP to be tested before installed on well and will be maintained in good working condition during workover. All wellhead fittings to be of sufficient pressure to operate in a safe manner.