

NO. OF COPIES RECEIVED	6
DISTRIBUTION	
SANTA FE	
FILE	
U.S.G.S.	
LAND OFFICE	
OPERATOR	

NEW MEXICO OIL CONSERVATION COMMISSION

RECEIVED

FEB 16 1976

30-015-21737

Form C-101
Revised 1-1-65

A. Indicate Type of Lease	
STATE <input checked="" type="checkbox"/>	FEE <input type="checkbox"/>
5. State Oil & Gas Lease No.	
647	
7. Unit Agreement Name	
8. Farm or Lease Name	
Empire Abo Unit "J"	
9. Well No.	
232	
10. Field and Pool, or Wildcat	
Empire Abo	
12. County	
Eddy	
19. Proposed Depth	19A. Formation
6375'	Abo Reef
20. Rotary or C.T.	
Rotary	
21. Elevations (Show whether DF, RT, etc.)	21A. Kind & Status Plug. Bond
3665.9' GR	GCA #8
21B. Drilling Contractor	
Not selected	
22. Approx. Date Work will start	
3/1/76	

1a. Type of Work	
b. Type of Well	
DRILL <input checked="" type="checkbox"/>	DEEPEN <input type="checkbox"/>
OIL WELL <input checked="" type="checkbox"/>	GAS WELL <input type="checkbox"/>
2. Name of Operator	
Atlantic Richfield Company	
3. Address of Operator	
P. O. Box 1710, Hobbs, New Mexico 88240	
4. Location of Well	
UNIT LETTER G	LOCATED 1576 FEET FROM THE East LINE
AND 2253 FEET FROM THE North	LINE OF SEC. 6 TWP. 18S RGE. 28E NMPM
5. Proposed Depth	
6375'	
6. Formation	
Abo Reef	
7. Rotary or C.T.	
Rotary	
8. Elevations (Show whether DF, RT, etc.)	
3665.9' GR	
9. Kind & Status Plug. Bond	
GCA #8	
10. Drilling Contractor	
Not selected	
11. Approx. Date Work will start	
3/1/76	

23.

PROPOSED CASING AND CEMENT PROGRAM

SIZE OF HOLE	SIZE OF CASING	WEIGHT PER FOOT	SETTING DEPTH	SACKS OF CEMENT	EST. TOP
11"	8-5/8" OD	24# K-55	550'	500	Circ to surf
7-7/8"	5-1/2" OD	14 & 15.5# K55	6375'	1100	Circ to surf

Propose to drill a producing oilwell in the Empire Abo Unit to complete a more efficient producing pattern, to conserve energy, promote the greatest ultimate recovery of reserves, prevent waste & protect correlative rights. Proposed non-standard well location to meet all requirements of Order No. 4549-B, Rule 14, NSL 743.

See blowout preventer program attached.

APPROVAL VALID
FOR 90 DAYS UNLESS
DRILLING COMMENCED,

EXPIRES 5-17-76

IN ABOVE SPACE DESCRIBE PROPOSED PROGRAM: IF PROPOSAL IS TO DEEPEN OR PLUG BACK, GIVE DATA ON PRESENT PRODUCTIVE ZONE AND PROPOSED NEW PRODUCTIVE ZONE. GIVE BLOWOUT PREVENTER PROGRAM, IF ANY.

I hereby certify that the information above is true and complete to the best of my knowledge and belief.

Signed Le Roy Pratt Title Dist. Drlg. Supv. Date 2/13/76

(This space for State Use)

APPROVED BY W. A. Gressett TITLE SUPERVISOR, DISTRICT II DATE FEB 17 1976

CONDITIONS OF APPROVAL, IF ANY:

N MEXICO OIL CONSERVATION COMMISS
WELL LOCATION AND ACREAGE DEDICATION PLAT

Form C-102
 Supersedes C-128
 Effective 1-1-65

All distances must be from the outer boundaries of the Section

Operator Atlantic Richfield Company			Lease Empire Abo Unit J		Well No. 232
Grid Letter G	Section 6	Township 18 South	Range 28 East	County Eddy	
Actual Footage Location of Well: 1576 feet from the East line and 2253 feet from the North line					
Ground Level Elev. 3665.9	Producing Formation Abo Reef		Pool Empire Abo	Total Acreage 40	

1. Outline the acreage dedicated to the subject well by colored pencil or hatchure marks on the plat below.
2. If more than one lease is dedicated to the well, outline each and identify the ownership thereof (both as to working interest and royalty).
3. If more than one lease of different ownership is dedicated to the well, have the interests of all owners been consolidated by communitization, unitization, force-pooling, etc?

☒ Yes ☐ No If answer is "yes," type of consolidation **Unitization**

If answer is "no," list the owners and tract descriptions which have actually been consolidated (Use reverse side of this form if necessary.) _____

No allowable will be assigned to the well until all interests have been consolidated (by communitization, unitization, forced-pooling, or otherwise) or until a non-standard unit, eliminating such interests, has been approved by the Commission.

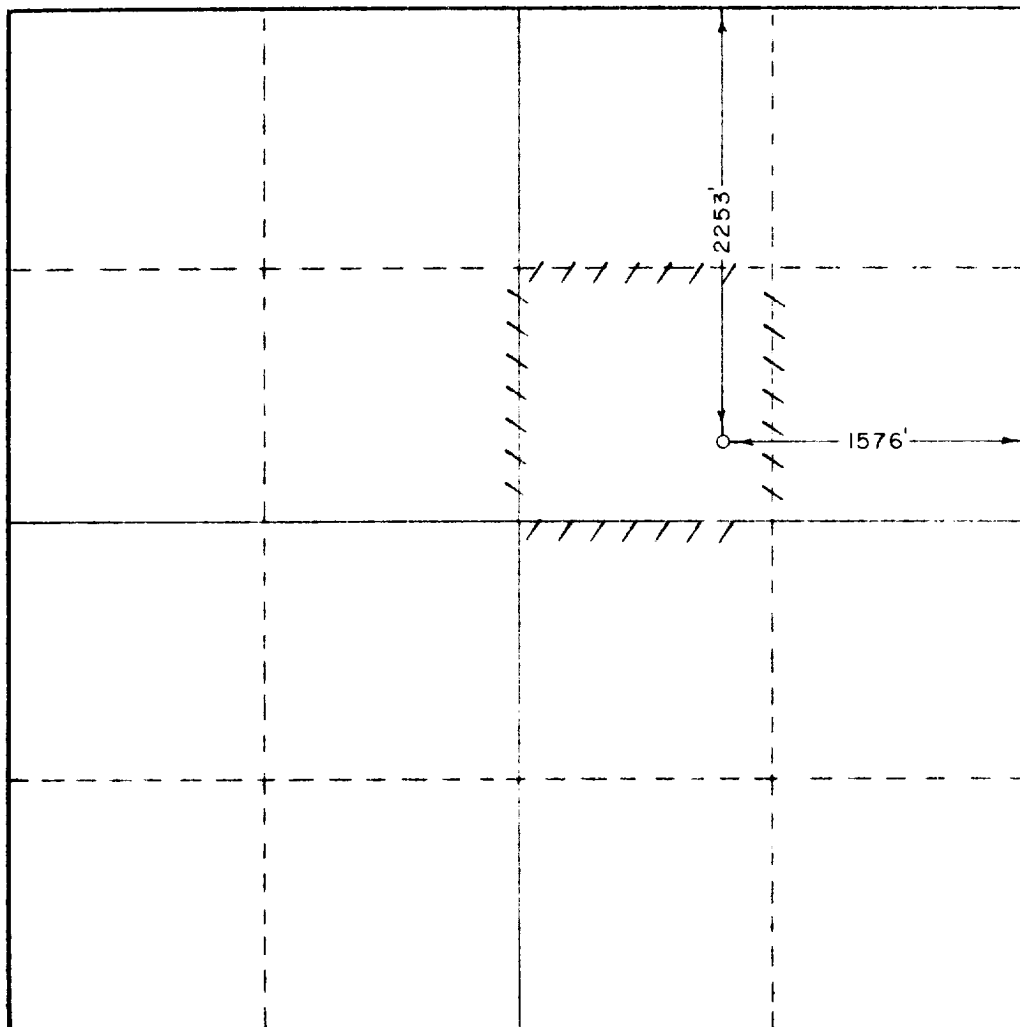

CERTIFICATION

I hereby certify that the information contained herein is true and complete to the best of my knowledge and belief.

Name *Shoy Knott*
 Position _____
 Dist. Drlg. Supv. _____
 Company **Atlantic Richfield Company**
 Date **2/13/76**

I hereby certify that the well location shown on this plat was plotted from field notes of actual surveys made by me or under my supervision, and that the same is true and correct to the best of my knowledge.

Registered Professional Engineer
 State of New Mexico
 November 19, 1975
Shoy Knott
 Certificate No. _____



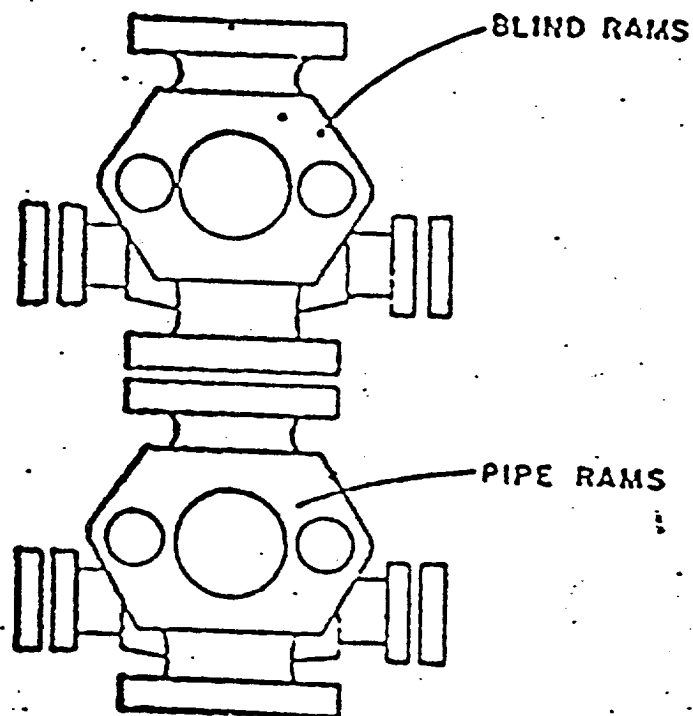

ATLANTIC RICHFIELD COMPANY
Blow Out Preventer Program

Lease Name Empire Abo Unit "J"

Well No. 232

Location 1576' FEL & 2253' FNL
Sec 6-T18S-R28E, Eddy Co.

BOP to be tested before installed on well and will be maintained in good working condition during drilling. All wellhead fittings to be of sufficient pressure to operate in a safe manner.