

Sec. 30, 1-185, H-KYE

Eddy County

Existi. Road - To Highway "3E" 2 miles

- 1 - Existing Roads - See Sketch
- 2 - Planned Access Road - See Sketch
- 3 - Location of Well - See Sketch
- 4 - No Lateral Roads at this time
- 5 - No Battery at this time
- 6 - Water Supply -- To be Hauled
- 7 - Waste Containers for Accumulation of Waste
Will be buried and covered up.
- 8 - No Camp Location
- 9 - No Airstrips
- 10 - Location Lay Out, etc. -- See Sketch
- 11 - Pits dried out, location clean up, and to
be re-stored to natural state as near as
possible
- 12 - Salt Water Base Gel to be used, with
10-3/4" Series 900 Shaffer Blow Out
Preventor for drilling operations.
3,000 lb. working press. - 6,000 lb. test.

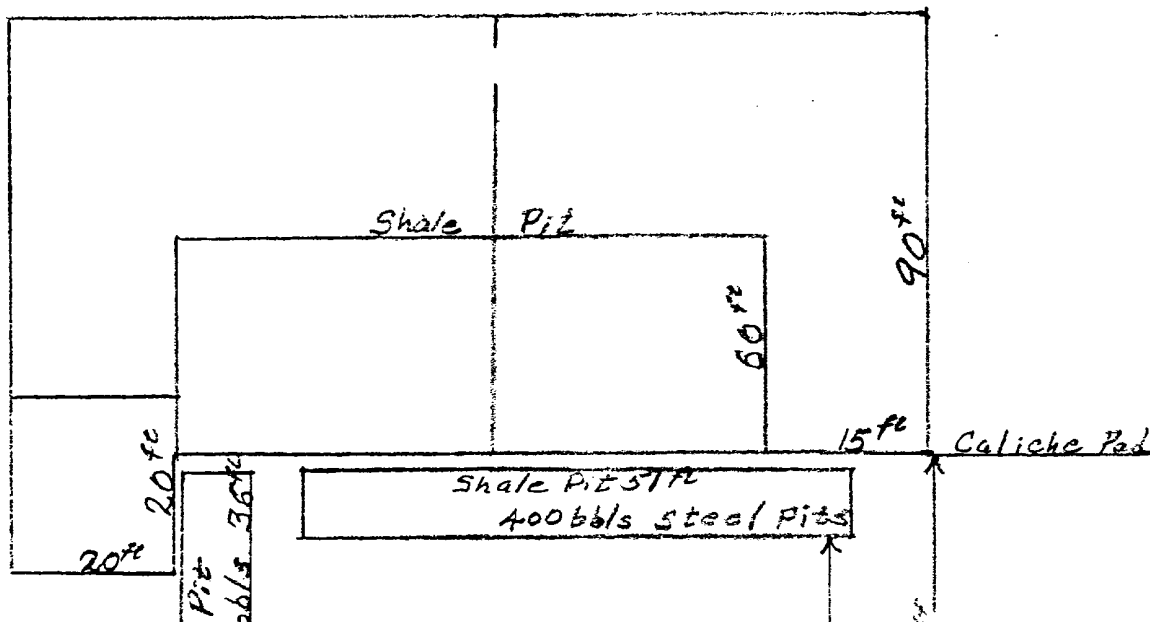

Sec. 30, T-18S, R-29E

Eddy County

Exist. Road - To Highway "3E" 2 miles

- 1 - Existing Roads - See Sketch
- 2 - Planned Access Road - See Sketch
- 3 - Location of Well - See Sketch
- 4 - No Lateral Roads at this time
- 5 - No Battery at this time
- 6 - Water Supply -- To be Hauled
- 7 - Waste Containers for Accumulation of Waste
Will be buried and covered up.
- 8 - No Camp Location
- 9 - No Airstrips
- 10 - Location Lay Out, etc. -- See Sketch
- 11 - Pits dried out, location clean up, and to
be re-stored to natural state as near as
possible
- 12 - Salt Water Base Gel to be used, with
10-3/4" Series 900 Shaffer Blow Out
Preventor for drilling operations.
3,000 lb. working press. - 6,000 lb. test.

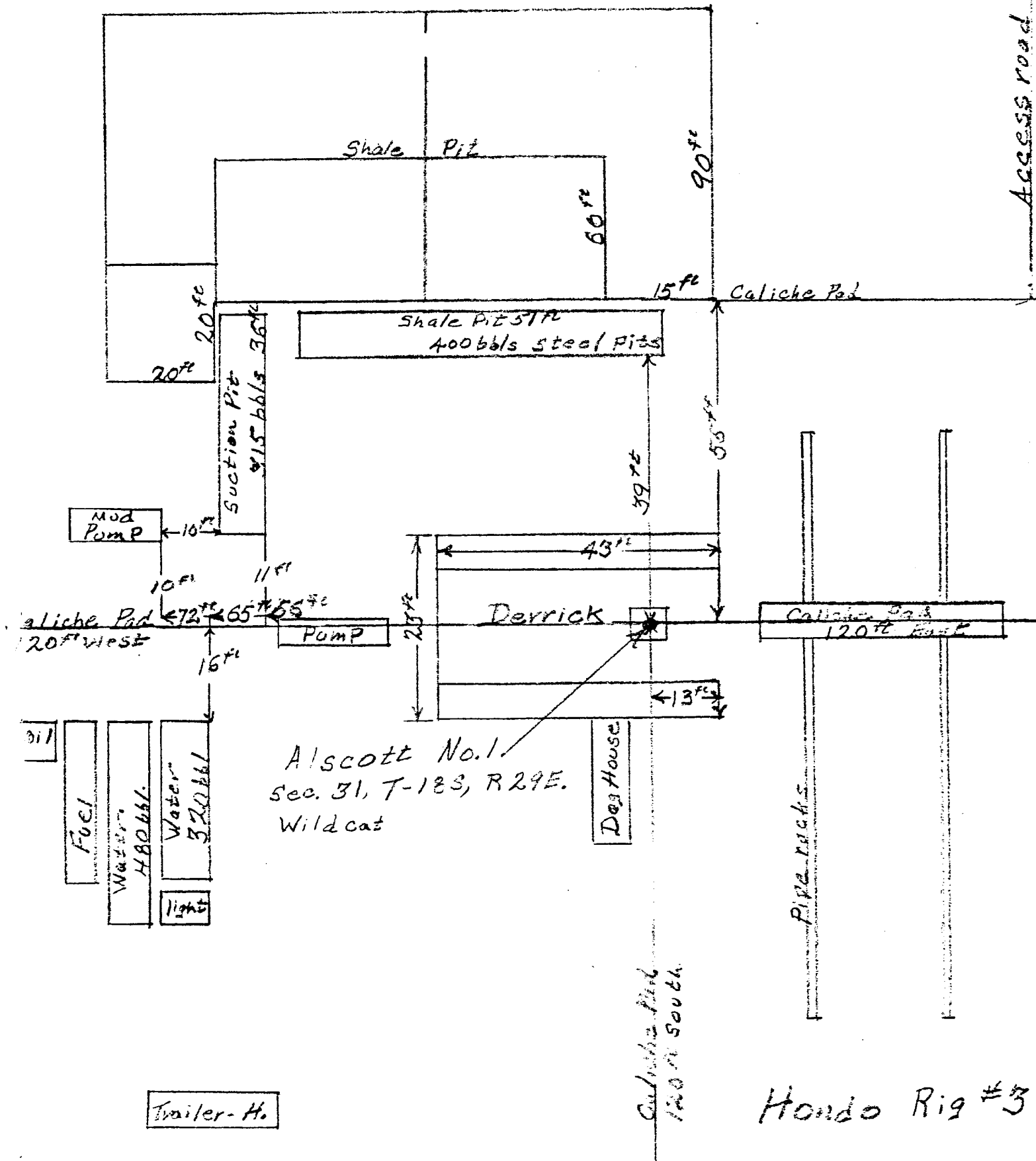

Hondo Rig #3