

NO. OF COPIES RECEIVED	
DISTRIBUTION	
SANTA FE	
FILE	
U.S.G.S.	
LAND OFFICE	
OPERATOR	

NEW MEXICO OIL CONSERVATION COMMISSION

RECEIVED

AUG 19 1976

AUG 25 1976

30-015-21894

Form C-101
Revised 1-1-65

5A. Indicate Type of Lease
STATE ☐ FEE ☒

5. State Oil & Gas Lease No.

O. C. C.
ARTESIA, OFFICE

O. C. C.
ARTESIA, OFFICE

APPLICATION FOR PERMIT TO DRILL, DEEPEN, OR PLUG BACK

1a. Type of Work		7. Unit Agreement Name	
b. Type of Well DRILL <input checked="" type="checkbox"/> DEEPEN <input type="checkbox"/> PLUG BACK <input type="checkbox"/> OIL WELL <input checked="" type="checkbox"/> GAS WELL <input type="checkbox"/> OTHER <input type="checkbox"/> SINGLE ZONE <input checked="" type="checkbox"/> MULTIPLE ZONE <input type="checkbox"/>		8. Farm or Lease Name E. C. Higgins Estate	
2. Name of Operator Gulf Oil Corporation		9. Well No. 1	
3. Address of Operator Box 670, Hobbs, New Mexico 88240		10. Field and Pool, or Wildcat Atoka San Andres	
4. Location of Well UNIT LETTER G LOCATED 1650 FEET FROM THE North LINE AND 2310 FEET FROM THE East LINE OF SEC. 28 TWP. 18-S RGE. 26-E NMPM		12. County Eddy	
19. Proposed Depth 1800'		19A. Formation San Andres	
20. Rotary or C.T. Rotary		21. Elevations (Show whether DF, RT, etc.) 3393' GL	
21A. Kind & Status Plug. Bond Blanket		21B. Drilling Contractor	
22. Approx. Date Work will start September 1, 1976			

PROPOSED CASING AND CEMENT PROGRAM

SIZE OF HOLE	SIZE OF CASING	WEIGHT PER FOOT	SETTING DEPTH	SACKS OF CEMENT	EST. TOP
17-1/2"	10-3/4"	40.50#	375'	Circulate	
9-7/8"	7-5/8"	26.4 & 29.7#	1200'	Circulate	
6-1/2"	4-1/2"	9.50#	1800'	Circulate	

BOP: See Drawing No. 1 attached.

APPROVAL VALID
FOR 90 DAYS UNLESS
DRILLING COMMENCED,

EXPIRES 11-26-76

IN ABOVE SPACE DESCRIBE PROPOSED PROGRAM: IF PROPOSAL IS TO DEEPEN OR PLUG BACK, GIVE DATA ON PRESENT PRODUCTIVE ZONE AND PROPOSED NEW PRODUCTIVE ZONE. GIVE BLOWOUT PREVENTER PROGRAM, IF ANY.

I hereby certify that the information above is true and complete to the best of my knowledge and belief.

Signed D. F. Berlin Title Area Engineer Date August 18, 1976

(This space for State Use)

APPROVED BY W. A. Gressett TITLE SUPERVISOR, DISTRICT II DATE AUG 26 1976

CONDITIONS OF APPROVAL, IF ANY:

Cement must be circulated to
surface behind 10 7/8" & 7 7/8" casing

Notify N.M.O.C.C. in sufficient
time to witness cementing
the 7 5/8" casing

NEW MEXICO OIL CONSERVATION COMMISSION
WELL LOCATION AND ACREAGE DEDICATION PLAT

Form O-128
Supersedes O-128
Effective 1-1-65

All distances must be from the outer boundaries of the Section

Operator GULF OIL CORP.		Lease E. C. Higgins, Estate		Well No. 1
Tract Letter G	Section 28	Township 18 South	Range 26 East	County Eddy
Actual Footage Location of Well: 2310 feet from the east line and 1650 feet from the north line				
Ground Level Elev. 3392.7	Producing Formation San Andres	Pool Name Atoka (SA)	Dedicated Acreage 40 Acres	

1. Outline the acreage dedicated to the subject well by colored pencil or hachure marks on the plat below.
2. If more than one lease is dedicated to the well, outline each and identify the ownership thereof (both as to working interest and royalty).
3. If more than one lease of different ownership is dedicated to the well, have the interests of all owners been consolidated by communitization, unitization, force-pooling, etc?

RECEIVED

AUG 19 1976

☐ Yes ☐ No If answer is "yes," type of consolidation _____

O. C. C.

ARTESIA, OFFICE

If answer is "no," list the owners and tract descriptions which have actually been consolidated. (Use reverse side of this form if necessary.) _____

No allowable will be assigned to the well until all interests have been consolidated (by communitization, unitization, forced-pooling, or otherwise) or until a non-standard unit, eliminating such interests, has been approved by the Commission.

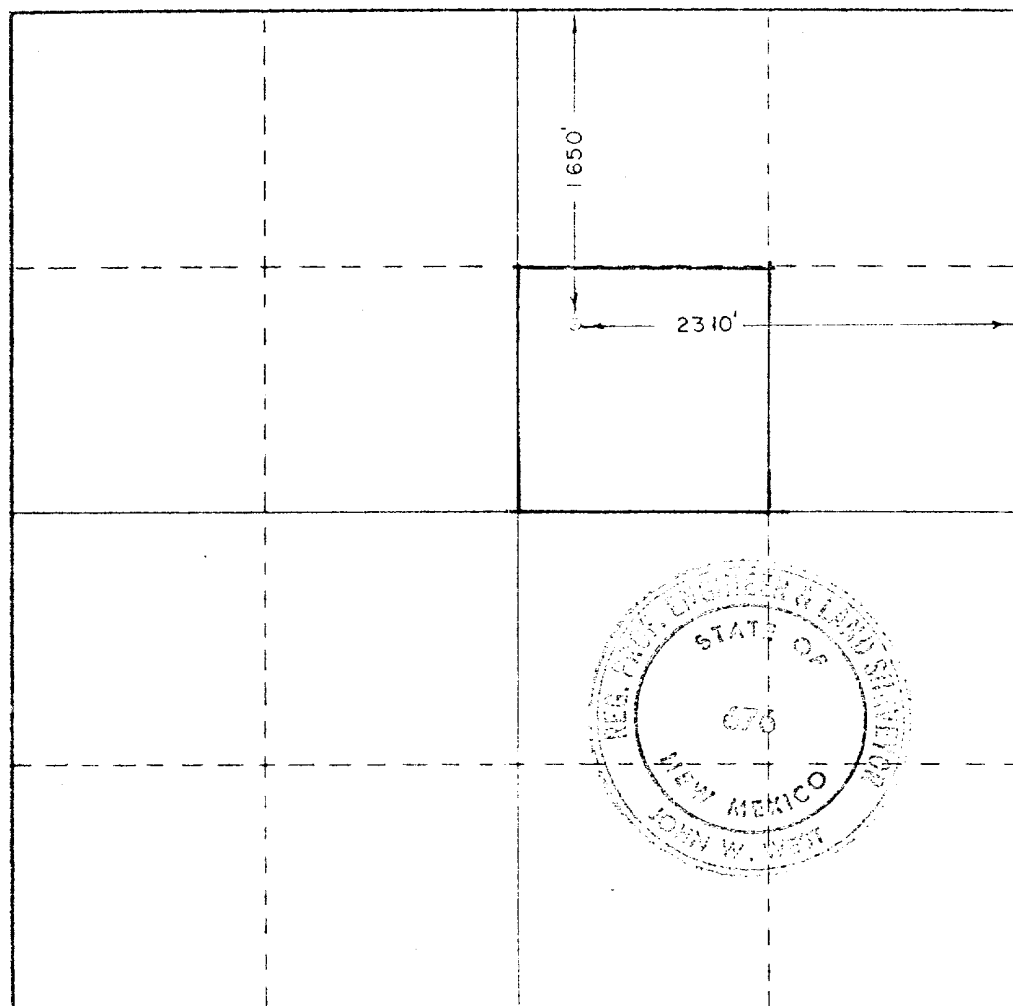

CERTIFICATION

I hereby certify that the information contained herein is true and complete to the best of my knowledge and belief.

D. T. Berlin

Name

D. T. BERLIN

Position

Area Engineer

Company

Gulf Oil Corporation

Date

August 18, 1976

I hereby certify that the well location shown on this plat was plotted from field notes of actual surveys made by me or under my supervision, and that the same is true and correct to the best of my knowledge and belief.

Date Surveyed

August 12, 1976

Registered Professional Engineer and Land Surveyor

John W. West

Certificate No.

676

0 330 660 990 1320 1650 1980 2310 2640 2000 1500 1000 500 0

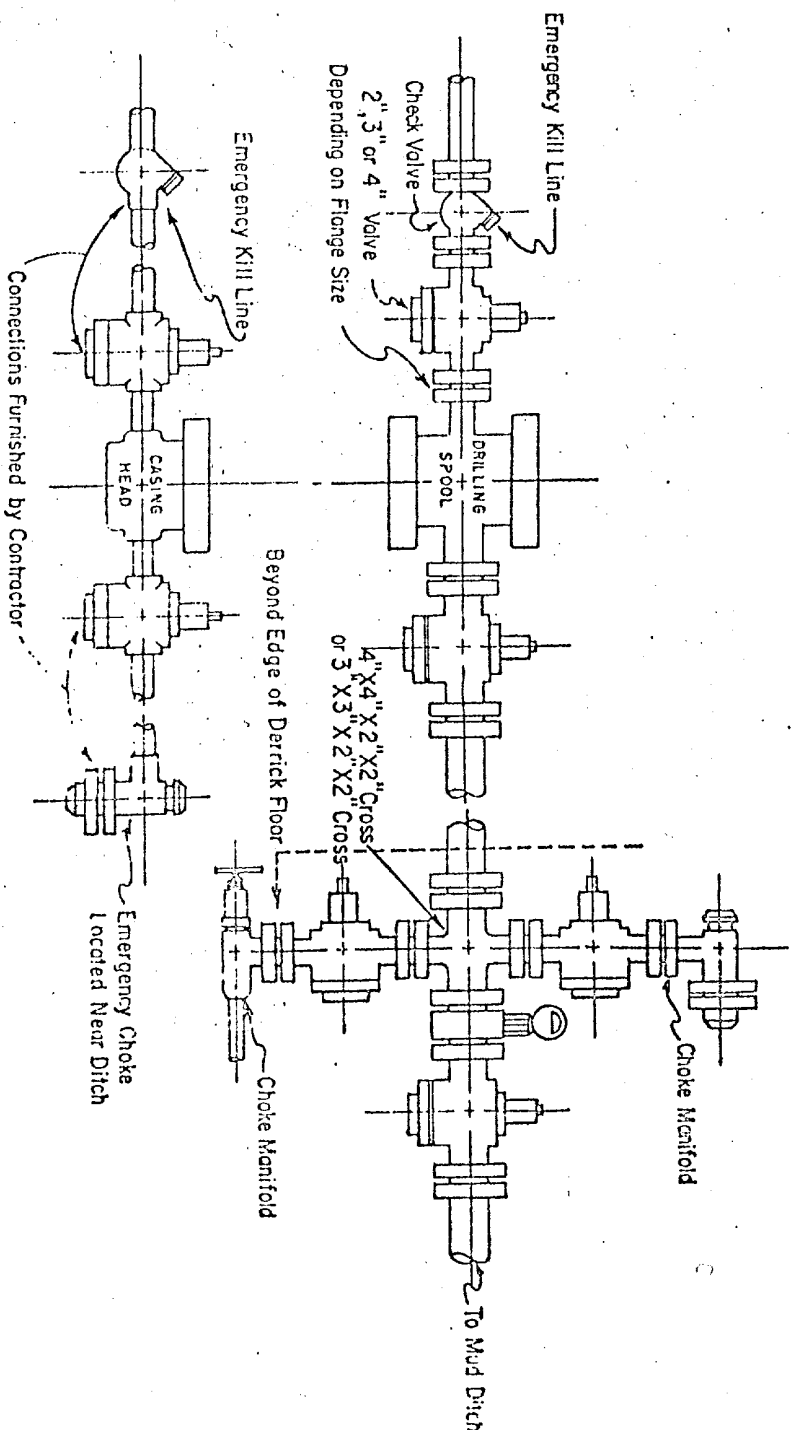
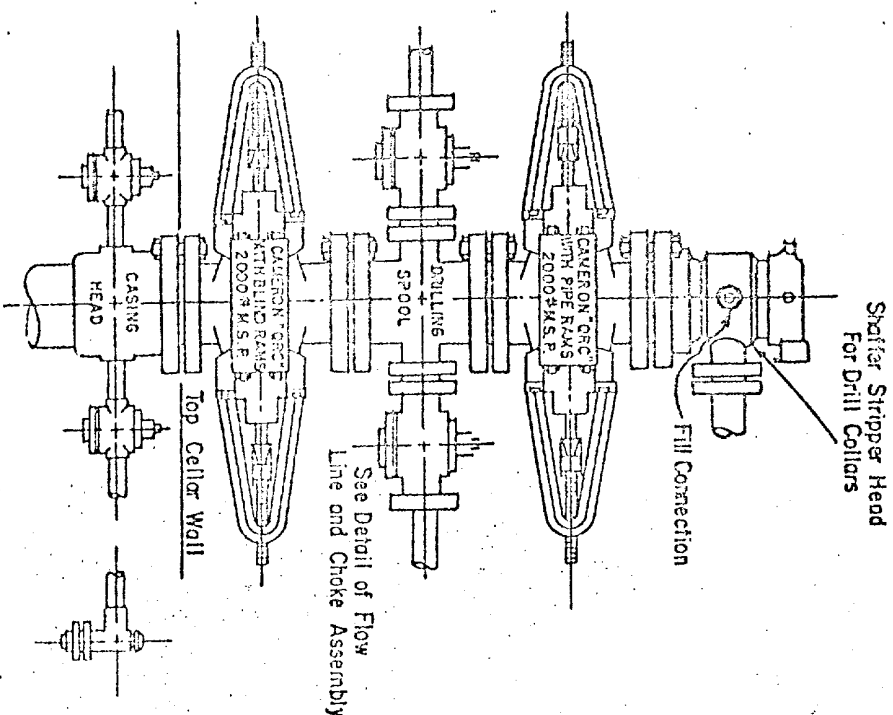

2,000 PSI WORKING PRESSURE
KILL, CHOKES, AND FILL CONNECTIONS
API Series 600 Flanges or Better

DETAIL OF FLOW LINE CHOKES ASSEMBLY

2,000 PSI WORKING PRESSURE
BLOWOUT PREVENTER HOOK-UP

Series 600 Flanges, or Better

Minimum assembly for 2000 PSI working pressure will consist of two preventers which may be Cameron QRC, Cameron Type F, single or double, Cameron Space-Saver or Shafter hydraulic, single or double. If double preventers are provided, the drilling spool shall be placed below the preventers and the blind rams placed in the upper preventer. With this arrangement the kill and choke lines to Gulf's housing will not be required. In lieu of the drilling spool, the flanged outlets of the double Shafter, the Space-Saver or double F, if they are the correct size, and provided the preventers can be installed to meet Gulf's requirements, may be used for the three or four-inch flow line and the two-inch kill line.

Size 10-inch preventers may be used for work down through 7-inch and 5-1/2 inch casings. Minimum operating equipment for the preventers will be: (1) An air operated pump and (2) A Baker hydraulic hand pump. The closing manifold will have a separate four-way valve for each pressure operated device. Gulf No. 561 hydraulic oil shall be used as the operating fluid.

The flow line from the preventers shall be supported by a metal stand or reinforced concrete. All valves throughout the assembly shall be selected for operation in both gas and fluids. Sufficient substructure height is to be provided in the event Gulf should request installation of a rotating type blowout preventer. The preventers will be provided with stem extensions, universal joints, if needed, and operating wheels.



OIL CONSERVATION COMMISSION

STATE OF NEW MEXICO
P. O. DRAWER DD - ARTESIA
88210



STATE GEOLOGIST
EMERY C. ARNOLD

DIRECTOR
JOE D. RAMEY

LAND COMMISSIONER
PHIL R. LUCERO

August 23, 1976

Gulf Oil Corporation
Box 670
Hobbs, NM

Re: E.C.Higgins Estate
#1-G, 28-18-26, Eddy
New Mexico

Gentlemen:

We are returning the enclosed Forms C-101 on the subject well for corrections.

The hole size for the water protection string (7 5/8") must be at least 2" larger than the casing.

If you have any questions concerning this matter please feel free to call me.

Sincerely yours,

OIL CONSERVATION COMMISSION

A handwritten signature in cursive script that reads "W. A. Gressett".

W. A. Gressett
Supervisor, District II

WAG:jw
Enclosure

NO. OF COPIES RECEIVED	
DISTRIBUTION	
SANTA FE	
FILE	
U.S.G.S.	
LAND OFFICE	
OPERATOR	

NEW MEXICO CONSERVATION COMMISSION

AUG 19 1976

O. C. C.
ARTESIA, OFFICE

Form C-101
Revised 1-1-65

5A. Indicate Type of Lease	
STATE <input type="checkbox"/>	FEE <input checked="" type="checkbox"/>

5. State Oil & Gas Lease No.

APPLICATION FOR PERMIT TO DRILL, DEEPEN, OR PLUG BACK

1a. Type of Work		7. Unit Agreement Name	
b. Type of Well DRILL <input checked="" type="checkbox"/> DEEPEN <input type="checkbox"/> PLUG BACK <input type="checkbox"/>		8. Farm or Lease Name	
OIL WELL <input checked="" type="checkbox"/> GAS WELL <input type="checkbox"/> OTHER <input type="checkbox"/> SINGLE ZONE <input checked="" type="checkbox"/> MULTIPLE ZONE <input type="checkbox"/>		E. C. Higgins Estate	
2. Name of Operator		9. Well No.	
Gulf Oil Corporation		1	
3. Address of Operator		10. Field and Pool, or Wildcat	
Box 670, Hobbs, New Mexico 88240		Atoka San Andres	
4. Location of Well		12. County	
UNIT LETTER G LOCATED 1650 FEET FROM THE North LINE		Eddy	
AND 2310 FEET FROM THE East LINE OF SEC. 28 TWP. 18-S RGE. 26-E NMPM			
19. Proposed Depth		19A. Formation	20. Rotary or C.T.
1800'		San Andres	Rotary
21. Elevations (Show whether DF, RT, etc.)	21A. Kind & Status Plug. Bond	21B. Drilling Contractor	22. Approx. Date Work will start
3393' GL	Blanket		September 1, 1976

PROPOSED CASING AND CEMENT PROGRAM

SIZE OF HOLE	SIZE OF CASING	WEIGHT PER FOOT	SETTING DEPTH	SACKS OF CEMENT	EST. TOP
17-1/2"	10-3/4"	40.50#	375'	Circulate	
9-1/2"	7-5/8"	26.4 & 29.7#	1200'	Circulate	
6-1/2"	4-1/2"	9.50#	1800'	Circulate	

BOP: See Drawing No. 1 attached.

IN ABOVE SPACE DESCRIBE PROPOSED PROGRAM: IF PROPOSAL IS TO DEEPEN OR PLUG BACK, GIVE DATA ON PRESENT PRODUCTIVE ZONE AND PROPOSED NEW PRODUCTIVE ZONE, GIVE BLOWOUT PREVENTER PROGRAM, IF ANY.

I hereby certify that the information above is true and complete to the best of my knowledge and belief.

Signed D. F. Berlin Title Area Engineer Date August 18, 1976
(This space for State Use)

APPROVED BY _____ TITLE _____ DATE _____

CONDITIONS OF APPROVAL, IF ANY: