

UNITED STATES
DEPARTMENT OF THE INTERIOR
GEOLOGICAL SURVEY30-015-21911
5. LEASE DESIGNATION AND SERIAL NO.

NM-01375A

6. IF INDIAN, ALLOTTEE OR TRIBE NAME

7. UNIT AGREEMENT NAME

8. FARM OR LEASE NAME

Lanning

9. WELL NO.

#4

10. FIELD AND POOL, OR WILDCAT

X Shugart - Yates

11. SEC., T., R., M., OR BLK.

AND SURVEY OR AREA
25-18S-30E

12. COUNTY OR PARISH

Eddy

13. STATE

New Mexico

APPLICATION FOR PERMIT TO DRILL, DEEPEN, OR PLUG BACK

1a. TYPE OF WORK

DRILL ☒DEEPEN ☐PLUG BACK ☐

b. TYPE OF WELL

OIL
WELL ☒GAS
WELL ☐OTHER ☐SINGLE
ZONE ☐MULTIPLE
ZONE ☐

2. NAME OF OPERATOR

R.Q. Silverthorne

O. C. C.

ARTESIA, OFFICE

3. ADDRESS OF OPERATOR

P.O. Drawer #10, Plainview, Texas - #79072

4. LOCATION OF WELL (Report location clearly and in accordance with any State requirements.)*

At surface

500' from the south line, 330' from East Line 25-18S-30E

Eddy County, New Mexico

Grayburg

14. DISTANCE IN MILES AND DIRECTION FROM NEAREST TOWN OR POST OFFICE*

15. DISTANCE FROM PROPOSED*

LOCATION TO NEAREST
PROPERTY OR LEASE LINE, FT.
(Also to nearest drlg. unit line, if any)

16. NO. OF ACRES IN LEASE

17. NO. OF ACRES ASSIGNED

TO THIS WELL

40

18. DISTANCE FROM PROPOSED LOCATION*

TO NEAREST WELL, DRILLING, COMPLETED,
OR APPLIED FOR, ON THIS LEASE, FT.

19. PROPOSED DEPTH

3800'

20. ROTARY OR CABLE TOOLS

Rotary

21. ELEVATIONS (Show whether DF, RT, GR, etc.)

3558.2 Ground Level

22. APPROX. DATE WORK WILL START*

August 15th 1976

23.

PROPOSED CASING AND CEMENTING PROGRAM

SIZE OF HOLE	SIZE OF CASING	WEIGHT PER FOOT	SETTING DEPTH	QUANTITY OF CEMENT
11	8 5/8"	24	800'	200 sacks
7	5 1/2"	15	3800'	150 sacks

RECEIVED

JUL 27 1976

U. S. GEOLOGICAL SURVEY
ARTESIA, NEW MEXICO

IN ABOVE SPACE DESCRIBE PROPOSED PROGRAM: If proposal is to deepen or plug back, give data on present productive zone and proposed new productive zone. If proposal is to drill or deepen directionally, give pertinent data on subsurface locations and measured and true vertical depths. Give blowout preventer program, if any.

24.

SIGNED

TITLE

Operator

DATE July 20th 1976.

R.Q. Silverthorne

(This space for Federal or State office use)

PERMIT TO

SEP 3 1976

APPROVED BY BEEKMAN
CONDITIONS OF APPROVAL, IF ANY:

APPROVAL DATE

DATE

THIS APPROVAL IS RESCINDED IF OPERATIONS
ARE NOT COMMENCED WITHIN 3 MONTHS.
EXPIRES DEC 3 1976

*See Instructions On Reverse Side

**NEW MEXICO OIL CONSERVATION COMMISSION
WELL LOCATION AND ACREAGE DEDICATION PLAT**

Form C-107
Supersedes C-128
Effective 1-1-65

All distances must be from the outer boundaries of the Section

RECEIVED
JUL 27 1976

U.S. GEOLOGICAL SURVEY
ARTESIA, NEW MEXICO

Operator R. Q. SILVERTHORNE		Lease LANNING		No. 4	
Unit Letter "P"	Section 25	Township 18 South	Range 30 East	County Eddy	
Actual Location of Well: 500 feet from the South line and 330 feet from the East line					
Ground Level Elev. 3558.2	Producing Formation Grayburg	Pool Shugart - Yates	Dedicated Acreage: 4.0 Acres		

1. Outline the acreage dedicated to the subject well by colored pencil or hatchure marks on the plat below.
2. If more than one lease is dedicated to the well, outline each and identify the ownership thereof (both as to working interest and royalty).
3. If more than one lease of different ownership is dedicated to the well, have the interests of all owners been consolidated by communitization, unitization, force-pooling, etc?

☐ Yes ☐ No If answer is "yes," type of consolidation _____

If answer is "no," list the owners and tract descriptions which have actually been consolidated. (Use reverse side of this form if necessary.) _____

No allowable will be assigned to the well until all interests have been consolidated (by communitization, unitization, forced-pooling, or otherwise) or until a non-standard unit, eliminating such interests, has been approved by the Commission.

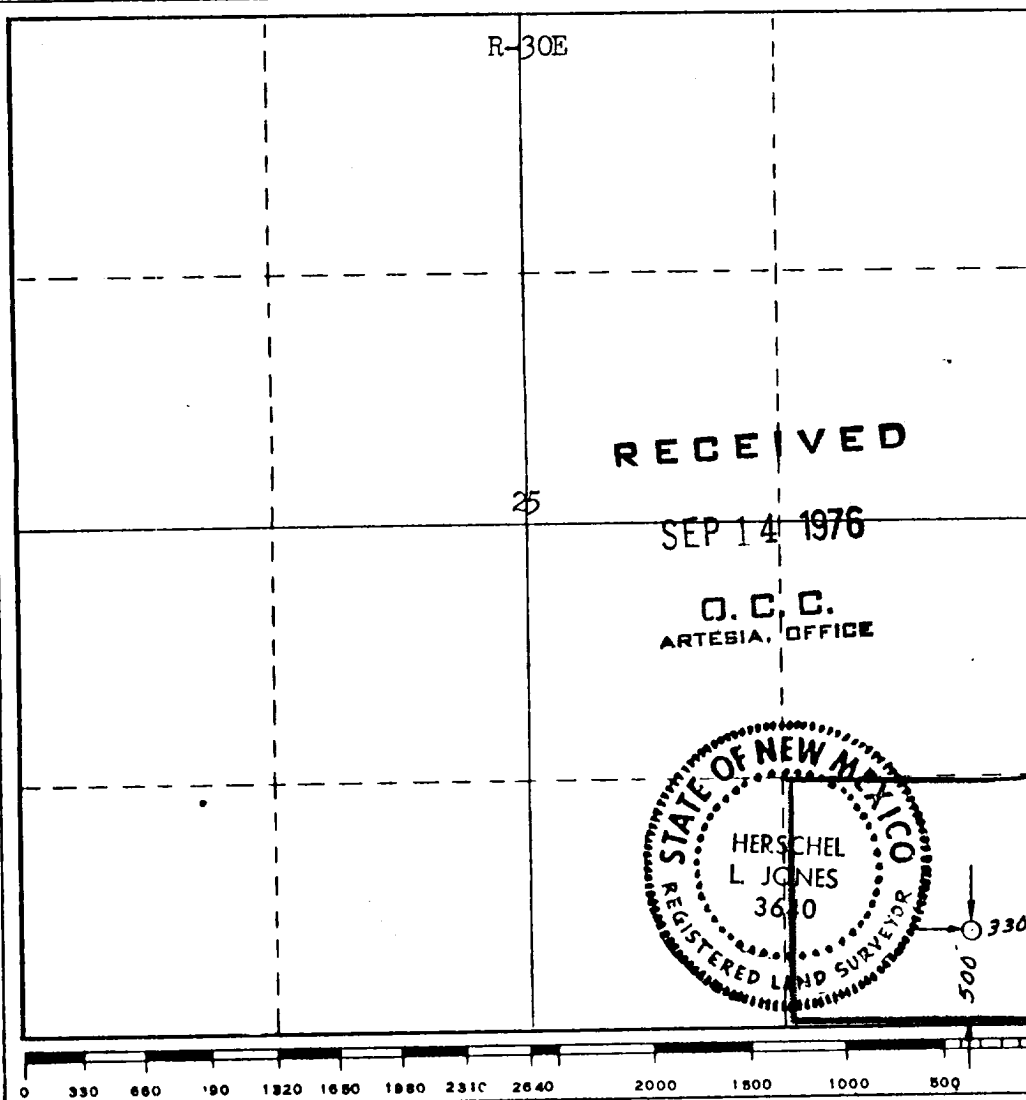

CERTIFICATION

I hereby certify that the information contained herein is true and complete to the best of my knowledge and belief.

Name *Nancy Ling*
Position Agent

Company
R. Q. Silverthorne

Date
July 27, 1976

I hereby certify that the well location shown on this plat was plotted from field notes of actual surveys made by me or under my supervision, and that the same is true and correct to the best of my knowledge and belief.

Date Surveyed
June 28, 1976

Registered Professional Engineer and/or Land Surveyor

Herschel L Jones
Certificate No. **3640**

SURFACE USE PLAN

R. Q. SILVERTHORNE, WELL NO. 4 LANNING
500' FSL & 330' FEL, Sec. 25, T. 18S, R. 30 E.
Lease NM 01375-A, Eddy County, N. Mex.

The proposed wellsite is approximately 8 miles southeast of Loco Hills, N. M. and can be reached by a dirt road which exits State Highway 31 about 6½ miles south of U.S. Highway 82 (see Exhibit "A"). The following information is submitted to describe the location and natural setting of the proposed wellsite, the surface disturbance involved, and the procedures to be followed in rehabilitating the surface after completion of the operation. A copy of this plan will be furnished to each of our contractors and subcontractors, and a copy will be posted at the wellsite during the drilling of the well.

1. EXISTING ROADS: Existing roads are shown on Exhibit "A", a portion of N.M. Quadrangle Road Map No. 107 of the State Highway Department, and on Exhibit "B" a large scale detailed plat of the Lanning Lease.

2. PROPOSED ROADS: No new roads will be required.

SURFACE MATERIAL: None will be used as no new roads are required.

CUT & FILL: None required.

CULVERTS: None required.

CATTLEGUARDS, GATES, ETC. None required.

3. EXISTING WELLS: Existing wells in the vicinity of the proposed wellsite are shown on Exhibit "C".

4. PRODUCTION, GATHERING, TREATING & STORAGE FACILITIES:

TANK BATTERY Location of battery site is shown on Exhibit "B". Battery consists of 3 210 bbl. tanks. If increased production requires enlargement of tank battery pad, an amended Surface Use Plan will be submitted for approval.

FLOW LINES: Location of existing flow lines is shown on Exhibit "B" with solid blue line. No new flow lines will be required

5. WATER SUPPLY: Drilling water will be hauled from water supply tank near State Highway 31.

6. SOURCE OF CONSTRUCTION MATERIALS: Caliche for surfacing the well pad will be purchased from the BLM from an existing pit in the NE $\frac{1}{4}$ SE $\frac{1}{4}$ Sec. 25, T. 18S, R. 30E.
7. METHODS OF HANDLING WASTE DISPOSAL:

DRILL CUTTINGS will be disposed of in the drilling pit.

DRILLING FLUIDS will be allowed to evaporate in the drilling pits until pits are dry.

WATER PRODUCED during tests will be disposed of in the drilling pits. Oil produced during tests will be stored in test tanks until sold.

TRASH CONTAINERS will be provided around the drilling rig during drilling and completion procedures. Trash, waste paper, garbage and junk will be buried in a separate trash pit and covered with a minimum of 24 inches of dirt, or removed from the wellsite within 30 days after finishing drilling and/or completion operations.
8. ANCILLARY FACILITIES: No camps, airstrips, etc. will be constructed.
9. WELLSITE LAYOUT: Exhibit "D" shows the dimensions and the relative locations of the well pad, mud pits, reserve pit, and trash pit with respect to the well.

MAT SIZE: 140' X 200'

CUT & FILL: Only minor levelling of the wellsite will be required. No significant cuts and fills will be necessary.

SURFACED: Will be topped with 6" of caliche, bladed, atered, and compacted.

RESERVE PIT: 80' X 150' pit lined with plastic.

CLEARED BUFFER AREA: No buffer area is to be cleared, however, area around well mat may be used for turn-a-round and/or storage.
10. PLANS FOR RESTORATION OF THE SURFACE After completion of drilling and/or completion operations all equipment and other material not needed for operations will be removed. Pits will be filled and location cleaned of all trash and junk to leave the wellsite in as aesthetically pleasing condition as possible. Any unguared pits containing fluids will be fenced until they are filled. After abandonment of the well, the well pad and all unneeded access roads will be ripped to promote revegetation. Rehabilitation should be accomplished within 90 days after abandonment.

11. OTHER INFORMATION:

TOPOGRAPHY: Land surface is undulating to gently rolling and dunny.
See Exhibit "E"

SOIL: Sandy rocky.

VEGETATION: The vegetative cover is generally sparse and consists of mesquite, yucca, shinnery oak, sandsage and perennial native range grasses.

WILDLIFE: Wildlife in the area is that typical of semi-arid desert land and includes coyotes, rabbits, rodents, reptiles, dove and quail.

PONDS & STREAMS: There are no rivers, streams, lakes or ponds in the area.

RESIDENCES & OTHER STRUCTURES: There are no occupied dwellings within ½ mile.

WATER WELLS There are no water wells within ½ miles.

ARCHEOLOGICAL SITES: None were observed in the area.

LAND USE: Grazing and some hunting.

SURFACE OWNERSHIP: Wellsite is on Federal surface

12. OPERATOR'S REPRESENTATIVES:

Garel Westall
P.O. Box 234
Loco Hills, New Mexico 88255
505-677-2421

Nancy King
P.O. Box 385
Artesia, New Mexico 88210
505-746-3451

13. CERTIFICATION:

I hereby certify that I, or persons under my direct supervision, have inspected the proposed drillsite and access route: that I am familiar with the conditions which presently exist: that the statements made in this plat are, to the best of my knowledge, true and correct; and, that the work associated with the operations proposed herein will be performed by R. Q. Silverthorne and his contractors and sub-contractors in conformity with this plan and the terms and conditions under which it is approved.

August 16, 1976

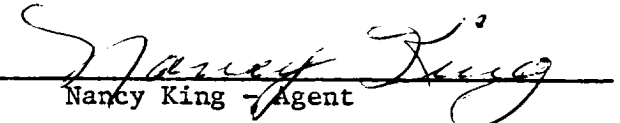
Nancy King - Agent

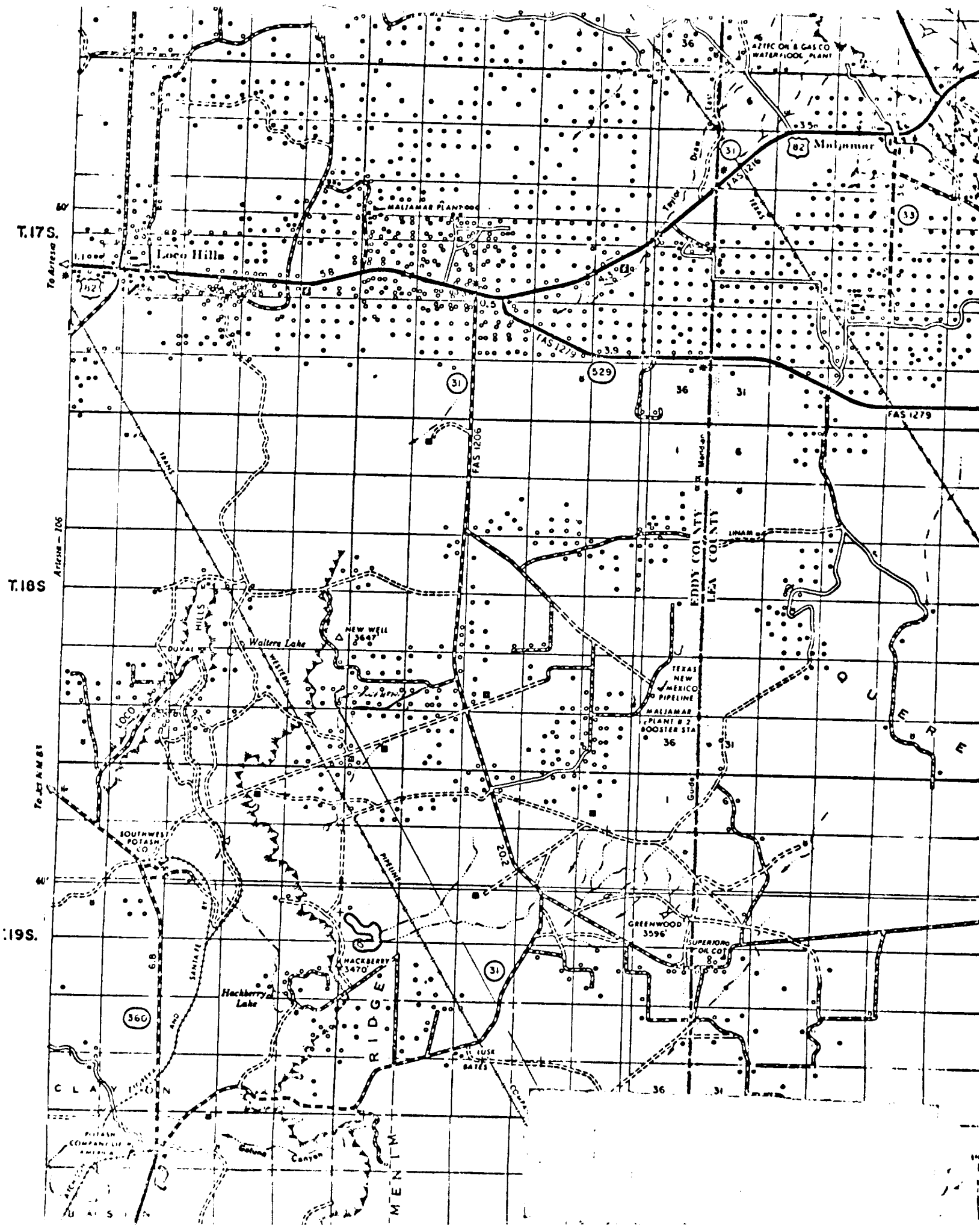

JUL 27 1976
U. S. GEOLOGICAL SURVEY
ARTESIA, NEW MEXICO
County, _____

JUL 27 1976

U. S. GEOLOGICAL SURVEY
ARTESIA, NEW MEXICO

County,

Supplies in Stock and For Sale by Triangle Blue Print & Supply Co., Tulsa, Okla.

A-51-5

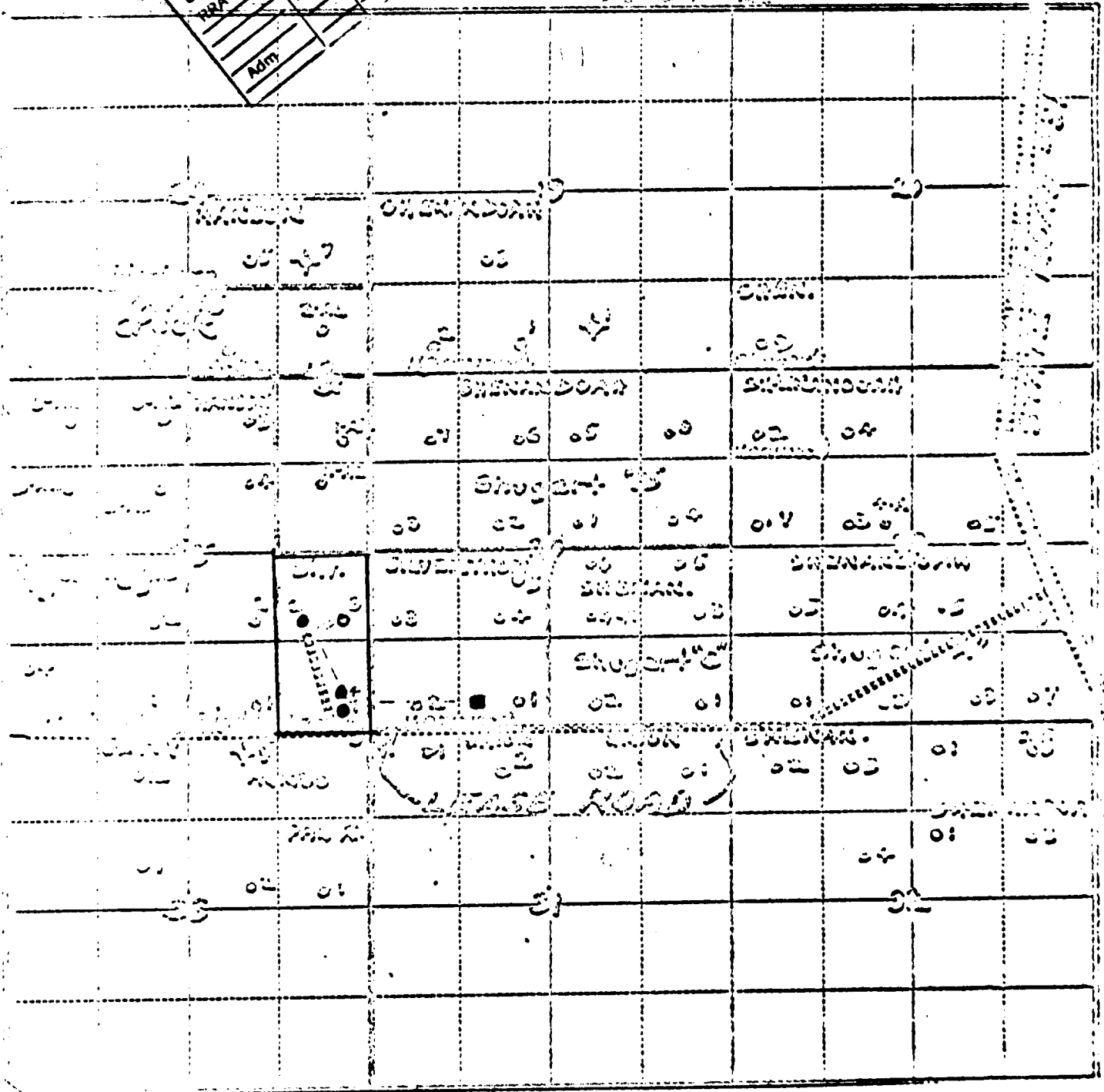

- - Battery

• 4-Proposed Location

RECEIVED

JUL 27 1976

U. S. GEOLOGICAL SURVEY
ARTESIA, NEW MEXICO

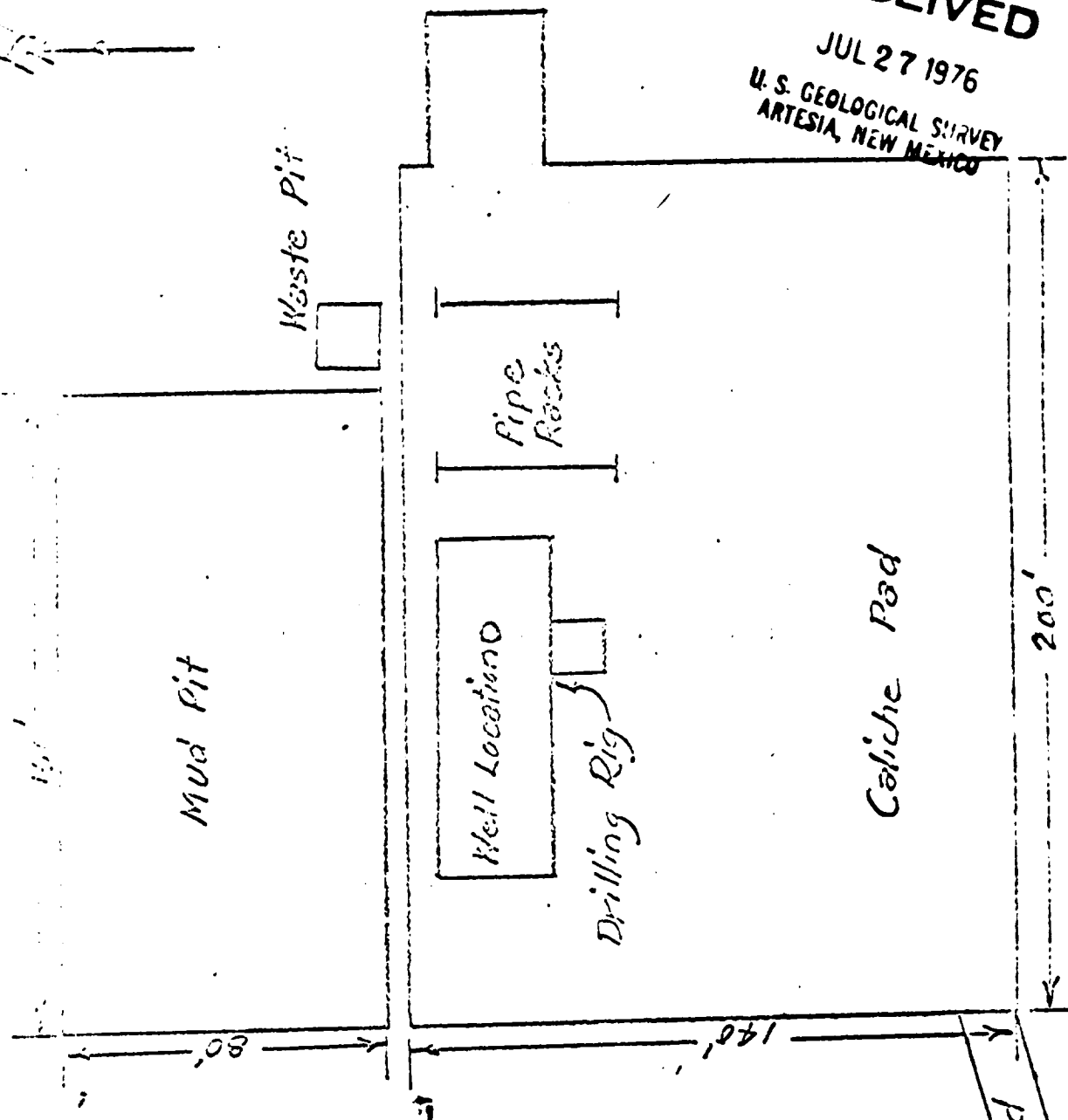

RECEIVED

AUG 02 1976

U. S. GEOLOGICAL SURVEY
ARTESIA, NEW MEXICO

R. Q. Silverthorne
Lanning No. 4

V = Info		X = Action	
DM		RM	
EPC			
Opr			
Received			
USDI BLM			
RRA		CRA	
Adm			

JUL 29 1976

Roswell

District