

**NEW MEXICO OIL CONSERVATION COMMISSION
WELL LOCATION AND ACREAGE DEDICATION PLAT**

Form C-102
Supersedes C-128
Effective 1-1-65

All distances must be from the outer boundaries of the Section

Operator MARATHON OIL COMPANY			Lease Arnquist, Estate			Well No. 2		
Tract Letter A	Section 29	Township 18 South	Range 26 East	County Eddy				
Actual Portage Location of Well:								
330 feet from the north line and		330 feet from the east line						
Ground Level Elev. 3422.3	Producing Formation Yeso		Pool <i>unleased</i> Wildcat			Dedicated Acreage: 40 Acres		

1. Outline the acreage dedicated to the subject well by colored pencil or hatchure marks on the plat below.
2. If more than one lease is dedicated to the well, outline each and identify the ownership thereof (both as to working interest and royalty).
3. If more than one lease of different ownership is dedicated to the well, have the interests of all owners been consolidated by communitization, unitization, force-pooling, etc?

☐ Yes ☐ No If answer is "yes," type of consolidation _____

If answer is "no," list the owners and tract descriptions which have actually been consolidated. (Use reverse side of this form if necessary.) _____

No allowable will be assigned to the well until all interests have been consolidated (by communitization, unitization, forced-pooling, or otherwise) or until a non-standard unit, eliminating such interests, has been approved by the Commission.

R-26E

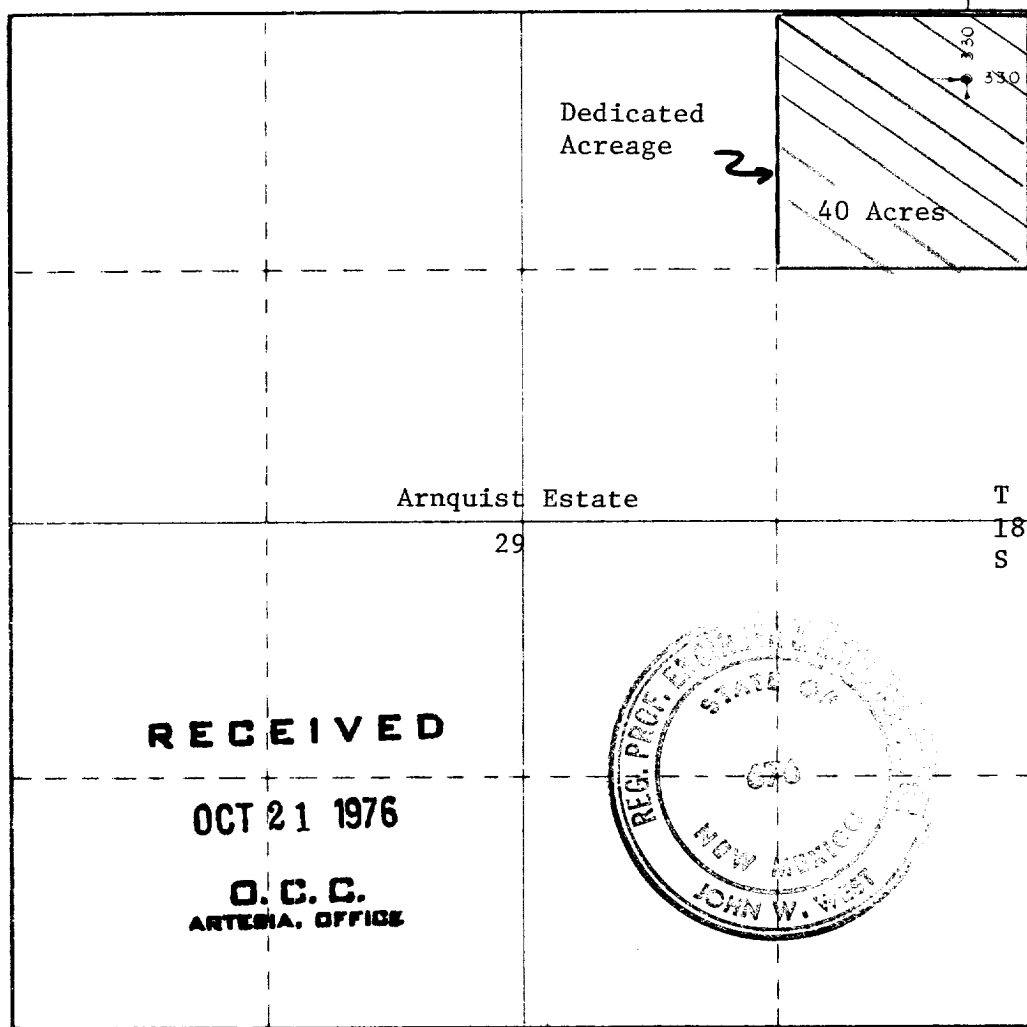

CERTIFICATION

I hereby certify that the information contained herein is true and complete to the best of my knowledge and belief.

William D. Holmes

Name
William D. Holmes

Position
Petroleum Engineer

Company
Marathon Oil Company

Date
October 21, 1976

I hereby certify that the well location shown on this plat was plotted from field notes of actual surveys made by me or under my supervision, and that the same is true and correct to the best of my knowledge and belief.

Date Surveyed
Oct. 20, 1976

Registered Professional Engineer and/or Land Surveyor

John W. West

Certificate No. **676**

