

NO. OF COPIES RECEIVED	1
DISTRIBUTION	
SANTA FE	/
FILE	/
U.S.G.S.	2
LAND OFFICE	
OPERATOR	/

Form C-105
Revised 11-1-84

NEW MEXICO OIL CONSERVATION COMMISSION
WELL COMPLETION OR RECOMPLETION REPORT AND LOG

5a. Indicate Type of Lease	
State <input type="checkbox"/>	Fee <input checked="" type="checkbox"/>
5. State Oil & Gas Lease No.	

10. TYPE OF WELL	
OIL WELL <input type="checkbox"/>	GAS WELL <input checked="" type="checkbox"/>
D. TYPE OF COMPLETION	
NEW WELL <input checked="" type="checkbox"/>	WORK OVER <input type="checkbox"/>
DEEPEN <input type="checkbox"/>	PLUG BACK <input type="checkbox"/>
DIFF. RESVR. <input type="checkbox"/>	OTHER <input type="checkbox"/>

7. Unit Agreement Name
8. Farm or Lease Name
Pipkin "HE" Com
9. Well No.
1

2. Name of Operator	
Yates Petroleum Corporation	
3. Address of Operator	
207 South 4th Street - Artesia, NM 88210	

10. Field and Pool, or Wildcat
Undesignated

4. Location of Well	
UNIT LETTER M	LOCATED 660 FEET FROM THE South LINE AND 660 FEET FROM
THE West LINE OF SEC. 4 TWP. 18S RGE. 25E NMPM	

11. County
Eddy

15. Date Spudded	16. Date T.D. Reached	17. Date Compl. (Ready to Prod.)	18. Elevations (DF, RKB, RT, GR, etc.)
2-17-77	3-10-77	4-5-77	3559' GR
20. Total Depth	21. Plug Back T.D.	22. If Multiple Compl., How Many	23. Intervals Drilled By
8560'	6653'		0-8560'

19. Elev. Casting/Leas
24. Producing Interval(s), of this completion - Top, Bottom, Name
6618-6640' Upper Penn
25. Was Directional Survey Made
No

26. Type Electric and Other Logs Run	
CNL/FDC, DLL	
27. Was Well Cased	
No	

28. CASING RECORD (Report all strings set in well)					
CASING SIZE	WEIGHT LB./ FT.	DEPTH SET	HOLE SIZE	CEMENTING RECORD	AMOUNT PULLED
13-3/8"	64#	356'	17 1/2"	380 sacks	
8-5/8"	24#	1150'	12 1/4"	800 sacks	
4 1/2"	10.5&11.6#	8518'	7-7/8"	425 sacks	

29. LINER RECORD					30. TUBING RECORD		
SIZE	TOP	BOTTOM	SACKS CEMENT	SCREEN	SIZE	DEPTH SET	PACKER SET
					2-3/8"	6556'	6564'

31. Perforation Record (Interval, size and number)		32. ACID, SHOT, FRACTURE, CEMENT SQUEEZE, ETC.	
6618-6622' w/16 .34" shots		DEPTH INTERVAL	AMOUNT AND KIND MATERIAL USED
6628-6634' w/24 .34" shots		6618-6640'	Acidized w/2500 gallons
6636-6640' w/16 .34" shots			15% DS-30 W/XR-2 acid.

33. PRODUCTION							
Date First Production		Production Method (Flowing, gas lift, pumping - Size and type pump)				Well Status (Prod. or Shut-in)	
4-5-77		Flowing				SIWOPLC	
Date of Test	Hours Tested	Choke Size	Prod'n. Per Test Period	Oil - Bbl.	Gas - MCF	Water - Bbl.	Gas - Oil Ratio
4-12-77	24	3/4"		TSTM	900	-	-
Flow Tubing Press.	Casing Pressure	Calculated 24-Hour Rate	Oil - Bbl.	Gas - MCF	Water - Bbl.	Oil Gravity - API (Corr.)	
50#	Pkr		TSTM	900			

34. Disposition of Gas (Sold, used for fuel, vented, etc.)	Test Witnessed By
Vented	Harvey Apple

35. List of Attachments	
Plat	
36. I hereby certify that the information shown on both sides of this form is true and complete to the best of my knowledge and belief.	
SIGNED <i>Charles J. Jaramila</i>	TITLE <u>Geol. Secty</u> DATE <u>4-29-77</u>

NE EXICO OIL CONSERVATION COMMISSION
WELL LOCATION AND ACREAGE DEDICATION PLAT

Form C-102
Supersedes C-128
Effective 1-1-55

All distances must be from the outer boundaries of the Section.

Operator Yates Petroleum Corporation			Lease Pipkin HE Com		Well No. 1
Unit Letter M	Section 4	Township 18S	Range 25E	County Eddy	
Actual Footage Location of Well:					
660		feet from the South	line and	660	feet from the West line
Ground Level Elev. 3559'	Producing Formation Upper Penn		Pool Undesignated		Dedicated Acreage: 320 Acres
<p>1. Outline the acreage dedicated to the subject well by colored pencil or hatchure marks on the plat below.</p> <p>2. If more than one lease is dedicated to the well, outline each and identify the ownership thereof (both as to working interest and royalty).</p> <p>3. If more than one lease of different ownership is dedicated to the well, have the interests of all owners been consolidated by communitization, unitization, force-pooling, etc?</p> <p><input checked="" type="checkbox"/> Yes <input type="checkbox"/> No If answer is "yes," type of consolidation <u>Being communitized</u></p> <p>If answer is "no," list the owners and tract descriptions which have actually been consolidated. (Use reverse side of this form if necessary.) _____</p> <p>No allowable will be assigned to the well until all interests have been consolidated (by communitization, unitization, forced-pooling, or otherwise) or until a non-standard unit, eliminating such interests, has been approved by the Commission.</p>					

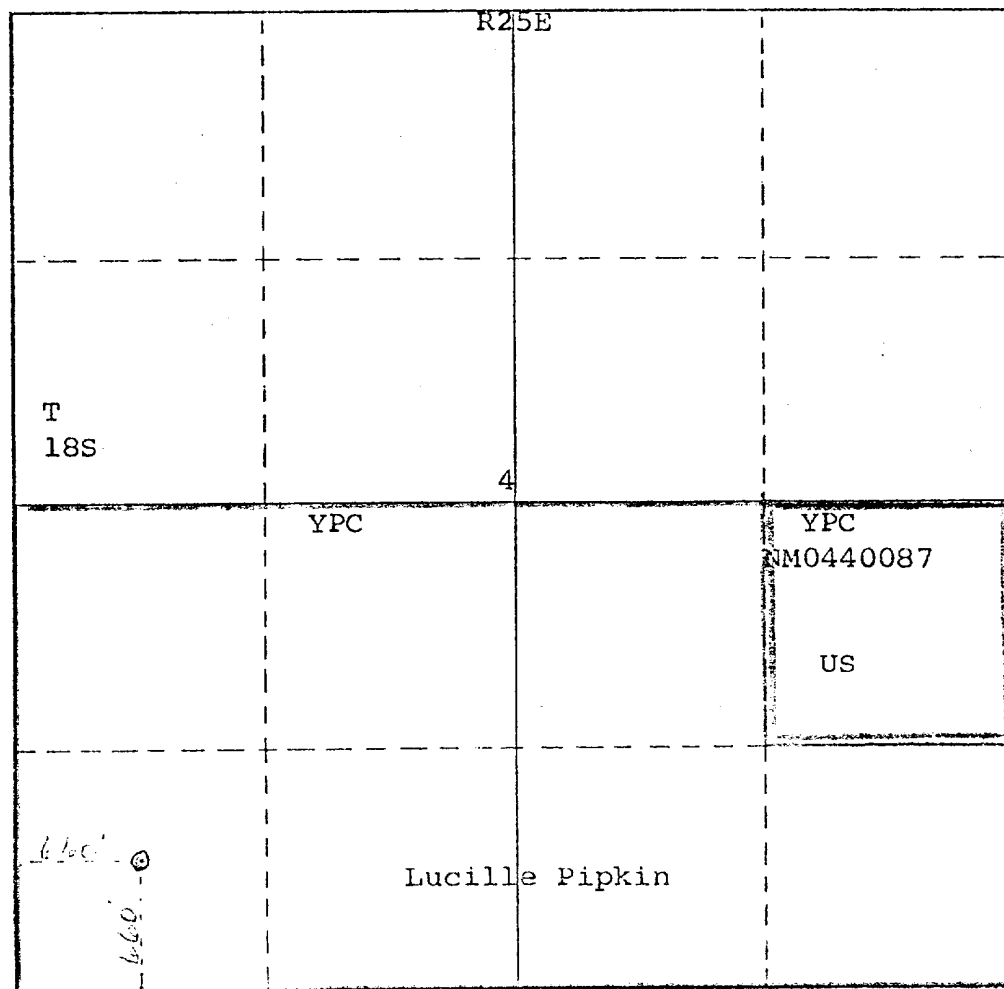

CERTIFICATION

I hereby certify that the information contained herein is true and complete to the best of my knowledge and belief.

Eddie M. Mahfood
Name

Eddie M. Mahfood

Position
Engineer

Company
Yates Petroleum Corp

Date
4-29-77

I hereby certify that the well location shown on this plat was plotted from field notes of actual surveys made by me or under my supervision, and that the same is true and correct to the best of my knowledge and belief.

Refer to Original Plat

Date Surveyed
Eddie M. Mahfood 2-7-77

Registered Professional Engineer
and/or Land Surveyor

Certificate No.

0 330 660 990 1320 1650 1980 2310 2640 2970 3300 3600 0

RECEIVED

MAY 2 1977

NEW MEXICO OIL CONSERVATION COMMISSION

OPERATOR O. C. D. Dates Petroleum Corporation
ARTESIA, OFFICE

ADDRESS 207 South 4th Street, Artesia, NM 88210

FIELD _____

LEASE Pipkin "HE" Com WELL NO. 1

LOCATION 660' FSL & 660' FWL of Sec. 4, T-18-S, R-25-E, Eddy County, New Mexico

DEVIATION RECORD

363	3/4	4675	2-1/4
857	1		
1163	1-3/4	5170	2-1/2
1510	1-3/4	5665	2-1/2
2029	2	6154	2-3/4
2520	1-1/2	6720	2-3/4
3020	1-3/4	6846	1-1/2
3515	2-1/2	7278	1-3/4
3618	2-1/4	7773	1-3/4
4085	2-1/2	8052	1-3/4
		8560	2

Certification of personal knowledge of Deviation Record:

I hereby certify that I have personal knowledge of the data and facts placed on this form, and that such information is true and complete.

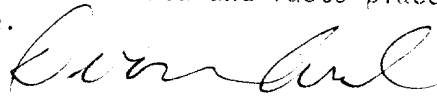
Signature

The Ard Drilling Company, Inc.
Company

STATE OF TEXAS
COUNTY OF MIDLAND

Before me, the undersigned authority, on this day personally appeared Ivan Ard, known to me to be the person whose name is subscribed hereto, who, after being duly sworn, on oath states that he is acting at the direction and on behalf of the operator of the well identified in this instrument and that such well was not intentionally deviated from the vertical.

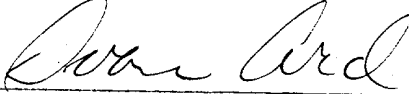
Signature
Vice-President
The Ard Drilling Company, Inc.
Title

Sworn and Subscribed to before me, this the 25th day of March, 19 77

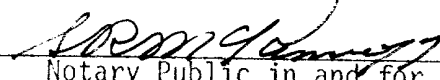
Notary Public in and for Midland County,
Texas.

MY COMMISSION EXPIRES:

June 1, 1977